

# DOUGLAS A-1G-6 SKYRAIDER

## ASSEMBLY INSTRUCTIONS

### HISTORY OF THE DOUGLAS AD-6 SKYRAIDER

The AD Series of aircraft was in production for twelve years at the El Segundo division of Douglas Aircraft Company. Since its first flight on March 8, 1945, the SKYRAIDER has become one of history's most famous aircraft. It is regarded as the most powerful single engine, propeller-driven airplane in existence, as well as being the world's most versatile combat aircraft.

Korea became the proving ground for the SKYRAIDER, where on July 3, 1950, they delivered their first bomb loads from the decks of the U.S.S. Valley Forge. This was only three days after the United Nations action started. From that time on, hardly a day passed without the "Able Dogs" flying missions against the Communists.

When the final AD was delivered to the Navy on February 18, 1957, 3,180 of the rugged carrier-based bombers had been built. It had gone through seven modifications, ranging from the AD-1 to the AD-7, and had been used in operations including dive-bombing, radar counter measures, airborne early warning, anti-submarine, photographic, and cargo and troop transport.

Having a wingspan of 50 feet, a length of 38 feet, 10 inches, the AD-6 has a cruising speed of 300 mph, and is capable of crossing the country non-stop. It is powered by an 18 cylinder, two row, Wright R-3350-26WA engine, which develops 2,700 horsepower. Normal armament includes four forward firing 20 mm guns mounted in the wings, and various arrangements of five-inch HVAR rockets and 11.75 inch "Tiny Tim" rockets, all mounted externally on the wings.

Although original design specifications called for a 1,000 pound bomb load capability, the AD's regularly carried 4,000 to 8,000 pound loads during the Korean operation. It also carried torpedoes, mines, depth charges, and napalm bombs.

In May of 1953, an AD set an all time single engine load carrying mark by taking aloft a total useful load of 14,941 pounds. This exceeded the aircraft's weight by more than 3,000 pounds.

The SKYRAIDER is still active in the fleet, but its duties are gradually being taken over by jet aircraft. It will remain as the high water mark of propeller-driven aircraft, and because it is one of the world's outstanding airplanes, it takes its place in Revell's collection.

### FOR BEST RESULTS, READ THIS FIRST

1. Since this kit is molded of Styrene Plastic, use only **REVELL Type 5 Cement**. Do not let cement touch your eyes, furniture or clothing.
2. Apply cement sparingly. Excess cement may run and damage the details on your model. Also be careful when applying cement where moving parts are involved.
3. Carefully trim any excess plastic from parts before assembling. This will result in parts fitting together perfectly, and enable moving parts to move freely.

### THIS IS VERY IMPORTANT

4. All parts are numbered for easy identification, or the numbers are engraved on the part or on the bar next to the part. Carefully remove each part from its bar **ONLY WHEN THAT PART IS TO BE USED**. As an aid to finding each individual part, the groups of parts are labeled A, B and C, as shown.
5. Each part in the instruction is called by its number and by the group letter. For instance: 1-A means part 1 which can be found in group A.
6. With **Revell Paint Set Colors**, paint all details where indicated and allow to dry before assembling. All colors are flagged, as shown: **[WHITE]**

7. Directions for applying **DECALS** are on the **DECAL SHEET**.
8. There are certain areas on your model that should be lubricated to help parts run smoothly. These points are indicated in your assembly drawings. To lubricate use small amounts of Machine Oil or "Vaseline." **DO NOT APPLY LUBRICATION WHERE PARTS ARE TO BE CEMENTED.**



THE SCALE OF  
THIS MODEL IS  
1/40 ACTUAL SIZE  
OR  
1" = 3' 4"

**Revell**  
Authentic Kits

COPYRIGHT 1961 BY REVELL, INC., VENICE, CALIF.

H-260

LITHO IN U.S.A.

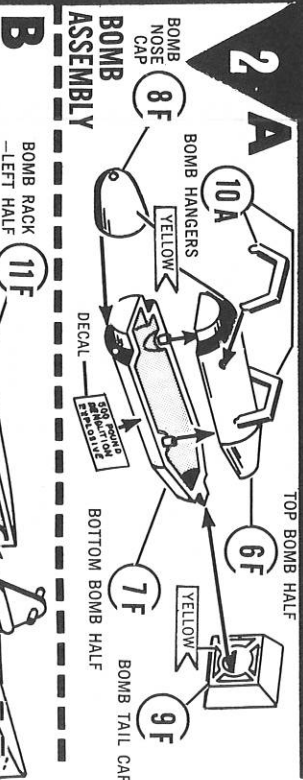
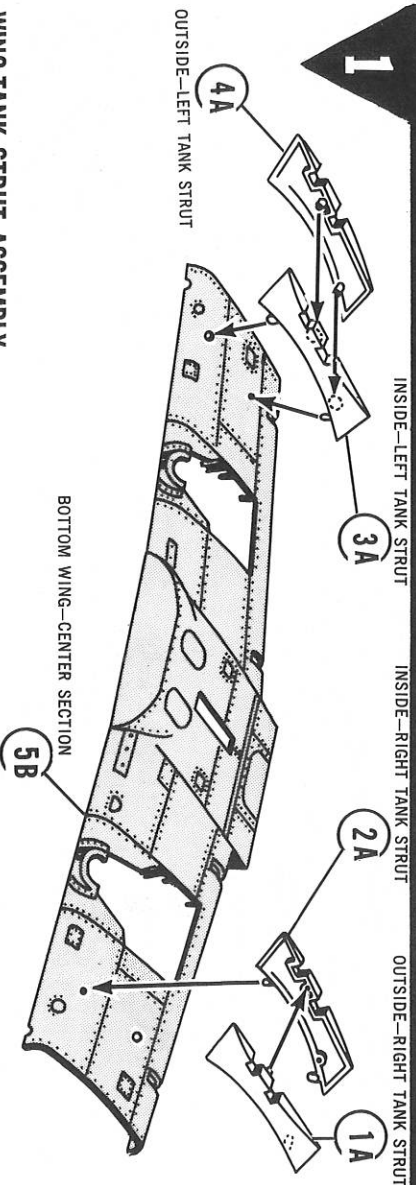

### BOMB RACK ASSEMBLY

**PAINT ALL DETAILS, AS SHOWN AND LET DRY BEFORE ASSEMBLING**

SEE **DRAWING A**, Cement 6 onto 7. Now cement 8 to assembled Parts 6 and 7. Next cement 9 to the REAR, as shown. Now cement (2) Parts 10 to the Holes in Part 6, then set aside to dry. SEE **DRAWING B**, Cement 11 to 12, apply **DECAL** as shown, then set aside to dry.

### WING-TANK STRUT ASSEMBLY

Cement Parts 1 and 2 together and Parts 3 and 4 together. Cement assembled Parts 1 and 2 and 3 and 4 down onto Part 5. We suggest you take your **BOX TOP** and **BOTTOM** and rest the **WING HALF** on them.





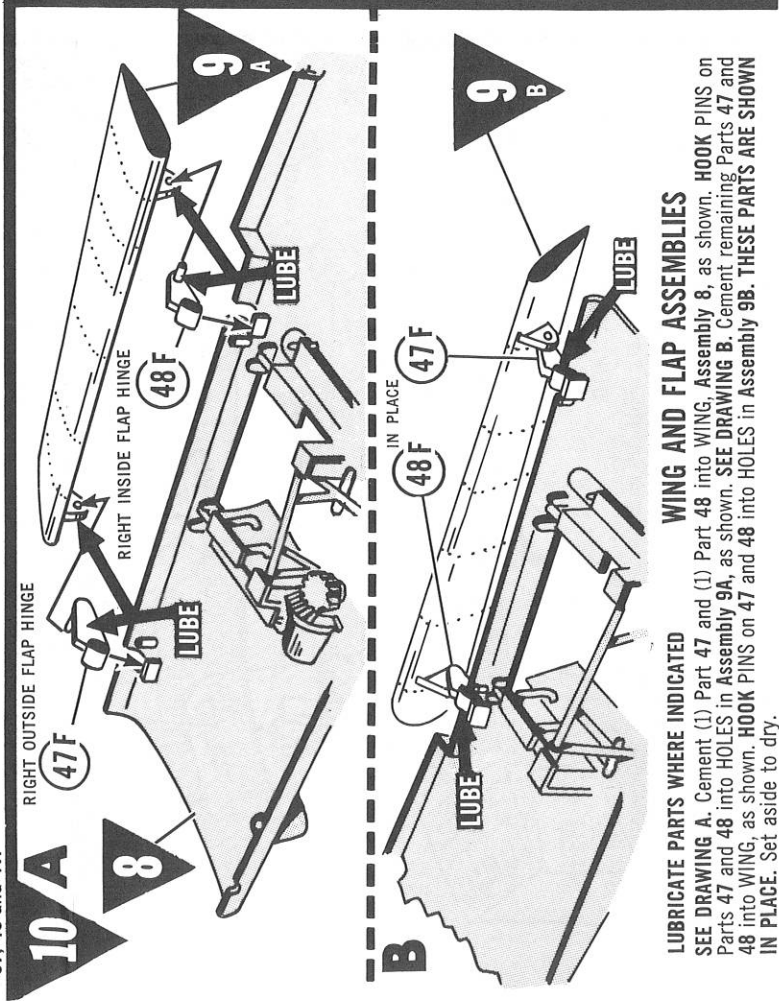
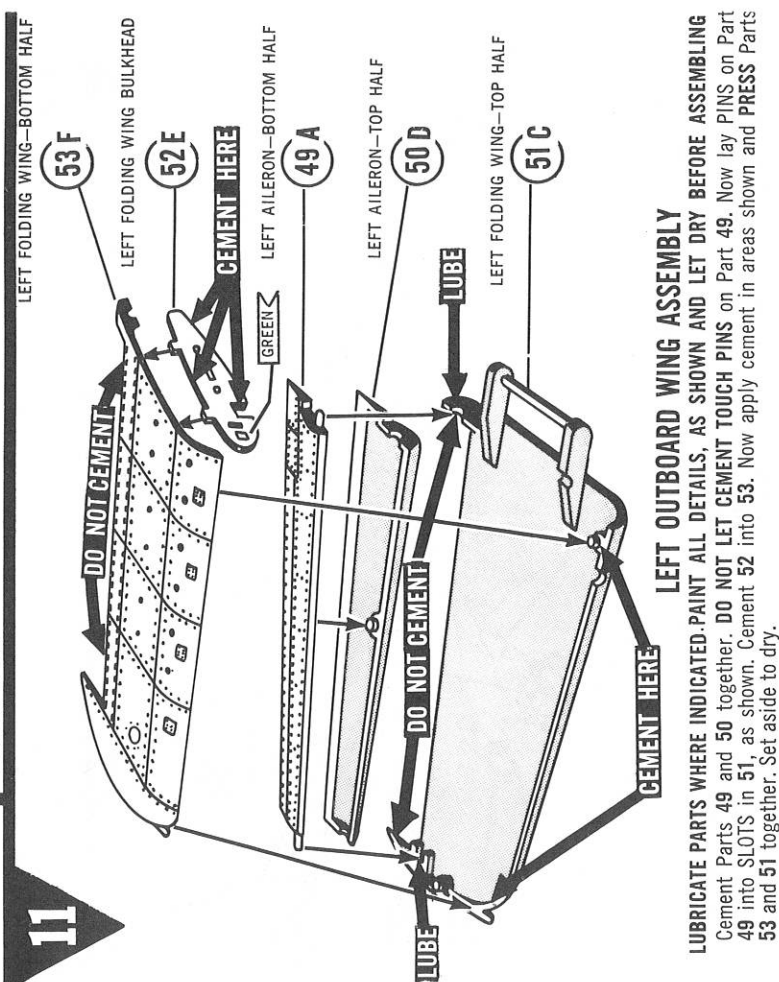
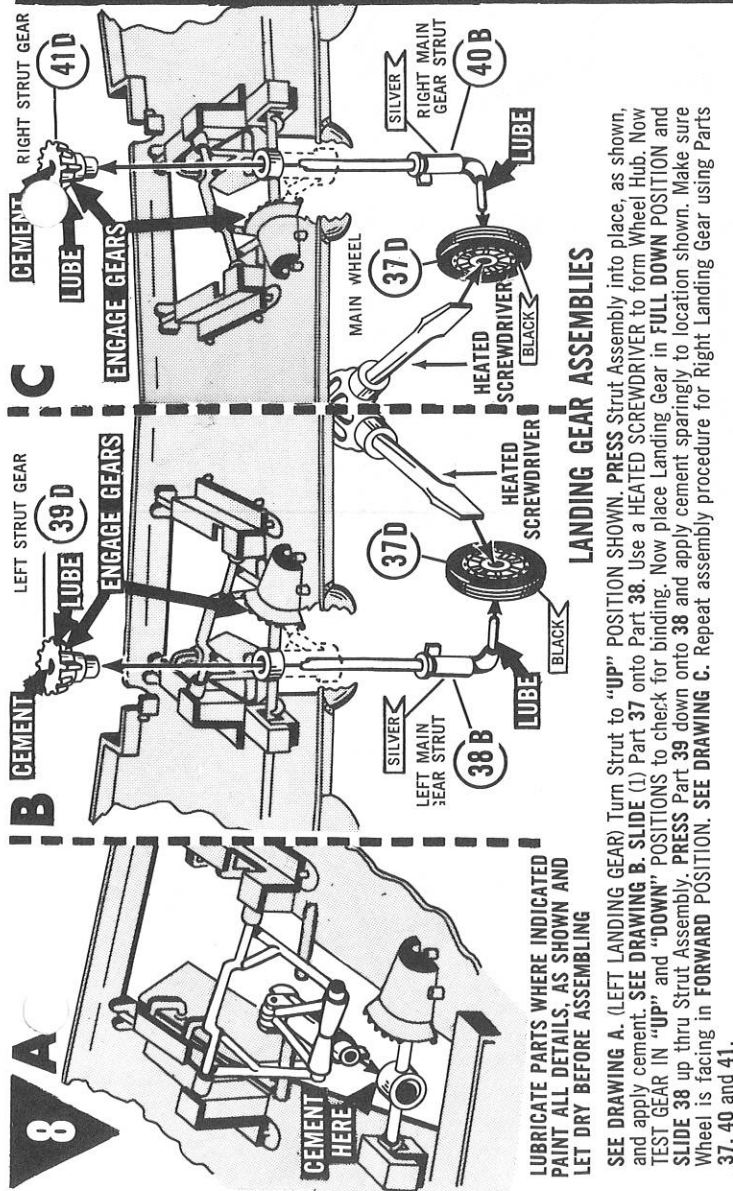
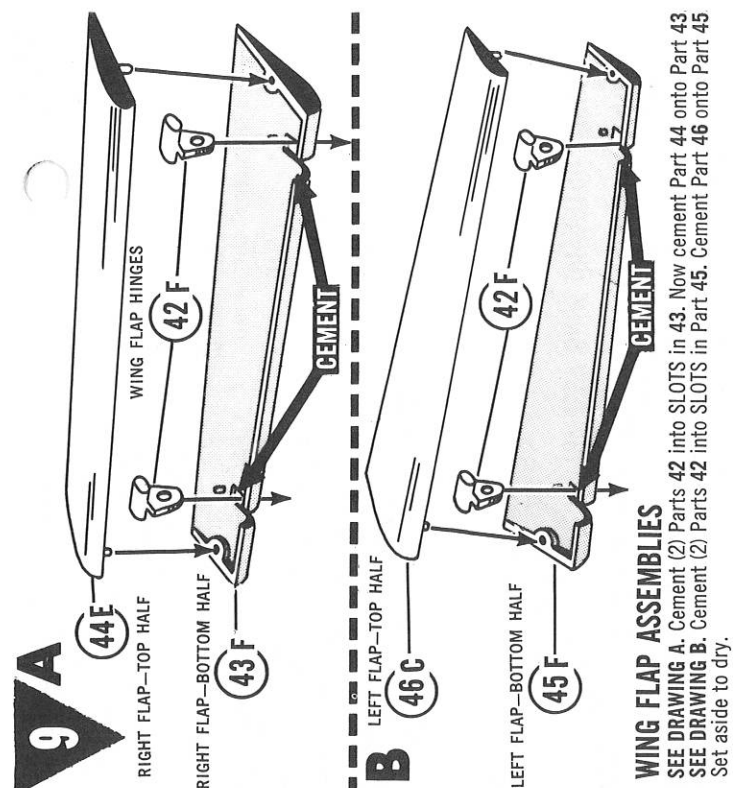

12

RIGHT FOLDING WING BOTTOM HALF

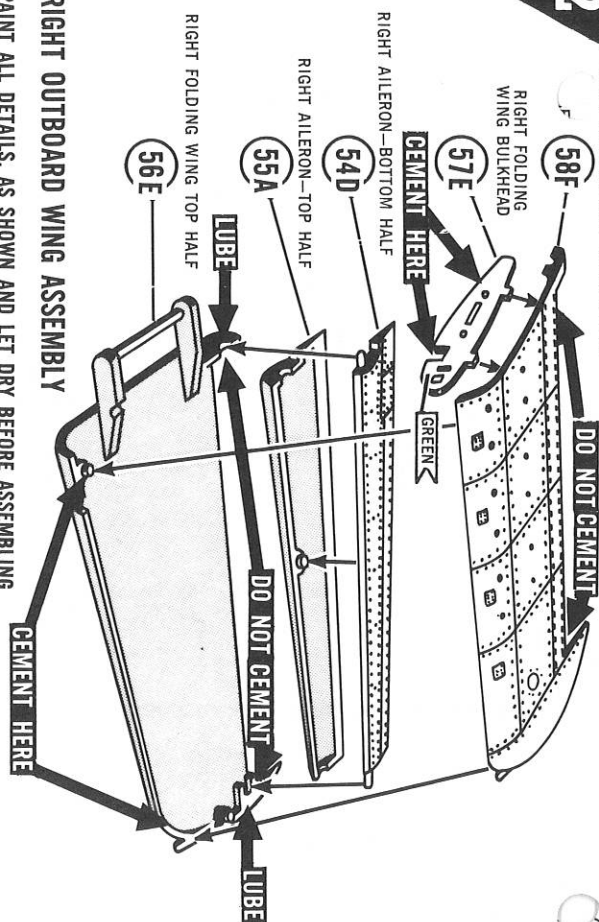

## RIGHT OUTBOARD WING ASSEMBLY

PAINT ALL DETAILS, AS SHOWN AND LET DRY BEFORE ASSEMBLING

LUBRICATE PARTS WHERE INDICATED  
Cement Parts 54 and 55 together. DO NOT LET CEMENT TOUCH PINS on Part 54. Now lay PINS on 54 into the SLOTS in Part 56 as shown. Cement Part 57 into Part 58. Now apply cement to areas shown and PRESS Parts 56 and 58 together. Set aside to dry.

13

RIGHT CENTER WING BULKHEAD

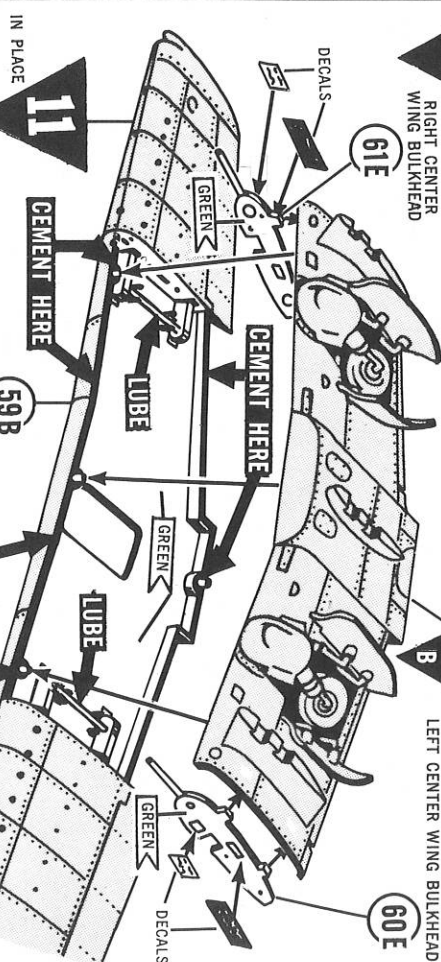

LEFT CENTER WING BULKHEAD

## COMPLETE WING ASSEMBLY

PAINT ALL DETAILS, AS SHOWN AND LET DRY BEFORE ASSEMBLING  
LUBRICATE PARTS WHERE INDICATED

Place Assemblies 11 and 12 into Part 59, as shown. Now cement Parts 60 and 61 into Assemblies 10B. Apply cement to areas shown and PRESS Assembly 10B down onto Part 59. DO NOT LET CEMENT TOUCH Assemblies 11 and 12 or they will not fold properly. Apply DECALS AND SET ASIDE TO DRY.

15

BOTTOM DIVE BRAKE HINGE

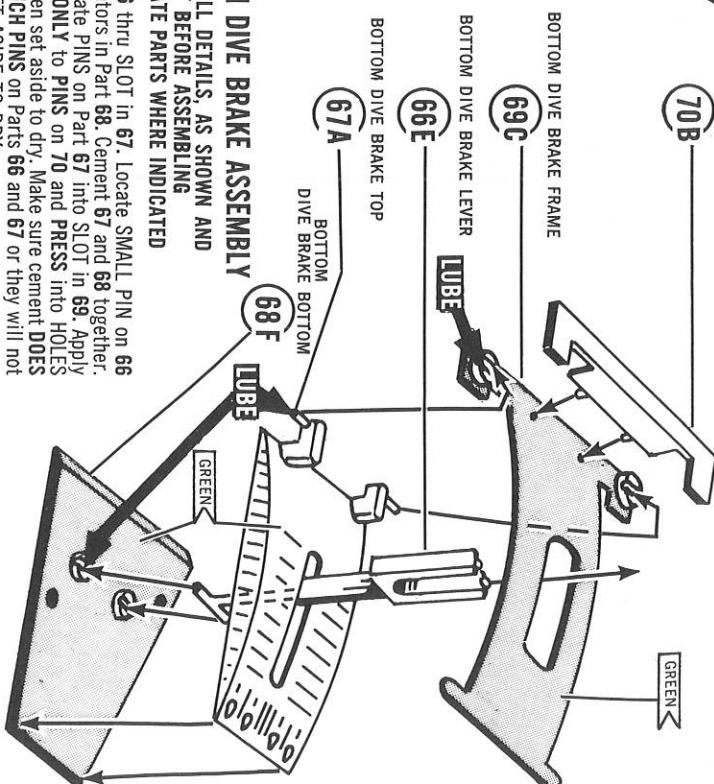

## BOTTOM DIVE BRAKE ASSEMBLY

PAINT ALL DETAILS, AS SHOWN AND LET DRY BEFORE ASSEMBLING  
LUBRICATE PARTS WHERE INDICATED

SLIDE 66 thru SLOT in 67. Locate SMALL PIN on 66 into locators in Part 68. Cement 67 and 68 together. Next locate PINS on Part 67 into SLOT in 69. Apply cement ONLY to PINS on 70 and PRESS into HOLES in 69, then set aside to dry. Make sure cement DOES NOT TOUCH PINS on Parts 66 and 67 or they will not move. SET ASIDE TO DRY.

14

RIGHT FUSELAGE HALF

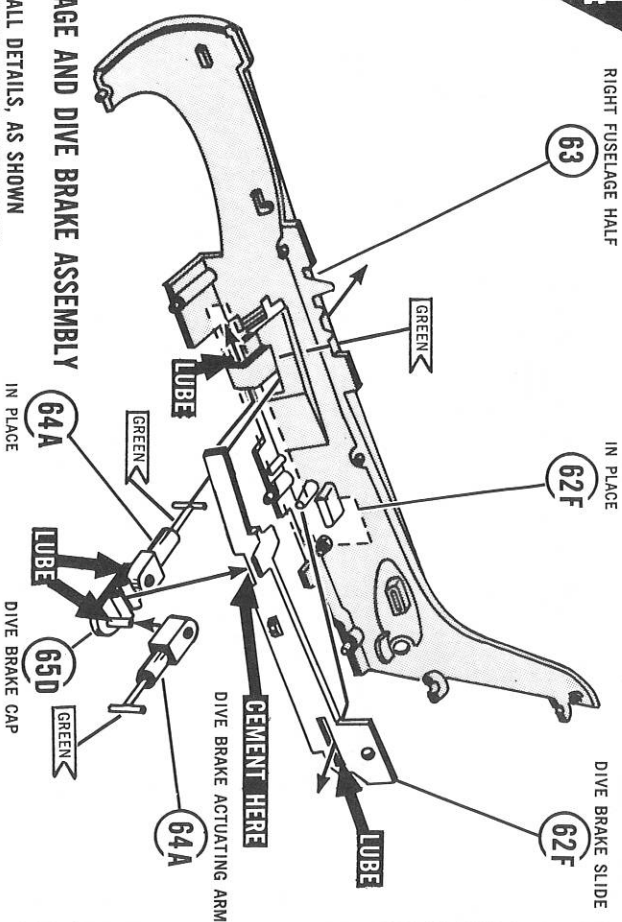

## FUSELAGE AND DIVE BRAKE ASSEMBLY

PAINT ALL DETAILS, AS SHOWN AND LET DRY BEFORE ASSEMBLING

LUBRICATE PARTS WHERE INDICATED  
SLIDE Part 62 into SLOT in Part 63, locating PIN on Part 63 into REAR SLOT in Part 62. PLACE, DO NOT CEMENT (2) Parts 64 onto PINS on 63. Apply cement to SLOT in 62, as shown and SLIDE the Right Part 64 thru opening in Part 63, then PRESS 65 into SLOT in 62. Set aside to dry.

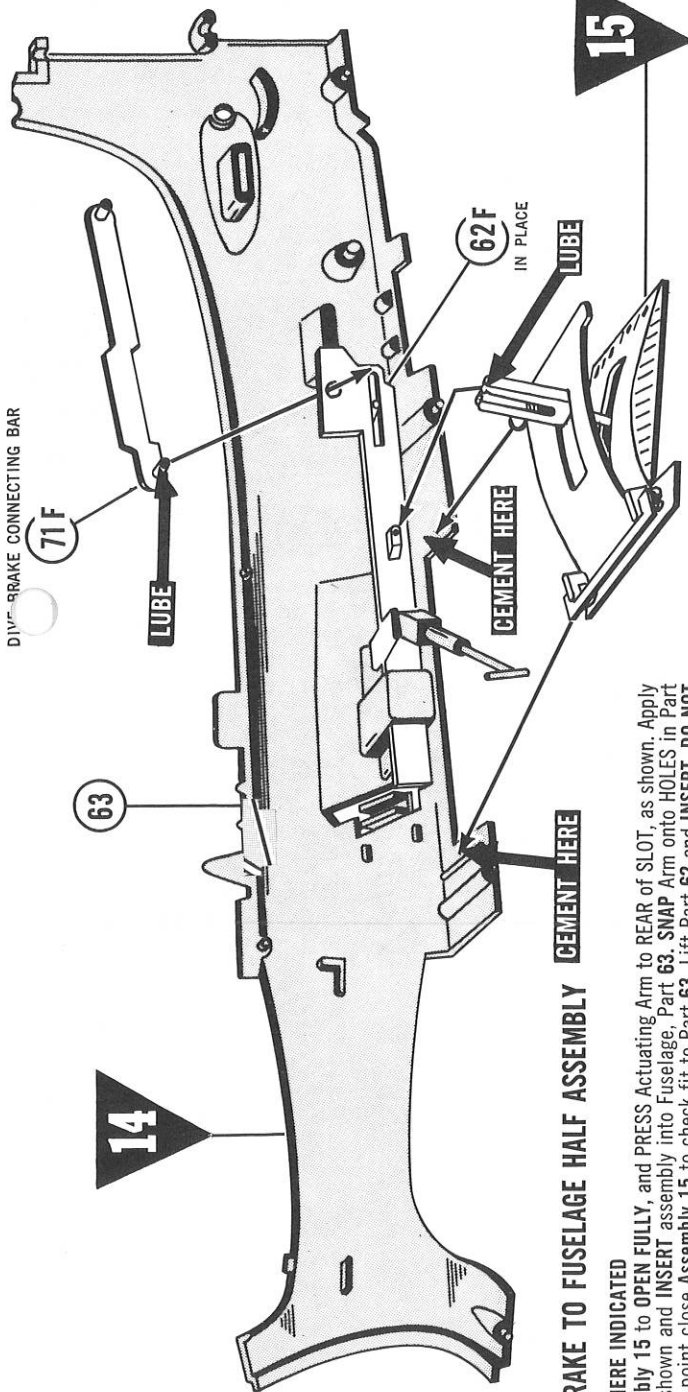

# **BOTTOM DIVE BRAKE TO FUSELAGE HALF ASSEMBLY**

**LUBRICATE PARTS WHERE INDICATED**

Allow Door on Assembly 15 to OPEN FULLY, and PRESS Actuating Arm to REAR of SLOT, as shown. Apply cement to locations shown and INSERT assembly into Fuselage, Part 63. SNAP Arm onto HOLES in Part 62, as shown. At this point close Assembly 15 to check fit to Part 63. Lift Part 62 and INSERT, DO NOT CEMENT PIN on Part 71 into HOLE in Part 62, as shown. Set aside to dry.

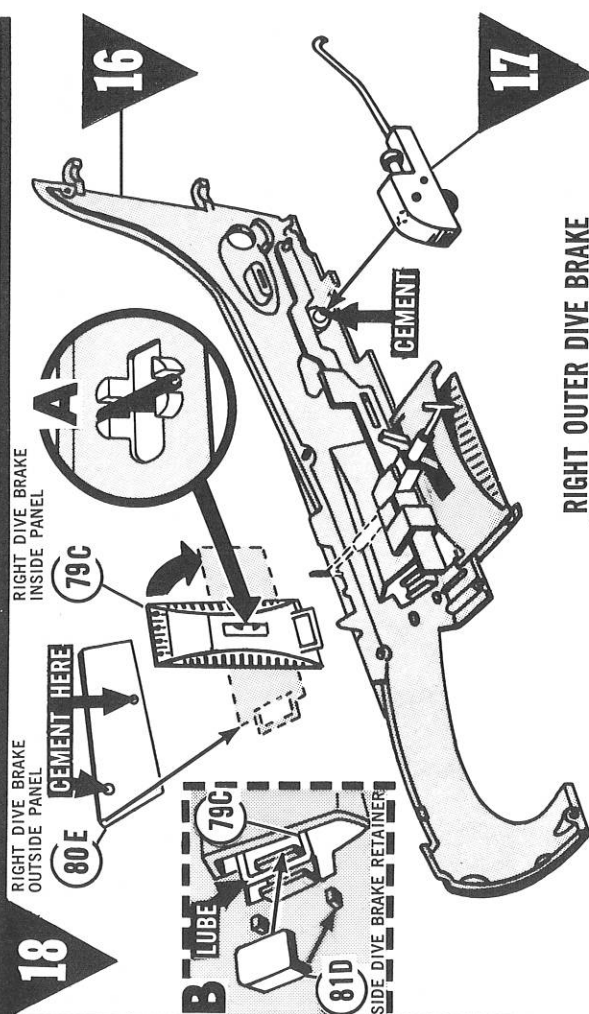

# **RIGHT OUTER DIVE BRAKE AND TAIL WHEEL ASSEMBLY**

**LUBRICATE PARTS WHERE INDICATED**

SLIDE Part 79 over Actuating Arm in Assembly 16 and turn until PINS on Arm locate properly INSIDE Part 79, as shown in SMALL DRAWING A. Now cement Part 80 to 79. Be sure PINS on Actuating Arm DO NOT JUMP OUT OF SLOT. This Part MUST MOVE. SEE DRAWING B. Insert "Bar" on Part 79 thru Fuselage until it locates between TABS inside Fuselage, as shown. Now cement (1) Part 81 to Fuselage but DO NOT LET CEMENT TOUCH "BAR" on Part 79 or it will not move. Apply cement to PIN at REAR of Fuselage and PRESS Assembly 17 into place, as shown.

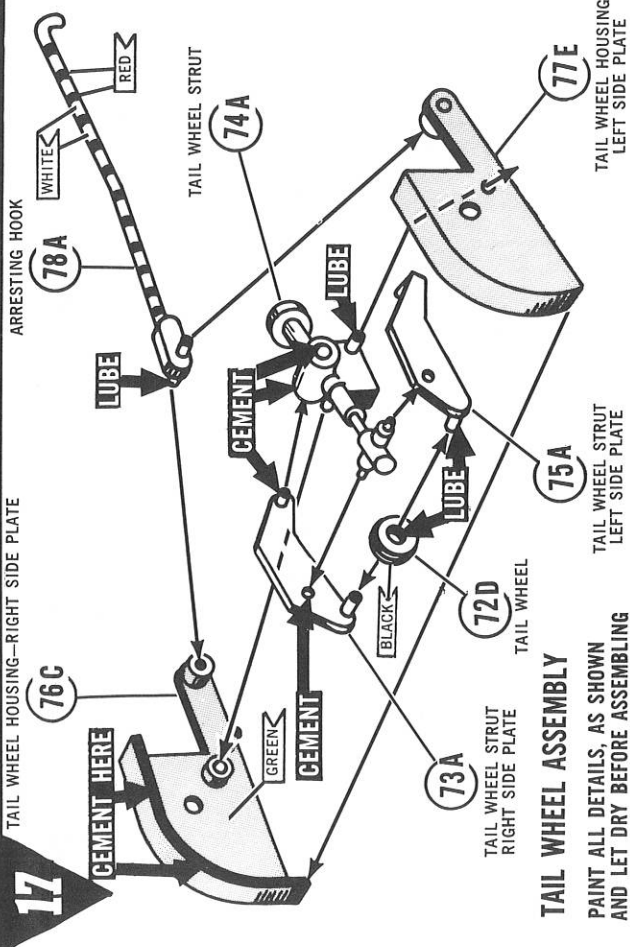

# **TAIL WHEEL ASSEMBLY**

**PAINT ALL DETAILS, AS SHOWN AND LET DRY BEFORE ASSEMBLING**

**LUBRICATE PARTS WHERE INDICATED**

PLACE, DO NOT CEMENT 72 onto LONG PIN on 73. Cement SMALL PIN on 73 into HOLE in 74, as shown. Now PLACE PINS on 75 into 72 and 74, as shown. PLACE, DO NOT CEMENT PIN on 74 into HOLE in 76, then locate 77 to 76. Spread 77 and 76 apart and locate PINS on Part 76 into HOLES, as shown. PRESS 77 and 76 together and apply cement to the TOP ONLY and set aside to dry.



# 19 / A

RIGHT HORIZONTAL STABILIZER TOP HALF

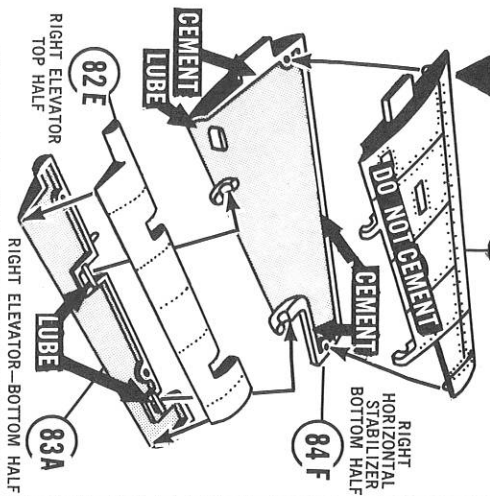

# B

18

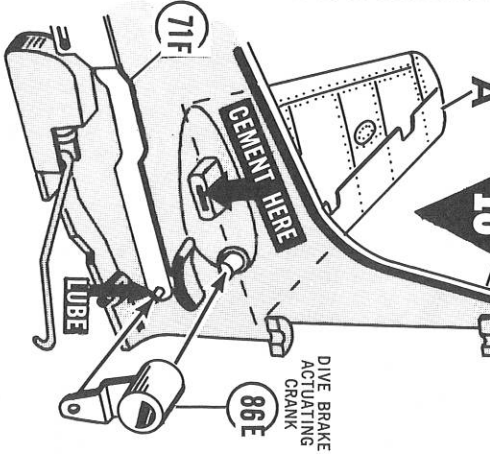

**STABILIZER AND ELEVATOR ASSEMBLY LUBRICATE PARTS WHERE INDICATED**

SEE DRAWING A. Cement 82 onto 83. PLACE. DO NOT CEMENT assembled 82 and 83 onto SLOTS in 84, as shown. Now CAREFULLY apply cement ONLY in area shown on Part 84, and PRESS 84 to 85. Make sure assembly moves freely. SEE DRAWING B. INSERT. DO NOT CEMENT PIN on Assembly A thru HOLE at REAR of Fuselage Assembly 18, and PRESS TAB on Parts 84 and 85 into SLOT. Apply cement to TAB from inside Tail Section. Now locate SMALL PIN on Part 71 into SMALL HOLE in Part 86. Now PRESS 86 onto "D" PIN on Assembly A, as shown.

# 20 / A

PILOT HEAD REST HEAD REST CONTROL UNIT

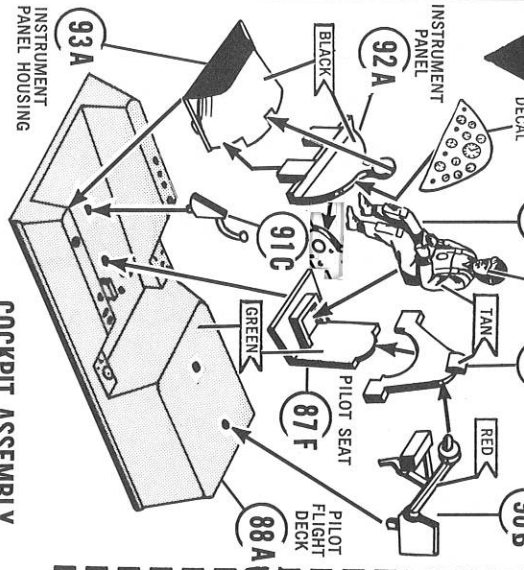

# B

19

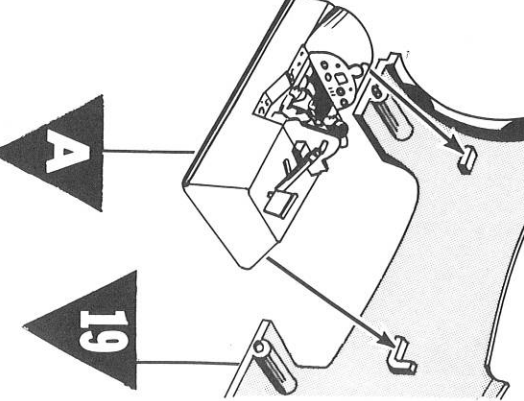

**COCKPIT ASSEMBLY**

PAINT ALL DETAILS, AS SHOWN AND LET DRY BEFORE ASSEMBLING

SEE DRAWING A. Cement 87 into 88. Cement 89 onto 87. Next cement 90 into 89 and down onto 88. Now cement 91 into 88. Cement 92 into 93. Now cement 93 onto 88. Finally cement 94 onto SEAT, Part 87. APPLY DECAL AS SHOWN. SEE DRAWING B. Cement complete Pilot Block, Assembly A onto locators inside Assembly 19, as shown.

# 21 / A

20

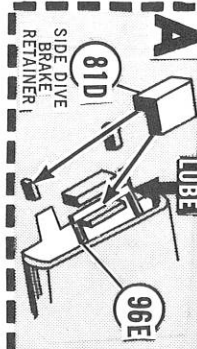

# B

20

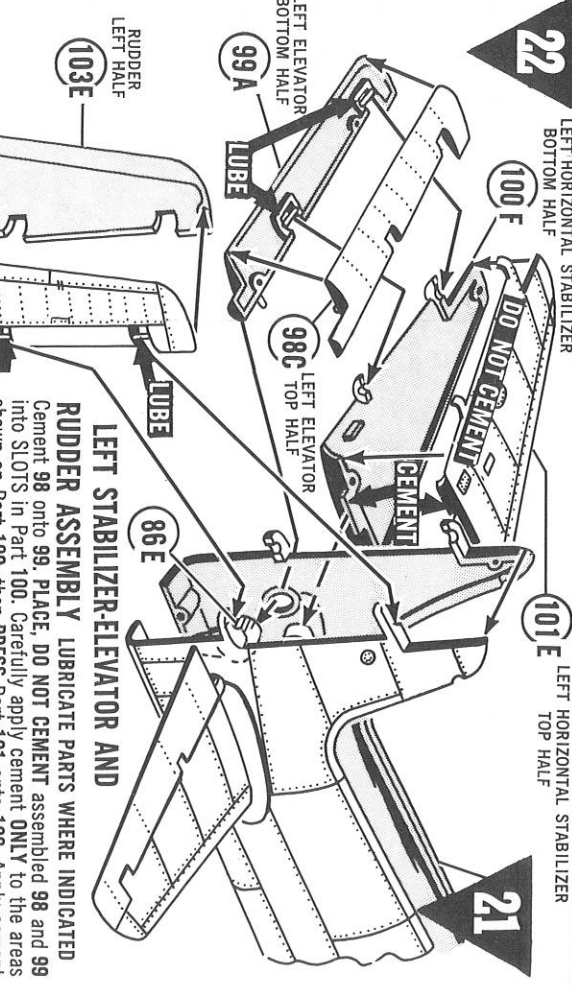
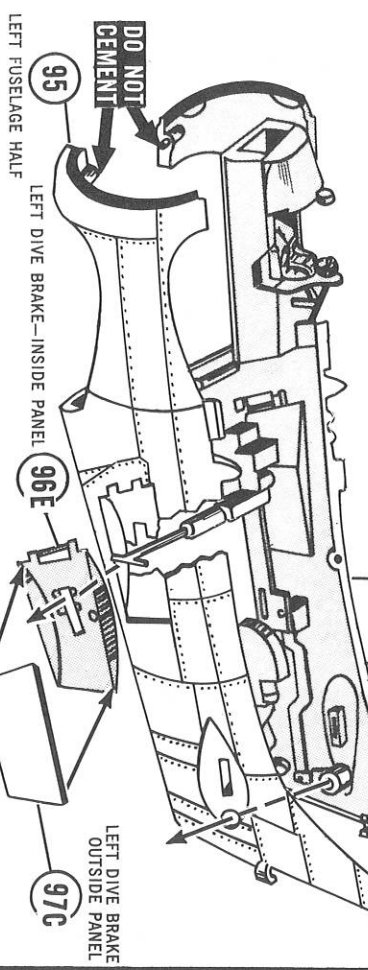
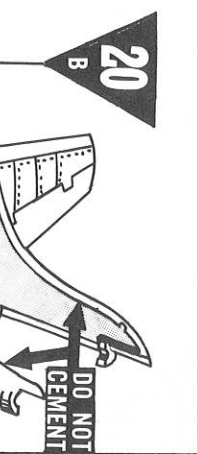

**FUSELAGE AND LEFT DIVE BRAKE ASSEMBLY LUBRICATE PARTS WHERE INDICATED**

SLIDE Actuating Arm through SLOT in Part 95. SLIDE Part 96 over Arm and turn until SMALL PINS on ARM locate INSIDE SLOTS in Part 96. Hold parts in this position and cement Part 97 to Part 96. Be sure PINS on ARM DO NOT JUMP OUT OF SLOT. INSERT "BAR" on Part 96 thru Fuselage until it locates between TABS inside Fuselage, as shown in DRAWING A and cement remaining Part 81 to Fuselage. Make sure cement DOES NOT TOUCH "BAR" on Part 96 or this part will not move. PRESS, DO NOT CEMENT FUSELAGE HALVES TOGETHER AT THIS TIME.

**RUDDER ASSEMBLY LUBRICATE PARTS WHERE INDICATED**

Cement 98 onto 99. PLACE. DO NOT CEMENT assembled 98 and 99 into SLOTS in Part 100. Carefully apply cement ONLY to the areas shown on Part 100, then PRESS Part 101 onto 100. Apply cement to the TAB on assembled 100 and 101. Now PRESS TAB thru SLOT in Fuselage and at same time locate "D" PIN ROUND HOLE and into Part 86, as shown. Next cement Part 102 to 103, and set aside. Now carefully spread Fuselage Halves SLIGHTLY, just enough to apply cement on ALL INSIDE EDGES. Before PRESSING HALVES together, locate assembled Parts 102 and 103 into SLOTS at REAR of Tail Section. PRESS Halves of Fuselage together and hold with RUBBER BANDS until dry, then remove RUBBER BANDS.

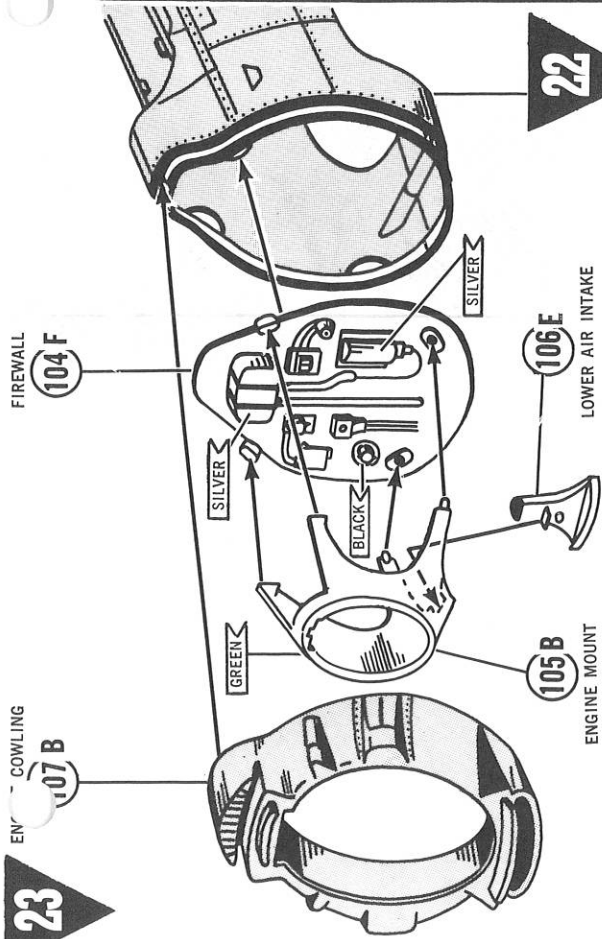

### ENGINE MOUNT AND FIRE WALL ASSEMBLY

PAINT ALL DETAILS, AS SHOWN AND LET DRY BEFORE ASSEMBLING

Cement Part 104 to FRONT of Assembly 22. Now cement Part 106 UP INSIDE Part 105. Finally cement Part 107 to FRONT of Assembly 22.

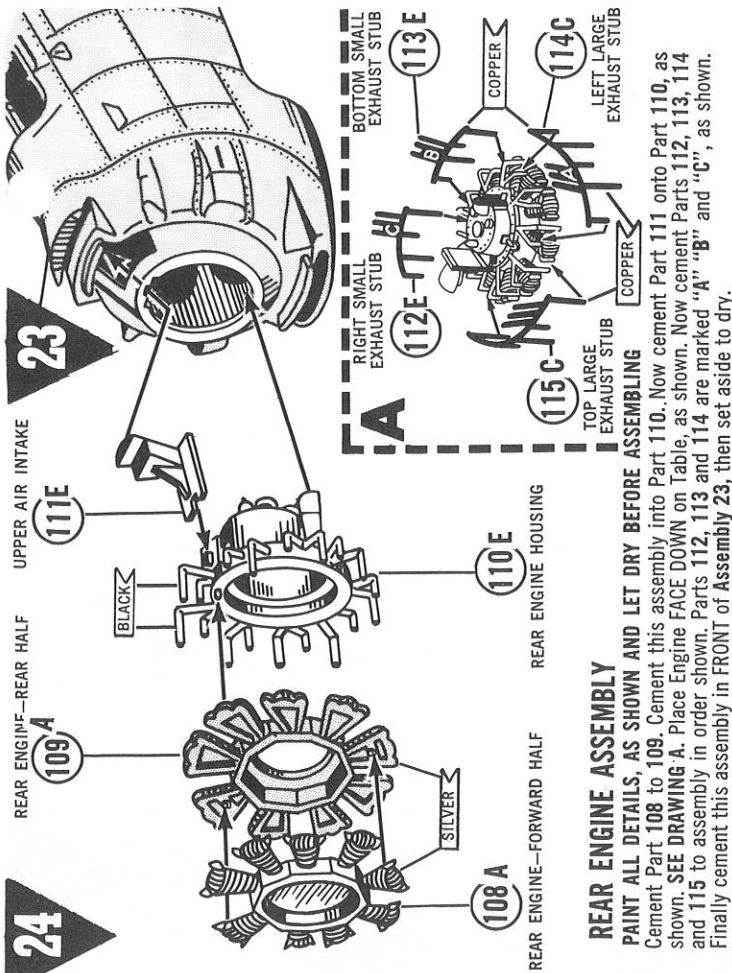

### REAR ENGINE ASSEMBLY

PAINT ALL DETAILS, AS SHOWN AND LET DRY BEFORE ASSEMBLING

Cement Part 108 to 109. Cement this assembly into Part 110. Now cement Part 111 onto Part 110, as shown. SEE DRAWING A. Place Engine FACE DOWN on Table, as shown. Now cement Parts 112, 113, 114 and 115 to assembly in order shown. Parts 112, 113 and 114 are marked "A", "B" and "C", as shown. Finally cement this assembly in FRONT of Assembly 23, then set aside to dry.

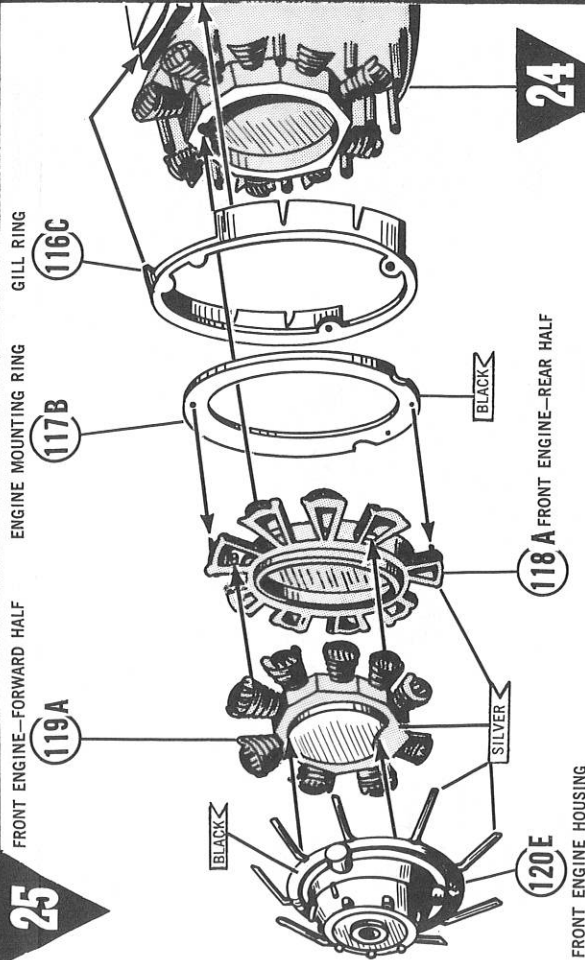
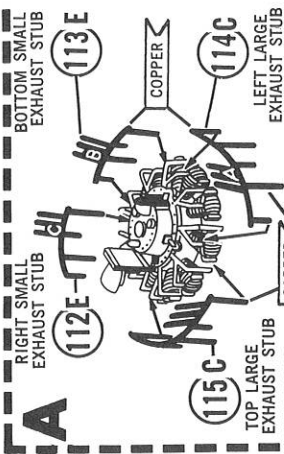

### FRONT ENGINE ASSEMBLY

PAINT ALL DETAILS, AS SHOWN AND LET DRY BEFORE ASSEMBLING

Cement Part 116 to FRONT of Assembly 24. Now cement Part 117 onto 118. Next cement Part 119 onto 118. Now cement 120 to 119. Cement this assembly to the FRONT of Assembly 24 and allow to dry.

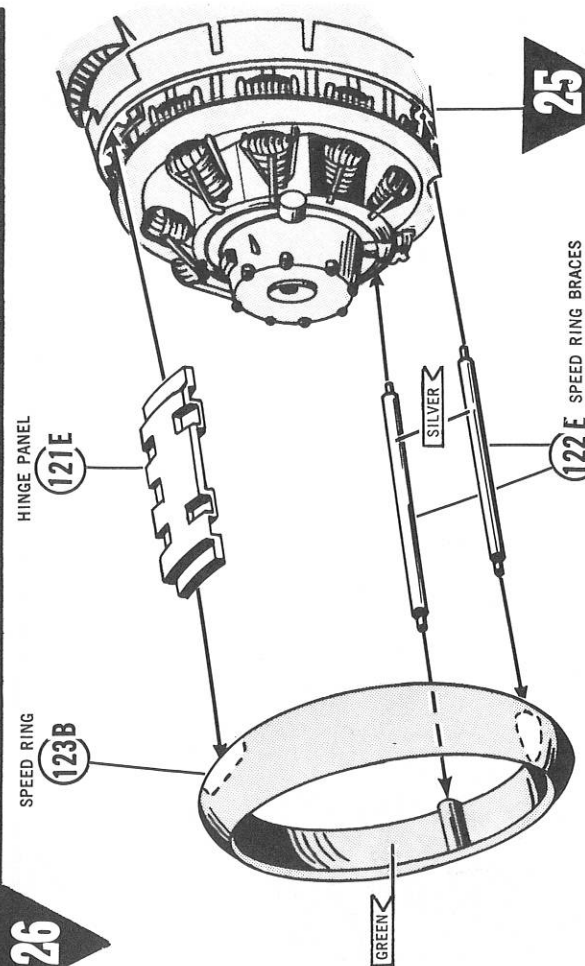

### FORWARD COWLING ASSEMBLY

PAINT ALL DETAILS, AS SHOWN AND LET DRY BEFORE ASSEMBLING

Cement Part 121 to FRONT of Assembly 25. Next cement (2) Parts 122 to Assembly 25. Now carefully locate Part 123 onto (2) Parts 122 and onto Part 121. When positioned properly apply cement then set aside to dry.

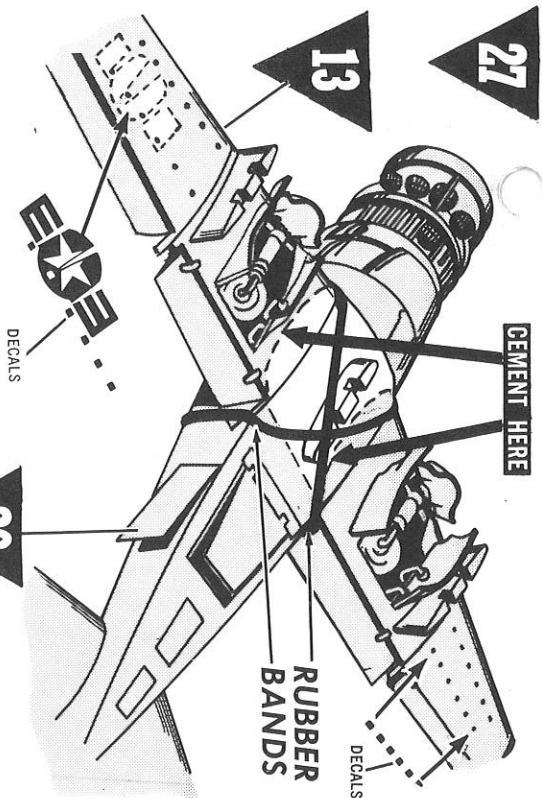

## WING AND FUSELAGE ASSEMBLY

Apply cement to the FUSELAGE. Assembly 26, at the areas shown. PRESS WING. Assembly 13 onto the FUSELAGE. Hold together with RUBBER BANDS, as shown until dry then CAREFULLY remove RUBBER BANDS. APPLY DECALS, SET ASIDE TO DRY.

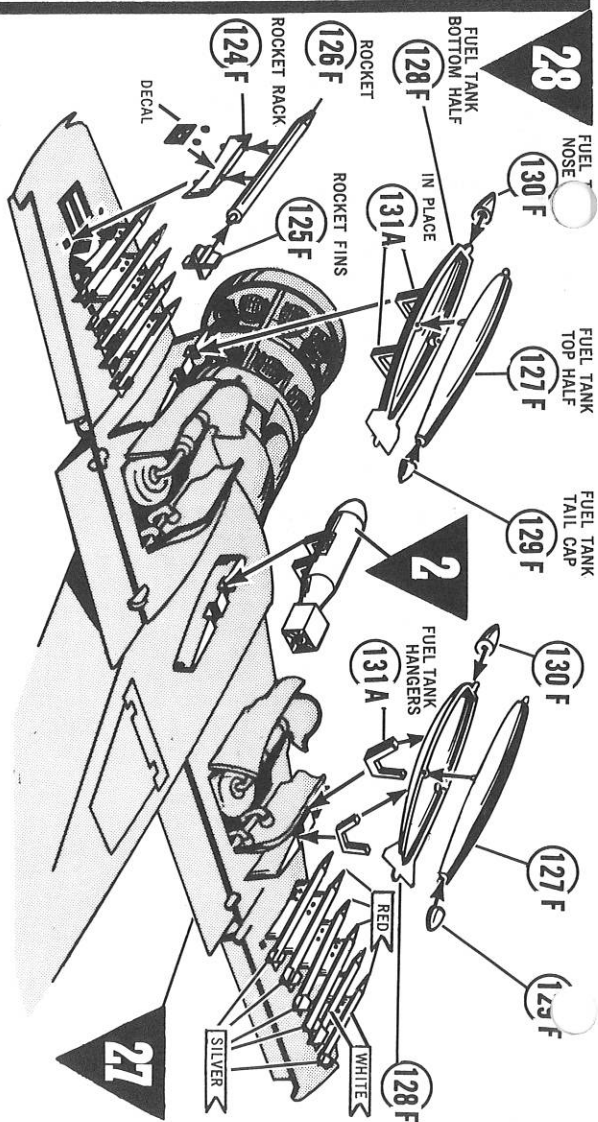

## ARMAMENT AND FUEL TANK ASSEMBLY

PAINT ALL DETAILS, AS SHOWN AND LET DRY BEFORE ASSEMBLING. Cement (6) Parts 124 to BOTTOM of EACH WING, as shown. Now cement (1) Part 125 to (1) Part 126. MAKE (12) SETS. Cement (1) ROCKET to EACH Part 124 on RIGHT AND LEFT WING. Next cement Part 127 to 128. Now cement (1) Part 129 to REAR and (1) Part 130 to FRONT, as shown. MAKE (2) SETS. Cement (2) Parts 131 to EACH assembled FUEL TANK. Cement completed TANK to locations shown. Finally cement Assembly 2 to location, as shown. Apply DECALS and set aside to dry.



## FINAL ASSEMBLY

PAINT ALL DETAILS, AS SHOWN AND LET DRY BEFORE ASSEMBLING.

LUBRICATE PARTS WHERE INDICATED. INSERT Part 132 into Part 133 and PRESS into ENGINE. You may SNAP Parts 134 and 135 CLOSED or cement them OPEN to DISPLAY ENGINE DETAIL. Now cement (1) Part 136 into RIGHT and LEFT WING, as shown. Cement Part 137 onto TOP of FUSELAGE. Cement (2) Parts 138 to Part 139. SLIDE, DO NOT CEMENT Parts 138 onto GROOVE on FUSELAGE SIDES. Cement Part 140 into HOLE in TAIL. Finally cement 141 to 142, 143 to 144 and 145 to 146. Place them as you wish. Apply DECALS to both sides of your model and set aside to dry.

