



RMXY8662 — Car Parts Accessory Pack B

Proof of Purchase



Seal

visit [www.scouting.org](http://www.scouting.org)

For more information on Scouting,

Manufactured under license. All rights reserved.

Pinewood Derby® is a registered trademark of the Boy Scouts of America.

PLEASE RETAIN PACKAGING FOR FUTURE REFERENCE.

MADE IN CHINA • CONTENTS / PACKAGING © 2010 REVELL® INC. • 3123554

REVELL® INC., ELK GROVE VILLAGE, IL 60007 U.S.A.

**Contents: • Helmet • Roll Cage • Wing**

Glue the wing to the body.

**Wing**

engine accessory.

Place the exhaust under the

**Exhaust**

accessory item in place.

amount of glue to help hold the

accessory. If required, add a small

to be installed. Install the

Drill a hole sized to the accessory

**& Roll Cage**

**Engine, Rollbar, Helmet**

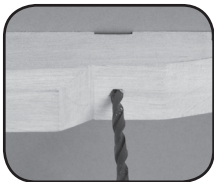
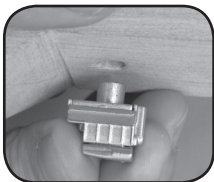

**CAR PARTS ACCESSORY PACK B**



**PINEWOOD DERBY®**

**CAR PARTS ACCESSORY PACK B**



**WARNING: CHOKING HAZARD -**  
Small parts. Not for children under 3 years

**8+**