

## Flying Your Piloto (continued)

### 2. HOW TO CONTROL FLIGHT:

#### To Ascend:

Gain flying altitude by moving the controller's throttle (left) stick upward.

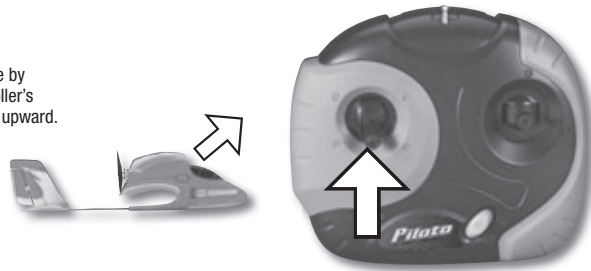

#### To Descend:

Fly lower by moving the controller's throttle (left) stick downward.

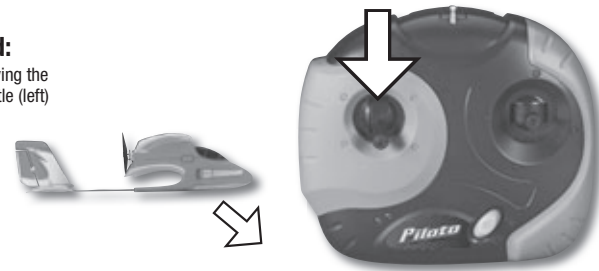

#### To Turn Left:

Make left turns by moving the controller's rudder (right) stick to the left.



#### To Turn Right:

Make right turns by moving the controller's rudder (right) stick to the right.

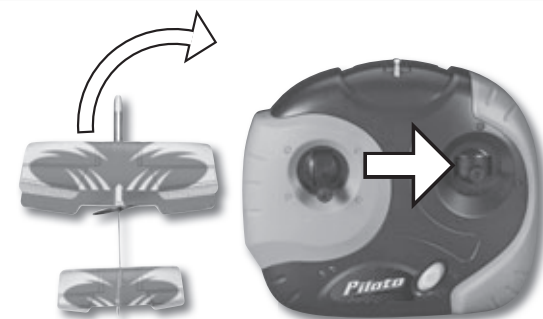

### 3. HOW TO LAND:

- When you're ready to land, just move the controller's throttle (left) stick down to its "off" position. As the Piloto glides to the ground, you can still make left and right turns using the controller's rudder (right) stick.

### Safety Tips

- Read through the entire instruction manual before flying your Piloto.
- This product should be flown only indoors.
- Make sure that you and other people stay at least 3 feet (or 1 meter) away from the Piloto during flight.
- Always keep your eye on the flying toy to prevent it from flying, landing, or crashing on or near your head or body, or on other people.
- Never disassemble or attempt to modify the Piloto. You could damage the product and create the potential for damage or injury.
- Never put your hands or face close to the spinning propeller. Doing so risks injury. Never operate the Piloto while sitting on the floor or on a chair — always fly from a position that lets you get out of the way quickly if necessary.
- Always switch off both the Piloto and the controller when you leave the controller unattended. If the power switch is left on, unintended stick operation might occur (for example, if the controller falls face-forward onto the floor).
- Never let young children use this product. Doing so risks accidents caused by the rotating parts.
- Never use parts that are damaged.

### Operating Tips

- Always move the controller's throttle stick to the down position after a crash.
- Do not place any other labels or stickers onto the Piloto. These could interfere with its performance.
- Two Piloto models cannot be flown on the same radio band.

### Trouble Shooting

#### Problem: Propeller doesn't turn.

- Cause:**
- ON/OFF switch is OFF.
  - Weak battery.

- Solution:**
- Set switch to ON.
  - Recharge the battery.

#### Problem: Piloto suddenly stops flying and drops.

- Cause:** Too little power.
- Solution:** Recharge the battery pack.

#### Problem: Loss of control.

- Cause:**
- Another RF control device is interfering.
- Solution:**
- Avoid flying around other radio-control devices.
  - Choose another flying location.

# Piloto™

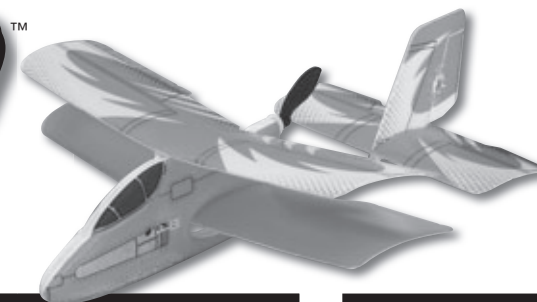

**Revell**

www.revell.com

Revell, Inc. a subsidiary of  
Hobbico®, Inc., Champaign, IL 61826

### Contents

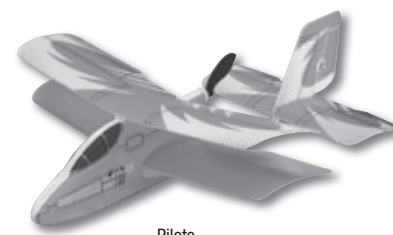

Piloto



Controller



Instruction Manual

### Main Features

#### Piloto:

- Durable, pre-colored foam fuselage, wings and tail
- Carbon-fiber frame
- On/off switch and charging jack
- Built-in LiPo (lithium-polymer) rechargeable flight battery
- Realistic rudder control
- Climbs, descends, and turns like a real airplane

#### Controller:

- Two-channel digital control
- Charge status and power-on LEDs
- Easy Piloto battery recharging from the controller

Do not touch the spinning propeller or fly over another person's head. Adult supervision is required.

#### Safety Precautions:

**Warning:** Do not modify or alter this unit. Changes or modifications to this unit not expressly approved by the party responsible for compliance could void the user's authority to operate the equipment.

- Do not turn on the Piloto unless the controller has been turned on first.
- Keep hands, hair and loose clothing away from the spinning propeller when the power switch is turned ON.
- Turn off the controller and Piloto when not in use.
- Remove the battery from the controller when not in use.
- Parental guidance is recommended while flying.
- Always keep your Piloto in sight while flying.
- For the best performance, use new alkaline batteries in the controller.
- Replace the batteries in the controller with new ones as soon as any function becomes diminished.
- Keep these instructions for future reference.
- Follow the operating instructions exactly.
- Your controller's built-in charger is made specifically for the rechargeable Piloto LiPo battery. Do not use it to charge any other battery.

### FCC REQUIREMENT



This device complies with Part 15 of the FCC rules. Operation is subject to the following two conditions: (1) This device may not cause harmful interference, and (2) this device must accept any interference received, including interference that may cause undesired operation.

**CAUTION:** Changes or modifications to this product not expressly approved by the party responsible for compliance may void the user's authority to operate the equipment.

#### Care and Maintenance:

- Always remove batteries from the controller when it is not being used for a long period of time.
- Wipe the toy gently with a clean, damp cloth.
- Keep the toy away from direct heat.
- Do not submerge the toy into water. This could damage the electronic assemblies.

#### Battery Cautions:

- Non-rechargeable batteries are not to be recharged.
- If the controller uses rechargeable batteries, remove them before recharging.
- Rechargeable batteries should be recharged only by an adult.
- Do not power the controller by mixing different types of batteries, or old and new batteries.
- Use only batteries of the same or equivalent type as those recommended.
- Install batteries following the correct polarity.
- Remove exhausted batteries from the controller.
- Do not short-circuit the supply terminals.

The Piloto is equipped with a rechargeable LiPo battery. Please pay attention to the following cautions for safe use:

- Do not dispose of the battery into fire or heat.
- Do not use or leave the battery near a heat source, such as fire or a heater.
- Do not strike the battery or throw it against a hard surface.

- Do not immerse the battery into water. Keep the battery cool and dry.
- When recharging the battery, use only the charger designed for that purpose.
- Do not over-discharge the battery.
- Do not connect the battery to an electrical outlet.
- Do not directly solder the battery or pierce it with a nail or other sharp object.
- Do not transport or store the battery together with metal objects such as necklaces, hairpins, etc.
- Do not disassemble or alter the battery.
- Charge the battery every six months.
- Turn off your equipment power switch after use.
- Recycle used batteries after covering the battery terminals with insulation tape or inserting the battery into an individual polybag.

#### Note:

- Parental guidance is recommended when installing or replacing batteries.
- Static electricity may cause the toy to malfunction, requiring you to turn it off and back on before flying again.

#### Specific Note to Adults:

- Regularly examine all parts of the toy for damage. If any is found, do not use the toy again until the damage has been repaired.
- This toy is not intended for children under 3 years old.
- This toy must be used only with the recommended charger.
- Do not try to charge other batteries with the controller's charger.

#### Battery Requirements for Piloto:

Power Supply: =====  
Rating: DC 3.7V  
Batteries: 1 x 3.7V LiPo Rechargeable Battery Pack  
Requires: 1 x 3.7V LiPo Rechargeable Battery Pack (included)

#### Battery Requirement for Controller:

Power Supply: =====  
Rating: DC 9V  
Batteries: 6 x 1.5V "AA"  
Requires: 6 x 1.5V "AA" size batteries (not included)



**WARNING:**  
**CHOKING HAZARD** — Small parts.  
Not for children under 3 years of age.

"This product is in compliance with the essential requirements and other relevant provisions of Directive 1999/5/EC."



Do not touch the spinning propeller or fly over another person's head. Adult supervision is required.



## Piloto and Controller Parts

### Piloto

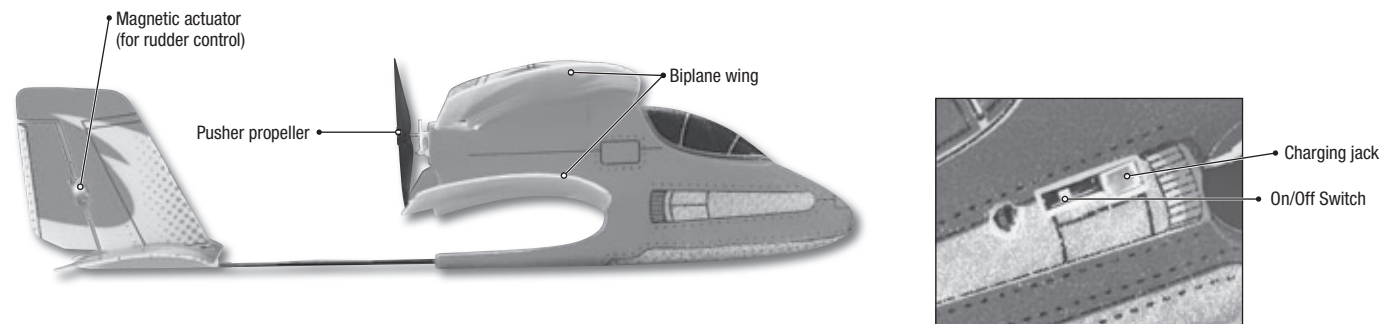

### Controller

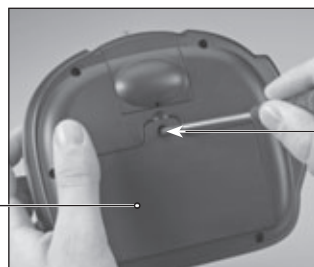
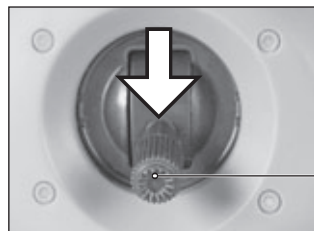
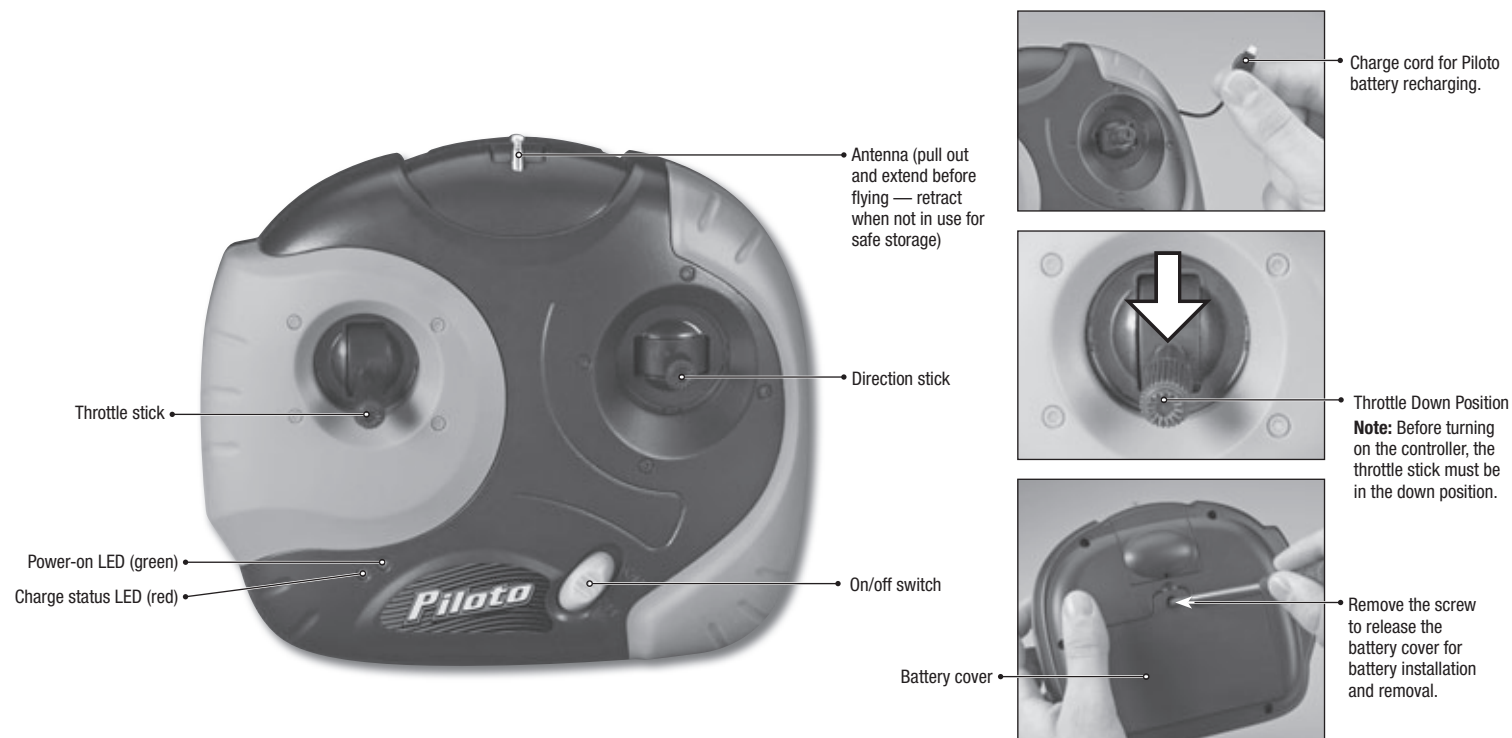

## Controller Battery Installation



1. Remove the screw from the battery cover by turning it counter-clockwise using a Phillips-head screwdriver.



2. Install 6 "AA" size batteries in the battery compartment following the polarity shown inside.



3. Replace and tighten the screw clockwise.

## Piloto Charging Procedure

**Note:** Before recharging the Piloto's LiPo battery after flying, always wait 10-15 minutes for it to cool down.

1. Turn off both the Piloto and the controller.
2. Pull out the charge cord from the back of the controller. (Pic 1).
3. Gently plug the charge cord into the Piloto (Pic. 2). DO NOT FORCE. It only inserts one way. When inserted properly, the charge cord should fit easily into the charging port. Incorrectly inserting the charge cord will damage the Piloto and may create a hazard.
4. Push the controller's power switch to the ON position (Pic. 3).
5. The green Power-on LED and red Charge Status LED will both glow (Pic. 4).
6. Charging is complete when the red Charge Status LED goes out.
7. Push the controller's power switch to the OFF position and remove the charge cord from the Piloto.

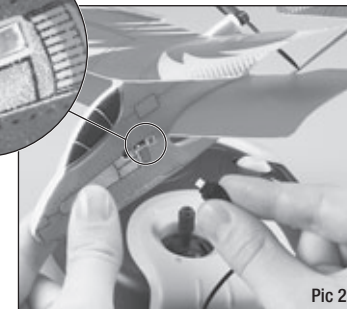
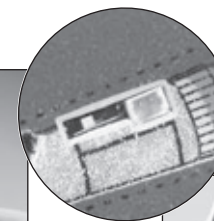

The Piloto can fly for about 3-5 minutes after 10-15 minutes of charging.

## Flying Your Piloto

With the throttle (left) stick in the down position, move the controller's power switch to the ON position. The green Power-on LED will light.

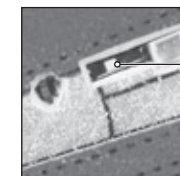

Then, set the Piloto's ON/OFF switch to ON.

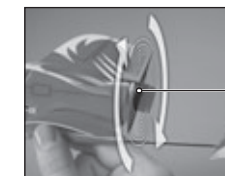

Keep fingers, hair, clothing and all other objects away from the spinning propeller.

## 1. HOW TO LAUNCH:

- An ideal flying site is an open, uncluttered room that measures approximately 20 ft (6 m) wide x 20 ft (6 m) long x 8 feet (2.5 m) high.

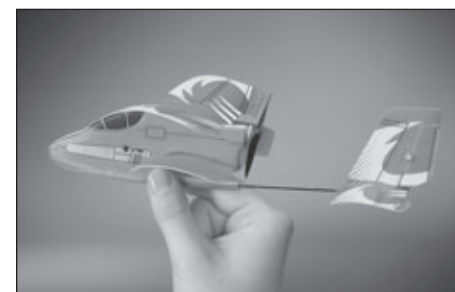

With one hand, grip the Piloto at the bottom of the fuselage



With the other hand, slowly move the controller's throttle (left) stick from the down position to halfway up.

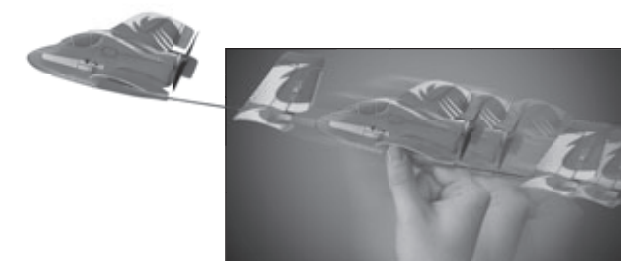

Now gently toss the Piloto into the air, at a slight upward angle. The Piloto performs best in still conditions. If you detect any air movement, launch into the direction air is moving from.