

Revell

KIT 5625

85562510200

B-24D LIBERATOR

For most of WWII, Consolidated's B-24 Liberator was the largest bomber available to the U.S. Army Air Forces. Only when the B-29 Superfortress became operational late in the war did the B-24 give up this distinction. The B-24 operated in every theater of the war by the USAAF, and the British also used it in large numbers.

Your Revell B-24D model features a detailed cockpit, interior and landing gear plus movable turrets and guns, optional bomb bay doors that can be open with a bomb load or closed and a highly detailed tow tractor with towbar. Authentic decal markings with nose art for two versions are also included.

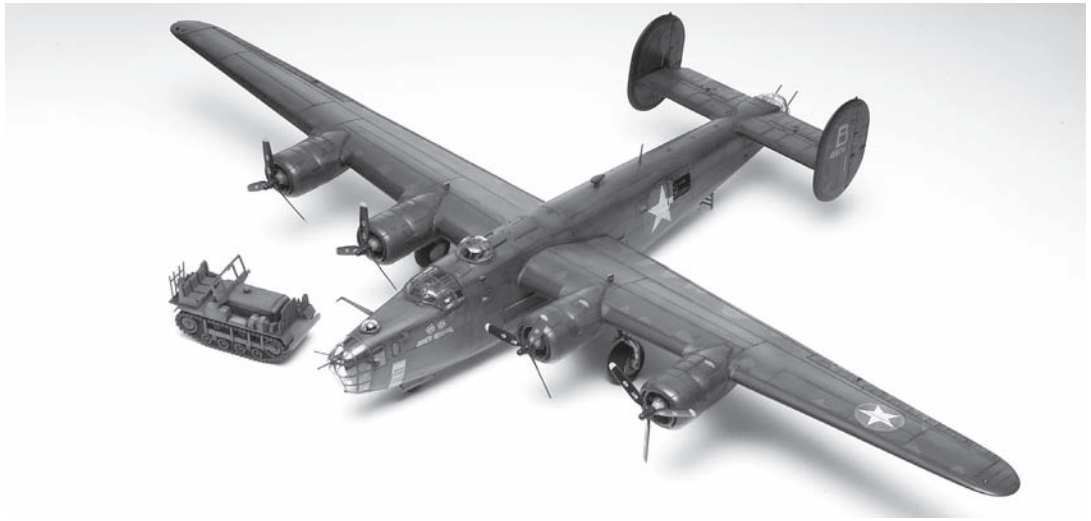

* REPEAT SEVERAL TIMES

* REPEAT PROCEDURE

* OPTIONAL PARTS

* DECAL

* ASSEMBLY CAUTION

* CEMENT TOGETHER

* REMOVE AND THROW AWAY

* DO NOT CEMENT

* A REPETER PLUSIEURS FOIS

* REPÊTEZ LE PROCÉDÉ

* PIÈCES EN OPTION

* DECAL COMANIE

* ATTENTION D'ASSEMBLÉE

* A COLLER

* A RETIRER ET JETER

* NE PAS COLLER

READ THIS BEFORE YOU BEGIN

- * Study the assembly drawings.
- * Each plastic part is identified by a number.
- * In the assembly drawings, some parts will be marked by a star (★) to indicate chrome plated plastic.
- * For better paint and decal adhesion, wash the plastic parts in a mild detergent solution. Rinse and let air dry.
- * Check the fit of each piece before cementing in place.
- * Use only cement for polystyrene plastic.
- * Scrape plating and paint from areas to be cemented.
- * Allow paint to dry thoroughly before handling parts.
- * Any unused parts may be discarded.

DECAL APPLICATION INSTRUCTIONS

1. Cut desired decal from sheet.
2. Dip decal in water for a few seconds.
3. Place wet decal on paper towel.
4. Wait until decal is movable on paper backing.
5. Place decal in position on model, face up and slide backing away.
6. Press out air bubbles with a soft damp cloth.
7. Milkyness that may appear is for better decal adhesion and will dry clear. Wipe away any excess adhesive.
8. Do not touch decal until fully dry.
9. Allow the decals 48 hours to dry before applying clear coat.

NOTE: Decals are compatible with setting solutions or solvents.

LIRE CE QUI SUIT AVANT DE COMMENCER

- * Etudier les schémas de montage.
- * Chaque pièce en plastique est identifiée par un numéro.
- * Sur les schémas de montage, certaines pièces sont marquées d'une étoile (★) pour indiquer qu'elles sont en plastique chromé.
- * Pour une meilleure prise de la peinture et des autocollants, laver les pièces en plastique avec une solution détergente peu concentrée. Les rincer et les laisser sécher à l'air.
- * Vérifier que chaque pièce s'ajuste bien avant de la coller en place.
- * N'utiliser que de la colle pour polystyrène.
- * Gratter les parties à coller pour enlever le chrome et la peinture.
- * Laisser la peinture bien sécher avant de manipuler les pièces.
- * Toute pièce inutilisée peut être jetée.

DIRECTIVES D'APPLICATION DES AUTOCOLLANTS

1. Découper l'autocollant désiré de la feuille.
2. Tremper l'autocollant dans de l'eau pendant quelques secondes.
3. Placer l'autocollant mouillé sur une serviette en papier.
4. Attendez que l'autocollant puisse être déplacé sur son support en papier.
5. Mettre l'autocollant en position sur le modèle face sur le dessus et faire glisser le support pour l'enlever.
6. Appuyer avec un chiffon doux humide pour éliminer les bulles d'air.
7. La substance laiteuse qui peut apparaître est destinée à améliorer l'adhésion de l'autocollant et devient incolore au séchage. Essuyer pour enlever tout excédent d'adhésif.
8. Ne pas toucher l'autocollant tant qu'il n'est pas bien sec.
9. Laisser l'autocollant sécher pendant 48 heures avant d'appliquer une couche transparente.

REMARQUE: Les autocollants sont compatibles avec les solutions de fixation ou les solvants.

This paint guide is provided to complete this kit as shown on the box.

Ce guide de peintures est fourni pour reproduire le modèle réduit qui apparaît sur la boîte.

Semi Gloss Black	<i>Noir satiné</i>
Olive Drab	<i>Gris vert</i>
Red	<i>Rouge</i>
Medium Green	<i>Vert moyen</i>
Aluminum	<i>Aluminium</i>
Zinc Chromate	<i>Vert de zinc</i>
Green	<i>Vert</i>
Yellow	<i>Jaune</i>
Neutral Gray	<i>Gris neutre</i>
Wood	<i>Bois</i>

If you have any questions or comments, call our hotline at: **(800) 833-3570**
or, please write to:

Revell Inc Consumer Service Department, 1850 Howard Street Unit A, Elk Grove Village, Illinois 60007

Be sure to include the plan number (85562510200), part number, description, your return address and phone number.

Visit our website: www.revell.com

1

COCKPIT ASSEMBLY

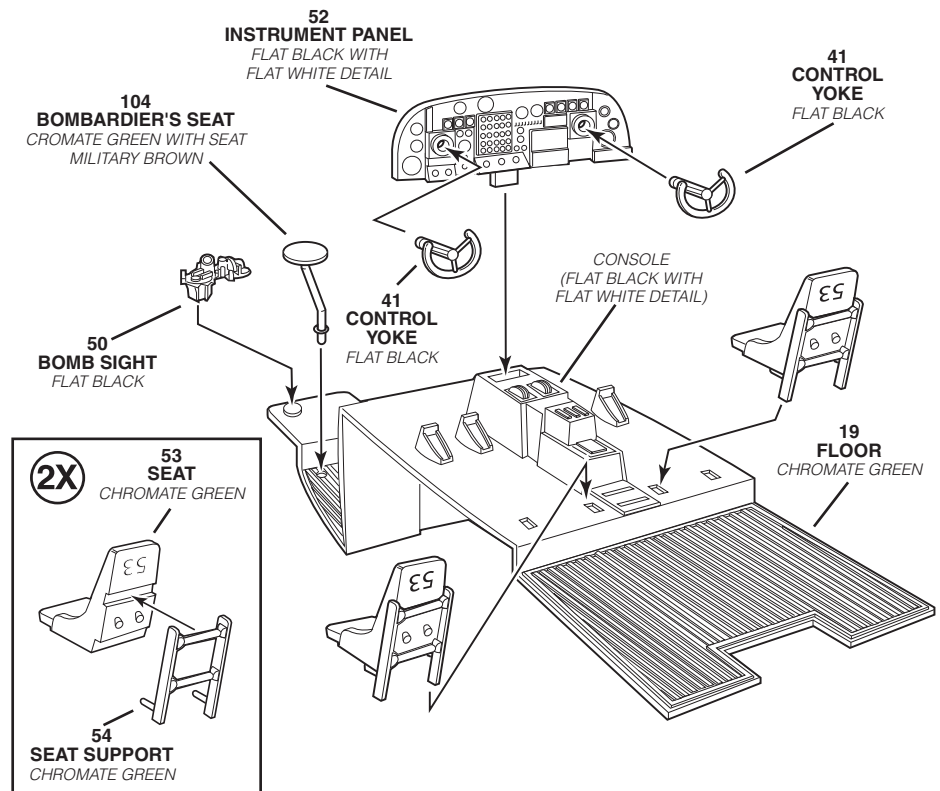
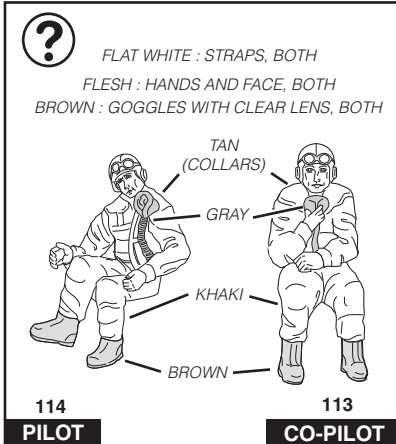
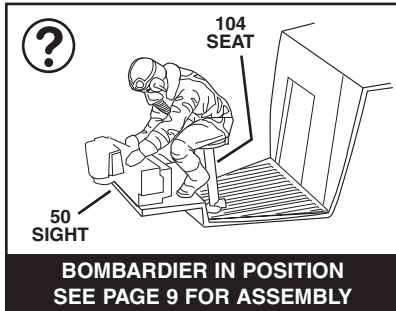

2

LEFT BOMB BAY ASSEMBLY

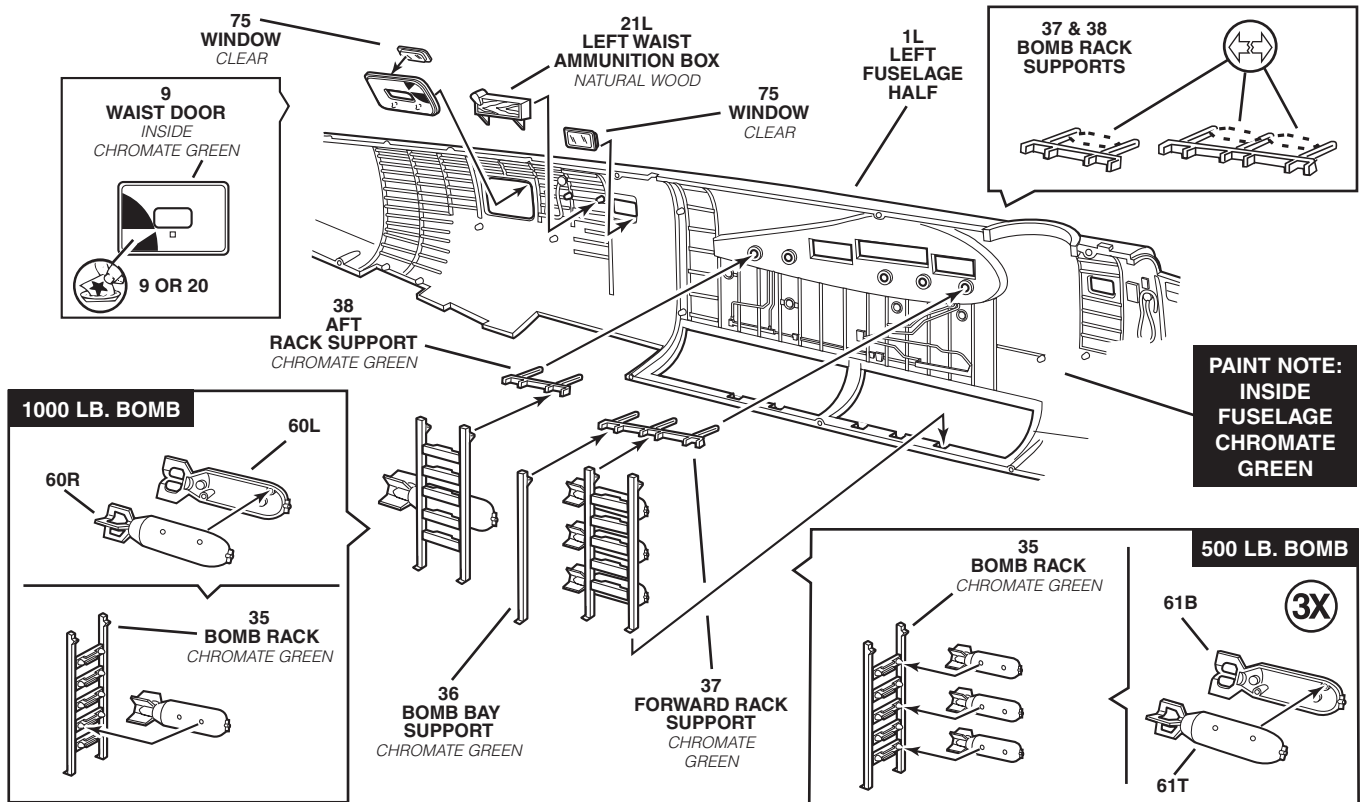

3

RIGHT BOMB BAY ASSEMBLY

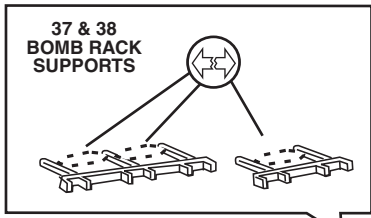

1R RIGHT FUSELAGE HALF

8 ANTENNA HOUSING
FLAT BLACK

75 WINDOWS
CLEAR

9 WAIST DOOR
INSIDE ONLY
CHROMATE GREEN



21R RIGHT WAIST AMMUNITION BOX
NATURAL WOOD

KHAKI

20 AFT BULKHEAD
CHROMATE GREEN

PAINT NOTE:
INSIDE FUSELAGE
CHROMATE GREEN

38 AFT RACK SUPPORT
CHROMATE GREEN

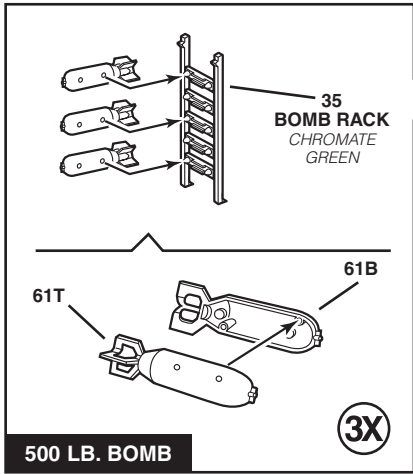

37 FORWRD RACK SUPPORT
CHROMATE GREEN

36 BOMB BAY SUPPORT
CHROMATE GREEN

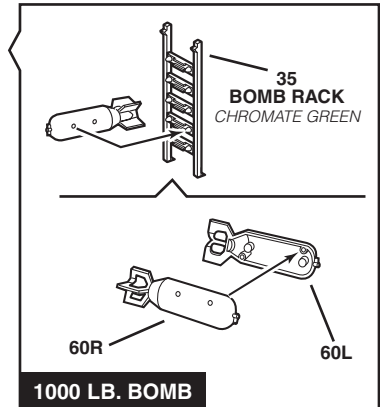

4

WAIST GUN ASSEMBLY

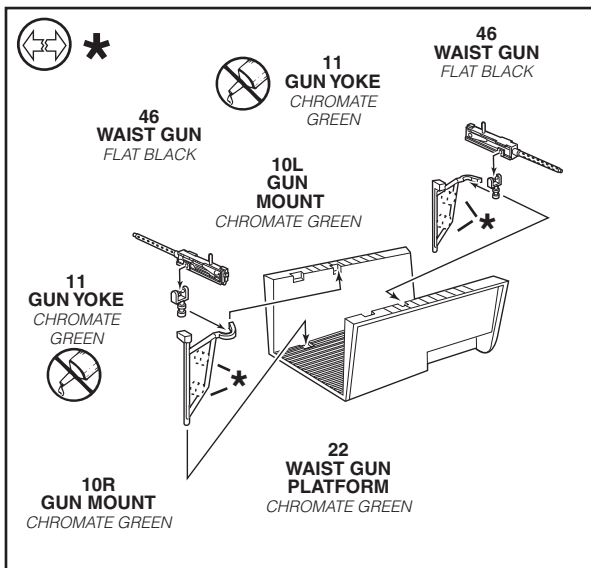

GUNNERS IN POSITION
SEE PAGE 9 FOR ASSEMBLY

7 REAR ANTENNA
SILVER

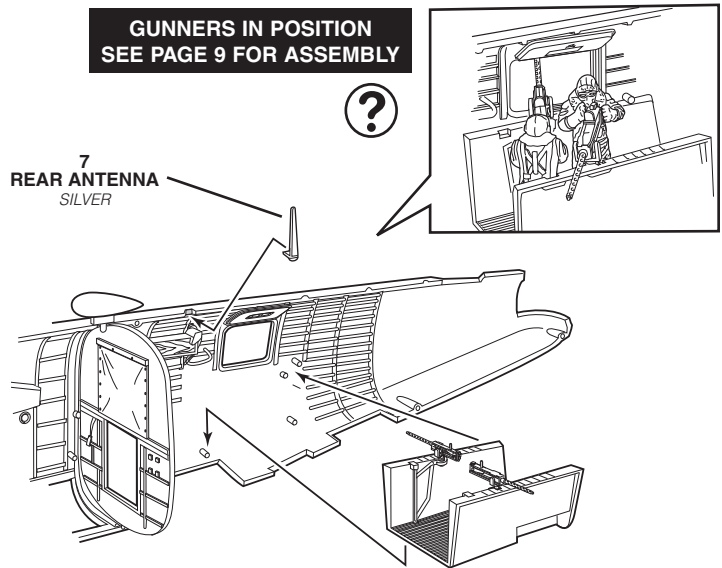

5

FORWARD FUSELAGE ASSEMBLY

RIGHT

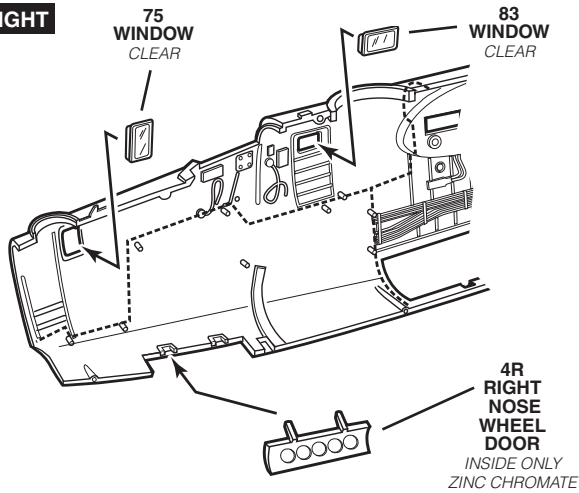

LEFT

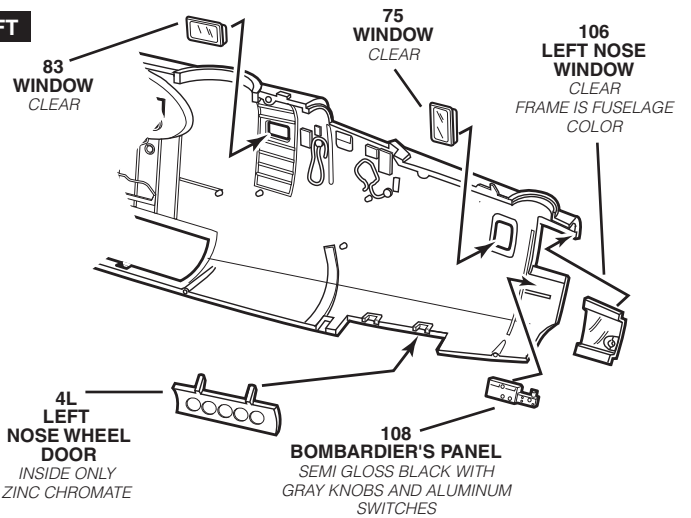

6

NOSE GEAR / FUSELAGE ASSEMBLY

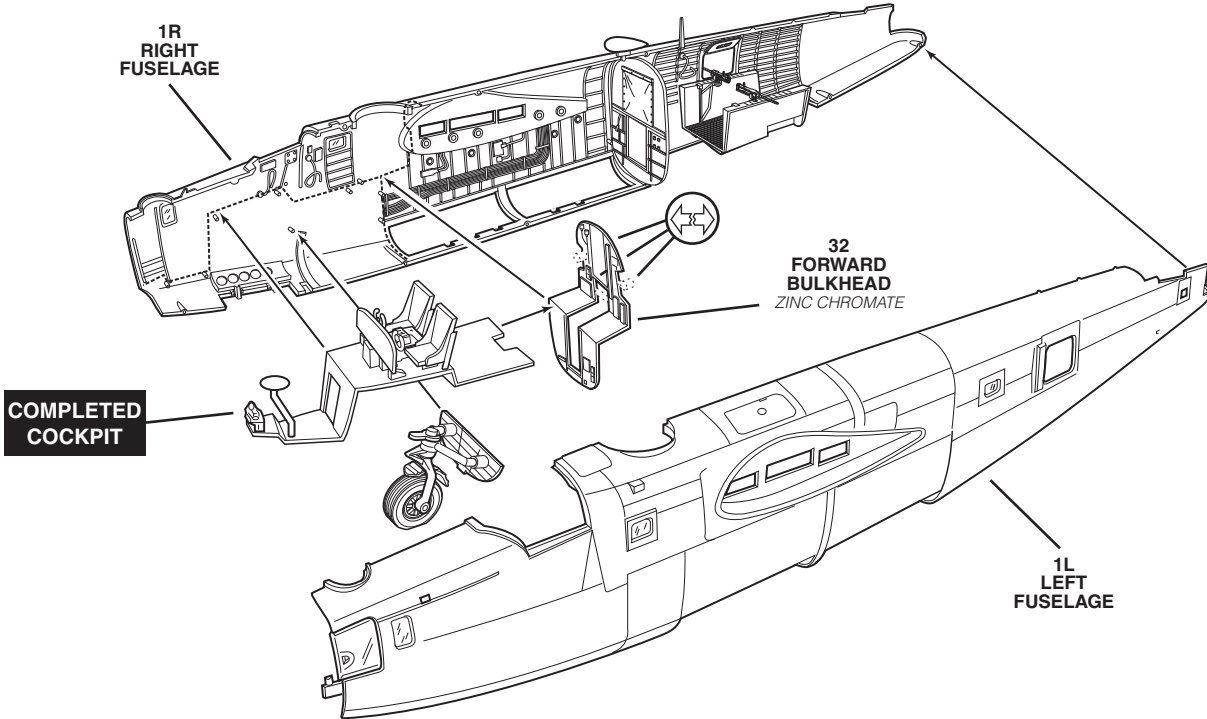
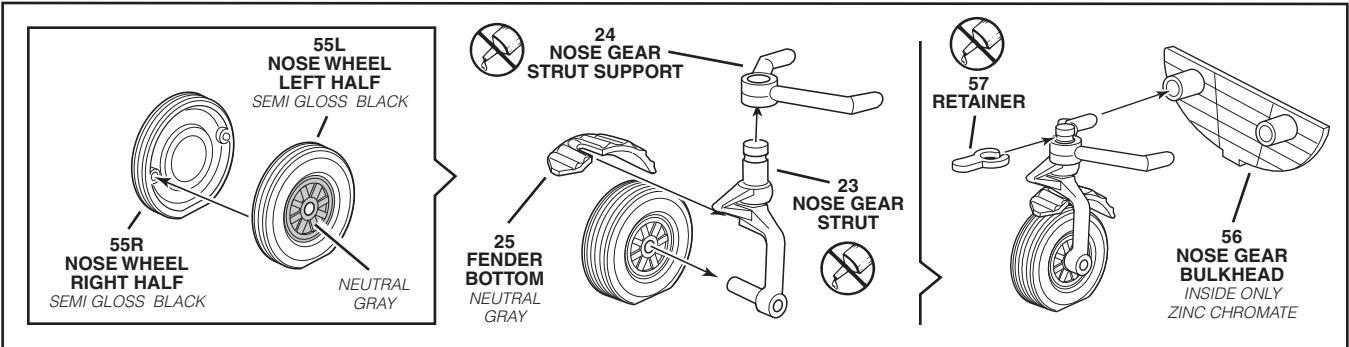

7

WING ASSEMBLY

RIGHT

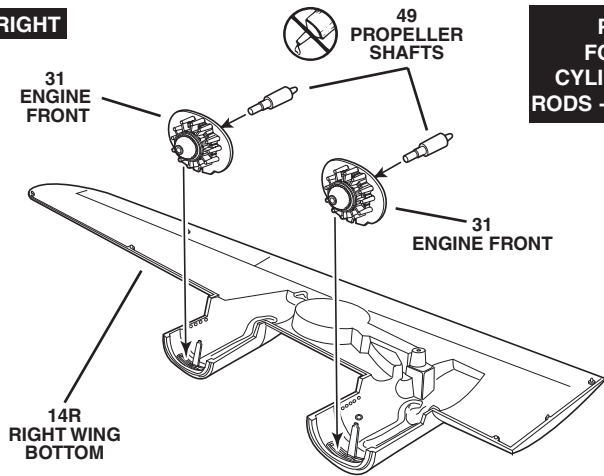

**PAINT NOTE
FOR ENGINES:
CYLINDERS - STEEL
RODS - GRAY OR BLACK**

LEFT

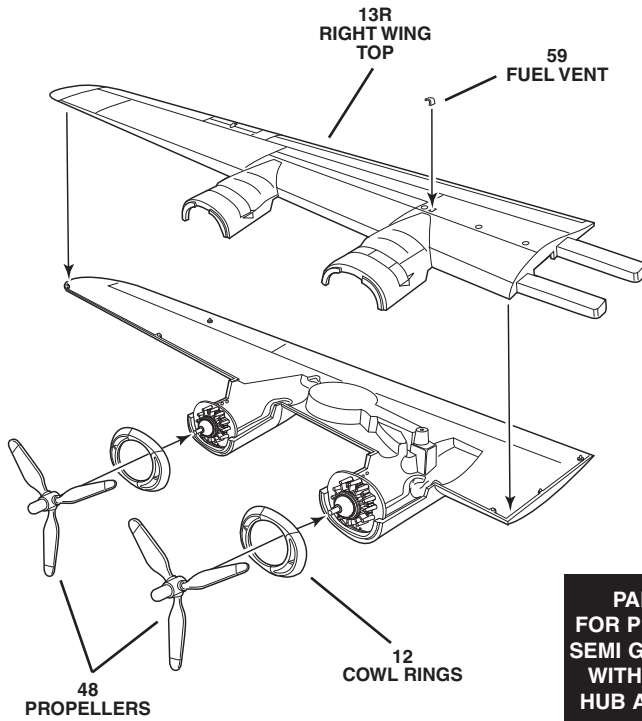
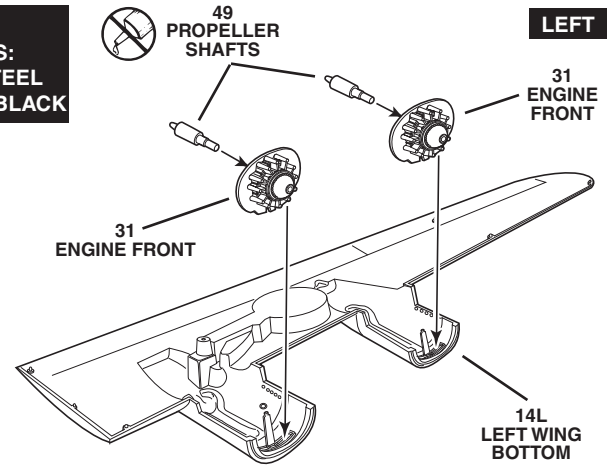

**PAINT NOTE
FOR PROPELLERS:
SEMI GLOSS BLACK
WITH ALUMINUM
HUB AND YELLOW
TIPS**

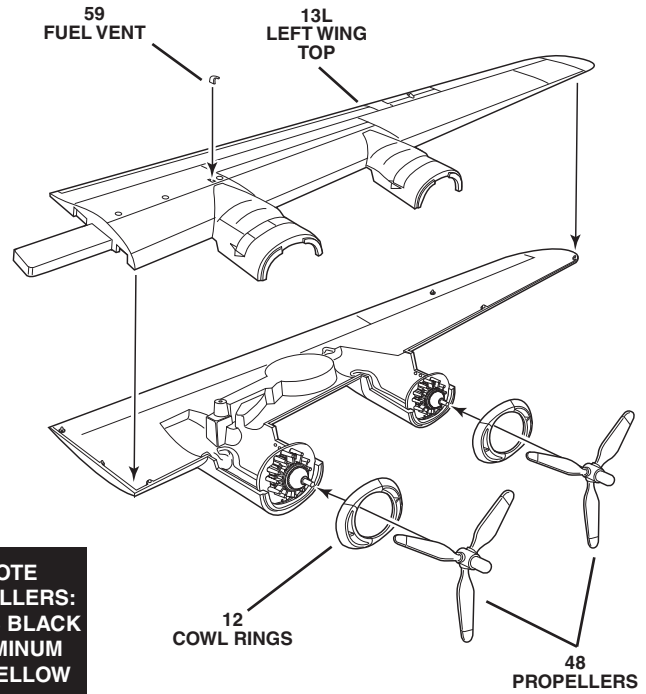

RIGHT WING TO FUSELAGE

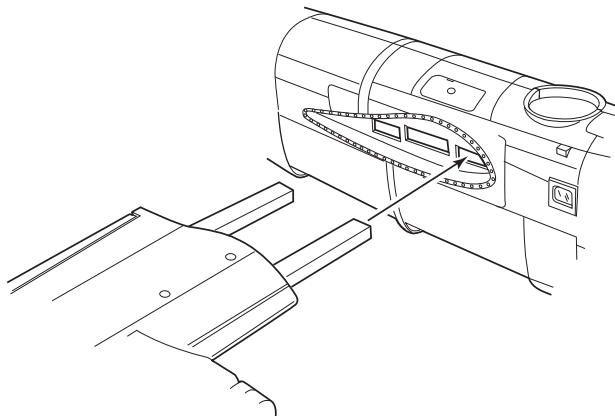

LEFT WING TO FUSELAGE

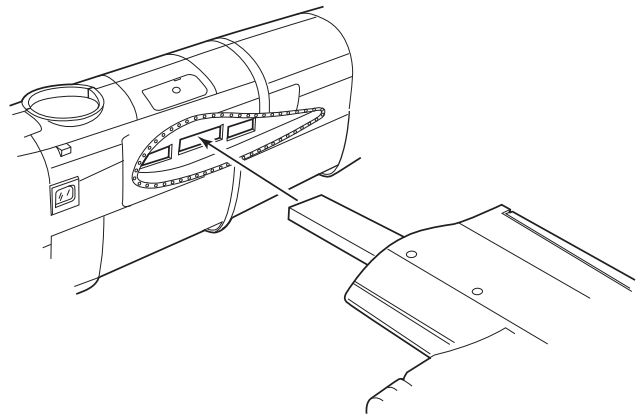

8

STRUT TO WING ASSEMBLY

LEFT MAIN LANDING GEAR

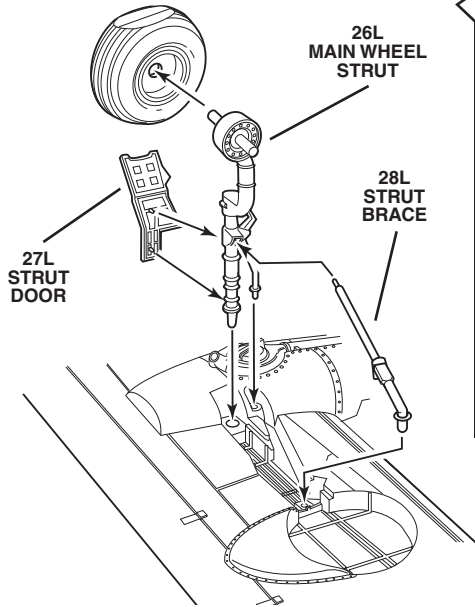

2X

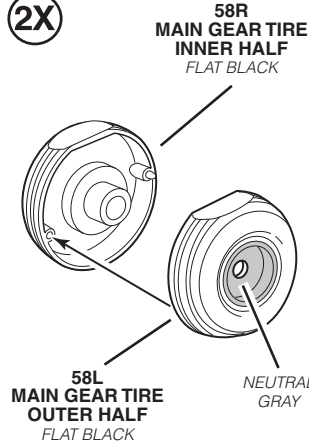

RIGHT MAIN LANDING GEAR

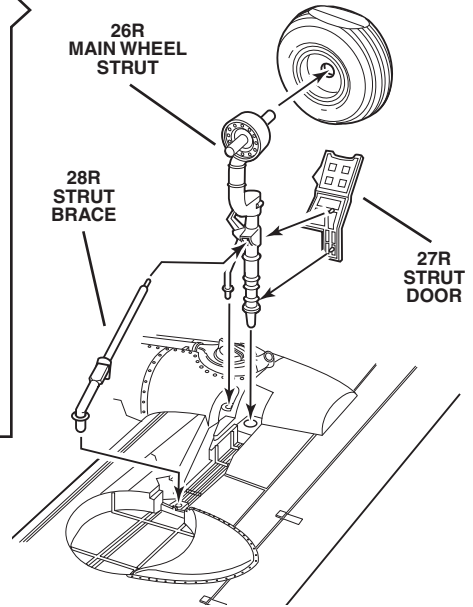

PAINT NOTE:
STRUT ASSEMBLIES
AND WHEEL WELLS ARE
PAINTED FUSELAGE
COLOR

9

TAIL GUN ASSEMBLY

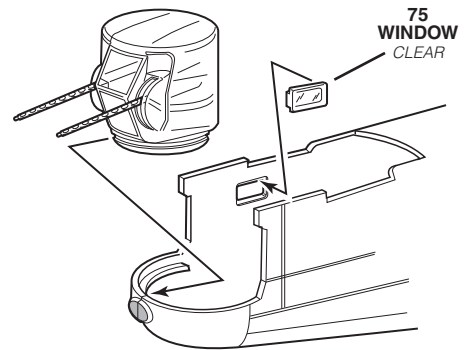
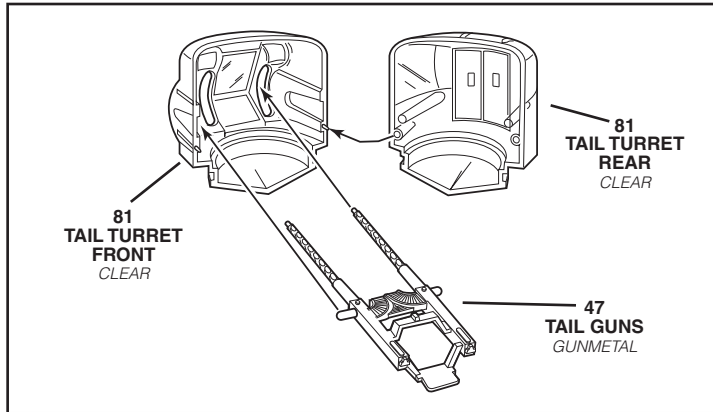

10

STABILIZER ASSEMBLY

15T
HORIZONTAL STABILIZER
TOP

15B
HORIZONTAL STABILIZER
BOTTOM

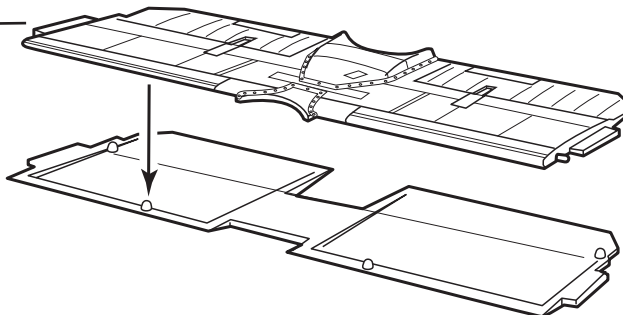

10

STABILIZER ASSEMBLY CONTINUED

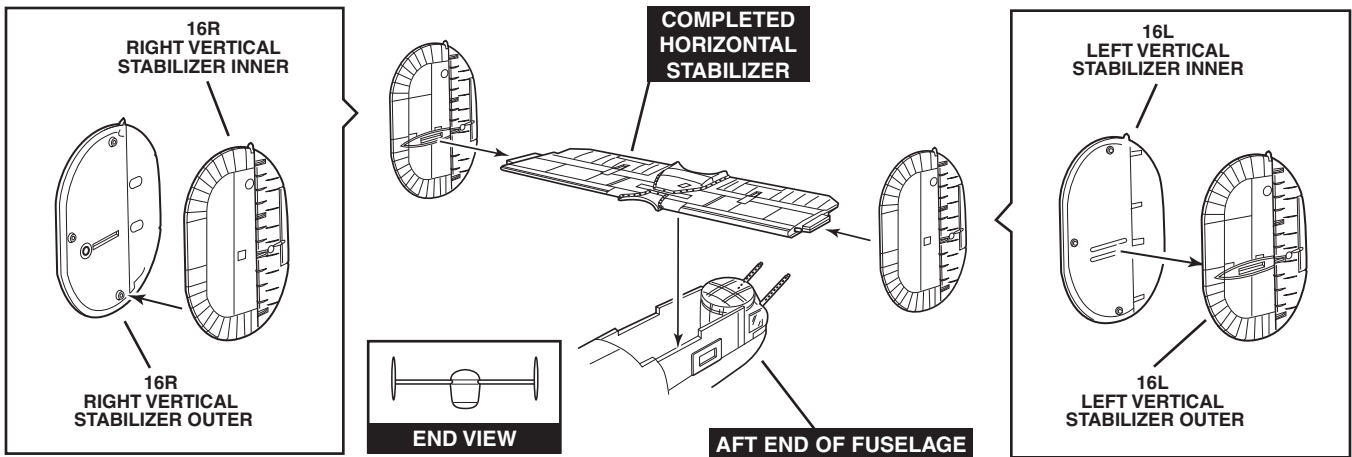

11

FRONT FUSELAGE ASSEMBLY

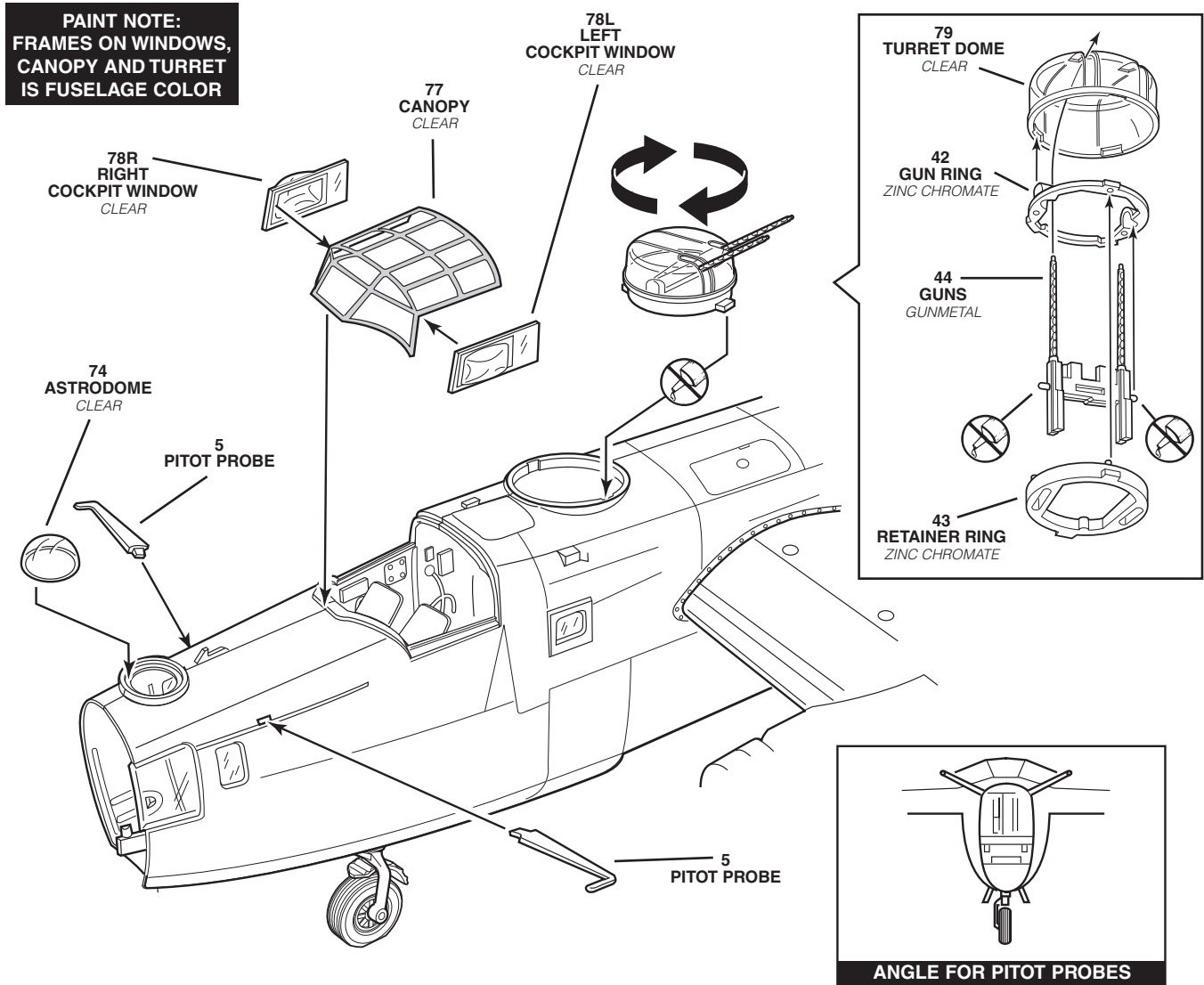

12

BOMB BAY DOOR ASSEMBLY

CLOSED

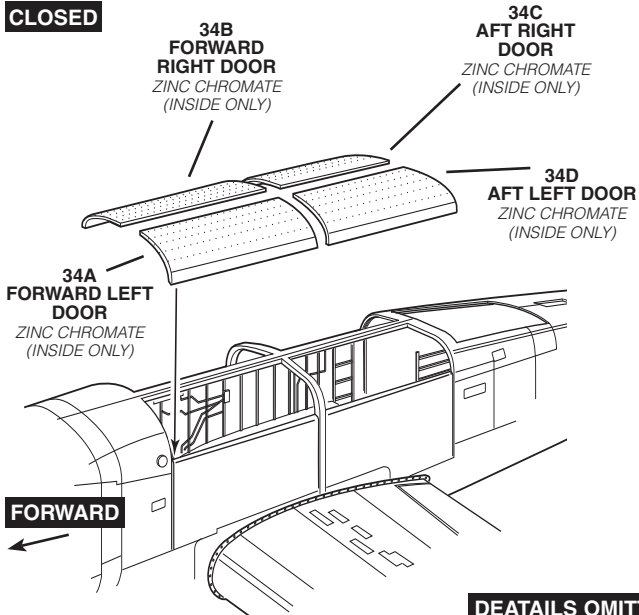

OPEN

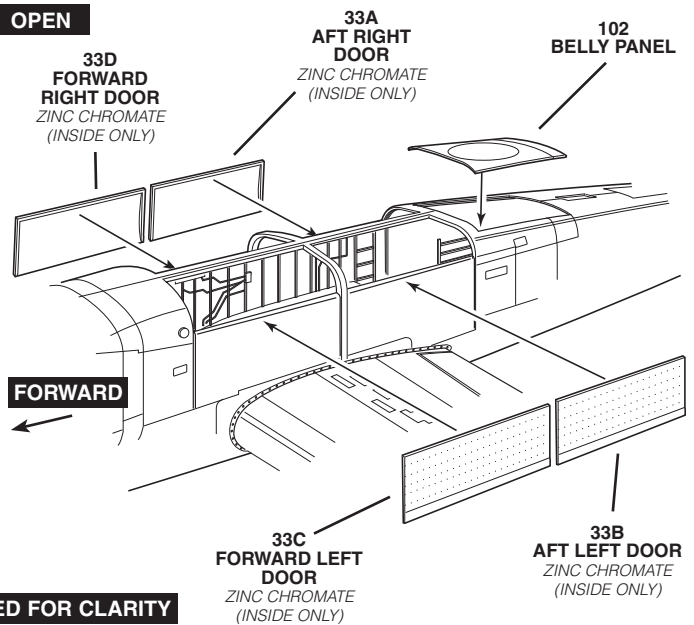

DETAILS OMITTED FOR CLARITY

13

FRONT NOSE / FINAL ASSEMBLY

A

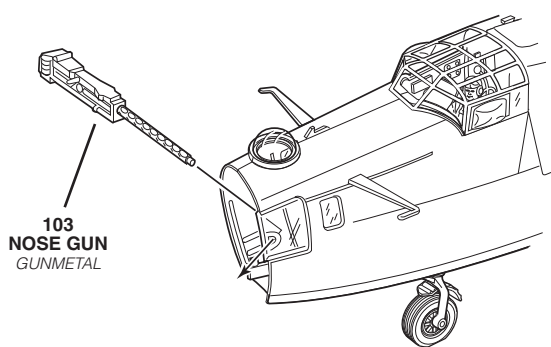

B

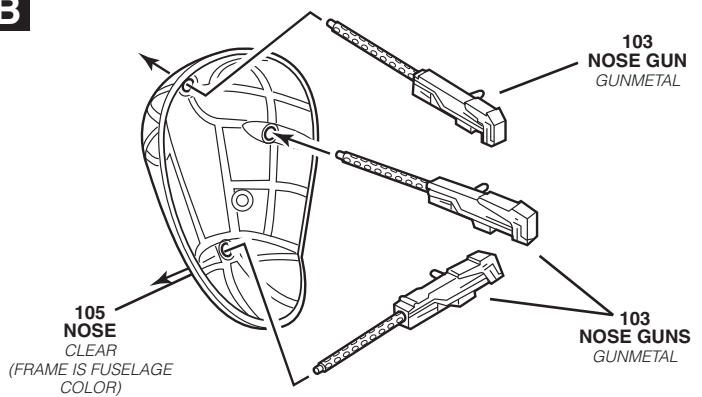

C

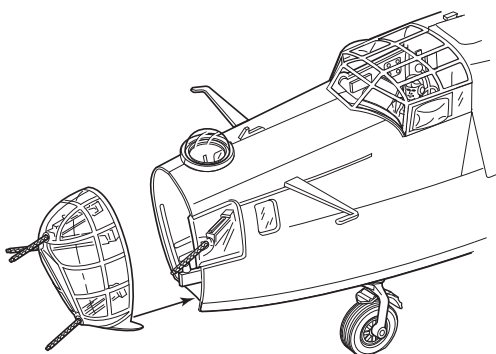

UNDERSIDE OF AFT FUSELAGE

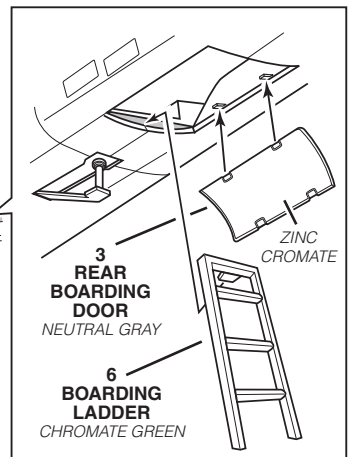
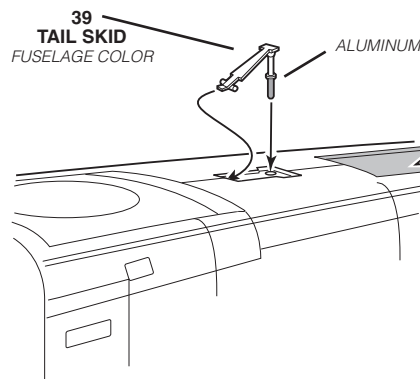

14

TRACTOR ASSEMBLY

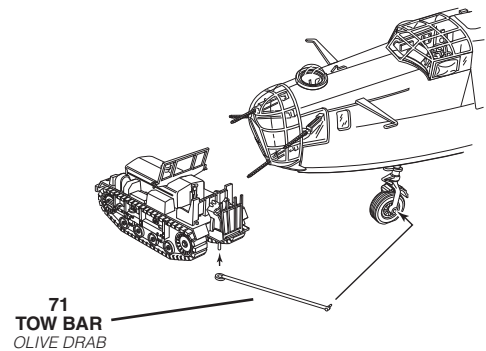
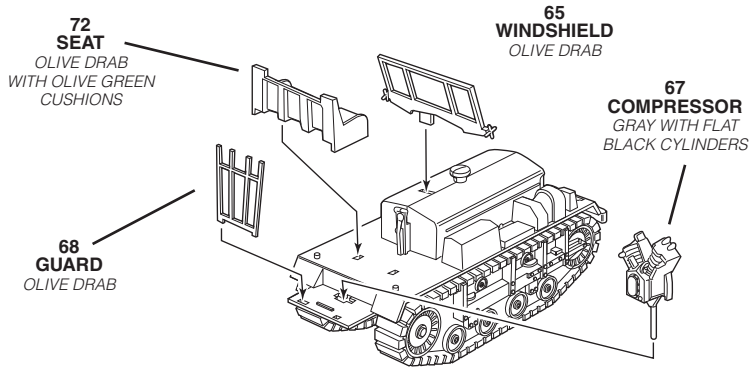
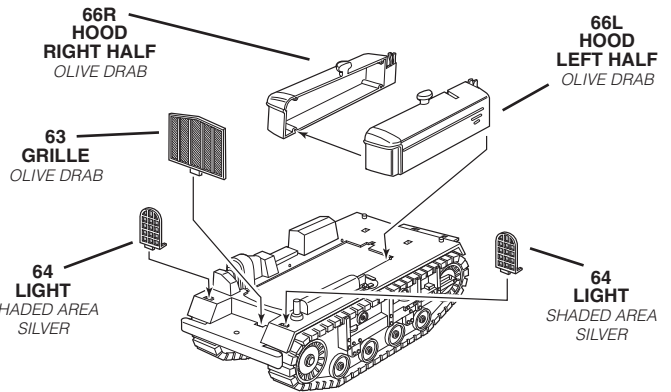
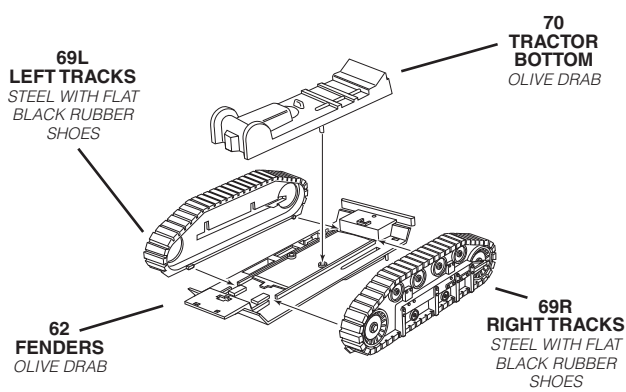

15

FIGURE ASSEMBLY

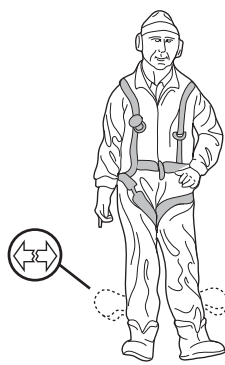

FLIGHT CREW
Uniforms - khaki,
Jackets - dark brown,
Life Vests - yellow,
Straps - dirty white, light gray,
or tan,
Buckles - silver,
Caps - brown,
Boots - brown leather with an
off-white fleece lining at the
top.

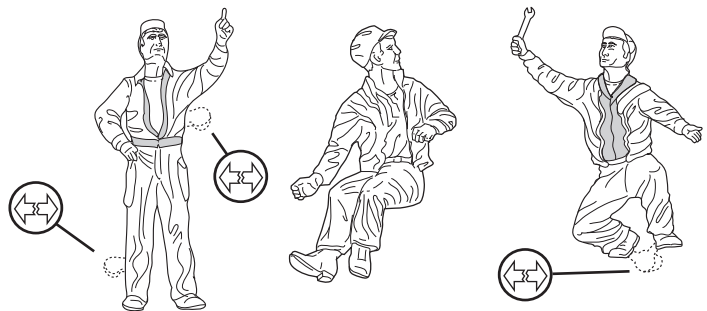

SERVICE MECHANICS Coveralls - Olive drab, gray, or khaki,
Jackets - Olive green, Caps - olive drab, Boots - brown leather.
Wrench - silver or dark gray

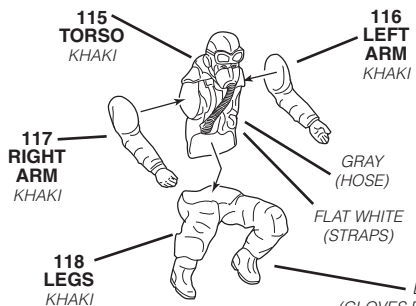

BOMBARDIER

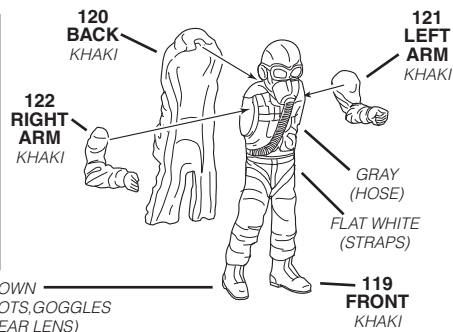

STANDING WAIST GUNNER

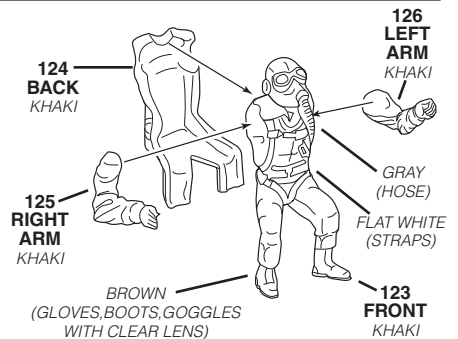

SQUATTING WAIST GUNNER

DECAL PLACEMENT

FIGHTIN' SAM, B-24D-65-CO, 42-51457, 389TH BOMB GROUP, 566TH BOMB SQUADRON, HETHEL, NORFOLK, ENGLAND , 1943-44.

Fightin' Sam carries an angry Uncle Sam figure from the Al Capp comic strip, "L'il Abner, which became the squadron's unofficial insignia. It carries an impressive scoreboard displaying its combat record with this unit.

The plane was transferred to the 801st Bomb Group and used on clandestine missions to supply underground organizations in occupied Europe. It also operated in a similar role over the Balkans, while based in Italy.

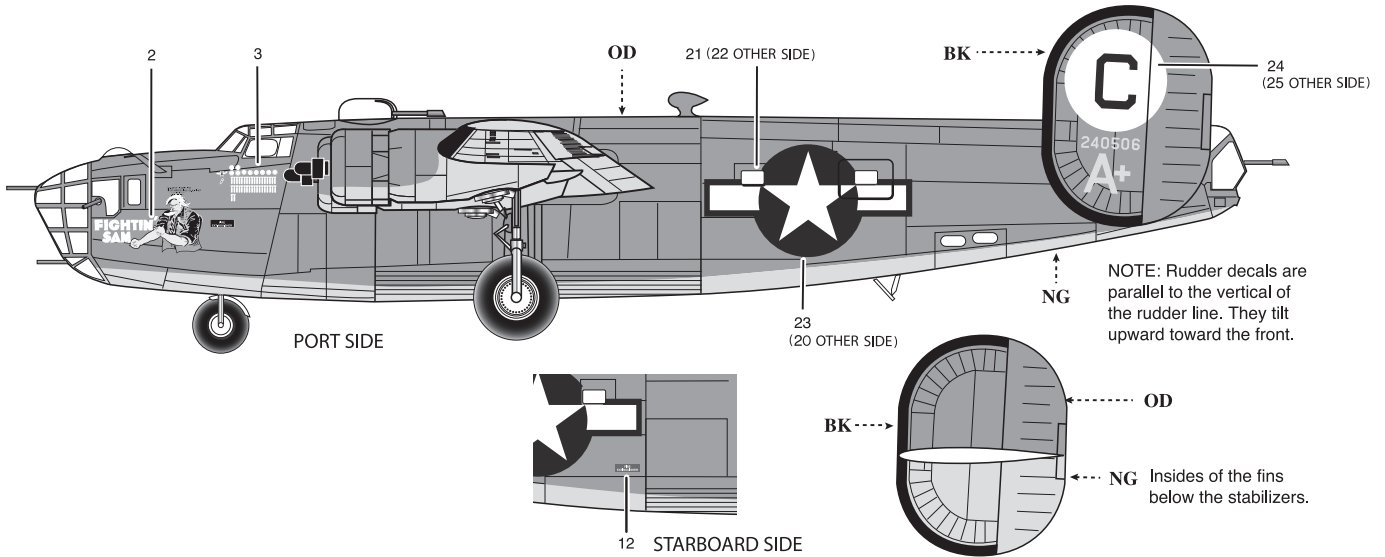

JERK'S NATURAL, B-24D-51-CO, 41-23711, 93RD BOMB GROUP, 328TH BOMB SQUADRON, HARDWICK, ENGLAND , 1943

Named after it's original pilot, John Jerstad, who flew it on five missions before he was promoted and assigned to another airplane, this plane carries the record of its colorful history. The markers represent a U-Boat, sunk in the Gulf of Mexico, five enemy fighters destroyed by the crew, and a record of it's bombing missions. Nine yellow bombs represent missions from Alconbury in 1942.

Two black bombs and fourteen red ones indicate raids flown from North Africa in night and daylight operations. Five yellow markers came from missions flown from Hardwick, in 1943. The plane participated in the famous Ploesti Oil Field raid, but was eventually lost in a mission to Austria on October 1, 1943.

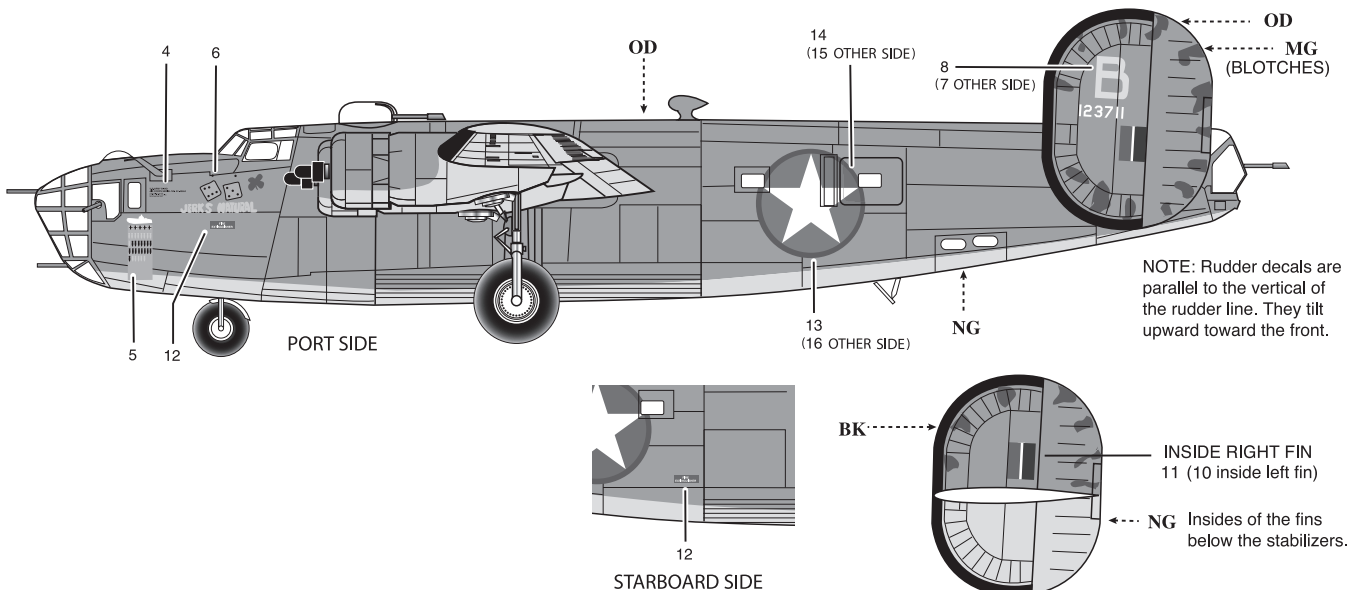

JERK'S NATURAL

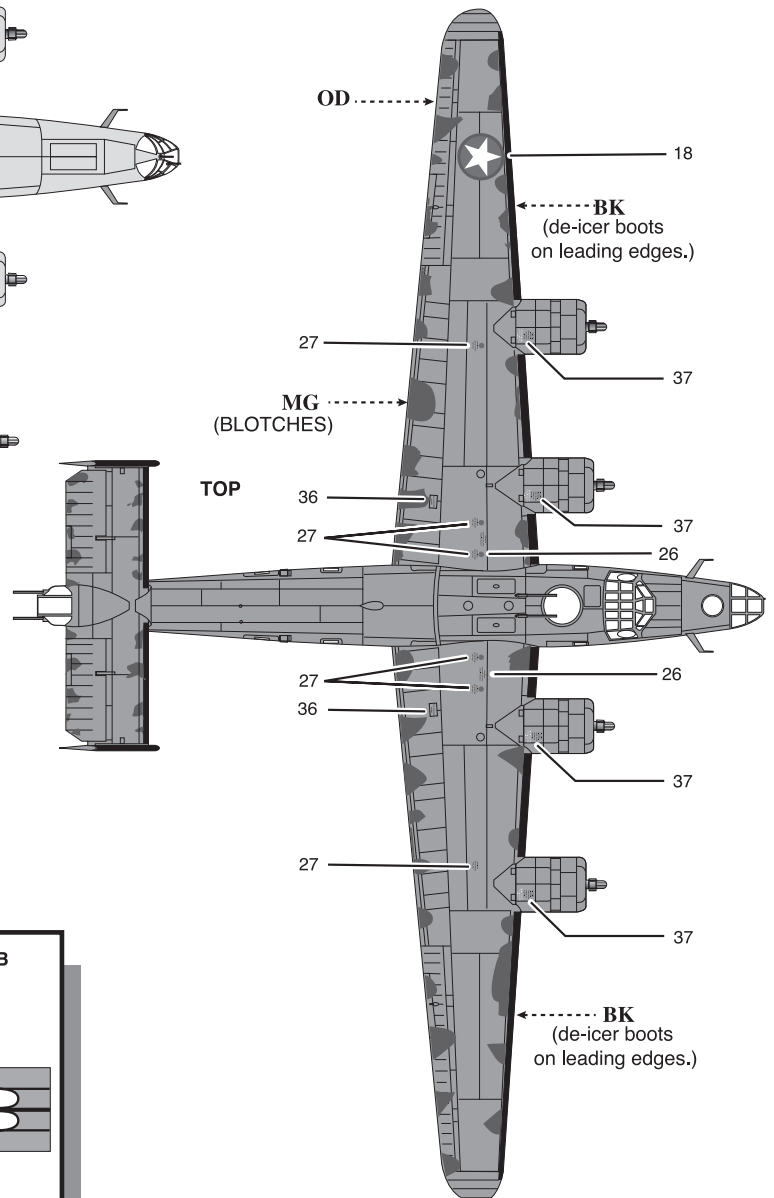
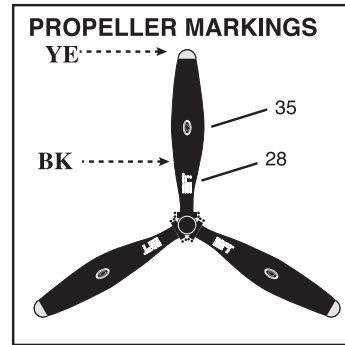
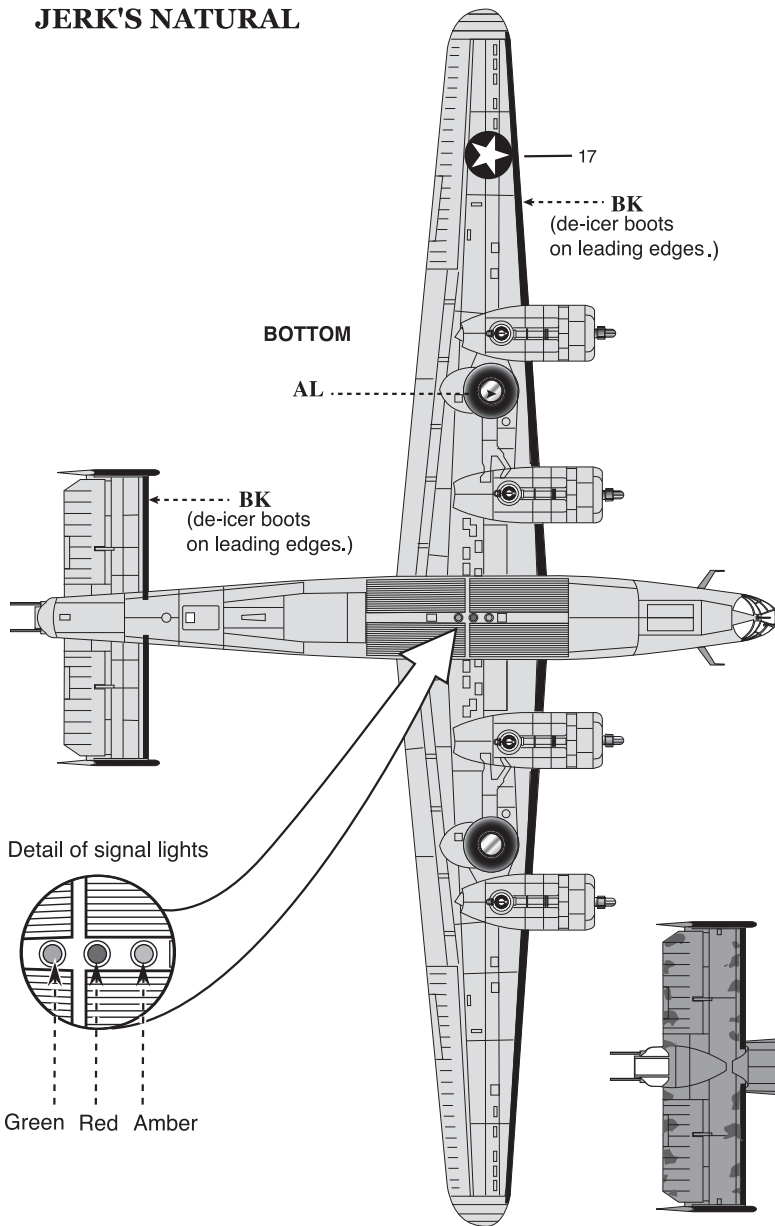

BOMB MARKINGS

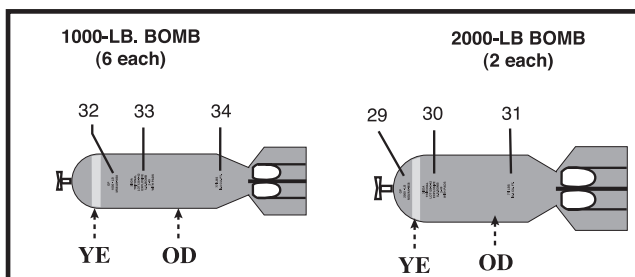

FIGHTIN' SAM

