



KIT 5089

85508900200

SPACE SHUTTLE WITH FUEL TANK AND BOOSTERS

The United States Space Transportation System (STS), commonly referred to as the Space Shuttle, provides complete Earth-to-orbit and return capabilities with versatility unmatched in the world. The Space Shuttles have flown a total of 132 missions since the very first launch which took place on April 12, 1981. The Space Shuttle program will be scheduled for retirement in 2011. Your Monogram model features a display stand to hold launch ready Shuttle with fuel tank and booster rockets, a detailed fully opening cargo bay with optional satellite payload assemblies and authentic NASA markings for six different Space Shuttles covering multiple variants.

*** REPEAT SEVERAL TIMES**** A REPETER PLUSIEURS FOIS**** REPEAT PROCEDURE**** RÊPÊTEZ LE PROCÈDE**** OPTIONAL PARTS**** PIÈCES EN OPTION**** DECAL**** DECAL COMANIE**** ASSEMBLY CAUTION**** ATTENTION D'ASSEMBLÉE**** CEMENT TOGETHER**** A COLLER**** REMOVE AND THROW AWAY**** A RETIRER ET JETER**** DO NOT CEMENT**** NE PAS COLLER*

READ THIS BEFORE YOU BEGIN

- * Study the assembly drawings.
- * Each plastic part is identified by a number.
- * In the assembly drawings, some parts will be marked by a star (★) to indicate chrome plated plastic.
- * For better paint and decal adhesion, wash the plastic parts in a mild detergent solution. Rinse and let air dry.
- * Check the fit of each piece before cementing in place.
- * Use only cement for polystyrene plastic.
- * Scrape plating and paint from areas to be cemented.
- * Allow paint to dry thoroughly before handling parts.
- * Any unused parts may be discarded.

DECAL APPLICATION INSTRUCTIONS

1. Cut desired decal from sheet.
2. Dip decal in water for a few seconds.
3. Place wet decal on paper towel.
4. Wait until decal is movable on paper backing.
5. Place decal in position on model, face up and slide backing away.
6. Press out air bubbles with a soft damp cloth.
7. Milkiness that may appear is for better decal adhesion and will dry clear. Wipe away any excess adhesive.
8. Do not touch decal until fully dry.
9. Allow the decals 48 hours to dry before applying clear coat.

NOTE: Decals are compatible with setting solutions or solvents.

LIRE CE QUI SUIT AVANT DE COMMENCER

- * Etudier les schémas de montage.
- * Chaque pièce en plastique est identifiée par un numéro.
- * Sur les schémas de montage, certaines pièces sont marquées d'une étoile (★) pour indiquer qu'elles sont en plastique chromé.
- * Pour une meilleure prise de la peinture et des autocollants, laver les pièces en plastique avec une solution détergente peu concentrée. Les rincer et les laisser sécher à l'air.
- * Vérifier que chaque pièce s'ajuste bien avant de la coller en place.
- * N'utiliser que de la colle pour polystyrène.
- * Gratter les parties à coller pour enlever le chrome et la peinture.
- * Laisser la peinture bien sécher avant de manipuler les pièces.
- * Toute pièce inutilisée peut être jetée.

DIRECTIVES D'APPLICATION DES AUTOCOLLANTS

1. Découper l'autocollant désiré de la feuille.
2. Tremper l'autocollant dans de l'eau pendant quelques secondes.
3. Placer l'autocollant mouillé sur une serviette en papier.
4. Attendez que l'autocollant puisse être déplacé sur son support en papier.
5. Mettre l'autocollant en position sur le modèle face sur le dessus et faire glisser le support pour l'enlever.
6. Appuyer avec un chiffon doux humide pour éliminer les bulles d'air.
7. La substance laiteuse qui peut apparaître est destinée à améliorer l'adhésion de l'autocollant et devient incolore au séchage. Essuyer pour enlever tout excédent d'adhésif.
8. Ne pas toucher l'autocollant tant qu'il n'est pas bien sec.
9. Laisser l'autocollant sécher pendant 48 heures avant d'appliquer une couche transparente.

REMARQUE: Les autocollants sont compatibles avec les solutions de fixage ou les solvants.

This paint guide is provided to complete this kit as shown on the box.

Ce guide de peintures est fourni pour reproduire le modèle réduit qui apparaît sur la boîte.

Aluminum	Aluminum
Blue	Bleu
Burnt Orange	Brulé Orange
Dark Gray	Gris foncé
Flat White	Blanc mat
Gold	Or
Gray	Gris
Light Blue	Bleu clair
Semi Gloss Black	Noir satiné
Steel	Acier

**If you have any questions or comments, call our hotline at: (800) 833-3570
or, please write to:**

Revell Inc Consumer Service Department, 1850 Howard Street Unit A, Elk Grove Village, Illinois 60007

Be sure to include the plan number (85508900200), part number, description, your return address and phone number.

Visit our website: www.revell.com

1

BASE ASSEMBLY

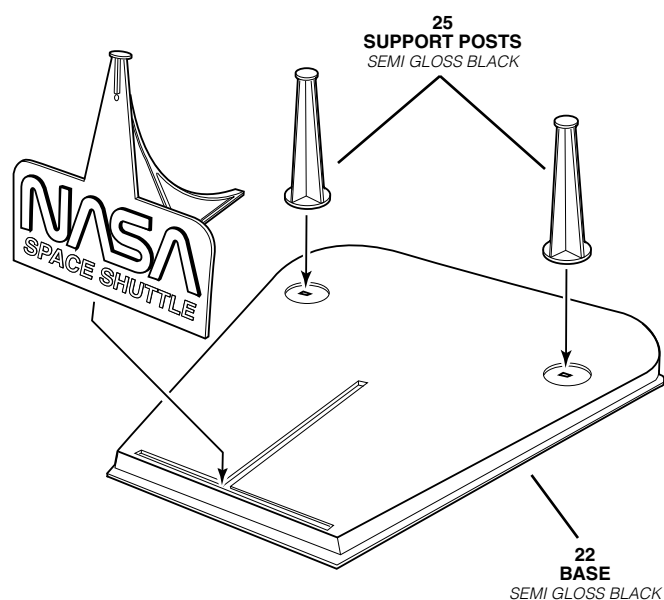
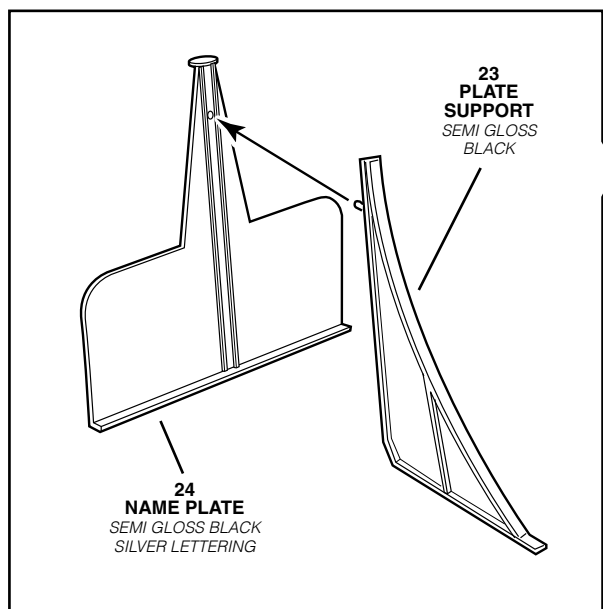

2

TANK ASSEMBLY

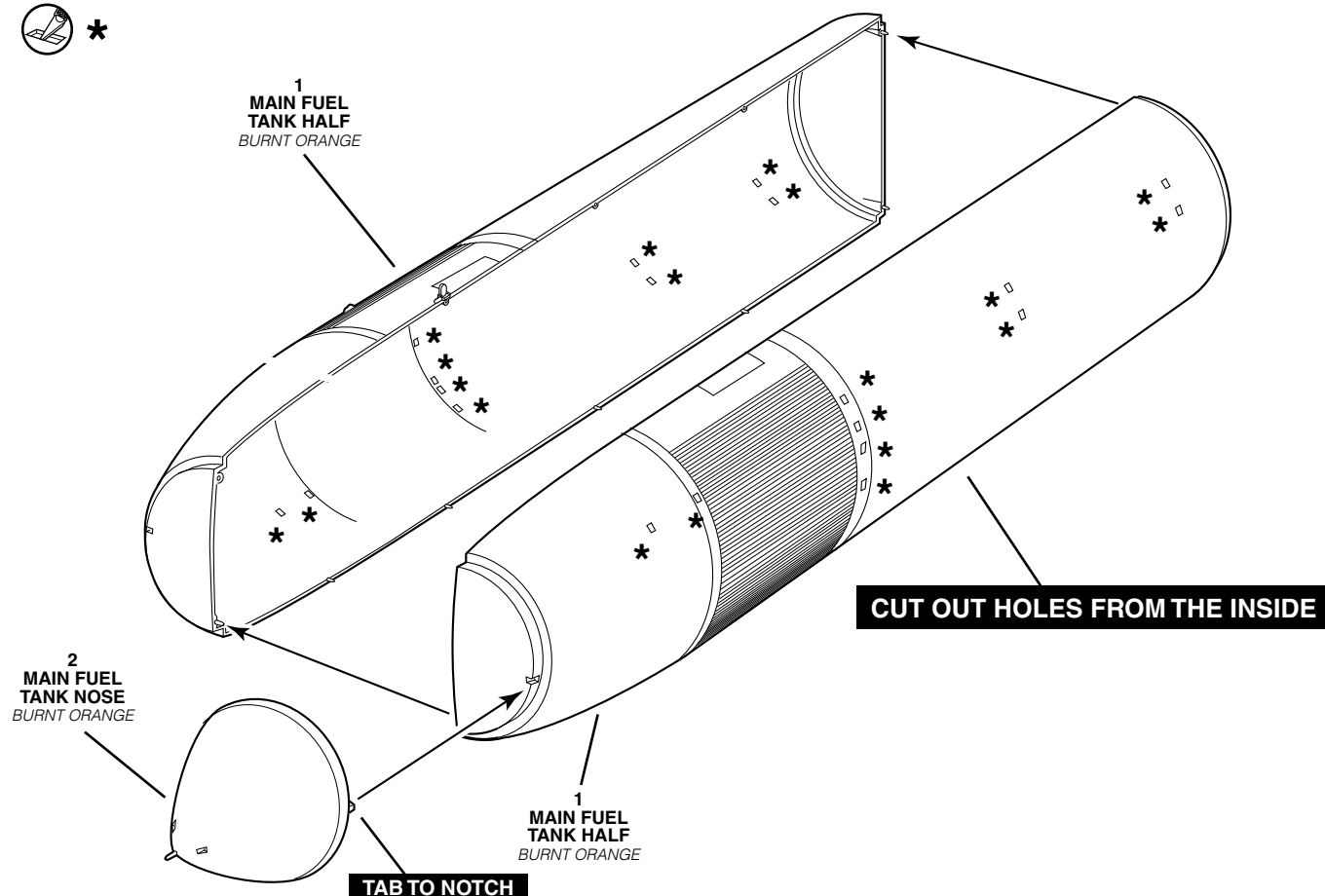

2

TANK ASSEMBLY CONTINUED

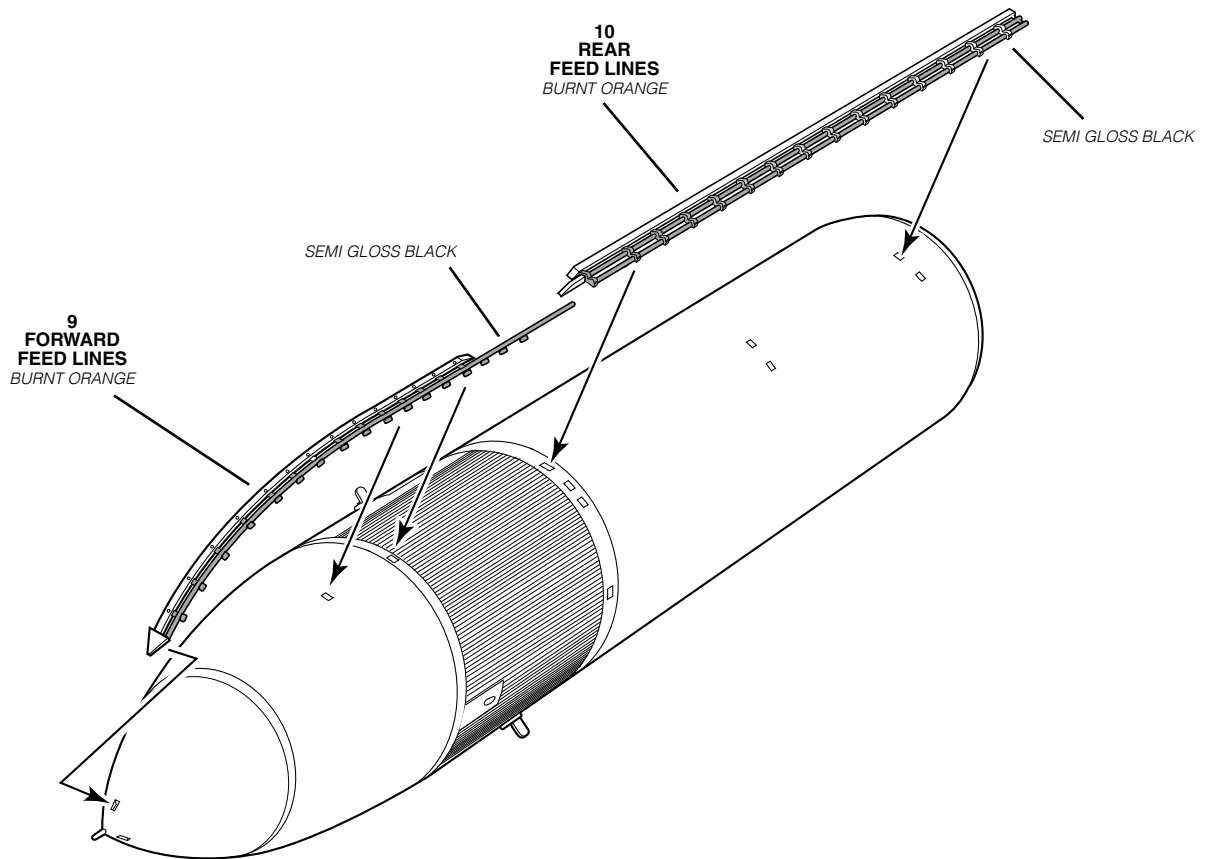

3

TANK BOTTOM ASSEMBLY

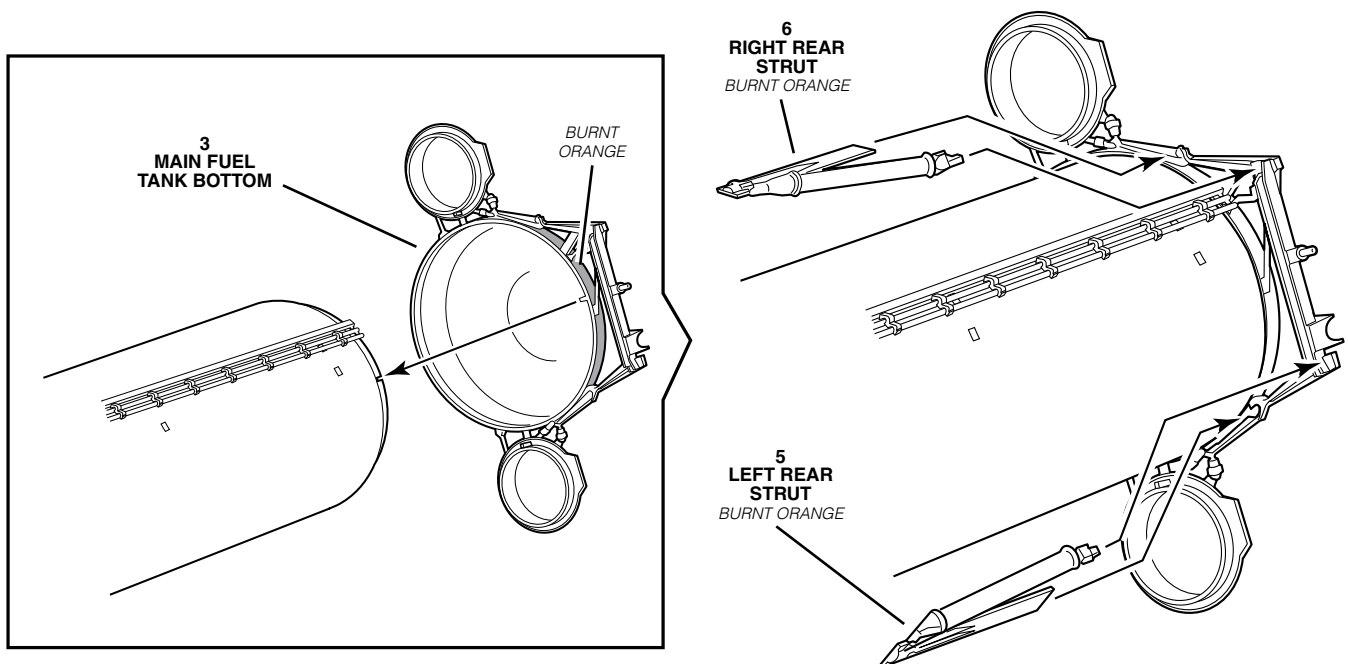

4

TANK SUPPLY LINE ASSEMBLY

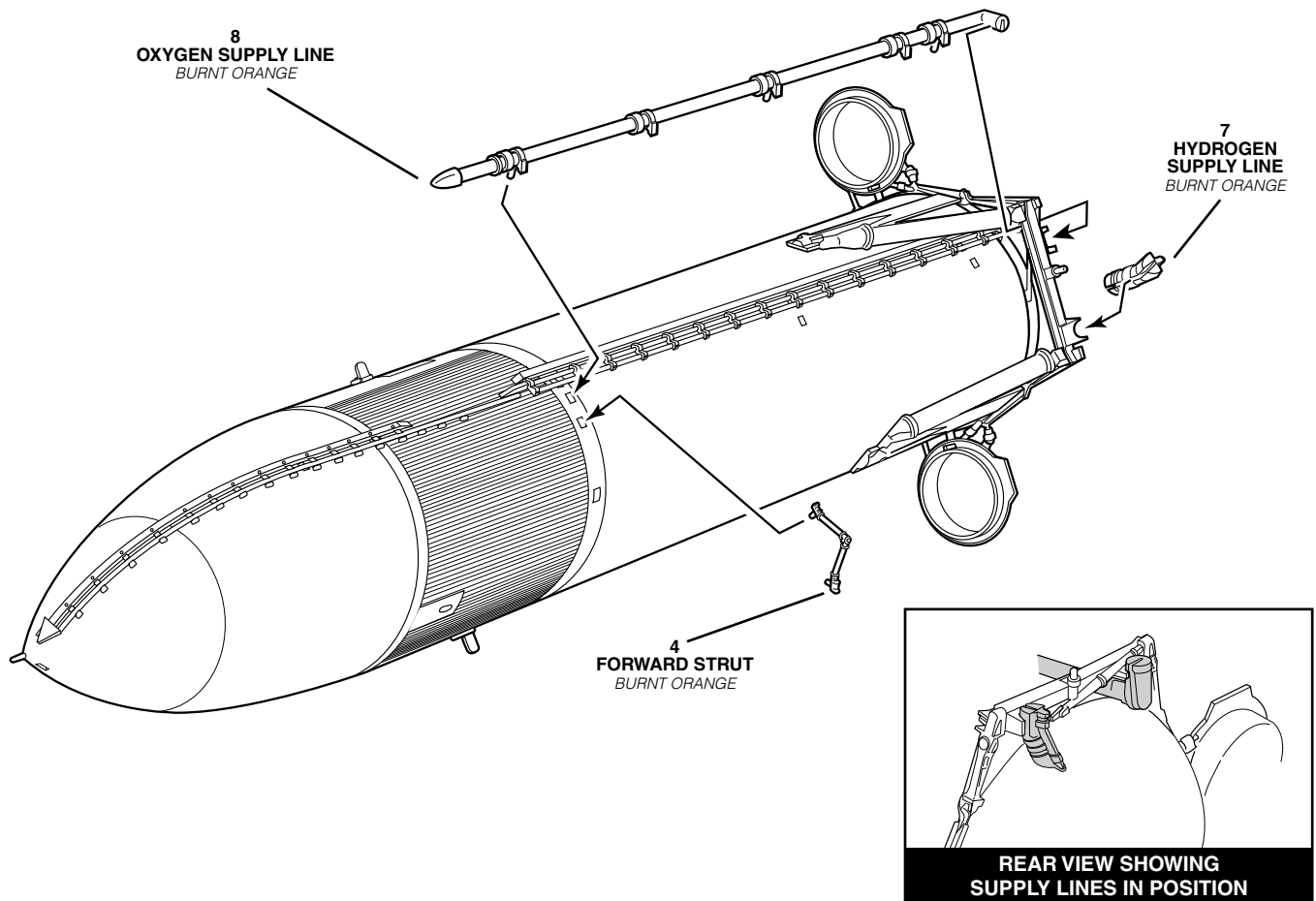

5

BOOSTER ASSEMBLY

(2X)

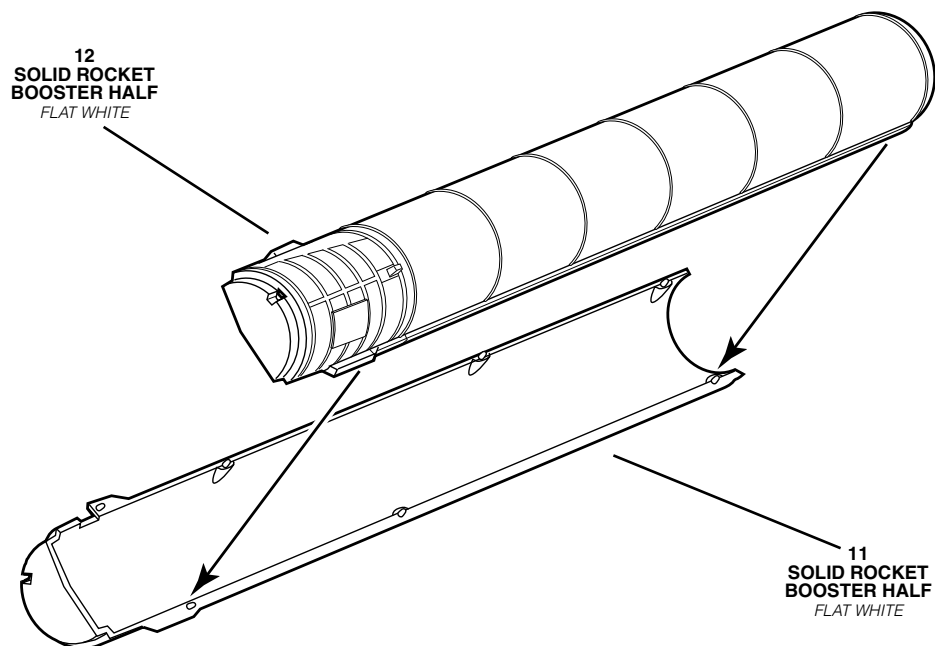

(2X)

14
SOLID ROCKET
BOOSTER HALF
FLAT WHITE

13
SOLID ROCKET
BOOSTER HALF
FLAT WHITE

18
HEAT SHIELD
STEEL

PIN TO HOLE

16
BOOSTER SKIRT
FLAT WHITE

17
EXHAUST NOZZLE
STEEL

(2X)

20
RIGHT
INTERFACE RING
FLAT WHITE

NOTCH TO TAB

NOTCH TO TAB

TAB TO NOTCH

15
NOSE CONE
FLAT WHITE

19
LEFT
INTERFACE RING
FLAT WHITE

NOTCH TO TAB

TAB TO NOTCH

15
NOSE CONE
FLAT WHITE

21
SEPARATION
MOTORS
FLAT WHITE

21
SEPARATION
MOTORS
FLAT WHITE

MOTORS
SHOWN IN PLACE

6

SHUTTLE ASSEMBLY



IF YOU DECIDE TO HAVE THE WHEELS UP. SEE STEP 8 FOR OTHER OPTION

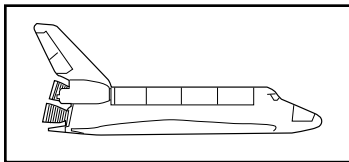

2
RIGHT
FUSELAGE
FLAT WHITE

93
ENTRY HATCH
WINDOW
CLEAR

1
LEFT
FUSELAGE
FLAT WHITE

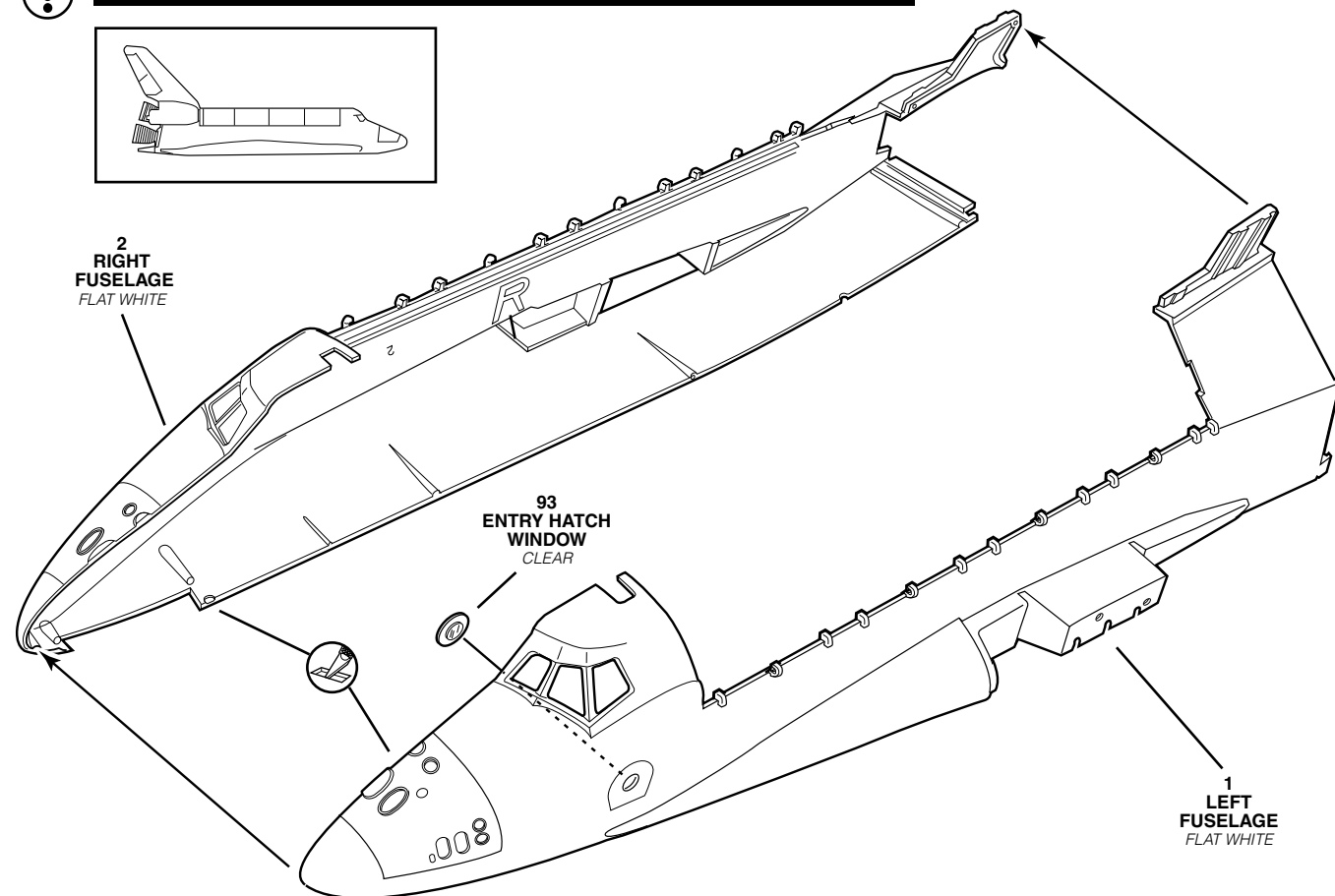

7

NOSE WHEEL DOOR ASSEMBLY

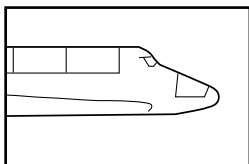

22
NOSE WHEEL DOORS
FLAT WHITE

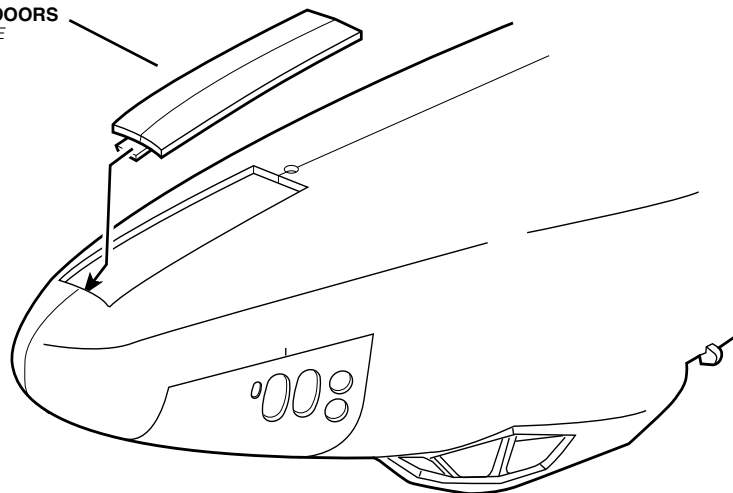



IF YOU DECIDE TO HAVE THE WHEELS DOWN

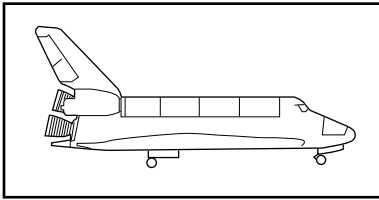

4X

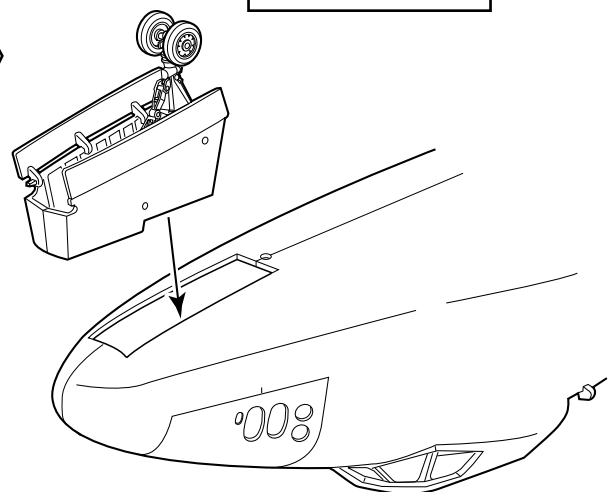
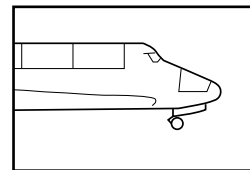
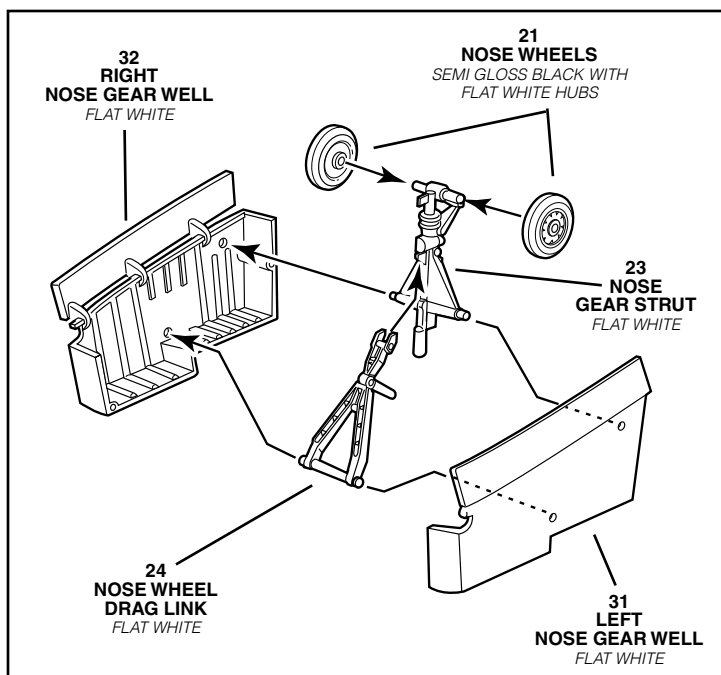
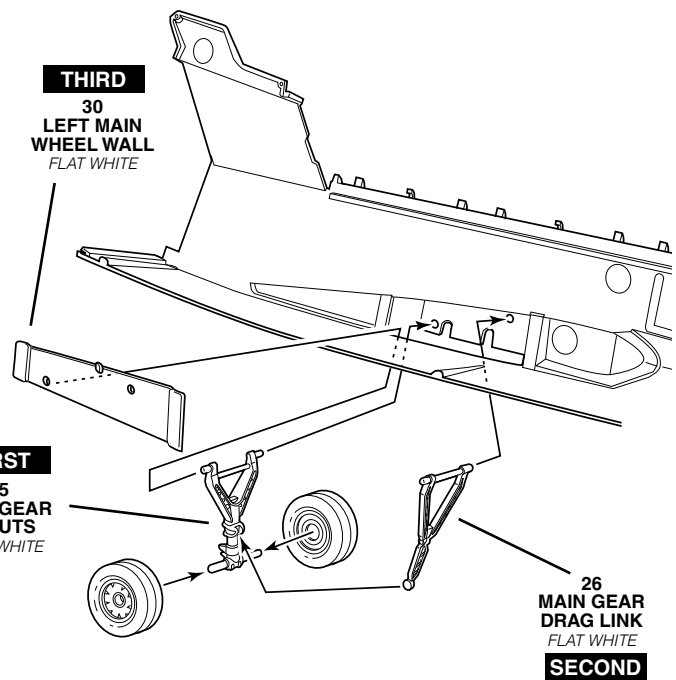
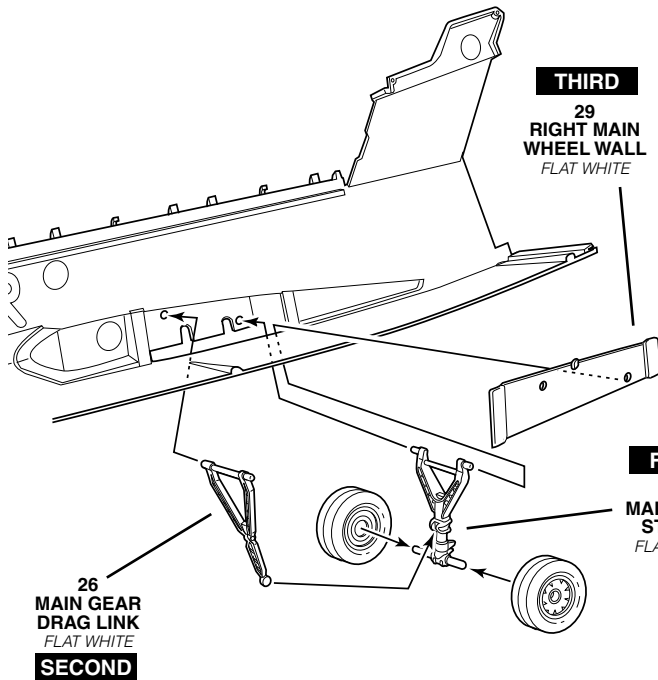
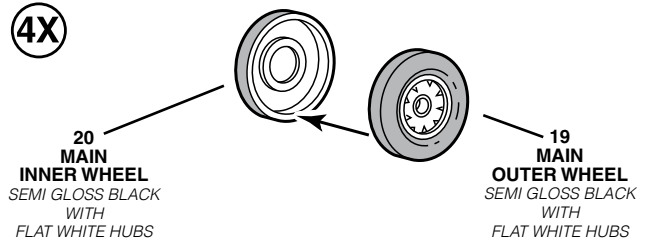

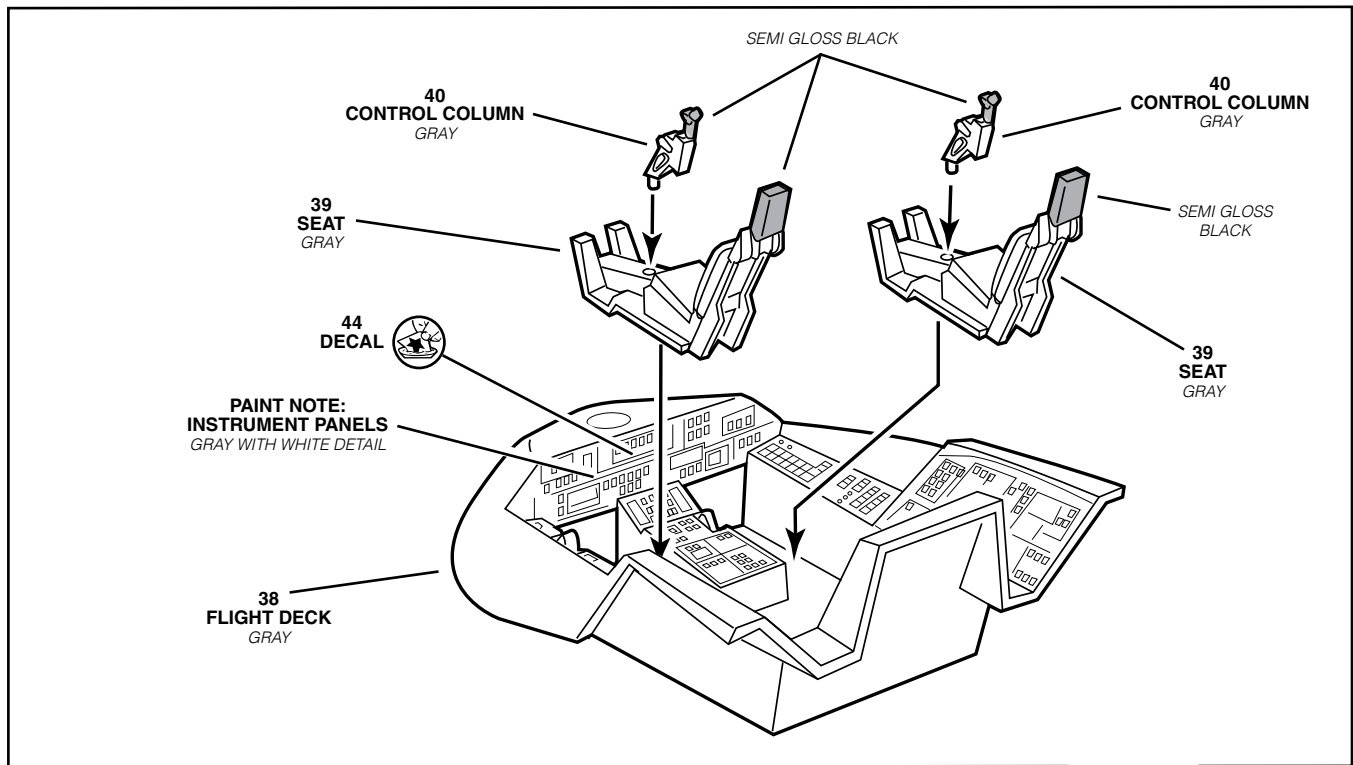
**FIRST**

95
OVERHEAD WINDOWS
CLEAR

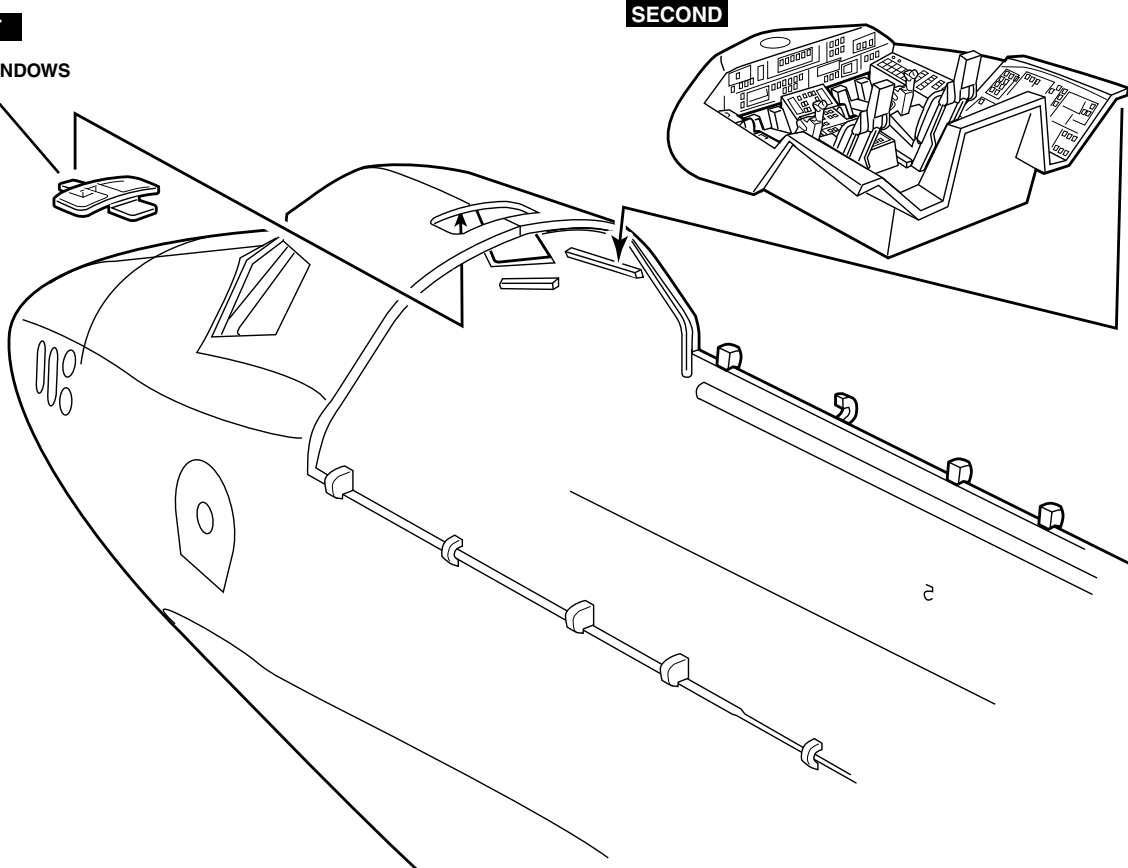
SECOND

10

FRONT BULKHEAD ASSEMBLY

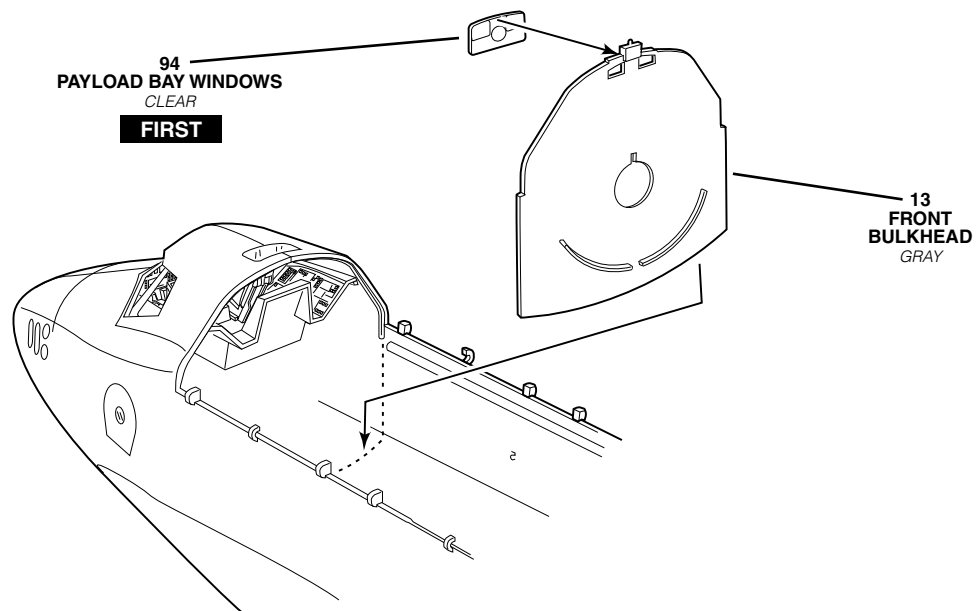

11

PAYLOAD BAY DOOR ASSEMBLY

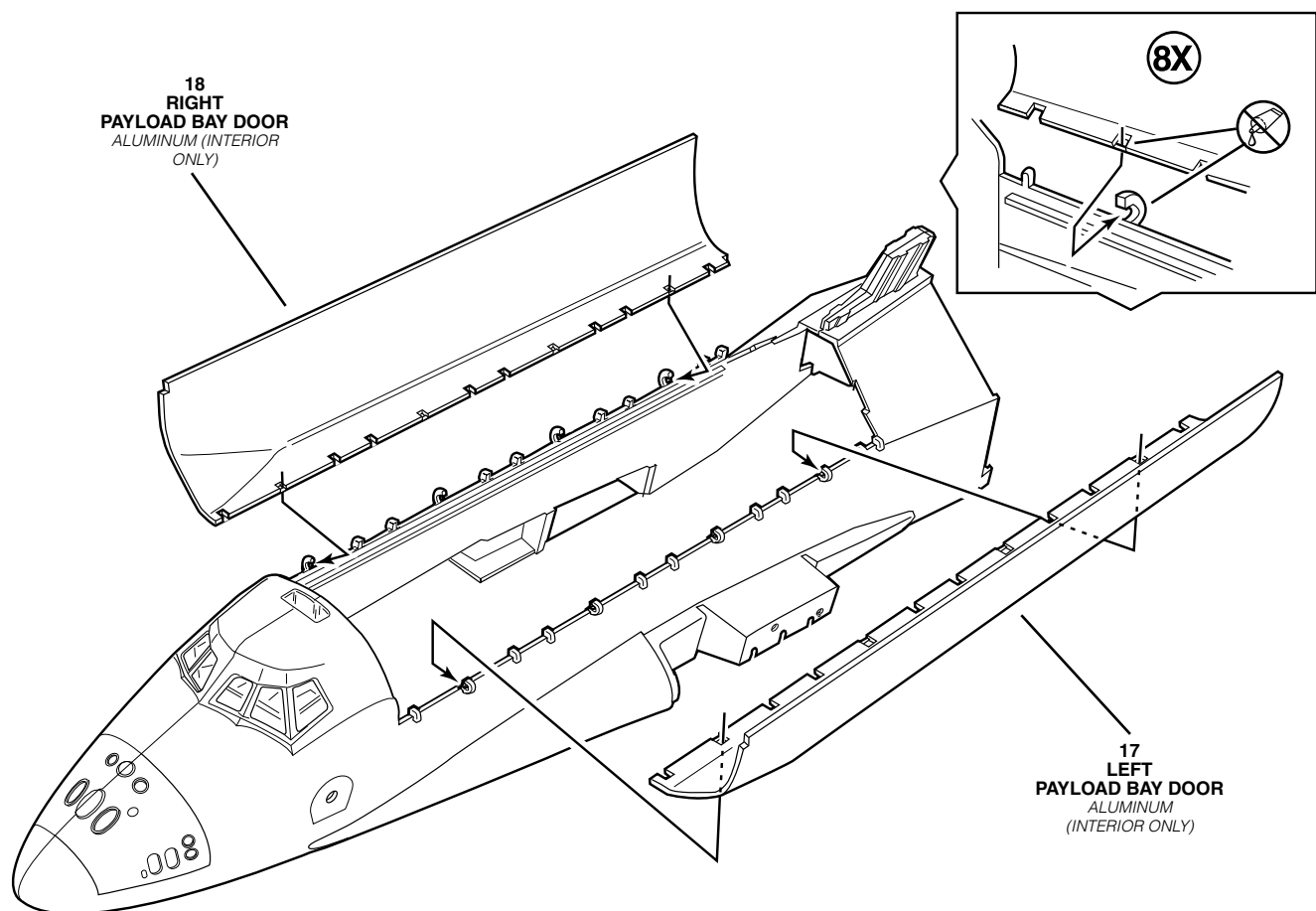

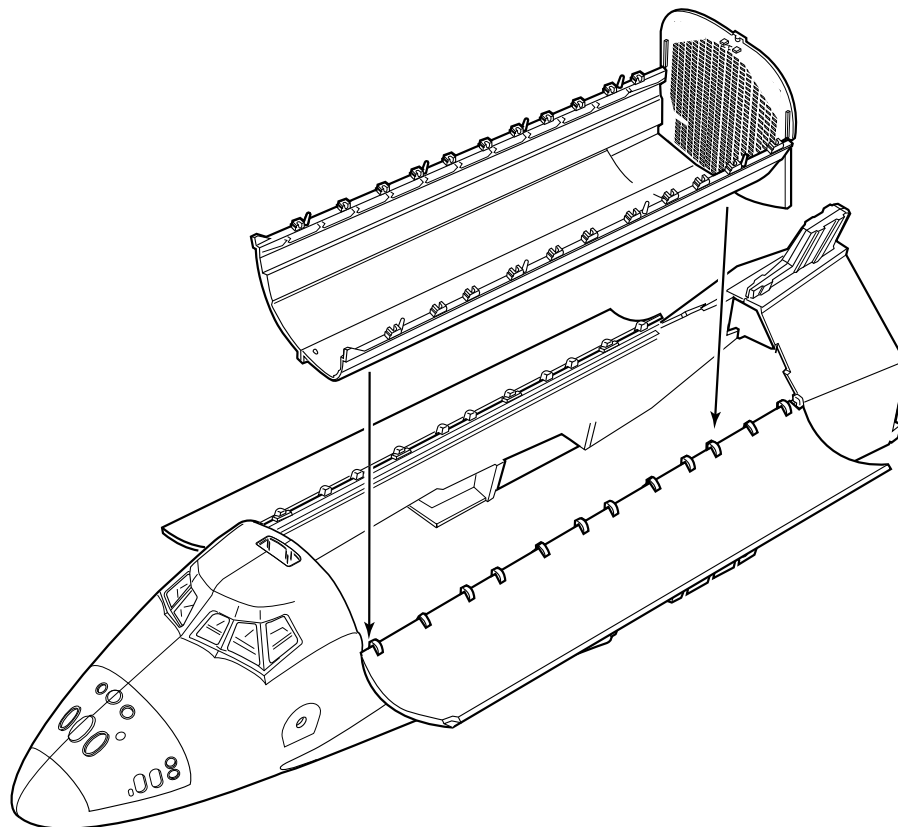
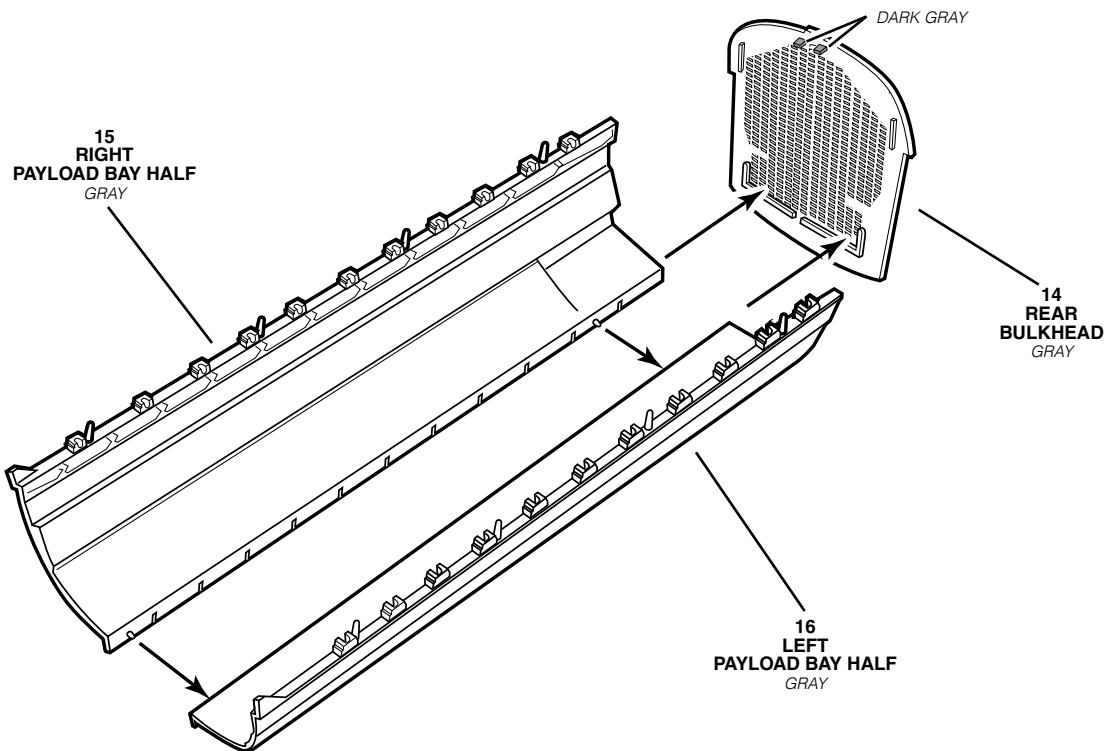

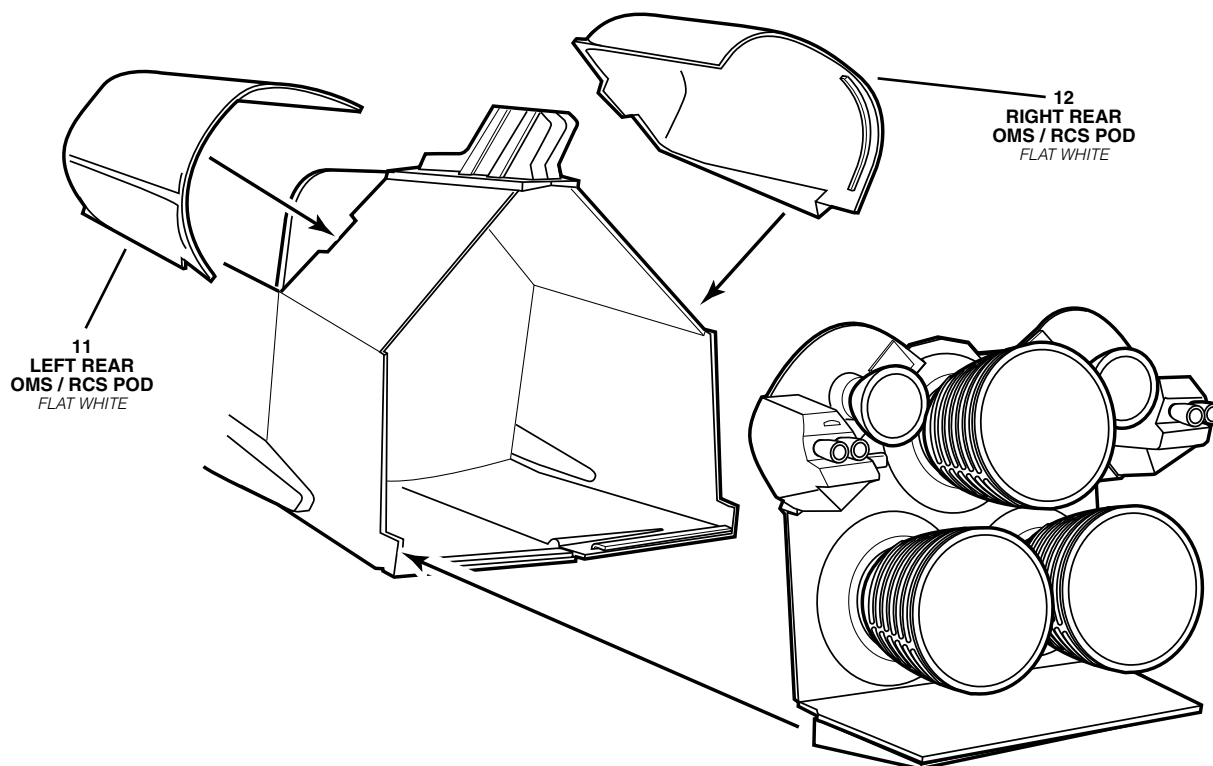
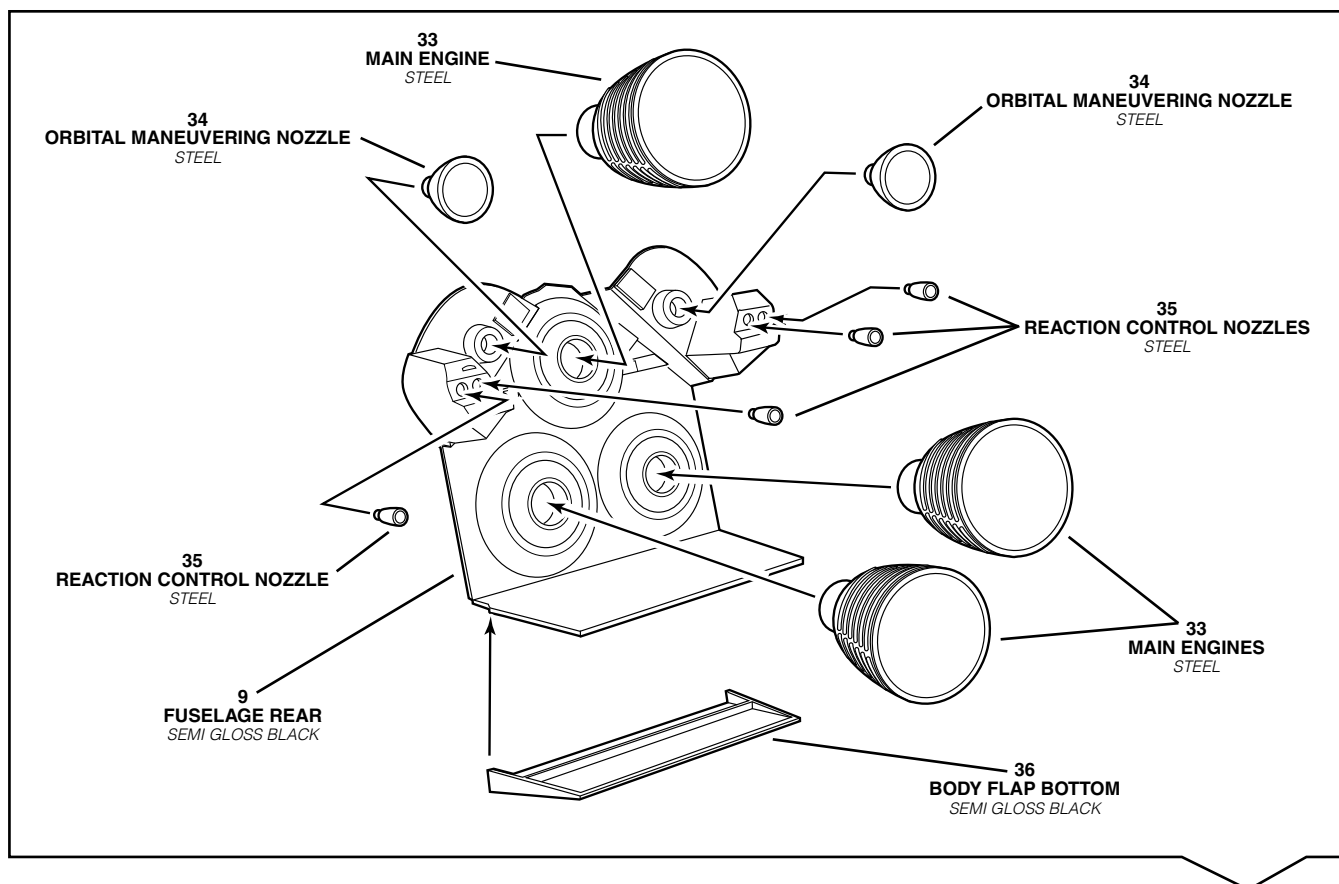

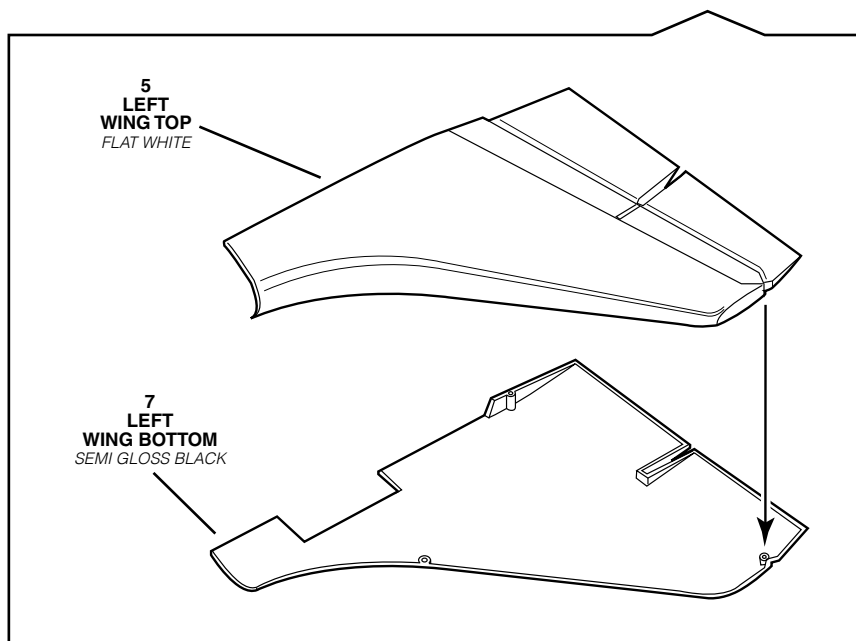
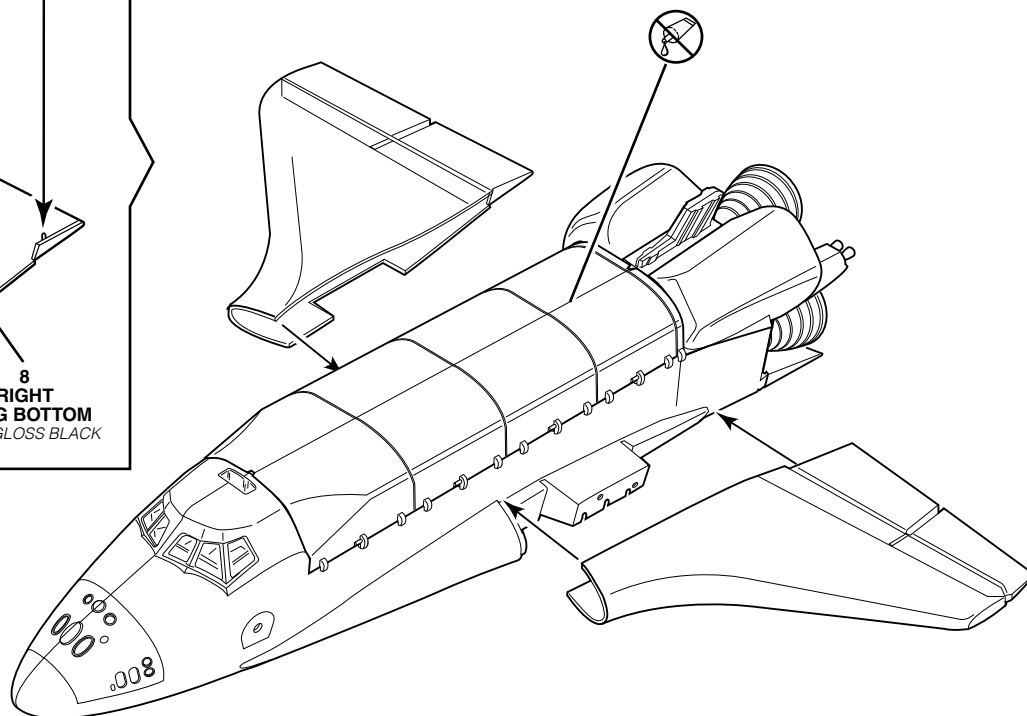
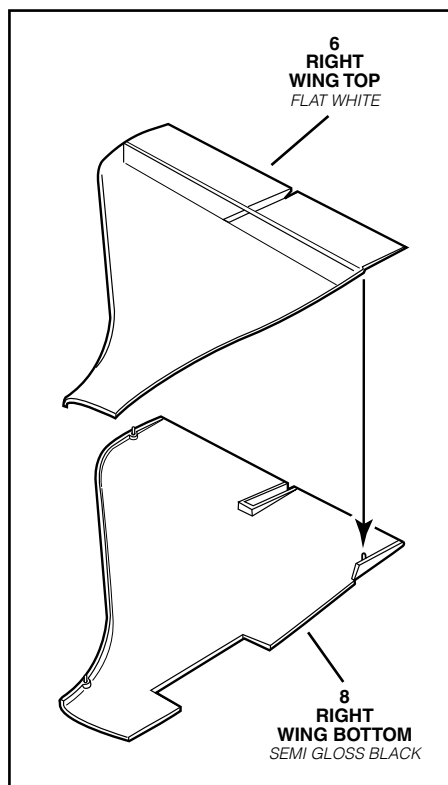

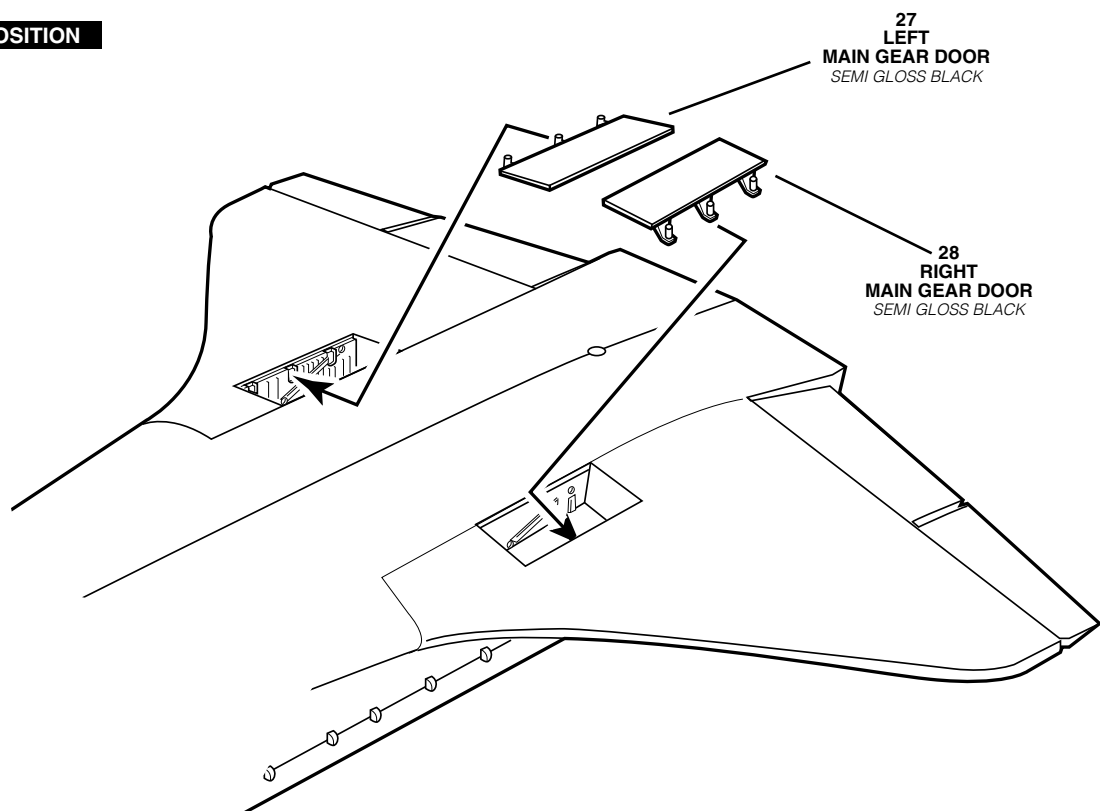
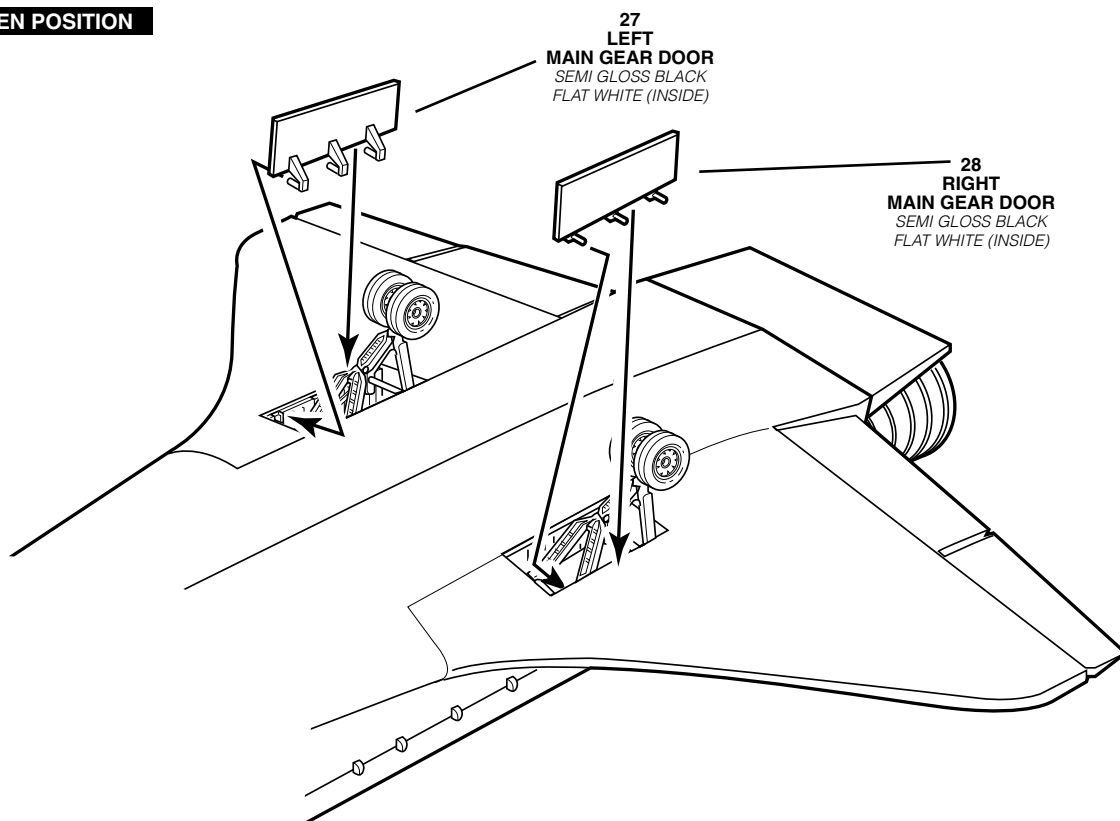
**CLOSED POSITION****OPEN POSITION**

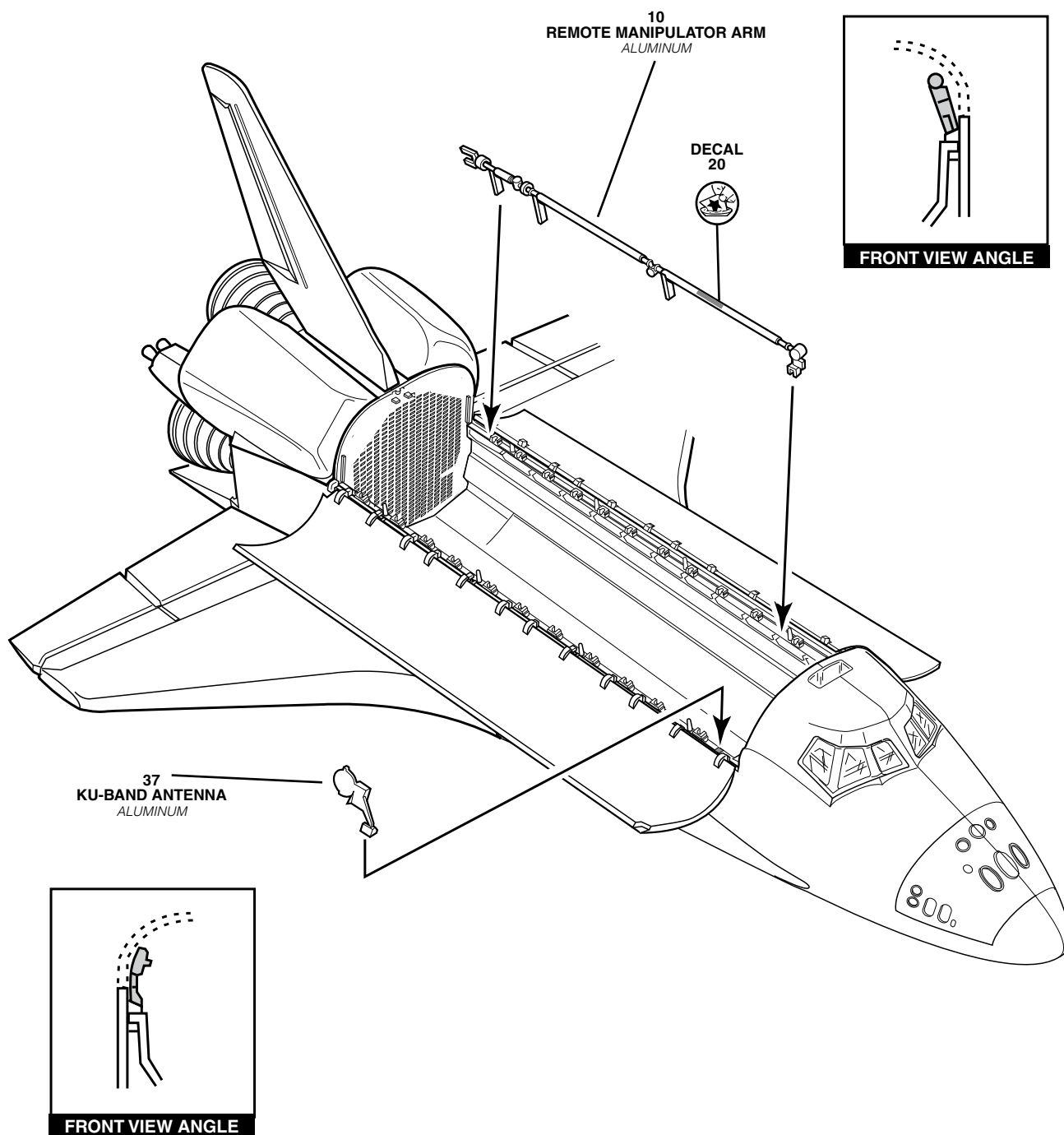

17

VERTICAL STABILIZER ASSEMBLY

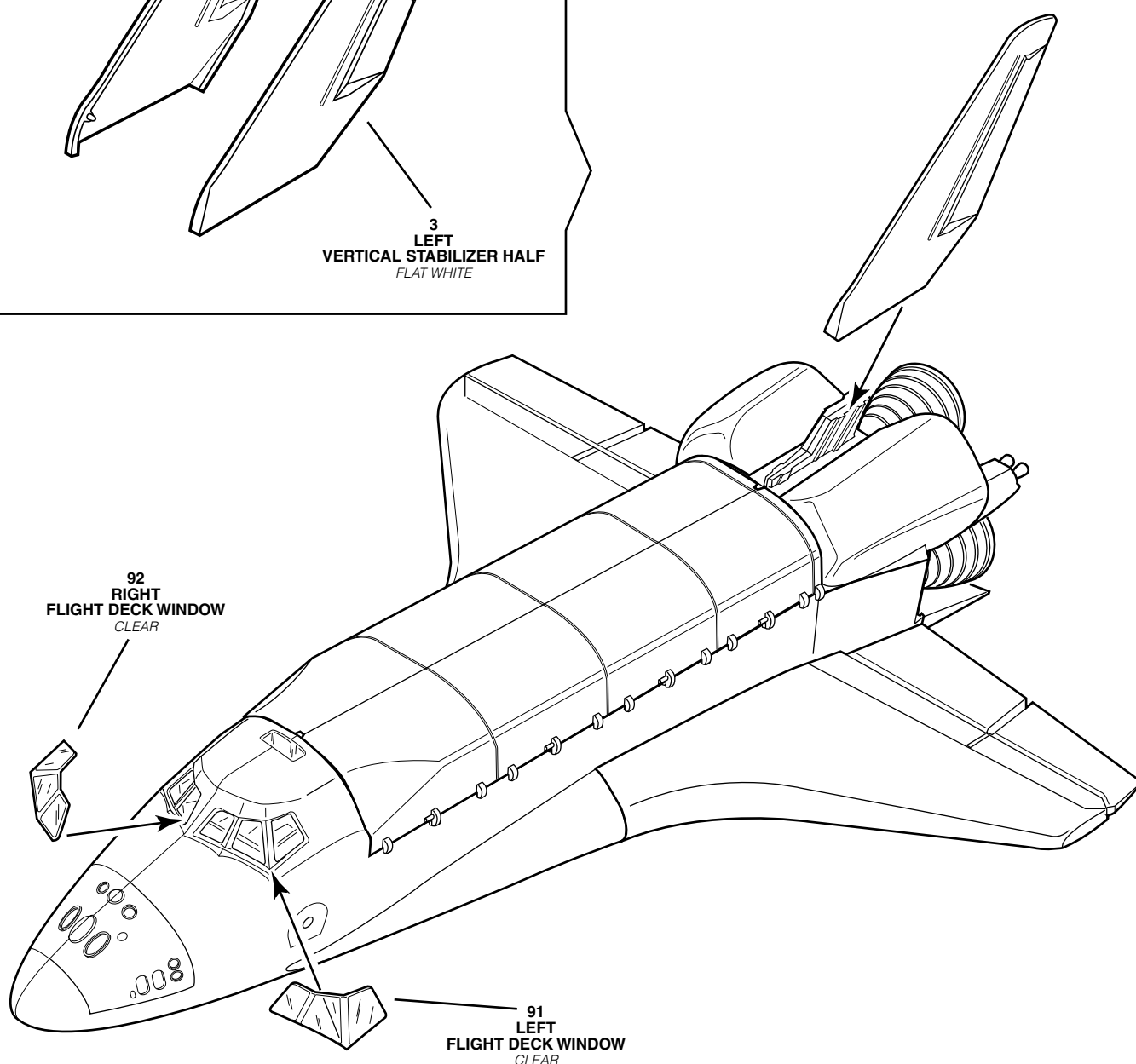
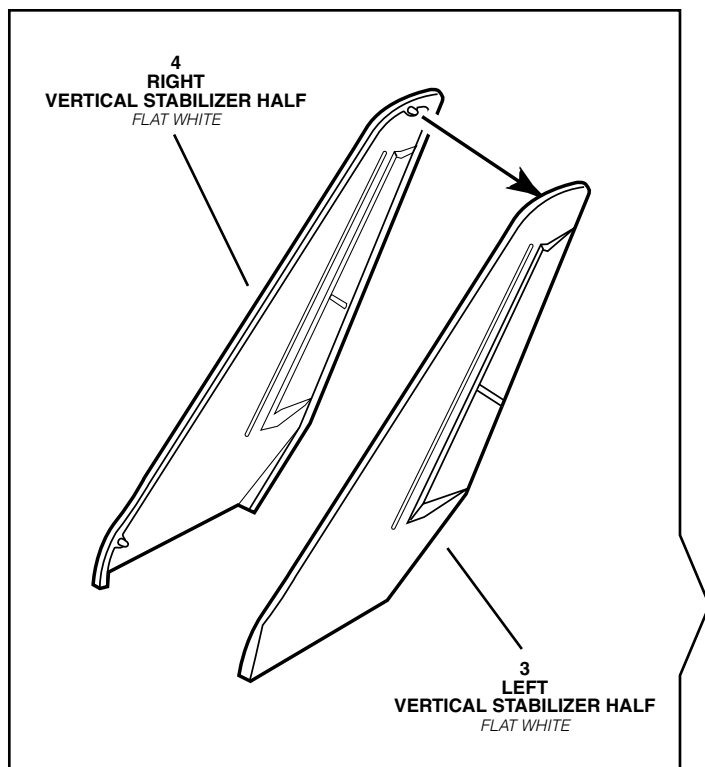

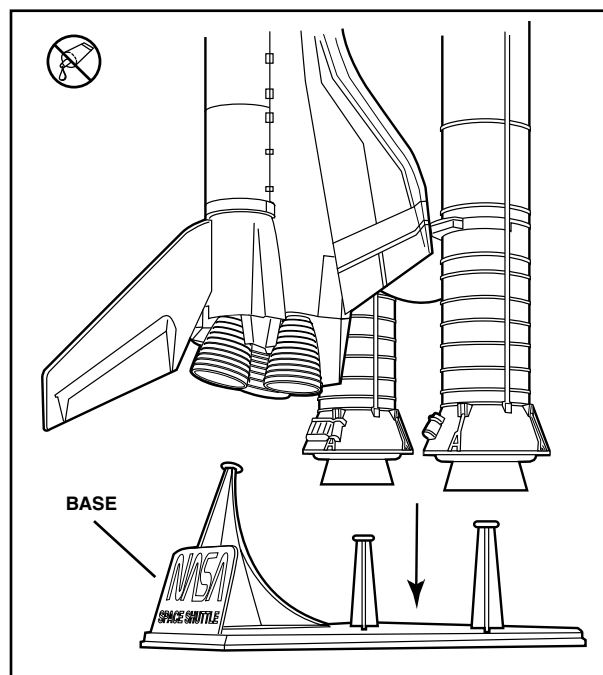
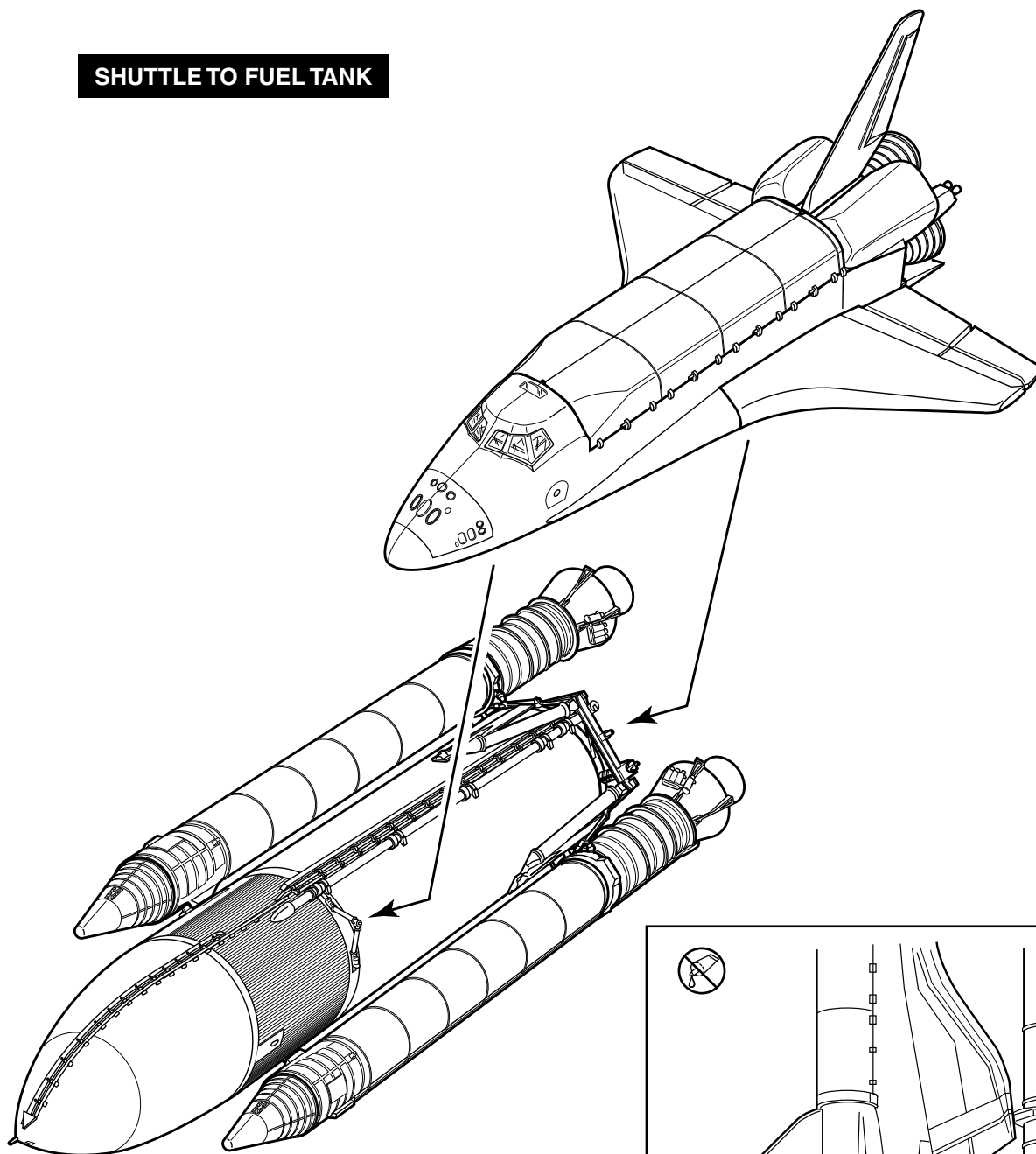
SHUTTLE TO FUEL TANK

19

AIR LOCK ASSEMBLY

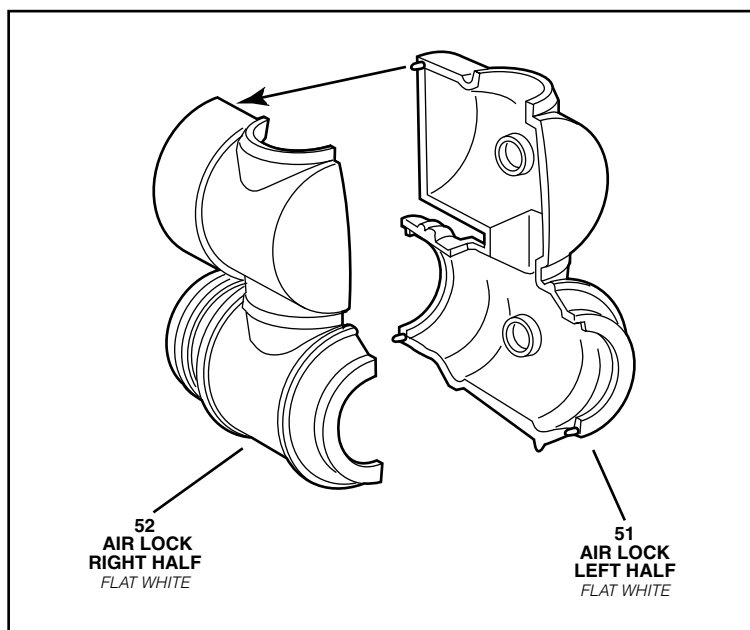

53 DOCKING MECHANISM
ALUMINUM

A

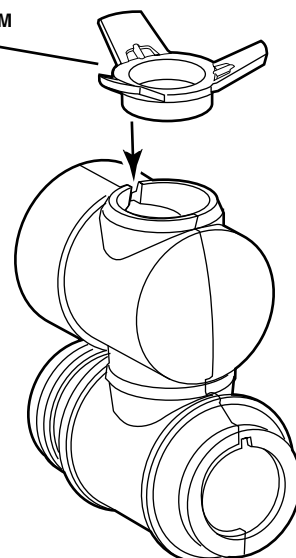

20

SPACE LAB ASSEMBLY

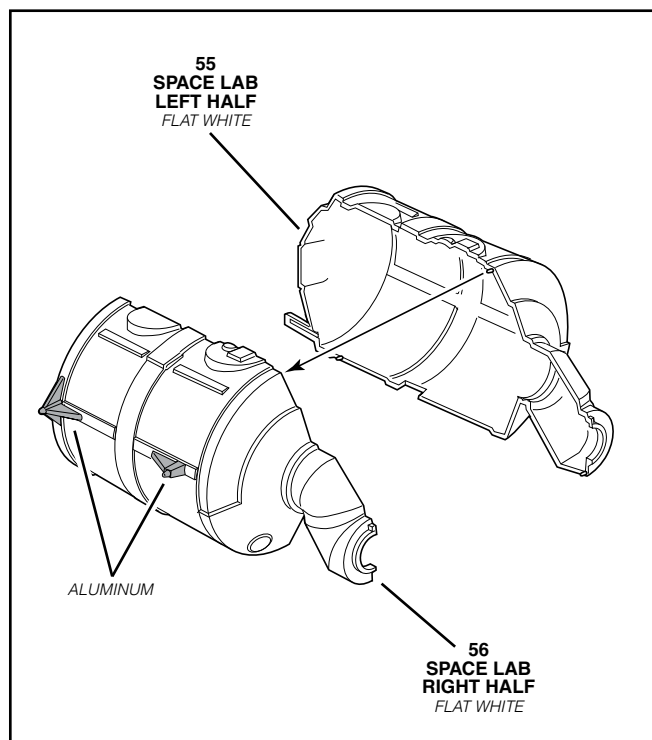

B

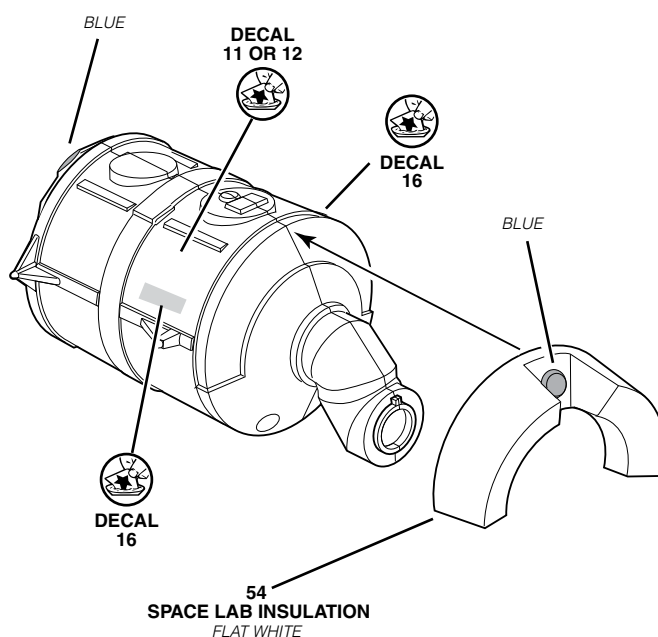

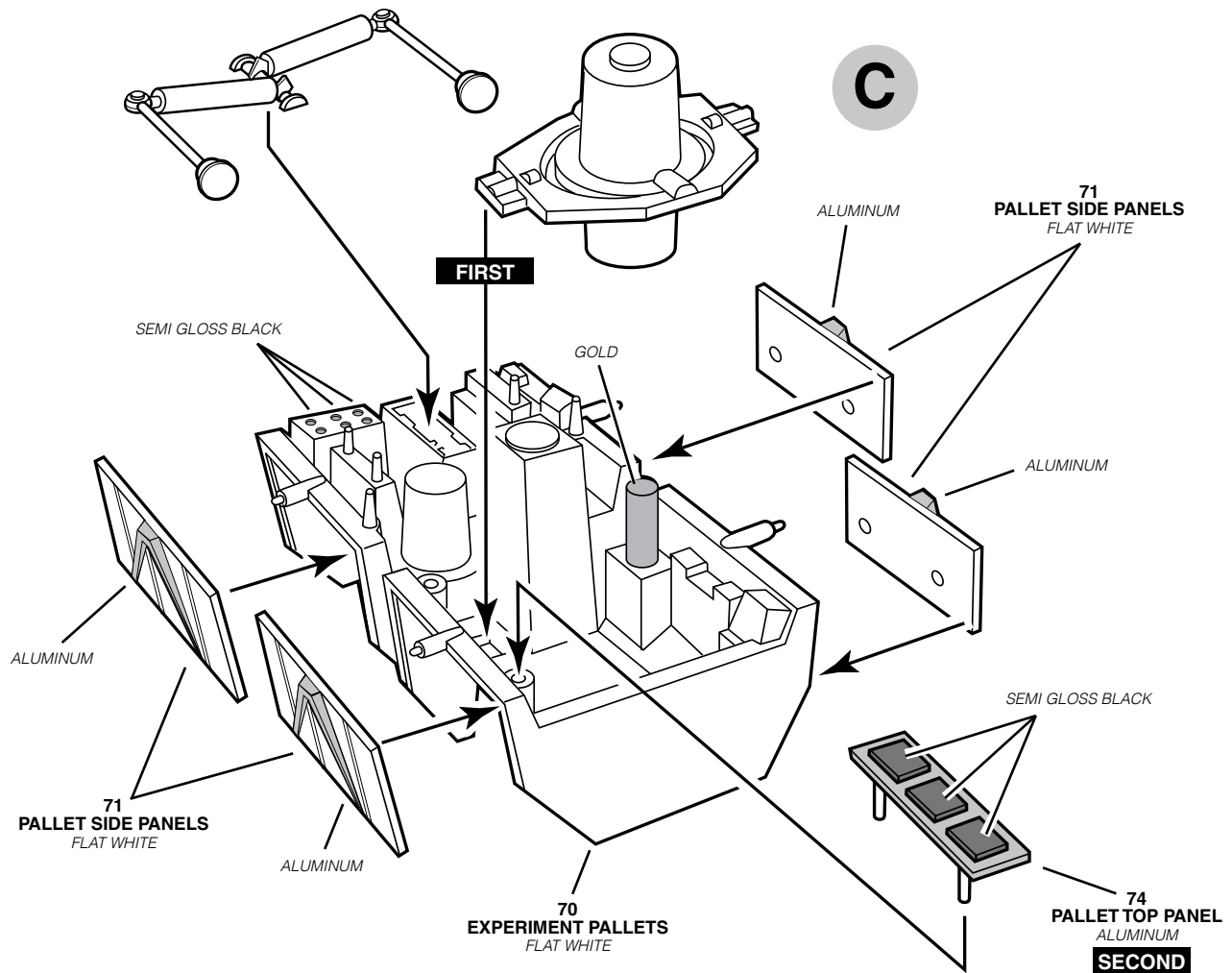
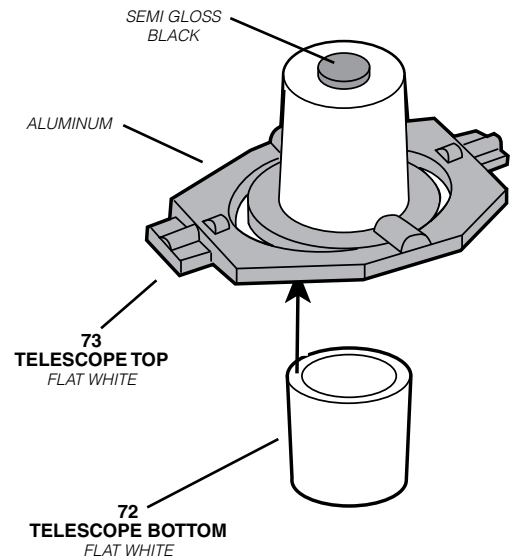
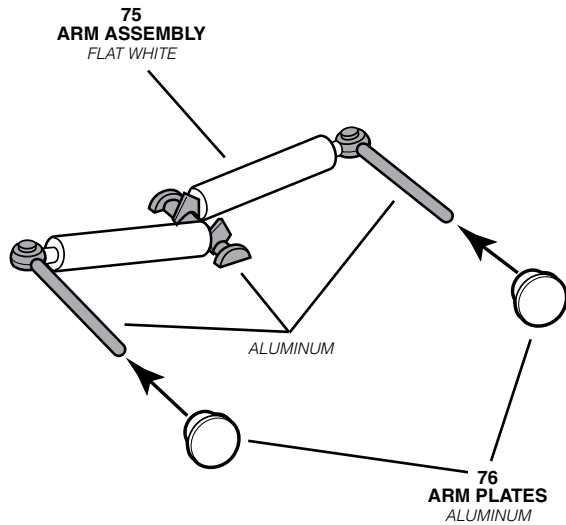

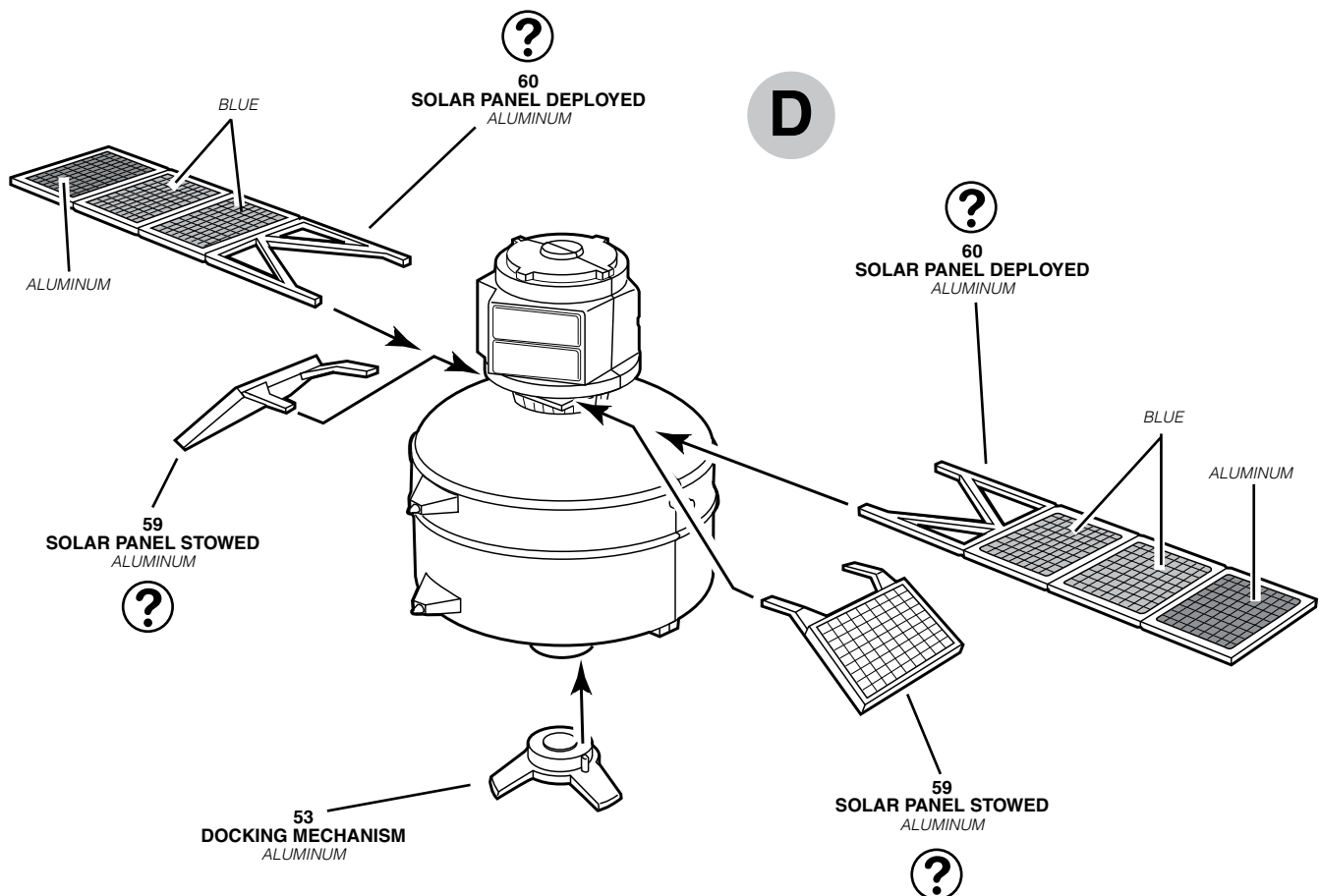
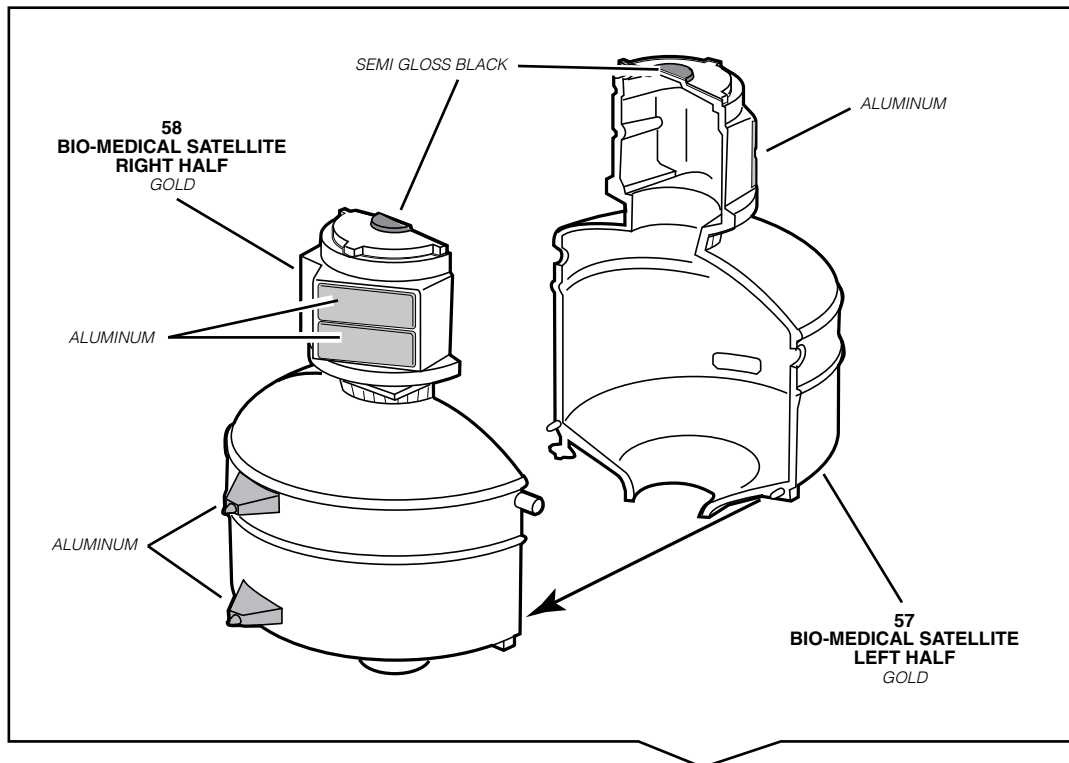

23

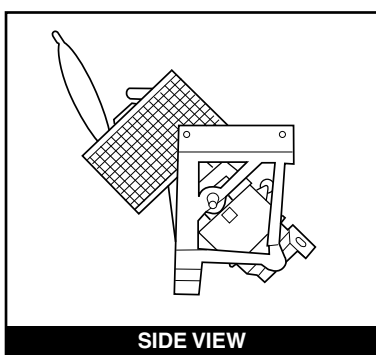

24

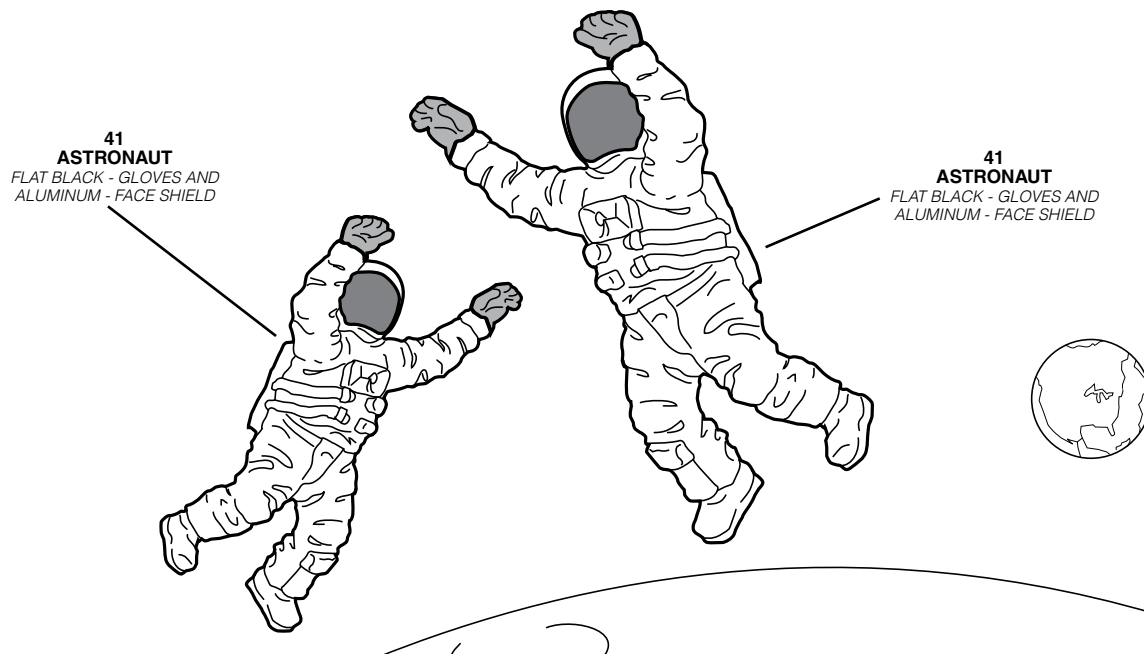



TOP VIEW USED ON COLUMBIA,
DISCOVERY, ATLANTIS AND ENDEVOUR

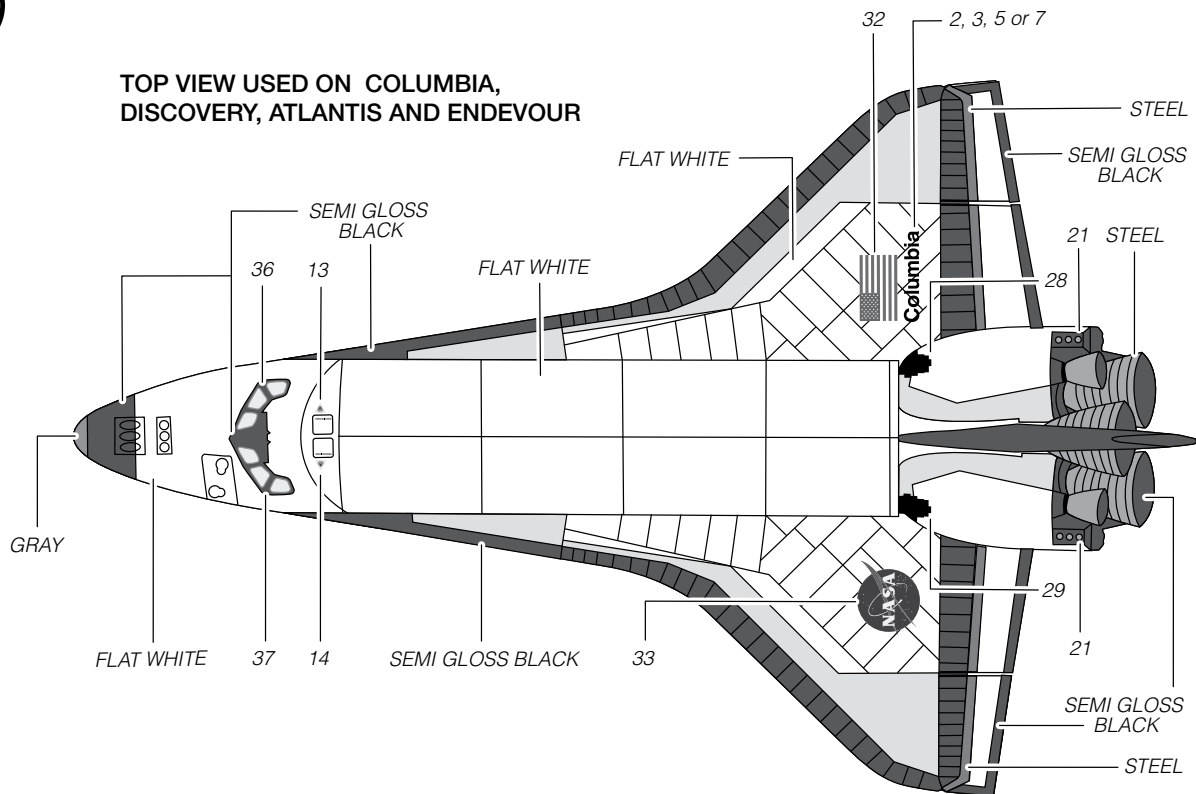

TOP VIEW USED ON EARLY
COLUMBIA, ENTERPRISE

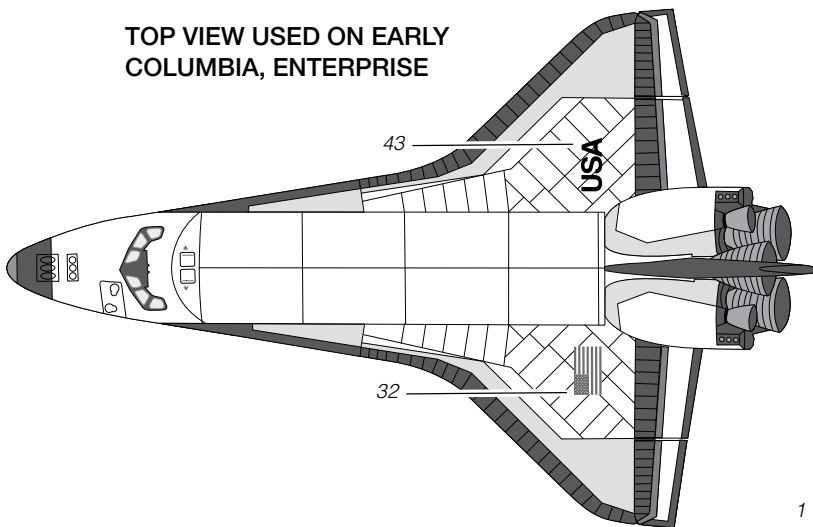

TOP VIEW USED ON COLUMBIA,
DISCOVERY, CHALLENGER, ATLANTIS
ENTERPRISE AND ENDEVOUR

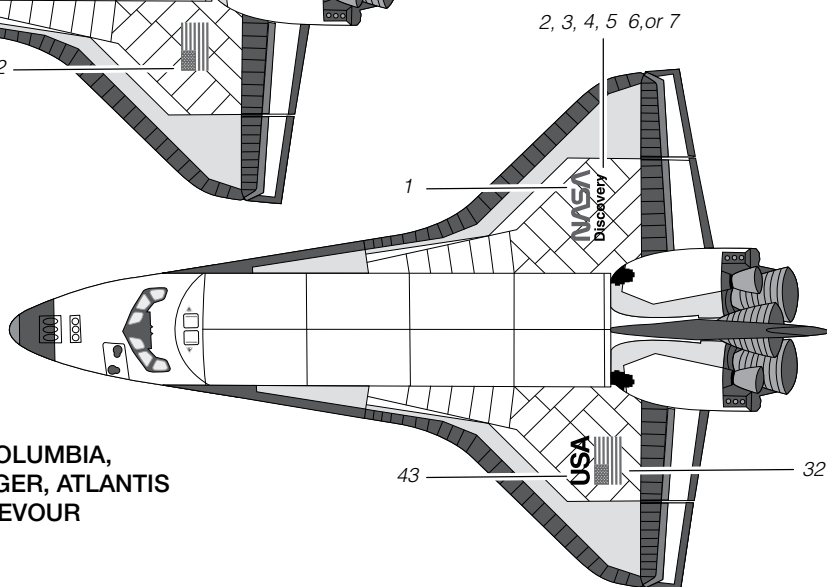

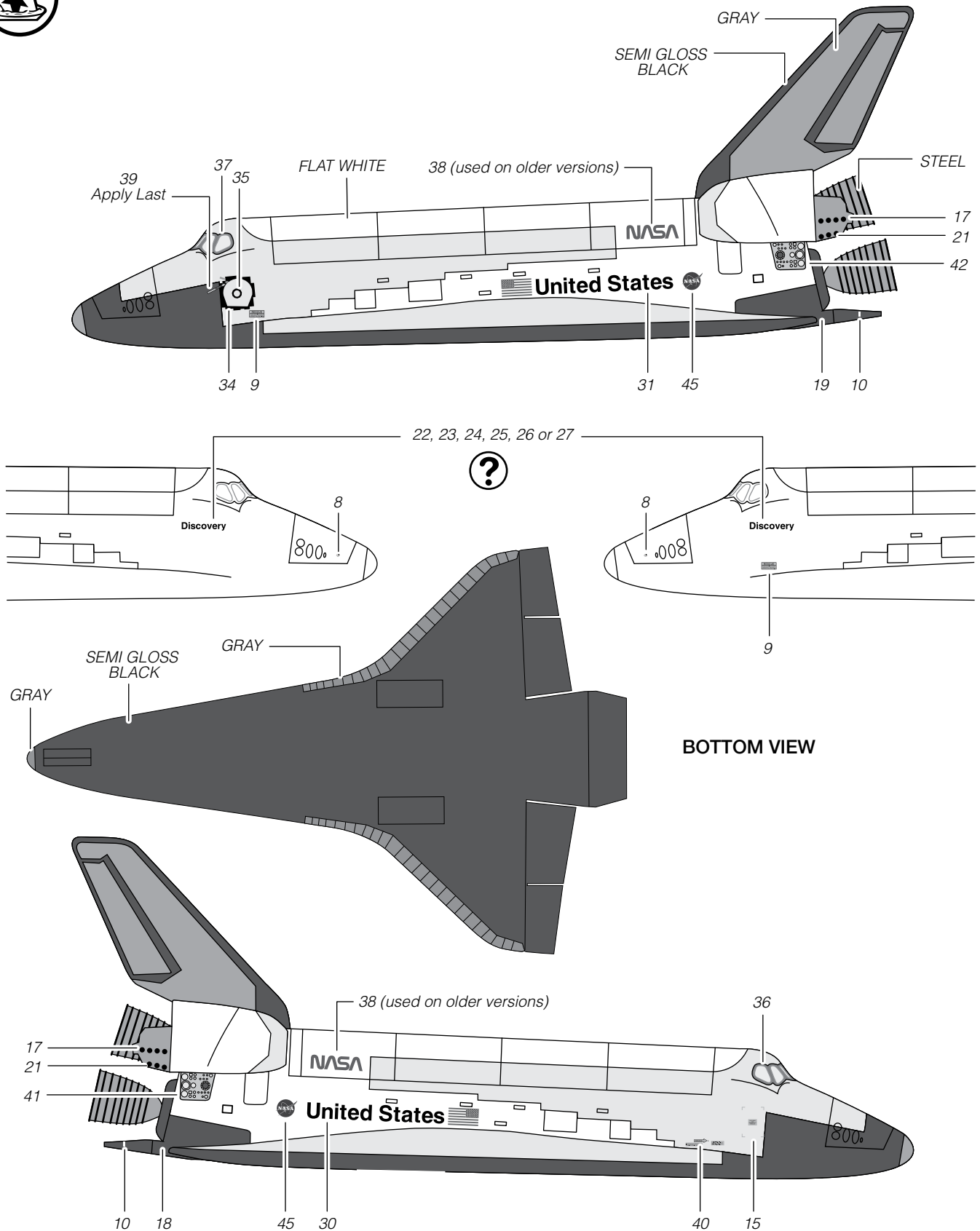

Cargo Bay / Payload Versions

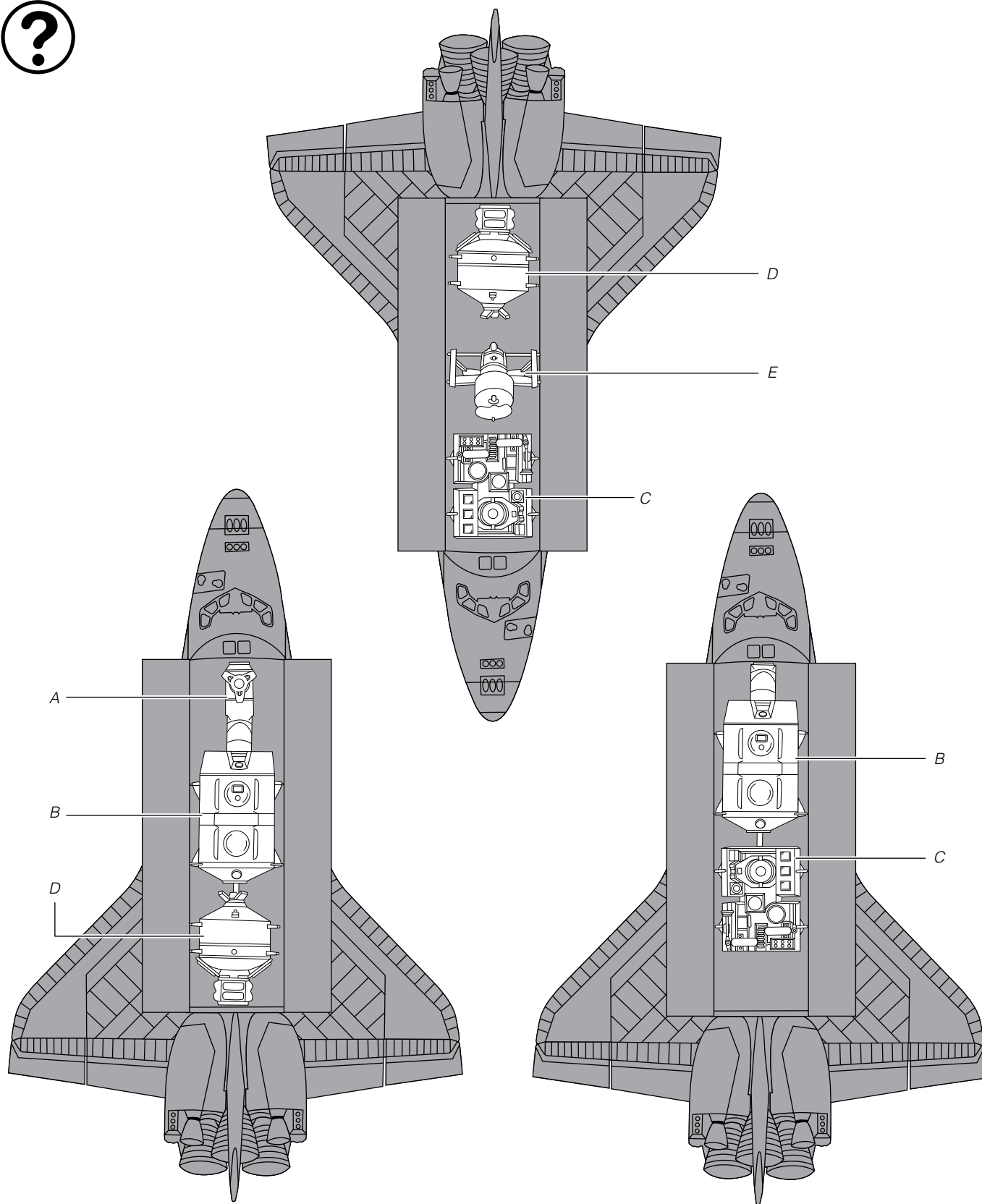

Cargo Bay / Payload Versions

