

THE ICE "T"®

FASTED AND QUICKEST ICE WAGON IN THE U.S.
OF A. The Ice "T" comes on like strong. Designed for the latest trend in show/go rod styling, Tom Daniel's newest creation is stuffed with mouth watering glitter.
This beauty rides on huge real-looking wrinkle sticks, just like those seen on hot machinery at drag strips everywhere. It's big thumpin' V-8 mill is topped by the latest Hi-Rise

EIGHT STEPS TO SUCCESSFUL MODEL BUILDING

1. READ the instructions.
STUDY the drawings.
Become familiar with your Monogram kit.
2. DO NOT REMOVE parts from trees until ready for use. All parts are identified by a number.
3. Read **PAINTING INSTRUCTIONS** before assembly.
Some parts must be painted before cementing.
4. CUT parts from trees, breaking off may damage part.
5. CHECK FIT of part before cementing into place.
6. Apply cement with a **TOOTHPICK** on small areas.
Too much cement can damage your model.
7. **SCRAPE PLATING** from plastic parts. Cement **WILL NOT** stick to plating.
8. DO NOT RUSH assembly. FOLLOW instructions and check off each step as completed.



KIT 4266

85426600200

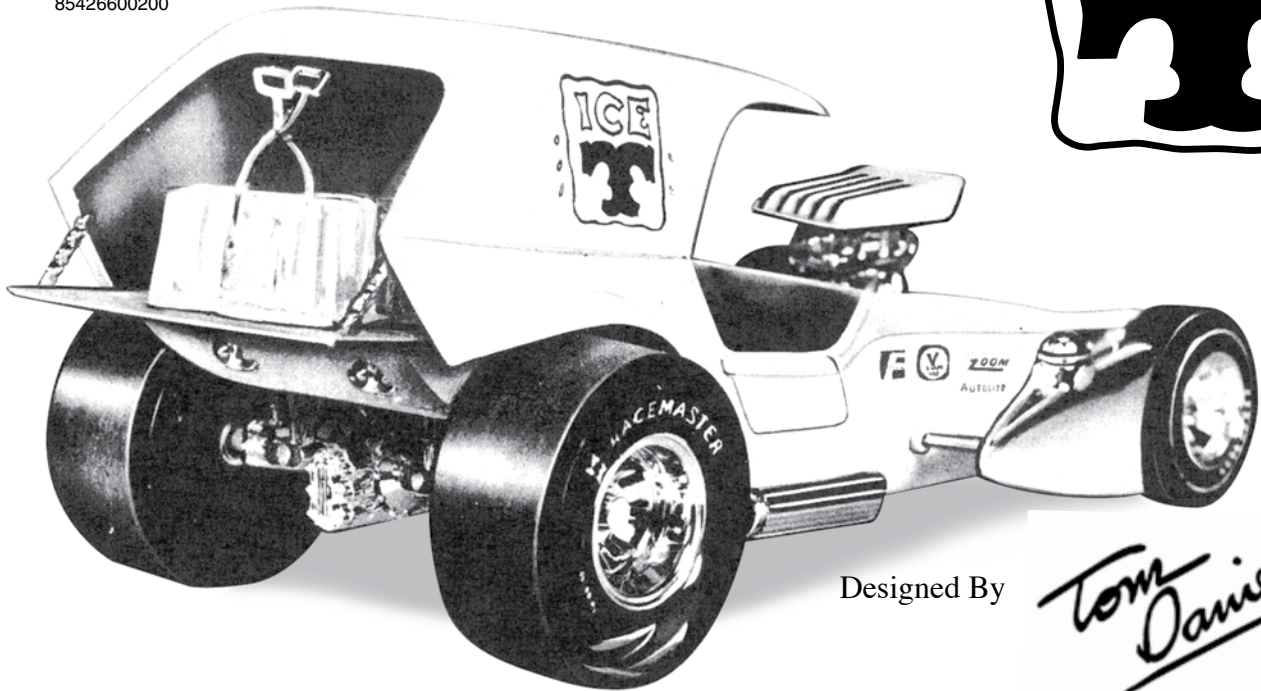

Designed By

Tom Daniel

If you have any questions or comments, call our hotline at: (800) 833-3570
or, please write to: Revell Inc Consumer Service Department, 1850 Howard Street Unit A, Elk Grove Village, Illinois 60007

Be sure to include the plan number (85426600200), part number, description, your return address and phone number.

Visit our website: www.revell.com Revell Inc Elk Grove Village, IL. Copyright © 2010. All rights reserved.

1. Begin by cementing engine halves 1 and 2 together.
2. Cement two heads 3 and 4 to engine.
3. Cement two rocker covers 5★ to heads as shown.
4. Next, cement high riser halves 7★ and 8★ together.
5. Cement distributor 9 into hole in tab on rear of high riser.
6. Cement high riser to top of engine.
7. Attach pulley assembly 10 to engine front.
8. Cement air scoop halves 11 and 12 together and attach to top of intake.

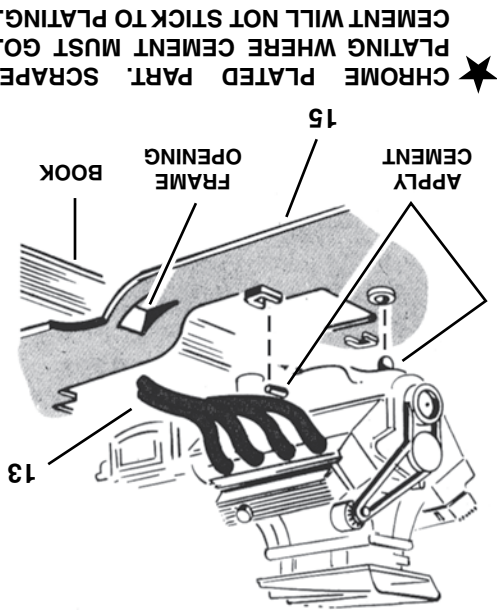
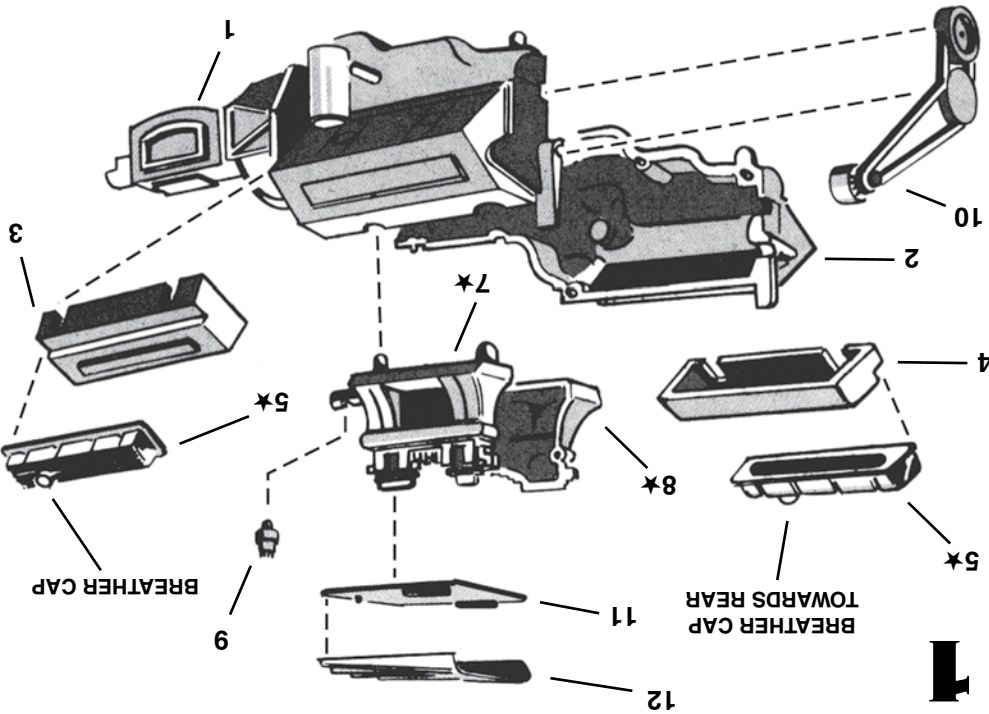

9. Cement exhaust pipes 13 and 14 to heads. While cement is still slightly wet on exhaust pipes, add cement to places indicated on sketch and position pipes should be centered in frame openings. Rest the frame between two books so that the bottom of the engine does not touch the table while the cement it drying.

PAINTING

Use only PAINT FOR PLASTICS or an ENAMEL for the parts you may wish to paint. Refer to the box illustrations and the detailed color scheme below.

It is best to paint some of the smaller parts before removing them from the plastic trees. Use a small pointed brush for the small parts and a 1/4 inch soft brush for larger areas.

Allow the paint to dry thoroughly before handling the parts. Paint should be scraped from the areas to be cemented because cement will not adhere to the paint.

GLOSS YELLOW - Body, back pan and scoop.

SEMI GLOSS BLACK - Entire engine assembly including exhaust pipes, entire frame except bed portion, belts on pulley assembly five ribs on top of air scoop, ends of exhaust pipes 25 and 26, surfaces between coil springs on front suspension, entire front seat and floorboard and inside of air scoop.

LIGHT BROWN (Wood) - Bed portion of frame (this is the portion which carries the ice).

SILVER - Seven metal strips on bed portion, pulleys and alternator on pulley assembly and six instruments on front of floorboard.

TRANSPARENT RED - Tail light lenses.

TRANSPARENT BLUE - ICE BLOCKS.

WHITE - Lettering on outside of front and rear tires and narrow stripe on sidewall of front tire.

DECALS

Use as many decals as you like and locate them to suit your individual taste. The photos show suggested decal locations. For a neat job, work with one subject at a time and trim each close to the color outline. Dip in water for a few seconds. When decal can slide off sheet, slide into position on model and let dry before handling.

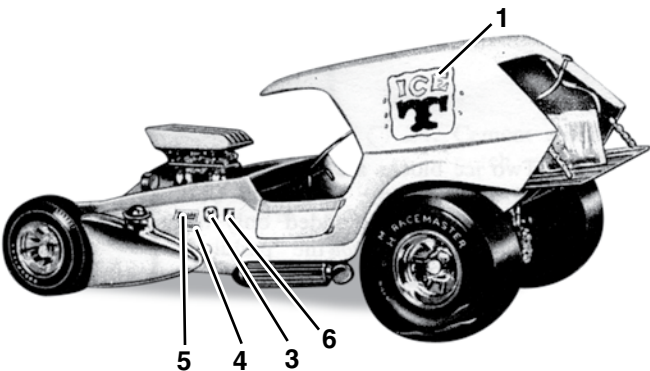
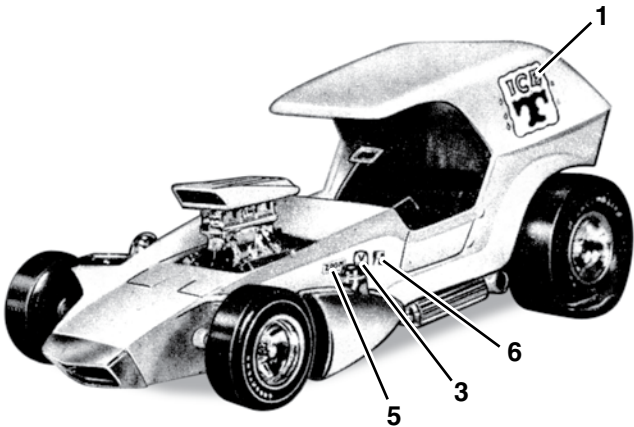

2

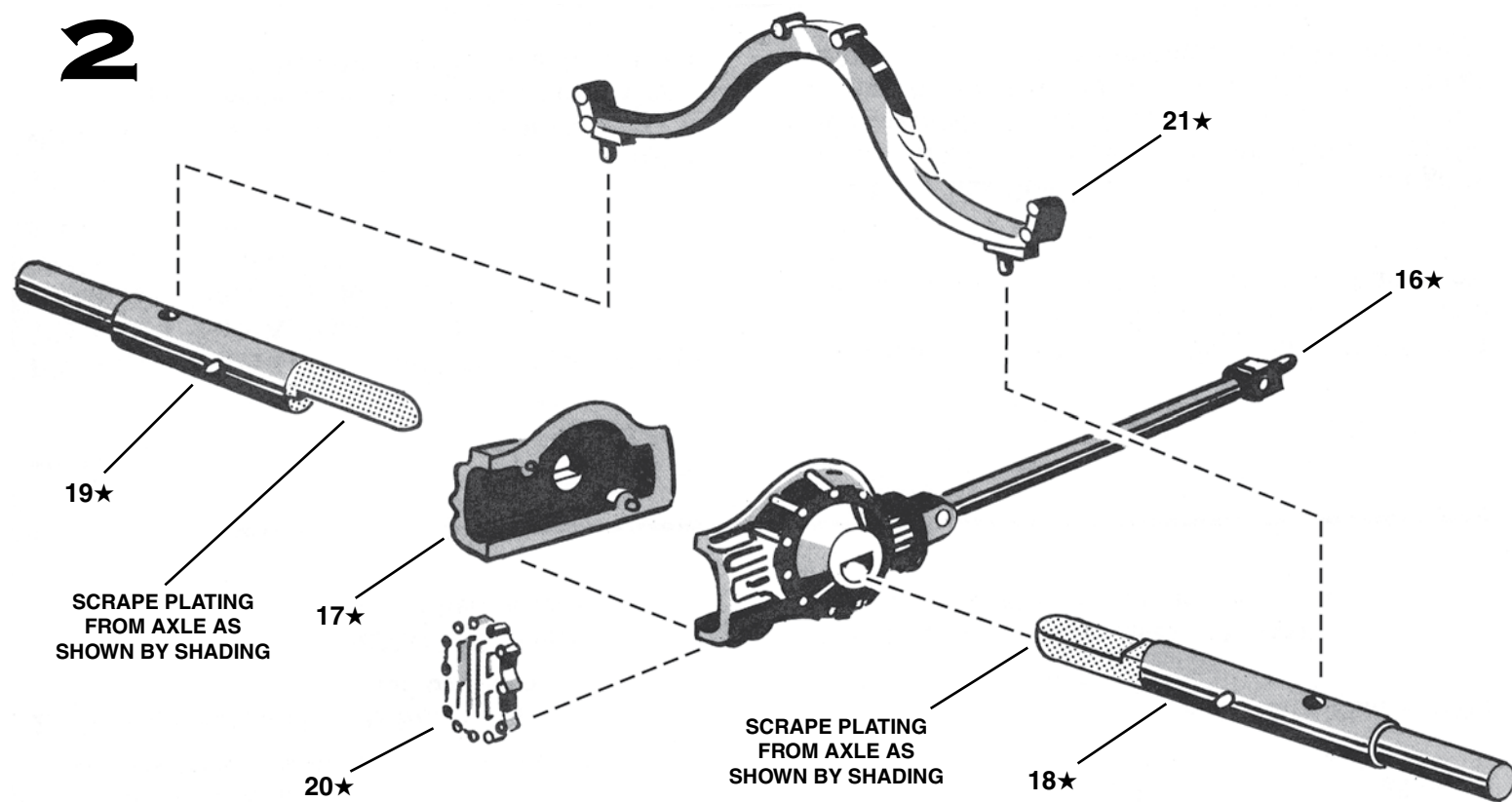

- 10. Cement quick change halves 16★ and 17★ together.
- 11. Attach cover 20★ to quick change halves.
- 12. Cement axle halves 18★ and 19★ into "D"

- 13. Cement spring 21★ into holes in axle. While cement is slightly wet proceed to next step.

shaped holes as shown. Make sure holes for springs in axle face up as shown.

★ **CHROME PLATED PART. SCRAPE PLATING WHERE CEMENT MUST GO. CEMENT WILL NOT STICK TO PLATING.**

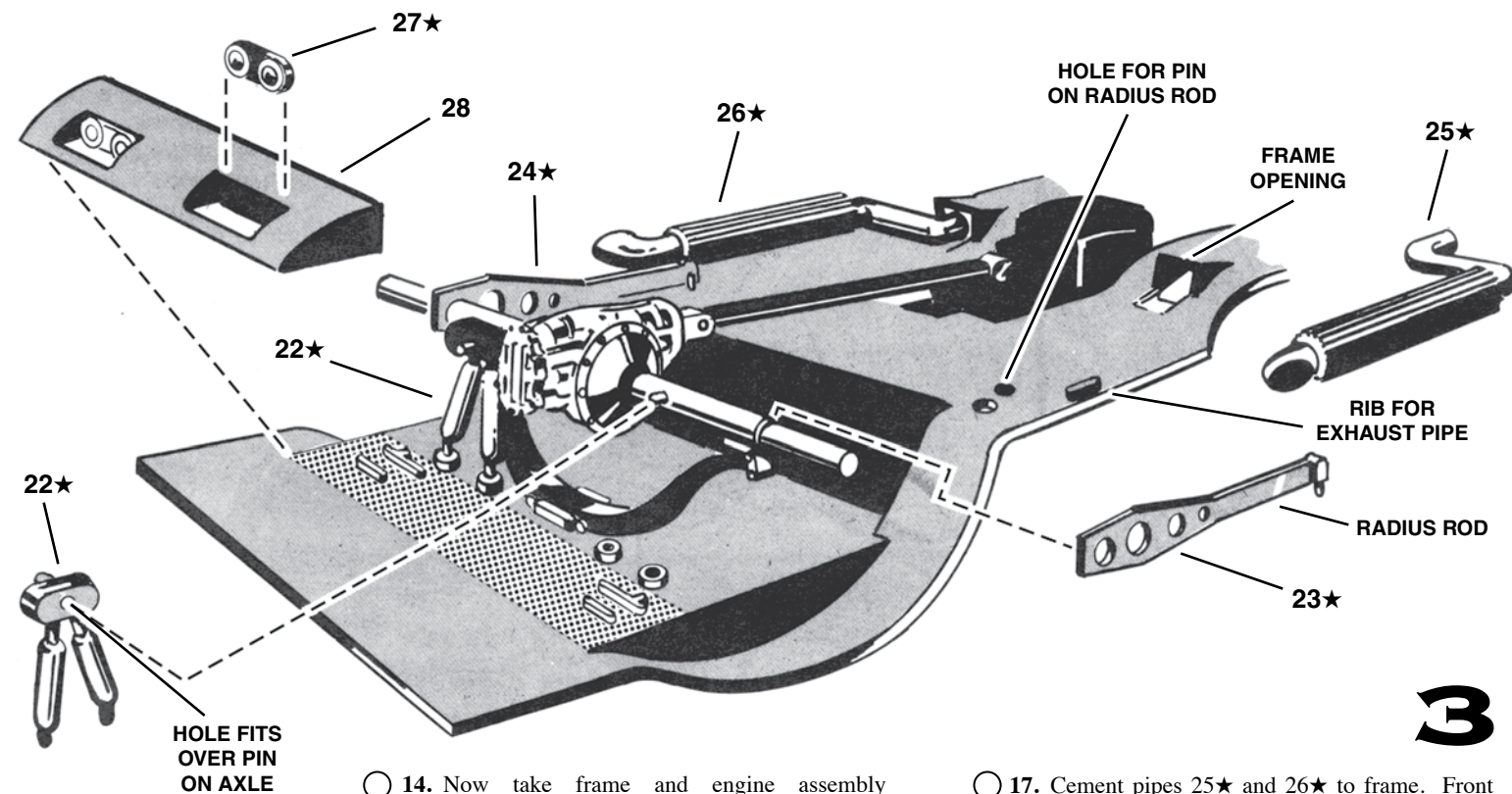

- 14. Now take frame and engine assembly assembled in Step 1 and turn upside down as shown. Cement end of driveshaft into engine and spring between ribs on frame.
- 15. Cement two shock absorber units 22★ to pins on axle and into holes as shown.
- 16. Attach two rear radius rods 23★ and 24★ as indicated.

- 17. Cement pipes 25★ and 26★ to frame. Front end of pipe fit into frame opening. Rib on frame fits into notch in exhausts.
- 18. Next, cement two tailight units 27★ into notches in back pan 28. Cement back pan to frame in position as indicated by shaded area. Edge of back pan rests against the mounts for the shock absorber units.

3

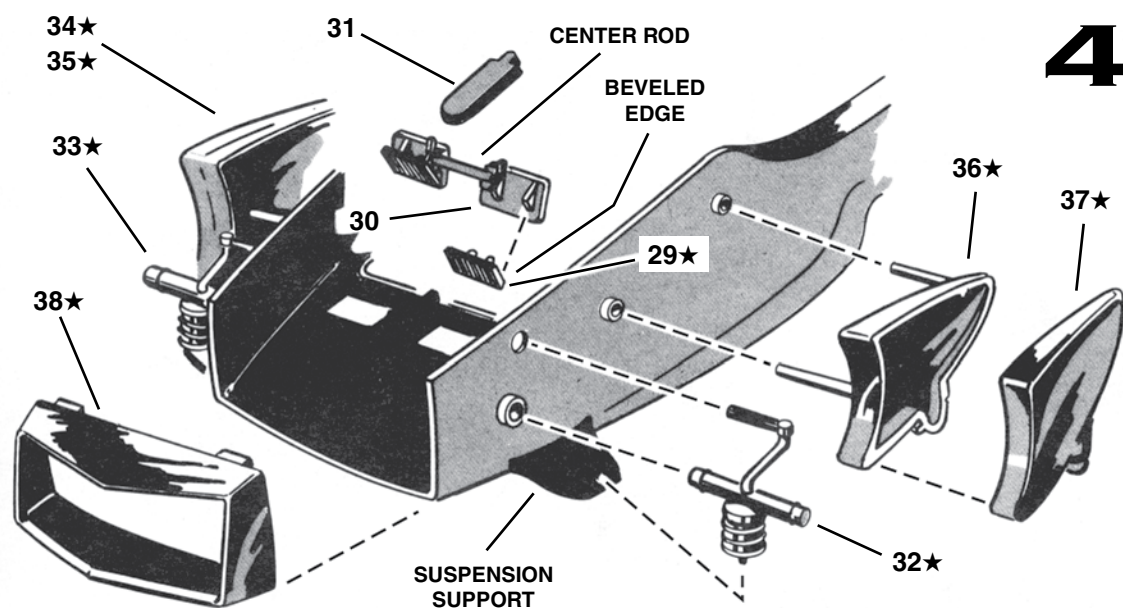

- 19. Cement two headlights 29★ against triangular stops on headlight backs 30. Make certain that the beveled edge of headlight is in position shown in sketch before cementing in place.
- 20. Locate (do not cement) rod on headlight back between two ribs on body. Now carefully cement retainer 31 to body. Add cement only to where retainer touches body. DO NOT put cement near rod so that headlights will operate properly. Hold 31 tightly in place until cement sets.

- 21. Cement two front axles suspensions 32★ and 33★ to side in body as shown. It is best to insert axle into hole in body, THEN insert small pin on spring into hold in suspension support.
- 22. Cement fuel tank halves 34★ and 35★ together and cement to body as shown. Repeat for remaining tank halves 36★ and 37★.
- 23. Next, cement nose piece 38★ to front of body.

Do not operate headlights until cement has dried overnight.

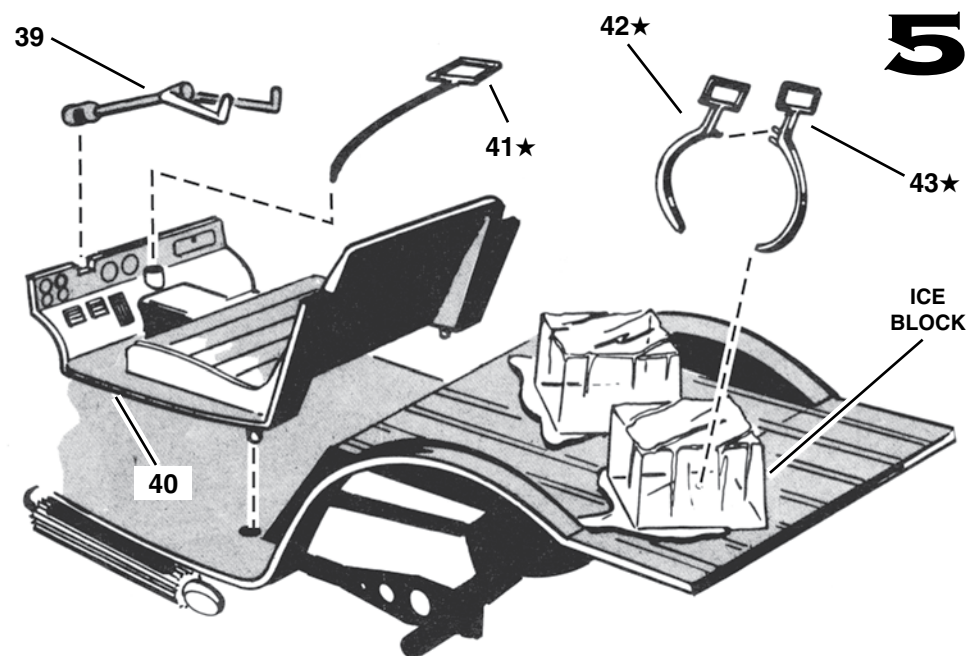

- 24. Cement steering column 39 into notch in floorboard 40.
- 25. Next, cement shift lever 41★ into floorboard as indicated, then cement floorboard to frame.
- 26. Cement ice tong halves 42★ and 43★ together. Pin on one half fits between two pins on other half. Cement tongs to one ice block.

- 27. Two ice blocks are now cemented to the frame as shown. Cement should be added only to the block edges *not* the "puddle" portions. The arrangement shown may be changed to suit. It is best to check for clearance with the body before cementing into final position.

5

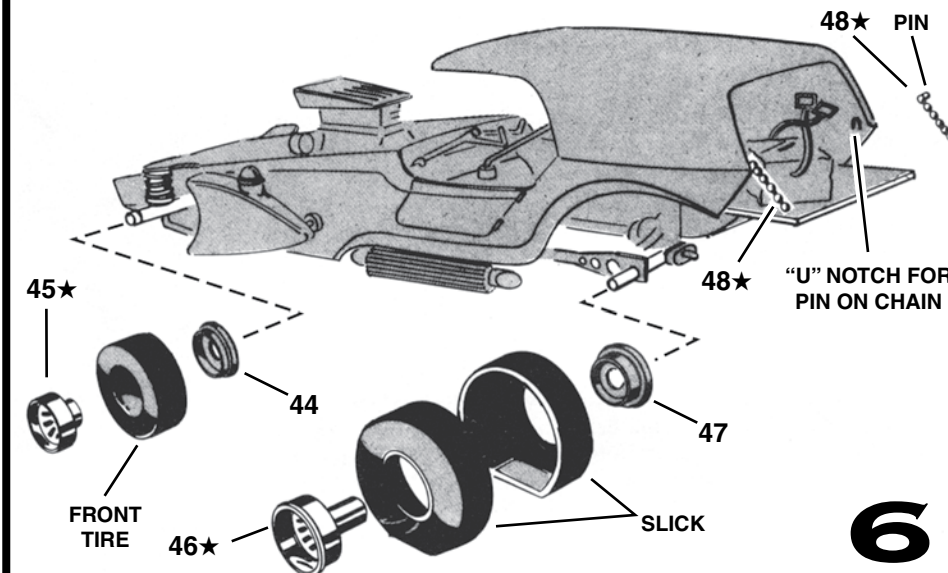

- 28. Cement completed frame assembly and body together.
- 29. Press inside wheel half 44 into front tire. Then apply cement to outside wheel half 45★ and press into other side of tire. Hold wheel halves together until cement sets. Cement wheels to front axle.
- 30. Fit slick halves together (do not cement) lining up the "flat" wrinkled portion. One slick half has a rib around

- 31. Fit the outside rear wheels 46★ into the assembled slicks and cement the wheels to the inner wheel halves 47. Now cement wheel to rear axle. Flat portion of slick lies flat on table.
- 32. Complete your model by cementing two tailgate chains 48★ in place as indicated.

6