

The "Desert Fox" was the name they gave to one of the best known generals in the history of military warfare.

General Erwin Rommel, the man who almost trapped the British at Dunkirk, took a mechanized armored division to the shores of Africa. This now famous German "Afrika Korps" rolled over the barren wastes of the African Desert like a powerful sandstorm, finally to be stopped at El Alamein in a wild brawl of tanks, guns, sand, and howling wind.

ROMMEL'S ROD, is Tom Daniel's version of what would have been the wildest command car ever built.

More powerful than a Tiger Tank, and able to leap tall sand-dunes in a single bound, Rommel's Rod, had it been seen by the Allies, may well have turned the tide of war.

Just the thing every well equipped general should own, Rommel's Rod is a real plum worth capturing. The eerie driver up front needs a skilled hand (bone) indeed to control the enormous power delivered to the half track treads by the big rumbling supercharged straight eight engine. The "roller" bumper permits him to blast over obstacles that would otherwise hang up a machine like this.

Armor plate on the rear protects the Rod during its lightning fast attacks and getaways and Mausner MG 34 machine guns are provided for both the driver and the General (in case the going gets rough and he decides to squeeze off a few). The General's plush seat is mounted atop a deck made of extra ammo cases. His map table tells him where he's at and his bony upraised finger indicates where he's going as he directs his battalions.

On the outside of the car is all the detail that makes Der Krazy Kommand Kar fun to build. Extra gas cans, tool box, extra track

## ROMMEL'S ROD®

# ROMMEL'S ROD®

1:24 SCALE

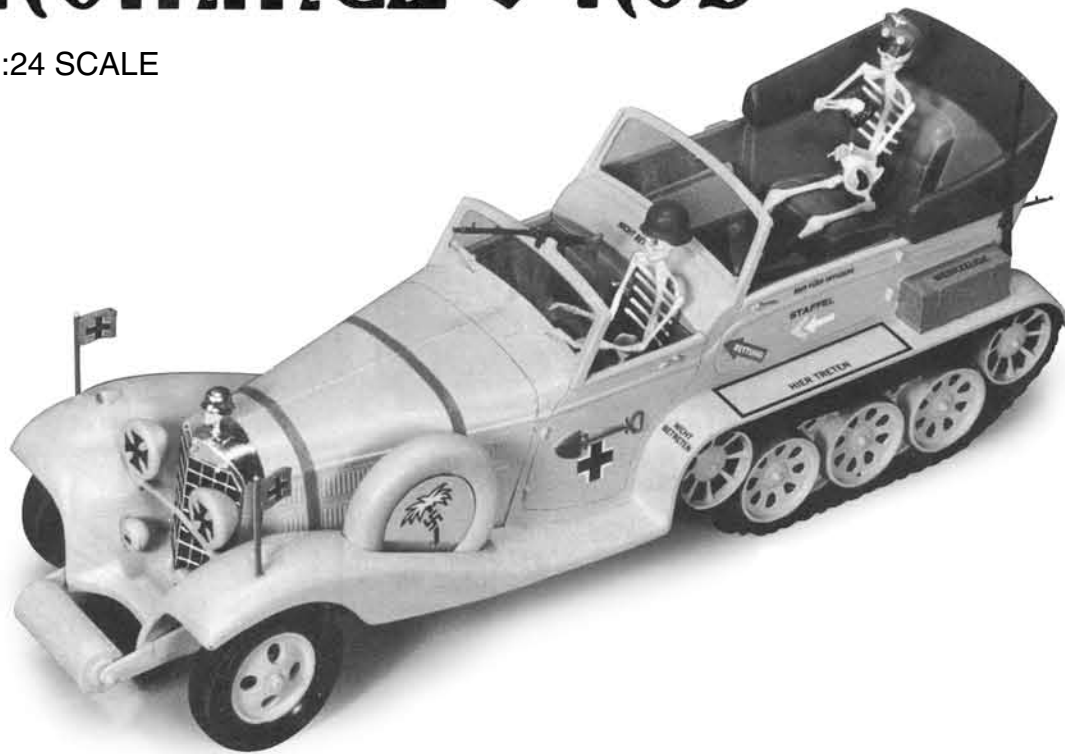

1. READ the instructions . . .
2. DO NOT REMOVE parts from trees until ready for use. All parts are identified by a number.
3. Read PAINTING INSTRUCTIONS before assembly. Some parts must be painted before cementing.
4. CUT parts from trees, breaking off may damage part.
5. CHECK FIT of part before cementing into place.
6. Apply cement with a TOOTHPIK on small areas. Too much cement can damage your model.
7. SCRAPE PLATING from plastic parts. Cement WILL NOT stick to plating.
8. DO NOT RUSH assembly. FOLLOW instructions and check off each step as completed.

## EIGHT STEPS TO SUCCESSFUL MODEL BUILDING

segments on the body rear, radio antenna and tow rings. In fact, everything it takes to make this thundering machine a real show-piece for every modeler, whether a car nut or military vehicle nut. Every inch of this big 9 inch model is packed with excitement. Just ask the General. The boys at the oasis loved it.

## MONOGRAM®

KIT 4260 85426000200

"Like the Phoenix arising out of ashes, the coolest, hippest, and most far-out WWII 'Kommand Kar' is back! ROMMEL'S ROD! As mysterious and timeless as the Sphinx of Egypt, arising out of the shifting African sands, Rommel's Rod returns! While no one knows for certain what happened so many years ago to the mysteriously 'disappeared' tooling for the 'Desert foxes' own bones as well as his favorite Kommand Kar, this 1:24 scale plastic model kit has all-new tooling- improved in ways to ensure that you - the modeler - will have even more fun building this kit than you did nearly 40 years ago!"

*Tom Daniel*

If you have any questions or comments, call our hotline at: (800) 833-3570 or, please write to: Revell Inc Consumer Service Department, 1850 Howard Street Unit A, Elk Grove Village, Illinois 60007

Be sure to include the plan number (85426000200), part number, description, your return address and phone number.

Visit our website: [www.revell.com](http://www.revell.com) Revell Inc Elk Grove Village, IL. Copyright © 2009. All rights reserved.

1. Begin by cementing engine halves 1 and 2 together.
2. Attach cylinder head 3\* to top of engine.
3. After attaching transmission top 4 to pan unit 5, cement unit to bottom of engine.
4. Next, cement the timing gear cover 6\* to front of engine.
5. Apply cement to two pins on carburetor unit 7\* and insert into holes in engine block.

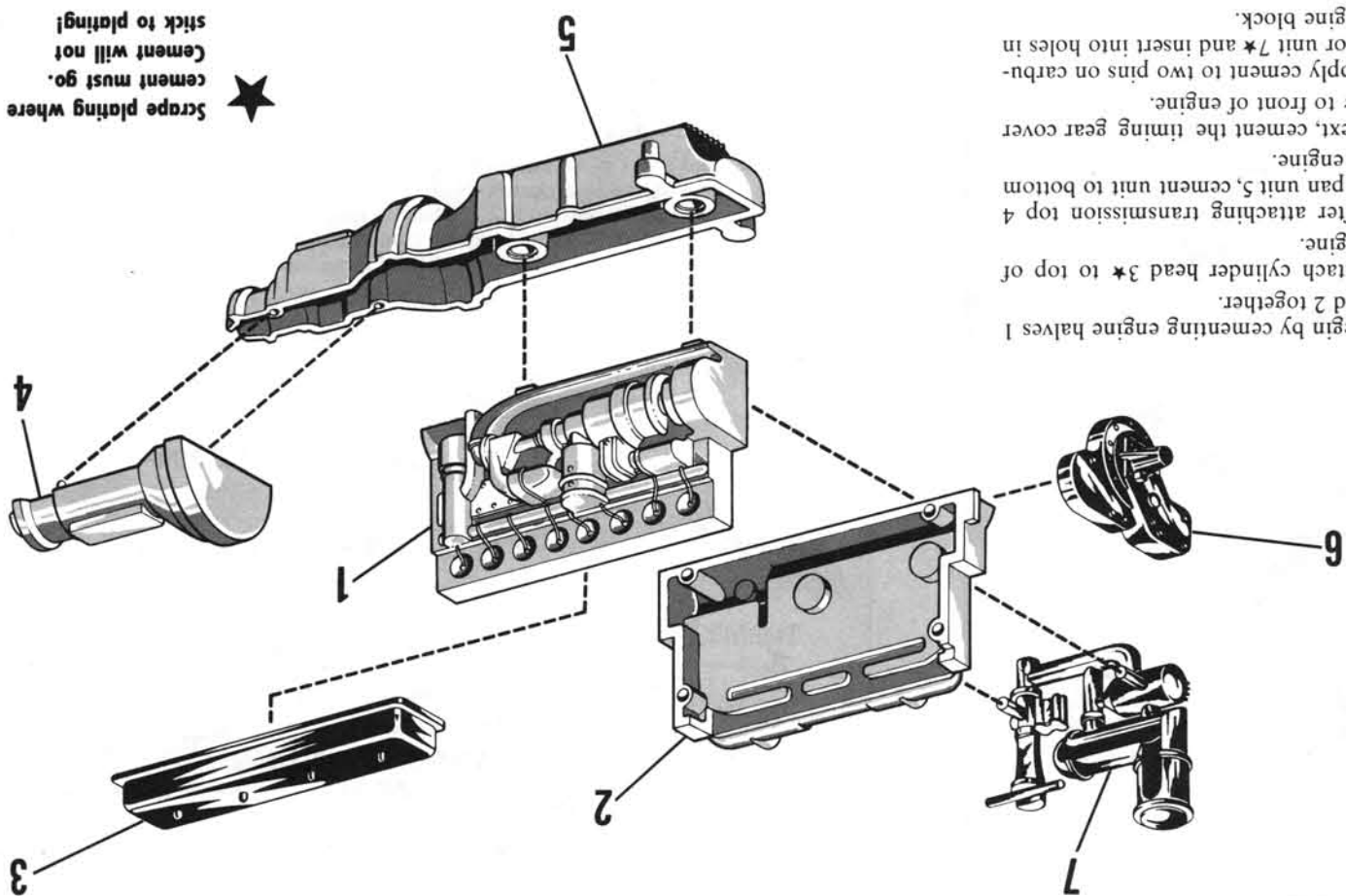

## DECALS

Refer to the photos below and the front page and box illustrations for proper decal locations. For a neat job, work with one subject at a time and trim each close to the color outline.

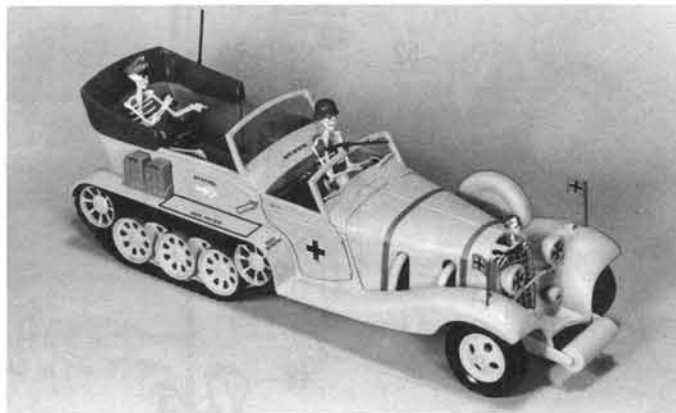

THE  
END

## PAINTING

Your model of Rommel's Rod has been molded in colors which by themselves are attractive. However, if you wish to further enhance the appearance of your model, refer to the box illustration and the detailed color scheme suggested below.

It is best to paint most of the parts before removing them from the plastic trees. Use a small pointed brush for the small parts and a 1/4 inch soft brush for larger areas. Use only PAINT FOR PLASTICS or an ENAMEL.

Allow paint to dry thoroughly before handling parts. Paint should be scraped from areas to be cemented because cement will not adhere to the paint.

**BLACK (FLAT)** — Boggie wheel backgrounds; antenna; ammo box; machine guns; eye and nose sockets, mouths and boots (both figures); steering wheel rim; radiator cap eyes, nose and mouth; inner patterns on running light and headlight lenses; binoculars; cap visor; tow rings on rear of body.

**BROWN (FLAT)** — Track treads; outer rims of boggie wheels; extra track segments on rear of body; front and rear seat cushions; machine gun stocks; flag staffs; hood straps; goggle strap; shovel handle and straps; map table; drivers helmet.

**MEDIUM GRAY** — Body interior; gasoline cans; tool box; shovel blade.

**DARK GRAY** — Rear compartment boot.

**BRASS** — Ammo cartridges; cap eagle.

**WHITE** — Both skeletons and radiator cap skull.

**GREEN** — Der General's cap.

**SILVER** — Binocular and goggle lenses.

**RED** — Fender light lenses.



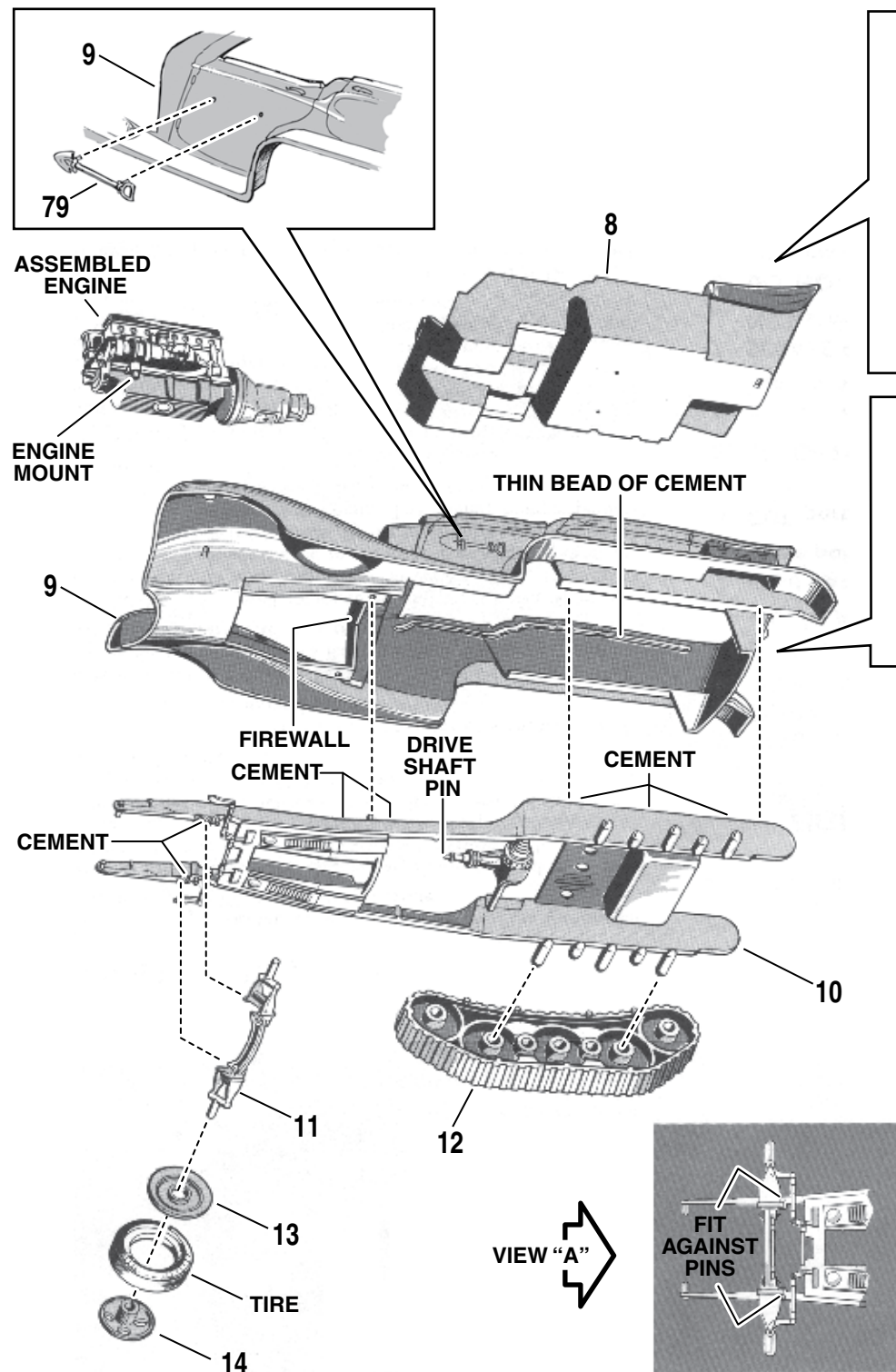

## 2

- 6. Apply cement to two pins on shovel 79 and insert into holes on body 9. Next, apply cement to pins on ammo box 75 and seat 76 then insert into holes in interior 8.
- 7. Cement spare tracks 77 and 78 to rear of body 9.
- 8. Apply a thin bead of cement along both sides of body 9 (see drawing) and insert interior 8. After making sure these parts line up properly, hold in place until cement sets.
- 9. Attach frame 10 to body by applying cement to top edges of frame as shown (see drawing). Check alignment and then hold together tightly until cement sets.
- 10. Apply cement to hole in rear of assembled engine and to engine mounts. Fit rear of engine through firewall and onto pin on drive shaft and engine mounts into holes in frame.
- 11. Apply cement to frame as shown on drawing and attach front suspension 11. Suspension fits against pins on underside of frame. See view "A" for correct location. Next, cement two track assemblies 12 and 80 to frame.
- 12. Press wheel half 13 into tire (do not cement). Apply cement to wheel half 14, press it into other side of tire and hold together until cement sets. Repeat procedure for remaining wheel and cement both wheels onto front axles.

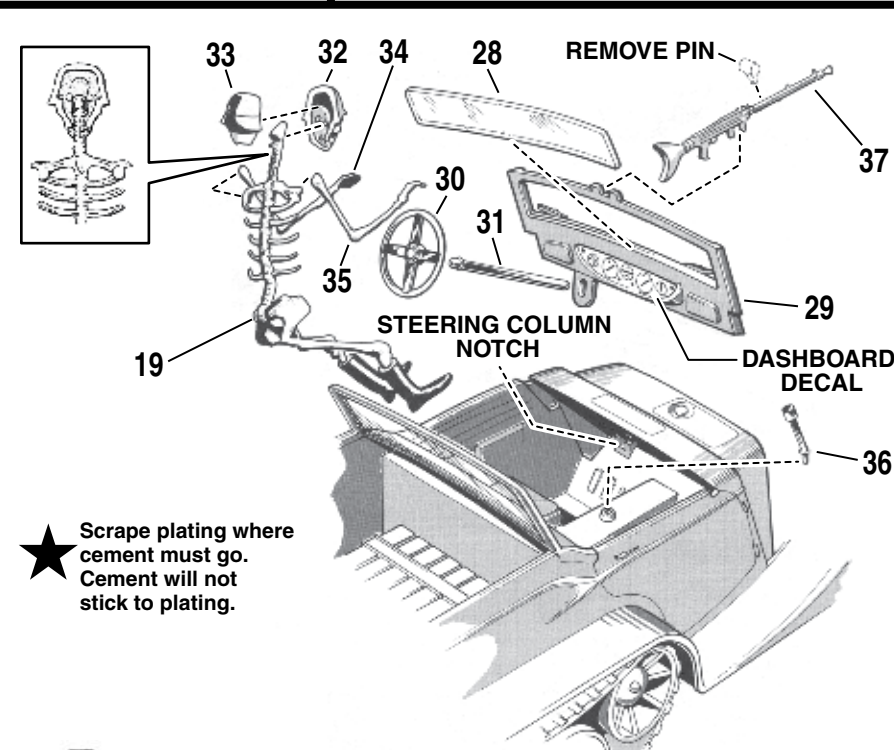
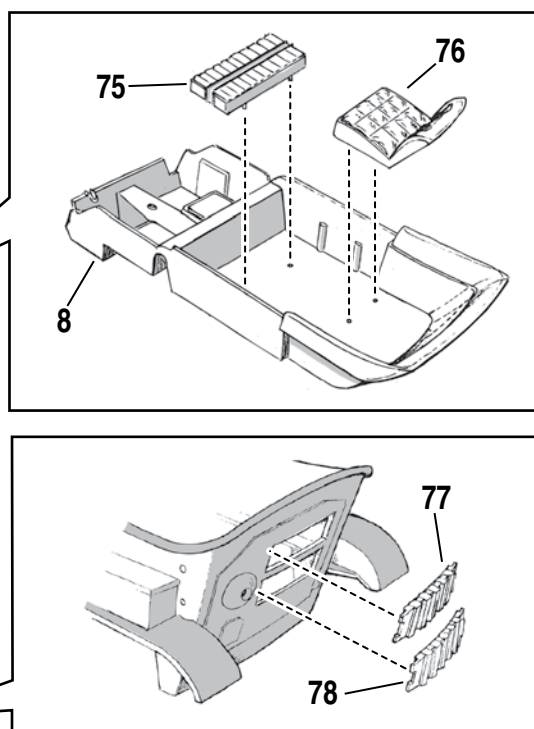

## 4

- 19. Attach front windshield 28 to front windshield frame 29 and cement windshield frame to body.
- 20. Attach steering wheel 30★ to steering column 31★. Apply cement to tip of steering column and slide it through the elongated hole in windshield frame until tip rests in notch in floorboard.
- 21. Cement head front 32 to knob on neck of skeleton 19. Knob fits between pins inside skull as shown in sketch. Next attach head rear 33. Apply cement to underside of skeleton legs and slide skeleton into front seat under steering wheel. Now skeleton arms 34 and 35 can be cemented to shoulder sockets and to the steering wheel (tweezers will help to fit the arms into place).
- 22. Complete this step by cementing gear shift 36★ to floor tunnel and front machine gun 37 to windshield frame.

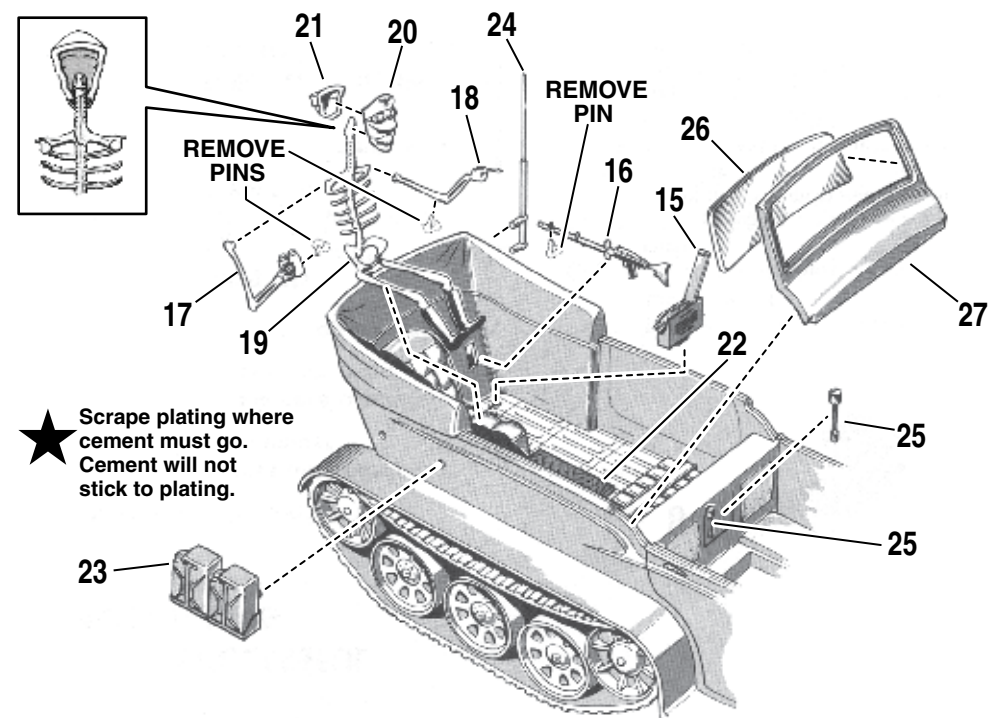

## 3

- 14. Cement tab on ammo box 15 into slot in floor. Next, remove pin from barrel of rear machine gun 16. Apply cement to pins on gun as indicated on drawing and attach it with pins on gun fitting through hole in interior wall.
- 15. Cement head front 20 to knob on neck of skeleton 19. Knob fits inside skull (see inset). Now attach head rear 21. Next remove pins from arms 17 and 18 and cement arms to skeleton.
- 16. Cement completed skeleton to rear seat and map table 22 to right side of interior.
- 17. Gasoline cans 23 and antenna 24 should now be attached to body.
- 18. After cementing two hand grenades 25★ between front seats, cement clear windshield 26 to rear windshield frame 27. Now attach windshield frame to body.

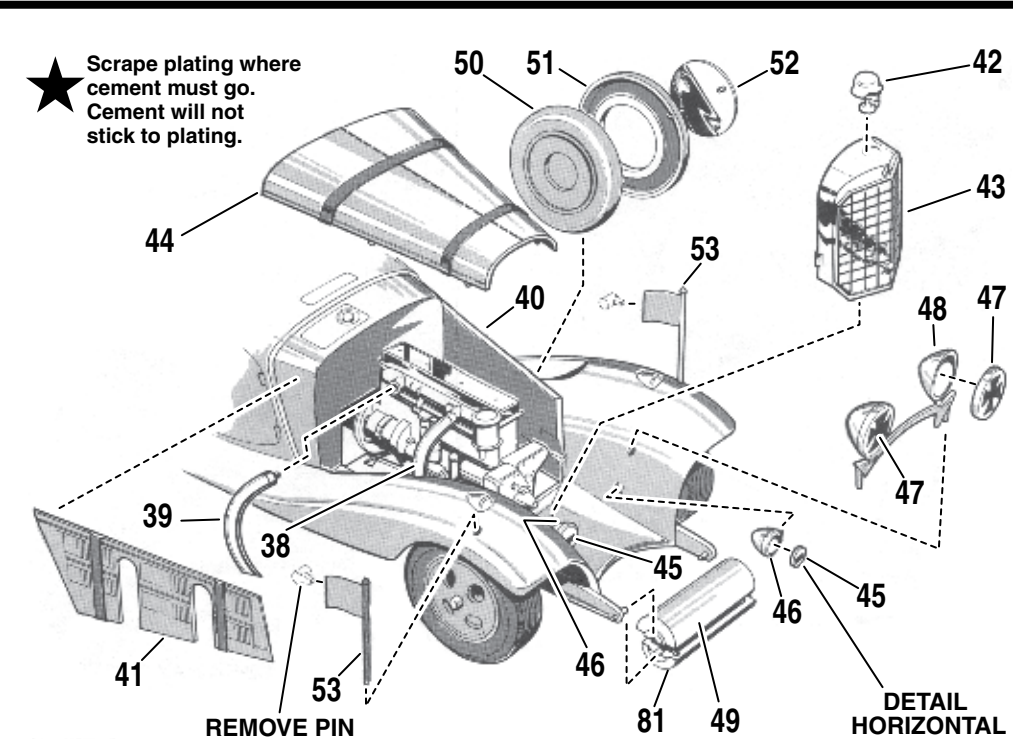

## 5

- 23. Cement exhaust pipes 38 and 39 to engine. Make sure lower ends of pipes line up with holes in fender. Hold in place until cement sets.
- 24. Next attach side panels 40 and 41 to body.
- 25. After attaching radiator cap 42★ to radiator shell 43★, apply cement to rear and underside edges of shell and attach to side panels and body.
- 26. Hood 44 can now be cemented to top edges of side panels. However, if you wish to display the engine, merely fit the hood into place without cement.
- 27. Attach two lenses 45 to running lights 46 with detail on lenses horizontal as shown on drawing. Cement tab on each light to depressions on front fenders.
- 28. Cement two headlight lenses 47 to headlights 48 and cement unit into holes in fenders.
- 29. Next, cement two roller bumper halves 49 and 81 together over pins on front of frame.
- 30. After cementing spare tire halves 50 and 51 together, attach hub cover 52★ to outer rim and cement assembly into fender well.
- 31. Remove pins from flags 53. Next apply flag decals and cement flags to holes in fenders. Hold in upright position until cement sets.