



KIT 2894

85289400200

'40 FORD STREET ROD

One of the most popular of the pre-war Ford Motor Company models was the 1940. Although only a minor facelift of the '39 models, the '40 featured handsome good looks with its new horizontal bar grille design and chevron style tail lamps. Offered in a range of body configurations including Tudor and Fordor sedans, convertible and "woody" station wagons, it was the five window coupe body styles that became the most popular with hot rodders both then and now. It was basically a three passenger coupe, although some versions had fold-up rear jump seats, and featured a flowing design with its short roof and large trunk. The stylish separate front and rear fenders integrated well with the overall shape. New engineering features included sealed beam safety headlamps and the relocation of the gearshift from the floor to the steering column. Over 540,000 units were produced in 1940, a year that also saw the 28 millionth Ford car built, a milestone that was reached in April of that year.

The '40 Ford coupe was offered new with two versions of the famous Ford flathead V-8. Many hot rod and street rod enthusiasts swear by the durable little engine and have kept them between the fenders of theirs. Yet, it's not unusual to go to a show or event today and see '40 Fords with every engine type imaginable under the hood. The car's "fat-fendered" classic styling lends itself with modern wheels and

tires as well as both traditional and wild paint schemes. We've included in this new Revell® kit some of the more popular items hot rodders like to add to their rides including a dual carb setup for the flathead and a dropped front axle for that "just right" stance. But feel free to add parts from some of your other kits to create your own personalized '40 Ford Coupe Street Rod.

If you count yourself among the millions of people that love hot rods, street rods and customs of all types, then you may want to check out the Goodguys Rod & Custom Association, the nation's leader in producing and promoting exciting automotive enthusiast events. The Goodguys have over 70,000 members worldwide and currently hold 22 annual events across the US. Whether you drive in your own creation and participate or just come by to eyeball all the fantastic machinery, the Goodguys invite you and your family and guarantee a good time. There's something for everyone, including modelers! Just click on their website at www.good-guys.com for all the information on the next event nearest you.

While you're there, you can join their mailing list and even become a member, which among many benefits also brings you a subscription to the Goodguys Gazette, their monthly 140+ page large format magazine chock full of event coverage and plenty of full-color pictures of some of the most jaw-dropping rods and customs you've ever laid your eyes on.



* REPEAT SEVERAL TIMES
* A REPETER PLUSIEURS FOIS



* OPTIONAL PARTS
* PIECES EN OPTION



* DECAL
* DECAL COMANIE



* ALTERNATIVE ASSEMBLY
* ENSEMBLAGE ALTERNATIVE



* CEMENT TOGETHER
* A COLLER



* REMOVE AND THROW AWAY
* A RETIRER ET JETER



* DO NOT CEMENT
* NE PAS COLLER

READ THIS BEFORE YOU BEGIN

- * Study the assembly drawings.
- * Each plastic part is identified by a number.
- * In the assembly drawings, some parts will be marked by a star (★) to indicate chrome plated plastic.
- * For better paint and decal adhesion, wash the plastic parts in a mild detergent solution. Rinse and let air dry.
- * Check the fit of each piece before cementing in place.
- * Use only cement for polystyrene plastic.
- * Scrape plating and paint from areas to be cemented.
- * Allow paint to dry thoroughly before handling parts.
- * Any unused parts may be discarded.

DECAL APPLICATION INSTRUCTIONS

1. Cut desired decal from sheet.
2. Dip decal in water for a few seconds.
3. Place wet decal on paper towel.
4. Wait until decal is movable on paper backing.
5. Place decal in position on model, face up and slide backing away.
6. Press out air bubbles with a soft damp cloth.
7. Milkiness that may appear is for better decal adhesion and will dry clear. Wipe away any excess adhesive.
8. Do not touch decal until fully dry.
9. Allow the decals 48 hours to dry before applying clear coat.

NOTE: Decals are compatible with setting solutions or solvents.

LIRE CE QUI SUIT AVANT DE COMMENCER

- * Etudier les schémas de montage.
- * Chaque pièce en plastique est identifiée par un numéro.
- * Sur les schémas de montage, certaines pièces sont marquées d'une étoile (★) pour indiquer qu'elles sont en plastique chromé.
- * Pour une meilleure prise de la peinture et des autocollants, laver les pièces en plastique avec une solution détergente peu concentrée. Les rincer et les laisser sécher à l'air.
- * Vérifier que chaque pièce s'ajuste bien avant de la coller en place.
- * N'utiliser que de la colle pour polystyrène.
- * Gratter les parties à coller pour enlever le chrome et la peinture.
- * Laisser la peinture bien sécher avant de manipuler les pièces.
- * Toute pièce inutilisée peut être jetée.

DIRECTIVES D'APPLICATION DES AUTOCOLLANTS

1. Découper l'autocollant désiré de la feuille.
2. Tremper l'autocollant dans de l'eau pendant quelques secondes.
3. Placer l'autocollant mouillé sur une serviette en papier.
4. Attendez que l'autocollant puisse être déplacé sur son support en papier.
5. Mettre l'autocollant en position sur le modèle face sur le dessus et faire glisser le support pour l'enlever.
6. Appuyer avec un chiffon doux humide pour éliminer les bulles d'air.
7. La substance laiteuse qui peut apparaître est destinée à améliorer l'adhésion de l'autocollant et devient incolore au séchage. Essuyer pour enlever tout excédent d'adhésif.
8. Ne pas toucher l'autocollant tant qu'il n'est pas bien sec.
9. Laisser l'autocollant sécher pendant 48 heures avant d'appliquer une couche transparente.

REMARQUE: Les autocollants sont compatibles avec les solutions de fixation ou les solvants.

This paint guide is provided to complete this kit as shown on the box.

Ce guide de peinture est fourni pour reproduire le modèle réduit qui apparaît sur la boîte.

Aluminum	Aluminium
Tan	Havane foncé
Flat Black	Noir mat
Gloss Red	Rouge lustré
Gunmetal	Bronze
Satin Black	Noir satiné
Tan	Havane
Transparent Red	Rouge transparent

If you have any questions or comments, call our hotline at: **(800) 833-3570** or, please write to:

Revell-Monogram Consumer Service Department, 725 Landwehr Road, Northbrook, Illinois 60062

Be sure to include the plan number (85289400200), part number, description, your return address and phone number.

Visit our website: www.revell-monogram.com

1

ENGINE ASSEMBLY

A

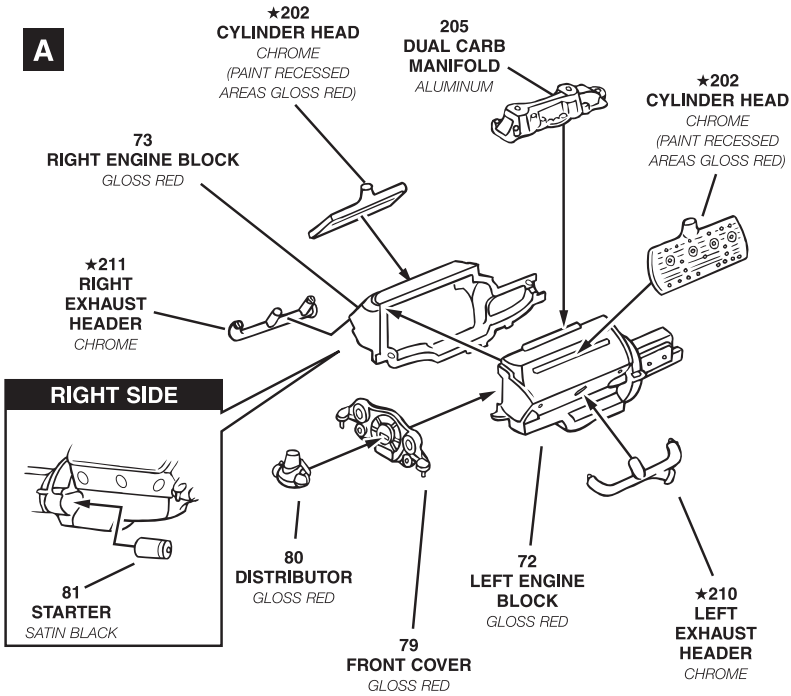

B

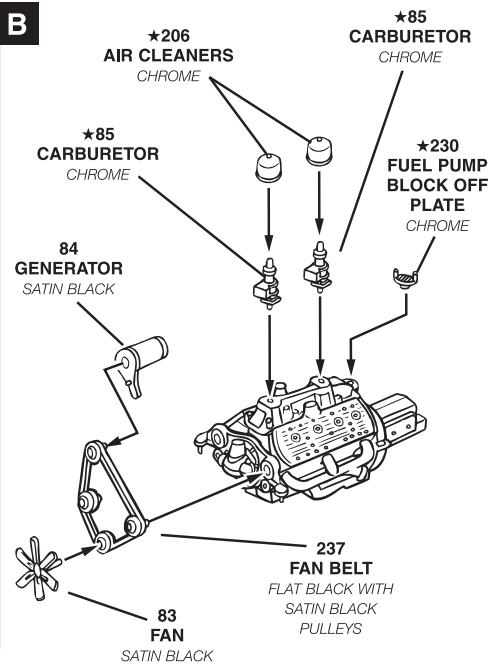

2

CHASSIS/REAR SUSPENSION ASSEMBLY

A

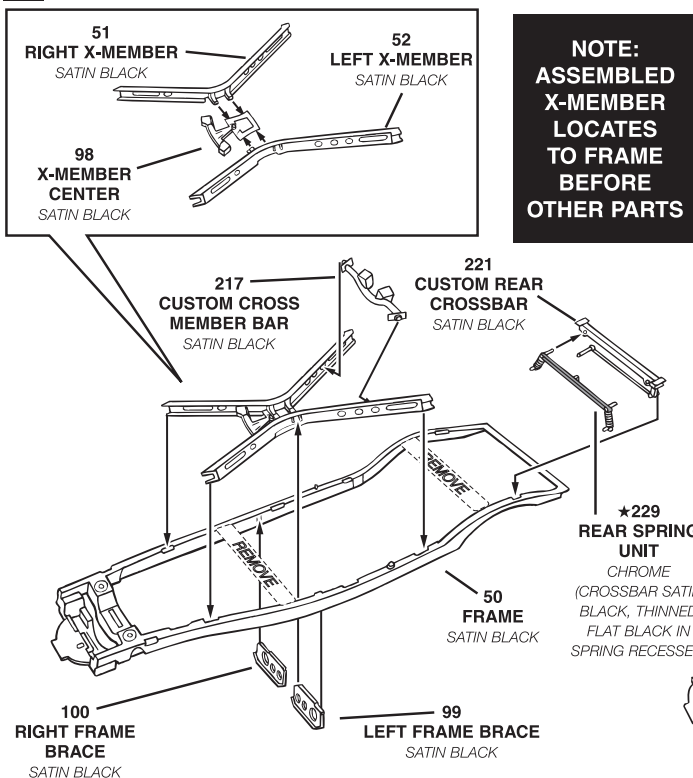

B

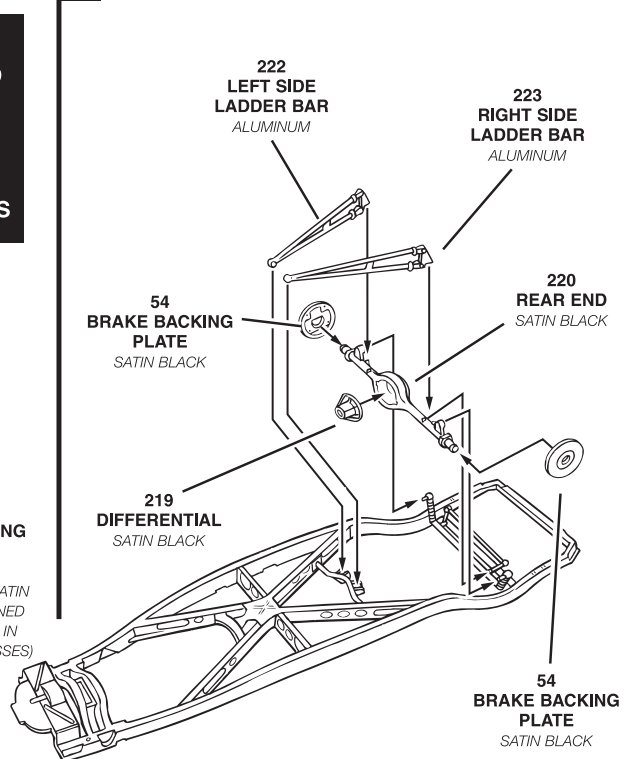

3

EXHAUST ASSEMBLY

NOTE: LOCATE FRONT EXHAUST PARTS #212 AND 213 TO FRAME BEFORE TAILPIPES

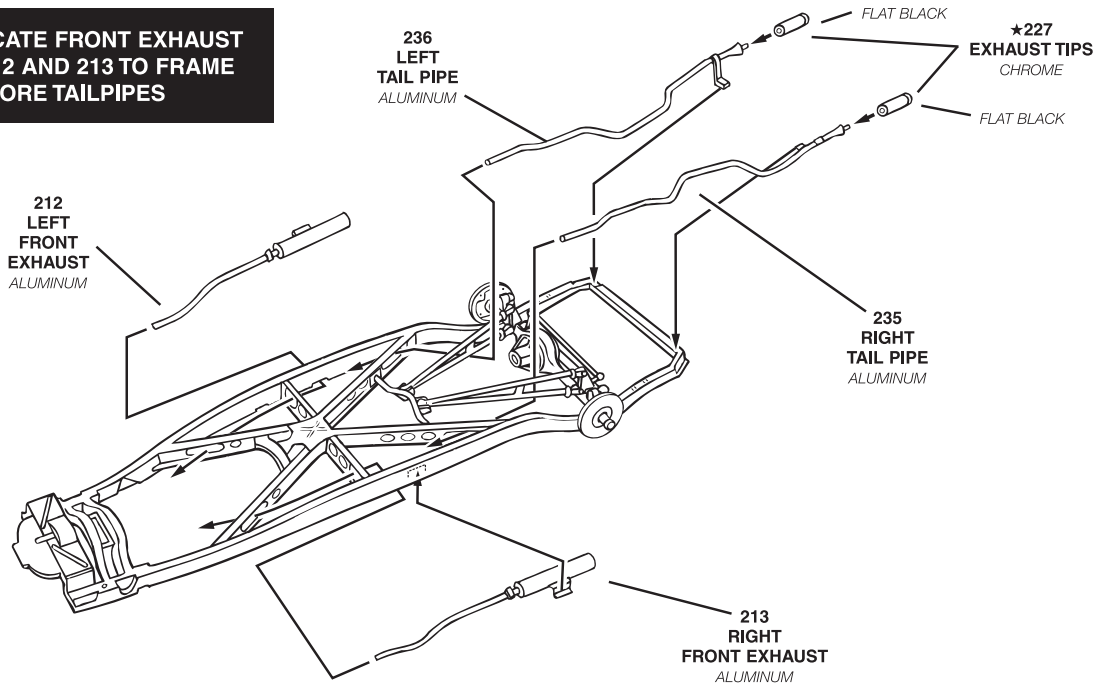

4

FRONT SUSPENSION ASSEMBLY

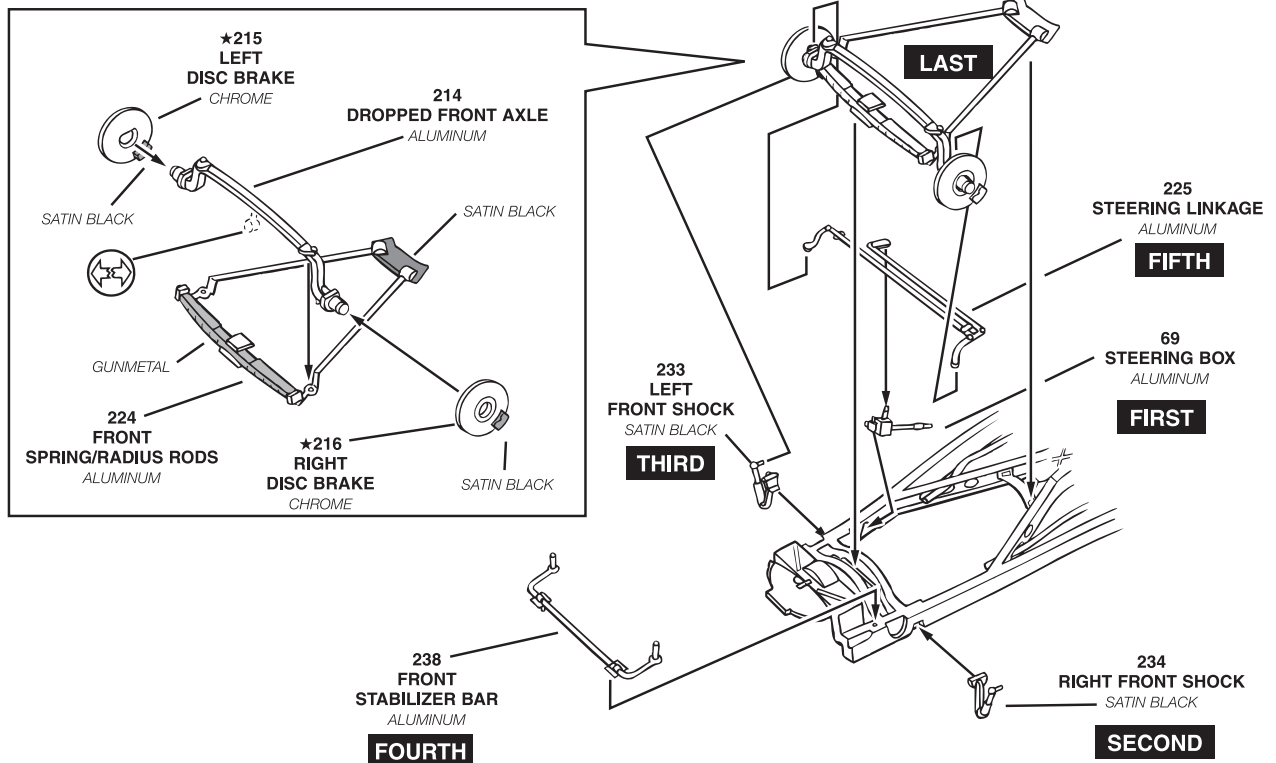

5

RADIATOR ASSEMBLY

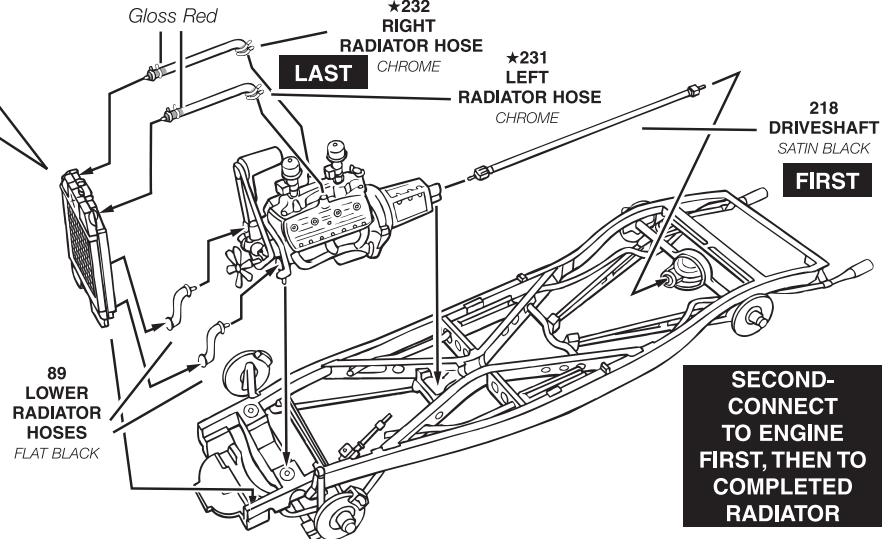
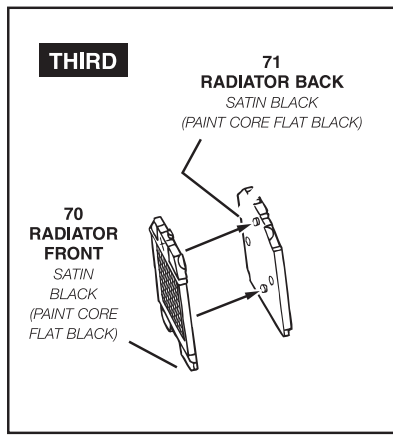

SECOND-CONNECT TO ENGINE FIRST, THEN TO COMPLETED RADIATOR

6

TIRE AND WINDOW ASSEMBLY

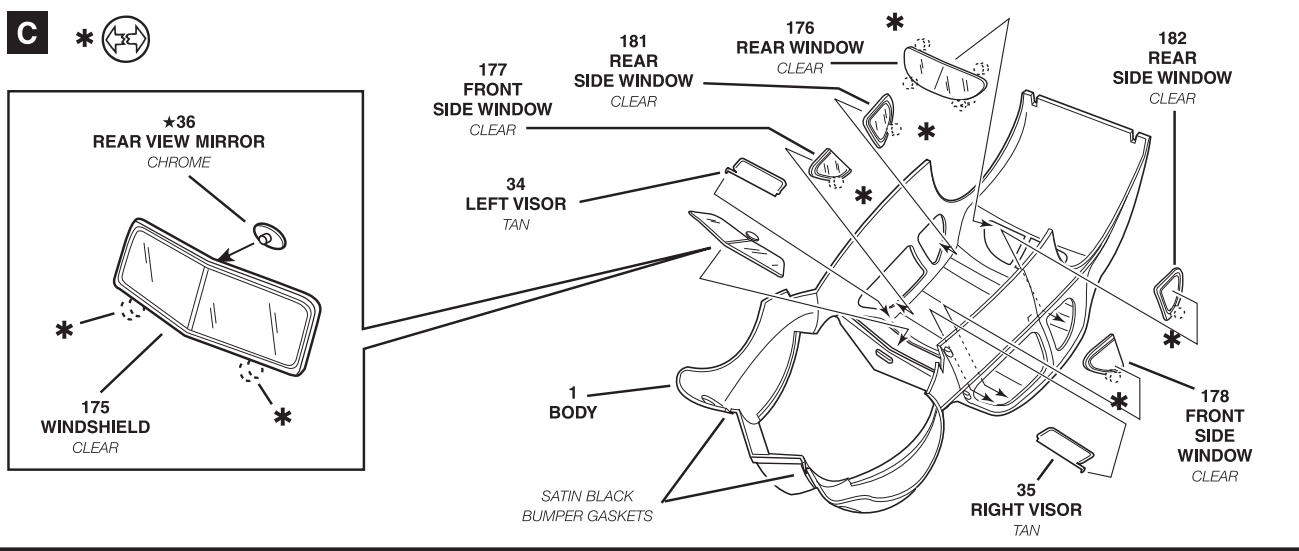
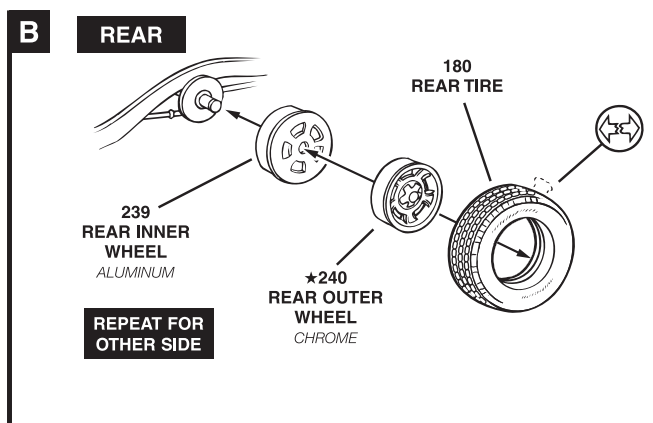
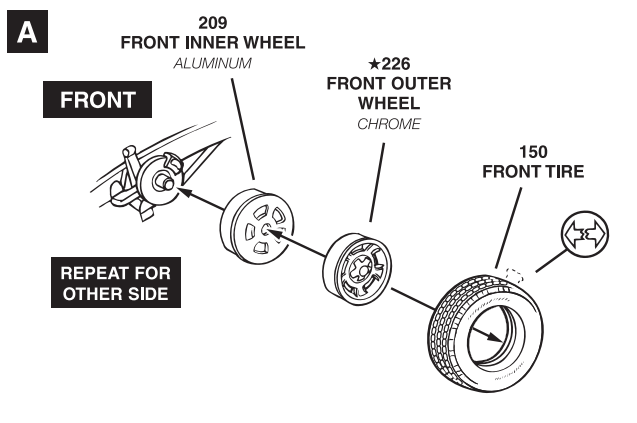

7

FIREWALL AND DASH ASSEMBLY

A

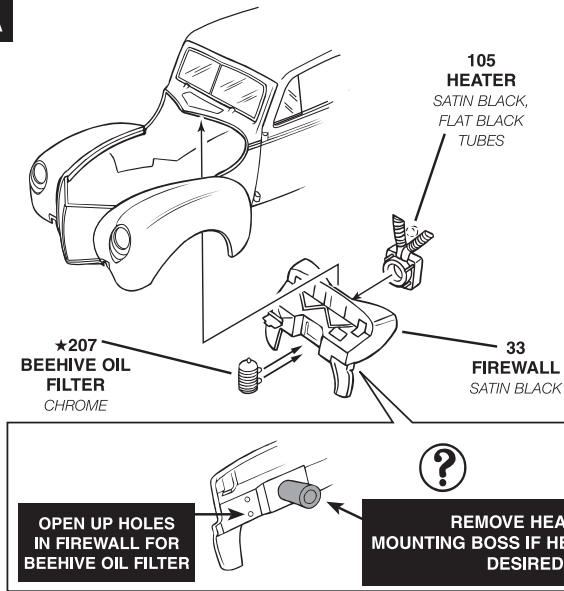

B

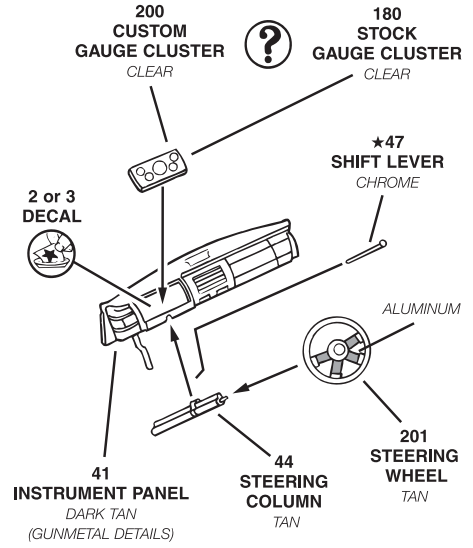

8

INTERIOR AND BODY ASSEMBLY

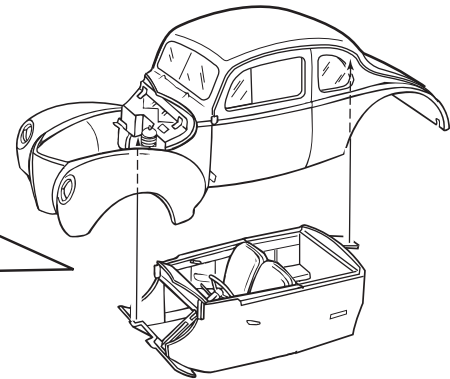
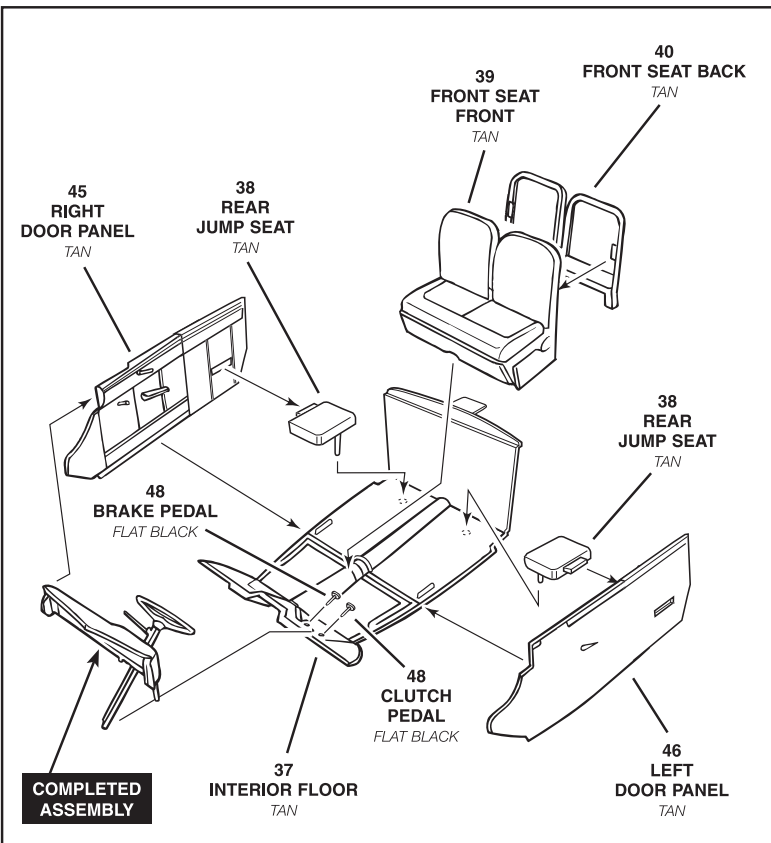

NOTE: LOCATE ASSEMBLED INTERIOR INTO BODY FIRST; THEN LOCATE FLOOR PAN

A

MODELING TIP
 TO ENSURE PROPER FIT OF INNER FENDER APRONS, GLUE THEM IN PLACE SO THAT OUTER EDGE OF MOUNTING SURFACE OF FIREWALL RESTS ON INSIDE SURFACE OF FENDER APRON

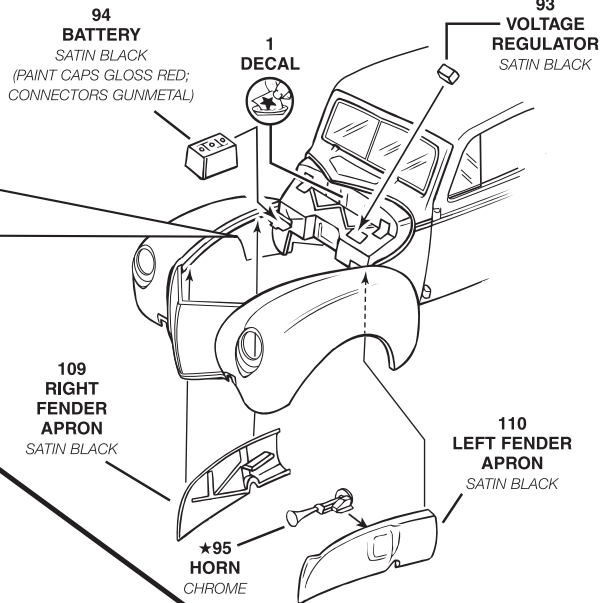
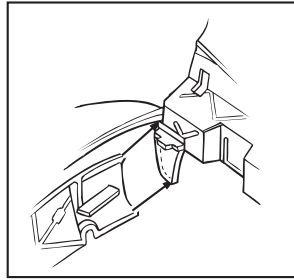

B

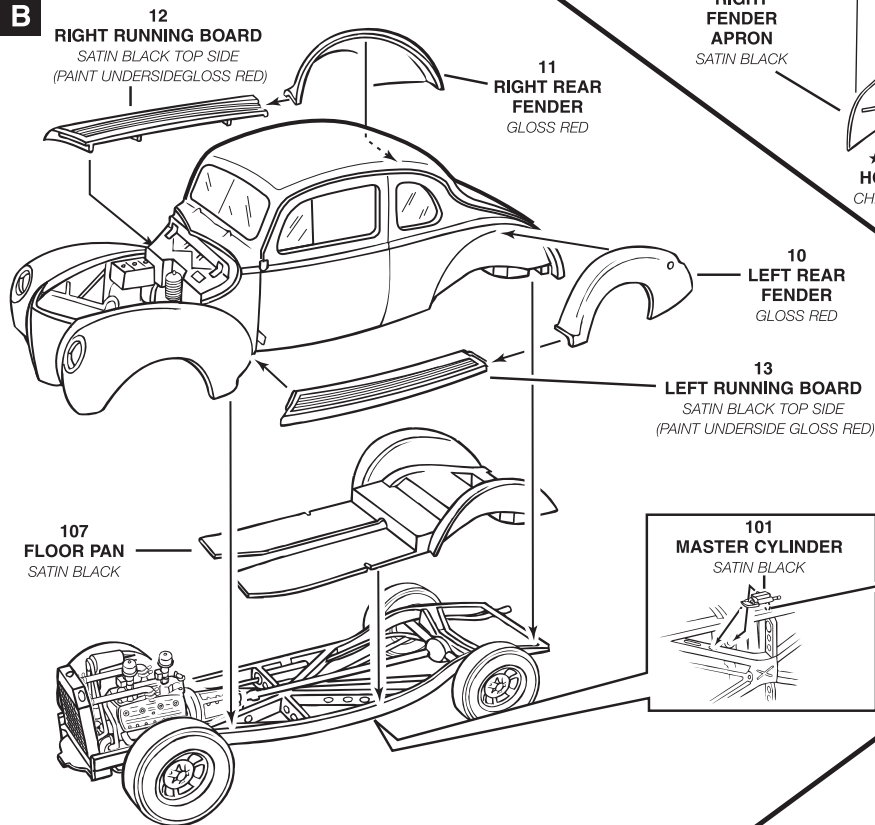

NOTE: LOCATE REAR FENDERS TO BODY BEFORE THE RUNNING BOARDS

C

NOTE: YOUR REVELL KIT HAS TWO TAILLIGHTS INCLUDED. THE STANDARD ONLY HAD ONE TAILLIGHT. THE DELUXE VERSION HAD TWO

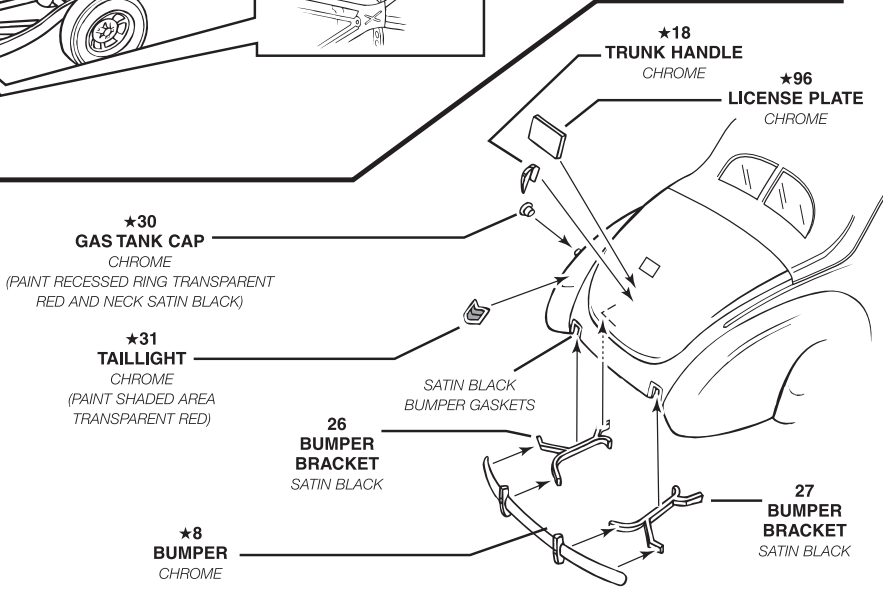

D

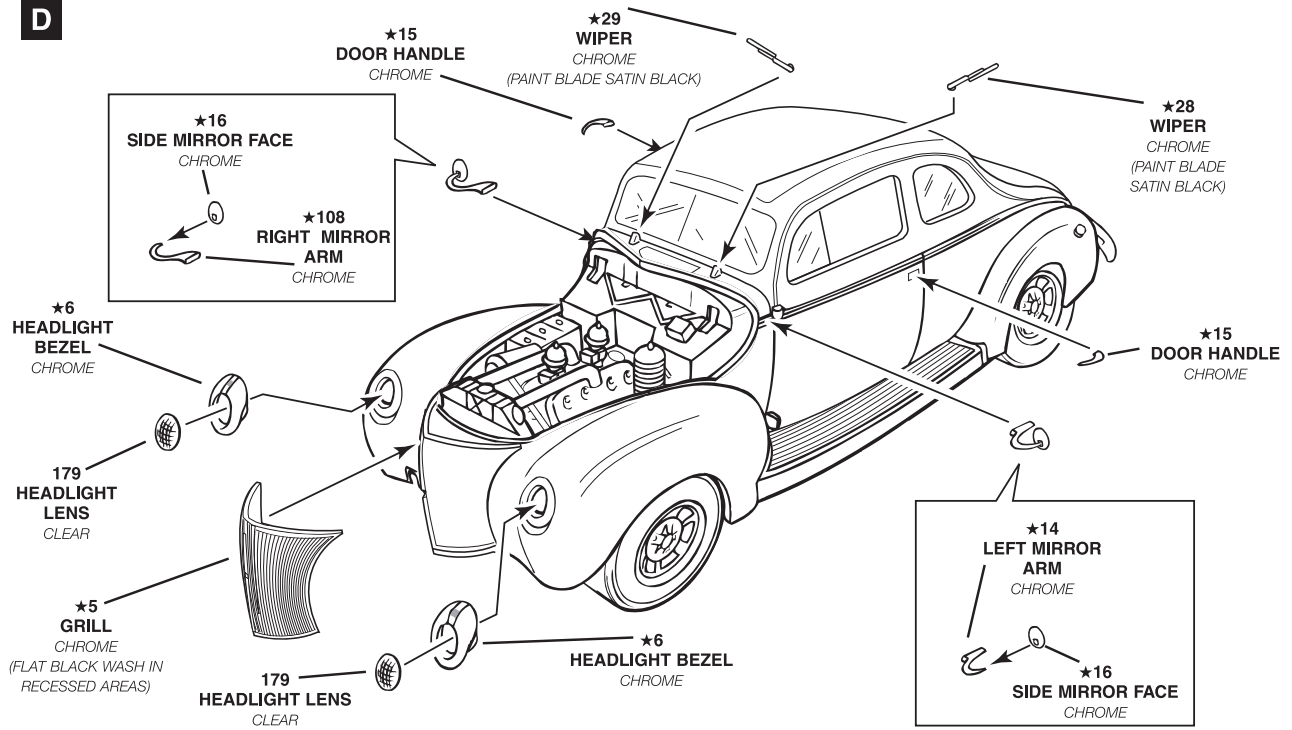

E

