

'51 HENRY J DRAG COUPE

The Henry J two-door economy sedan was one of America's first compact cars- truly ahead of it's time, it was introduced to the motoring public in 1951 by the Kaiser Motor Corporation. Three years later, in 1954, the Henry J became automotive history, another victim of poor sales and public non-acceptance. The surviving Henry J's were largely forgotten and eventually faded into obscurity.

Fast forward to the 1960's where the little Henry J enjoyed a come-back not as a stock street car but a fire breathing drag machine. The lightweight

Henry J ran in the highly competitive drag Gas class and could hold it's own against the popular Anglia and Willys cars and run with the best of them of them at the time.

Your Revell '51 Henry J model comes with a full tilt front end surrounding a blown big block V-8, modular alloy wheels, and prototypacal small front tires and big drag slicks in the rear. The interior features a custom steering wheel and upholstery, bucket seats and a roll bar.



* REPEAT SEVERAL TIMES
* A REPETER PLUSIEURS FOIS



* OPTIONAL PARTS
* PIECES EN OPTION



* DECAL
* DECAL COMANIE



* ALTERNATIVE ASSEMBLY
* ENSEMBLAGE ALTERNATIVE



* CEMENT TOGETHER
* A COLLER



* REMOVE AND THROW AWAY
* A RETIRER ET JETER



* DO NOT CEMENT
* NE PAS COLLER

READ THIS BEFORE YOU BEGIN

- * Study the assembly drawings.
- * Each plastic part is identified by a number.
- * In the assembly drawings, some parts will be marked by a star (★) to indicate chrome plated plastic.
- * For better paint and decal adhesion, wash the plastic parts in a mild detergent solution. Rinse and let air dry.
- * Check the fit of each piece before cementing in place.
- * Use only cement for polystyrene plastic.
- * Scrape plating and paint from areas to be cemented.
- * Allow paint to dry thoroughly before handling parts.
- * Any unused parts may be discarded.

DECAL APPLICATION INSTRUCTIONS

1. Cut desired decal from sheet.
2. Dip decal in water for a few seconds.
3. Place wet decal on paper towel.
4. Wait until decal is movable on paper backing.
5. Place decal in position on model, face up and slide backing away.
6. Press out air bubbles with a soft damp cloth.
7. Milkyness that may appear is for better decal adhesion and will dry clear. Wipe away any excess adhesive.
8. Do not touch decal until fully dry.
9. Allow the decals 48 hours to dry before applying clear coat.

LIRE CE QUI SUIT AVANT DE COMMENCER

- * Etudier les schémas de montage.
- * Chaque pièce en plastique est identifiée par un numéro.
- * Sur les schémas de montage, certaines pièces sont marquées d'une étoile (★) pour indiquer qu'elles sont en plastique chromé.
- * Pour une meilleure prise de la peinture et des autocollants, laver les pièces en plastique avec une solution détergente peu concentrée. Les rincer et les laisser sécher à l'air.
- * Vérifier que chaque pièce s'ajuste bien avant de la coller en place.
- * N'utiliser que de la colle pour polystyrène.
- * Gratter les parties à coller pour enlever le chrome et la peinture.
- * Laisser la peinture bien sécher avant de manipuler les pièces.
- * Toute pièce inutilisée peut être jetée.

DIRECTIVES D'APPLICATION DES AUTOCOLLANTS

1. Découper l'autocollant désiré de la feuille.
2. Tremper l'autocollant dans de l'eau pendant quelques secondes.
3. Placer l'autocollant mouillé sur une serviette en papier.
4. Attendez que l'autocollant puisse être déplacé sur son support en papier.
5. Mettre l'autocollant en position sur le modèle face sur le dessus et faire glisser le support pour l'enlever.
6. Appuyer avec un chiffon doux humide pour éliminer les bulles d'air.
7. La substance laiteuse qui peut apparaître est destinée à améliorer l'adhésion de l'autocollant et devient incolore au séchage. Essuyer pour enlever tout excédent d'adhésif.
8. Ne pas toucher l'autocollant tant qu'il n'est pas bien sec.
9. Laisser l'autocollant sécher pendant 48 heures avant

This paint guide is provided to complete this kit as shown on the box.

Ce guide de peinture est fourni pour reproduire le modèle réduit qui apparaît sur la boîte.

FLAT TAN	BRUN MAT
GOLD	DORE
GLOSS RED	ROUGE LUSTRE
FLAT LIGHT GRAY	GRIS MAT
WHITE	BLANC LUSTRE
GLOSS BLACK	NOIR LUSTRE
ALUMINUM	ALUMINIUM
FLAT BLACK	NOIR MAT

Visit our website: www.revell.com

1

WINDOW ASSEMBLY

CUTTING TEMPLATE

A
FRONT

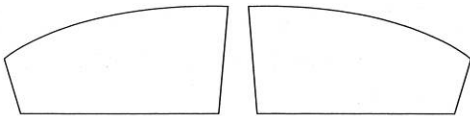
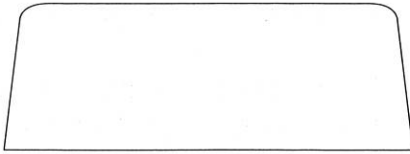

C
SIDE

D
SIDE

B
BACK

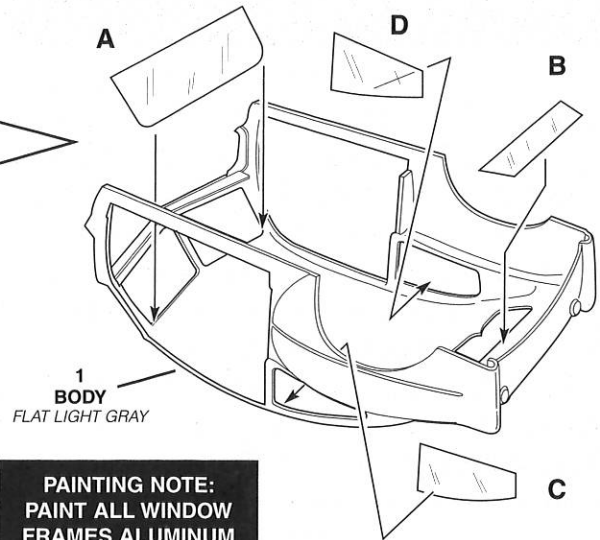

1
BODY
FLAT LIGHT GRAY

**PAINTING NOTE:
PAINT ALL WINDOW
FRAMES ALUMINUM**

2

FIREWALL / DASH ASSEMBLY

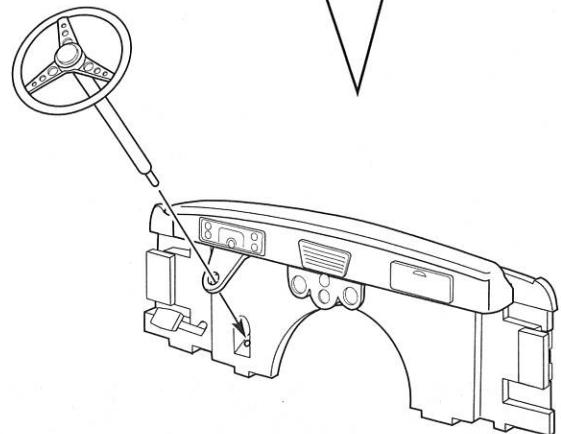
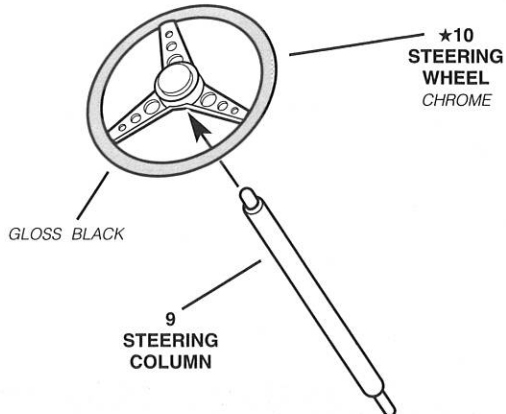
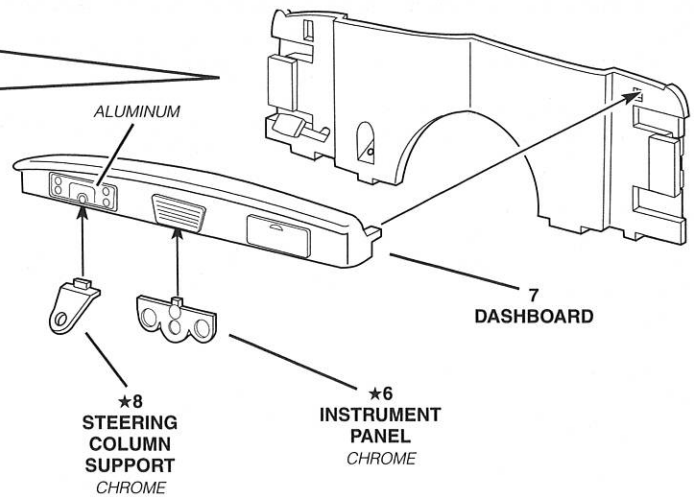
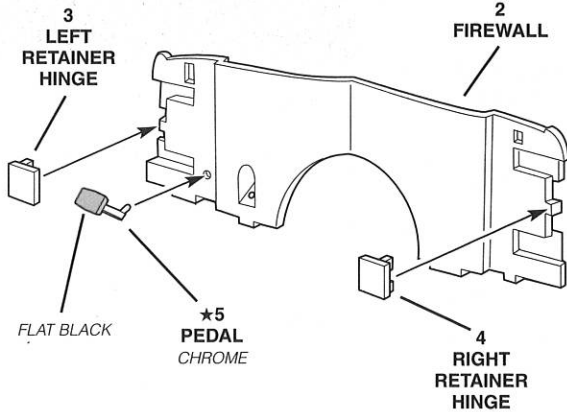

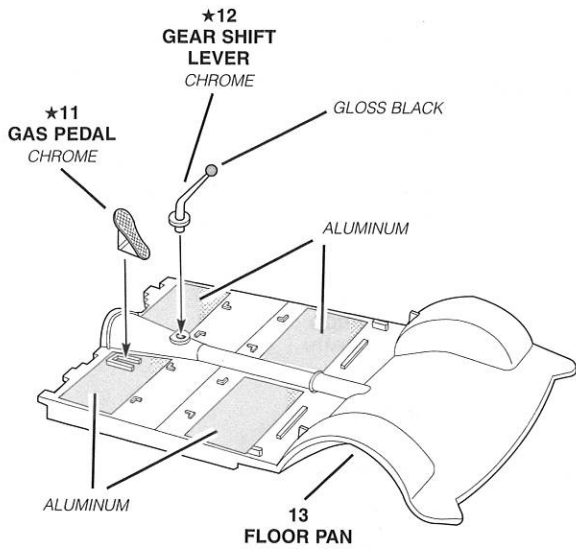

COMPLETED DASH AND FIREWALL

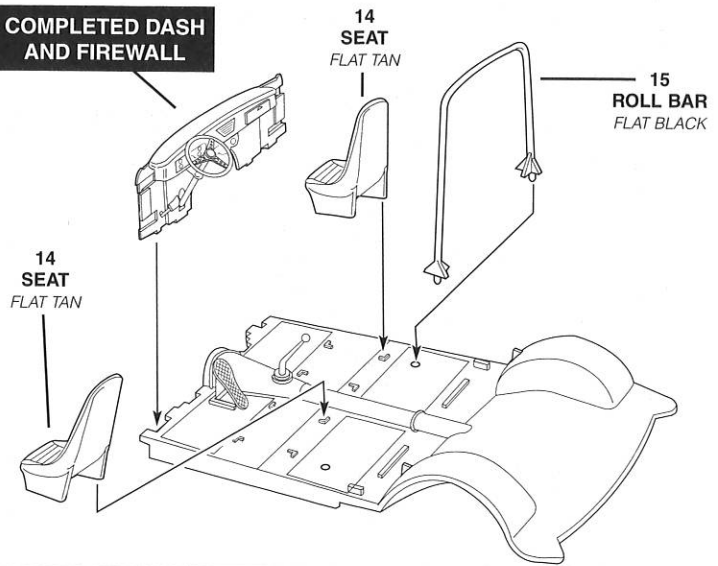

YOU CAN REVERSE THE REAR PANELS USING EITHER ONE FOR EITHER SIDE

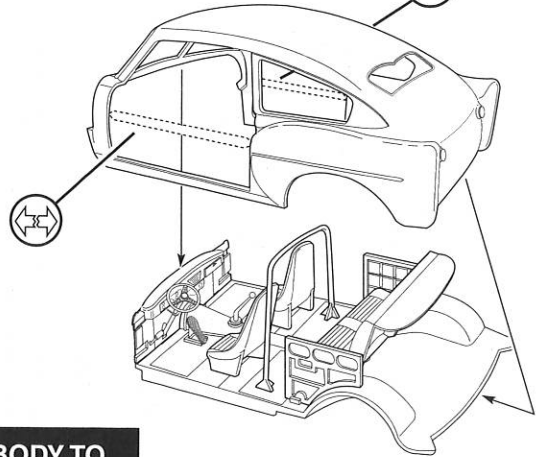
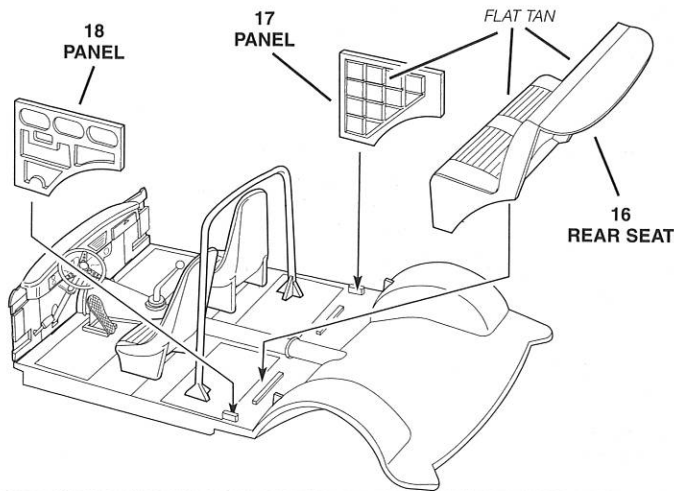

BODY TO INTERIOR

LEFT DOOR

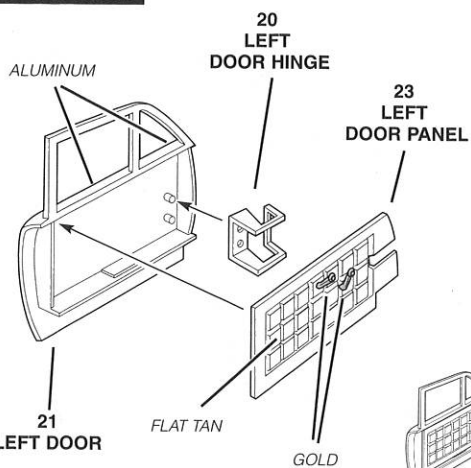

YOU CAN REVERSE THE DOOR PANELS USING EITHER ONE FOR EITHER SIDE

RIGHT DOOR

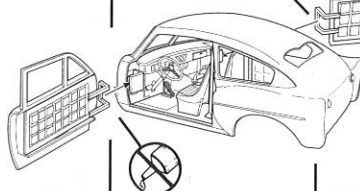
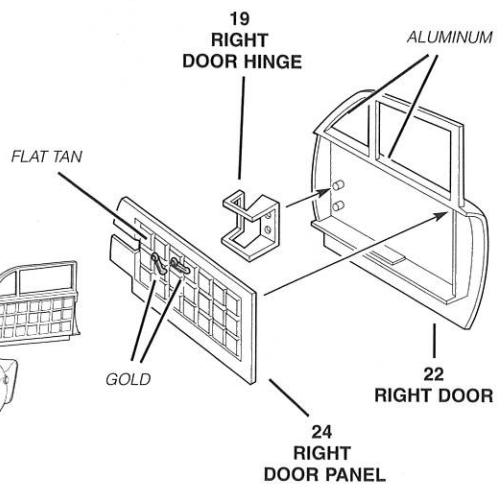

4

FRONT/REAR SUSPENSION ASSEMBLY

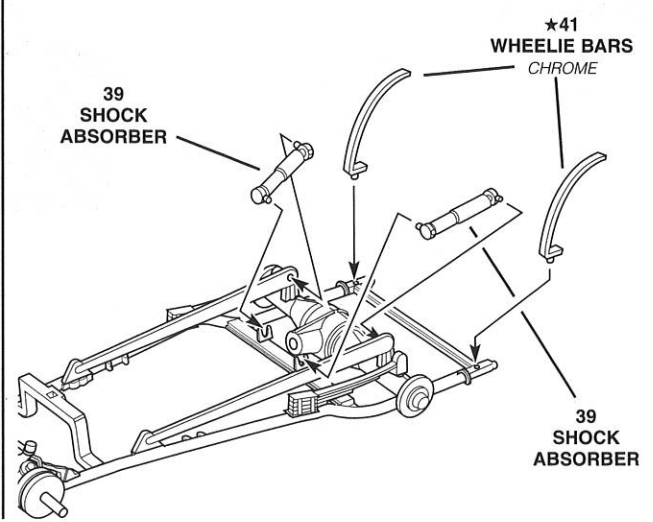
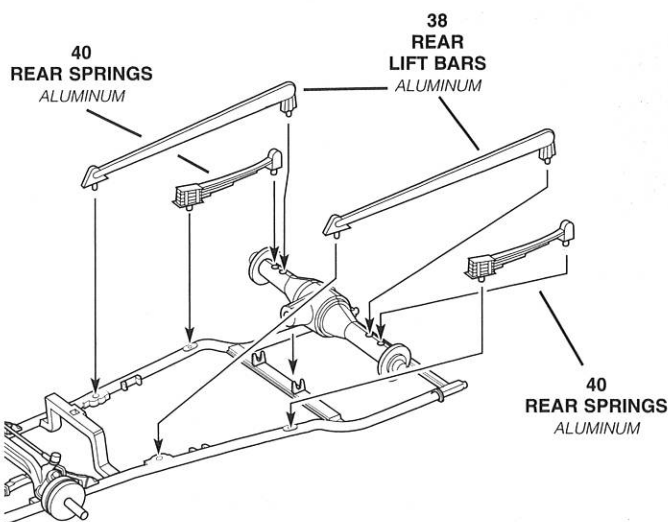
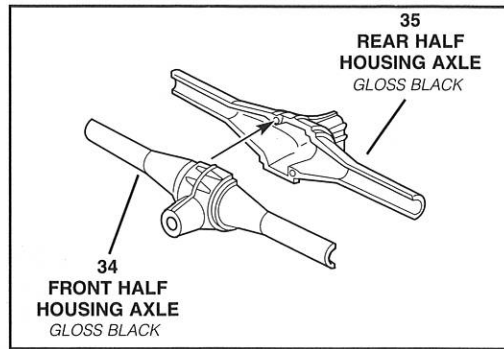
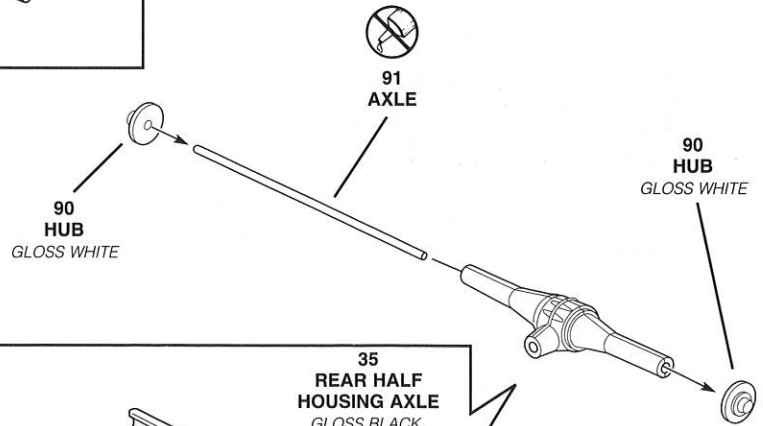
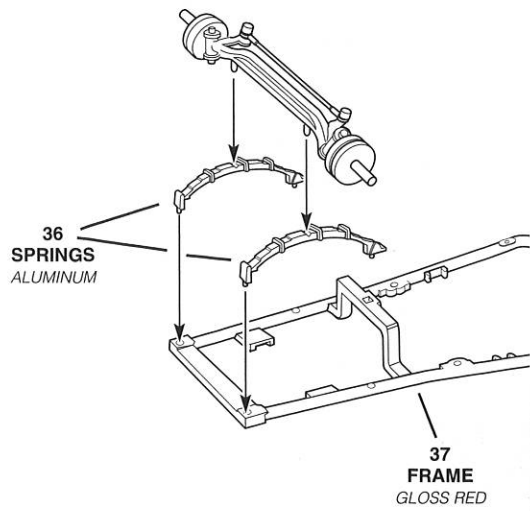
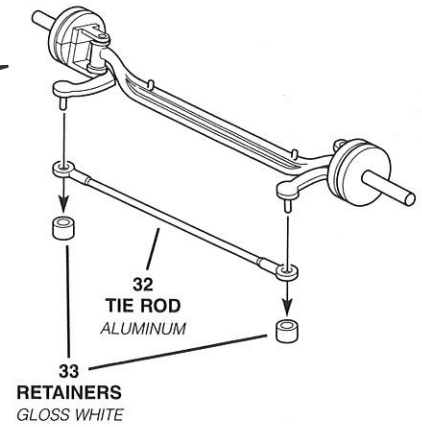
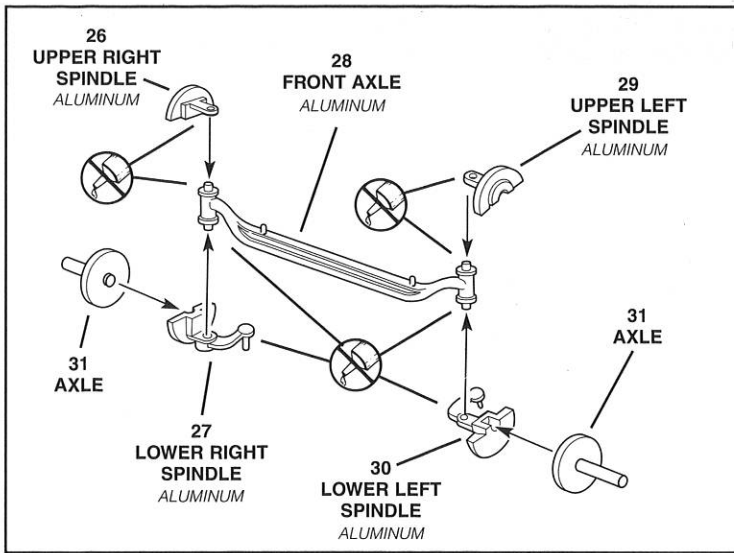

ENGINE ASSEMBLY

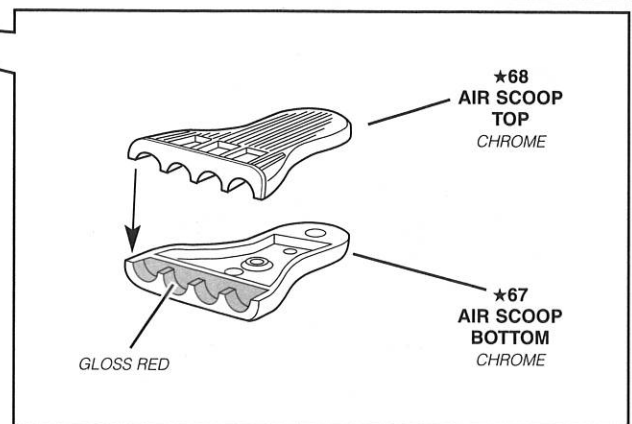
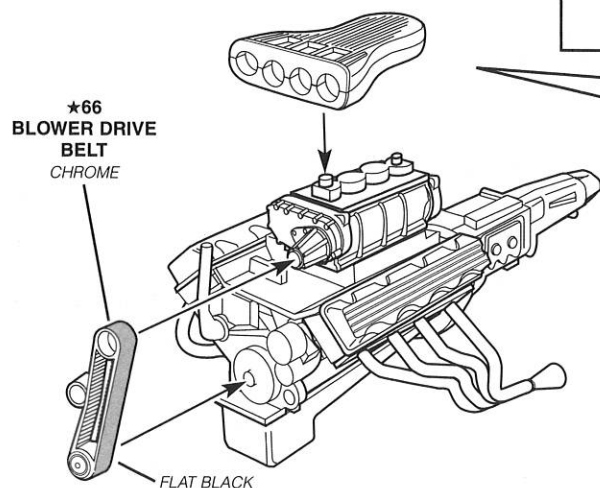
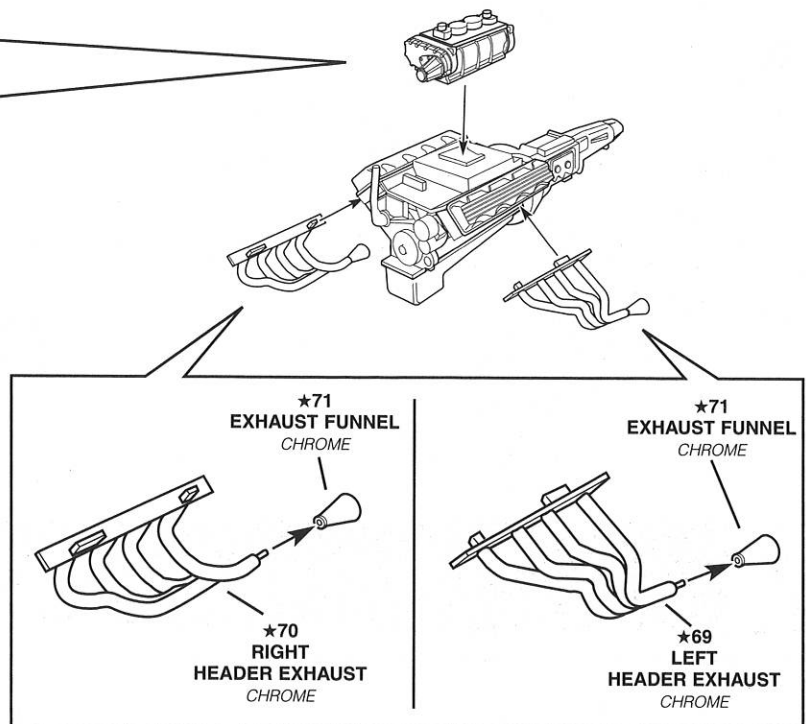
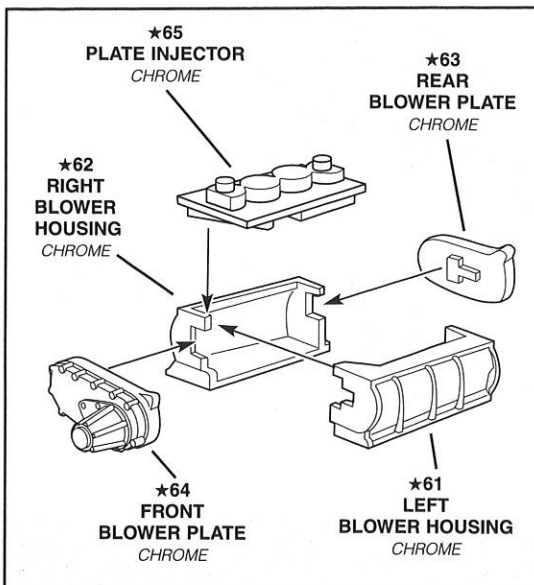
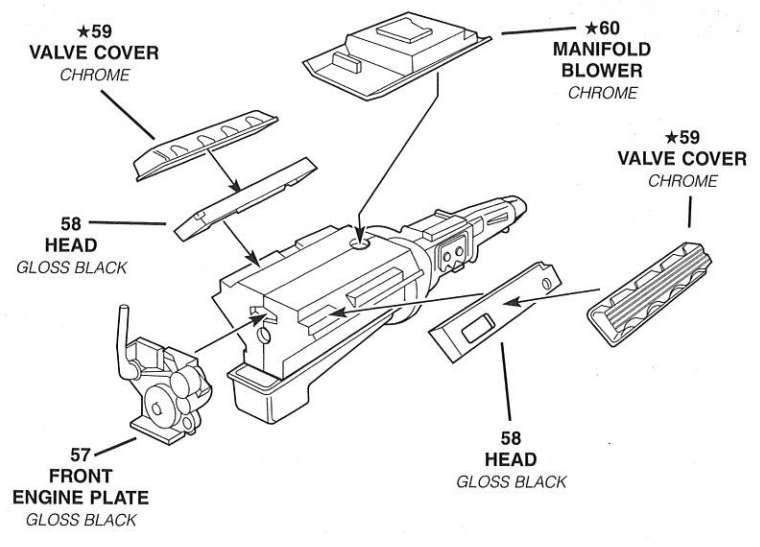
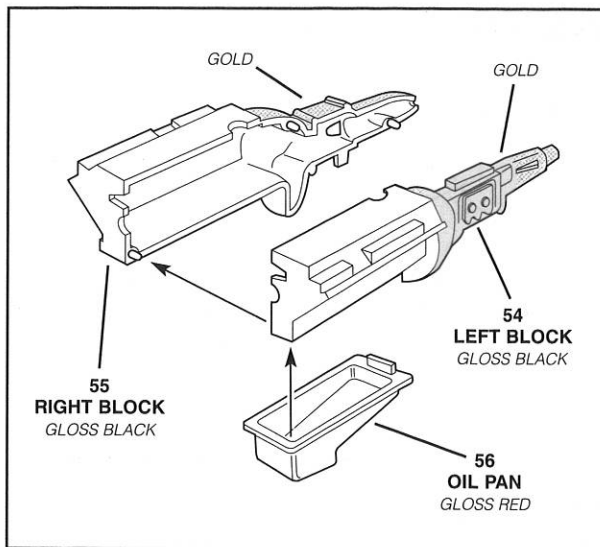

6

WHEEL / ENGINE ASSEMBLY

FRONT

(2X)

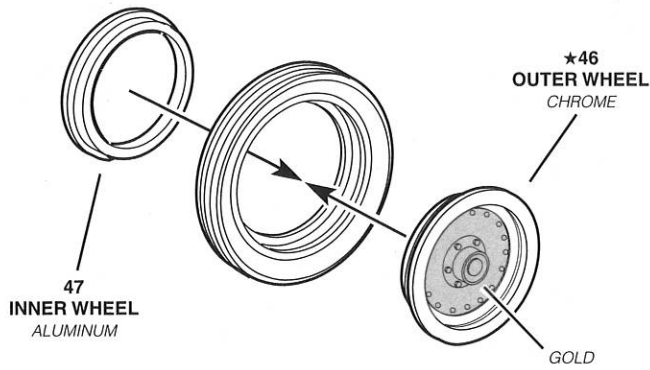

REAR

(2X)

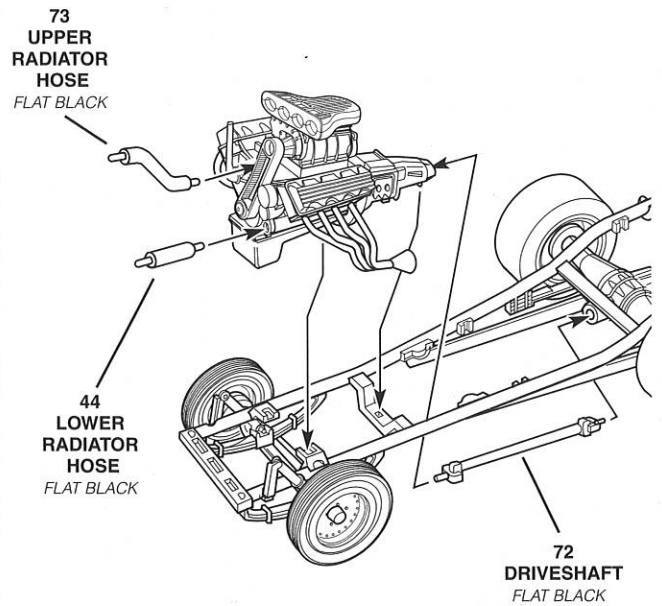
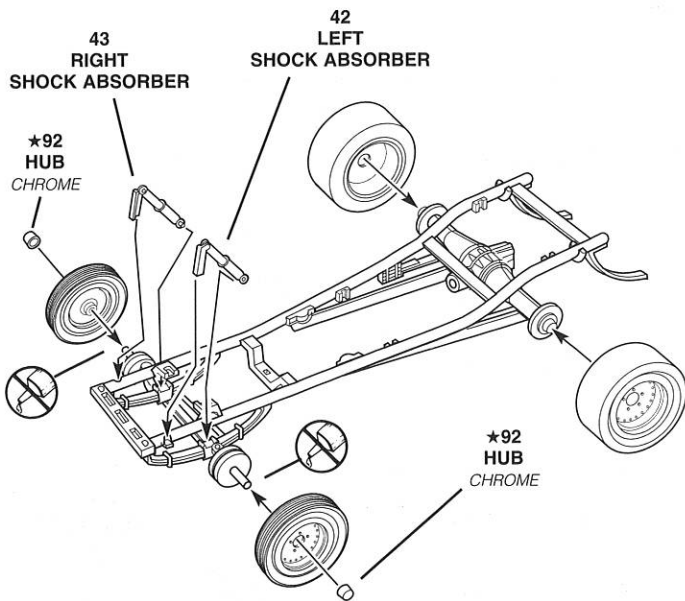
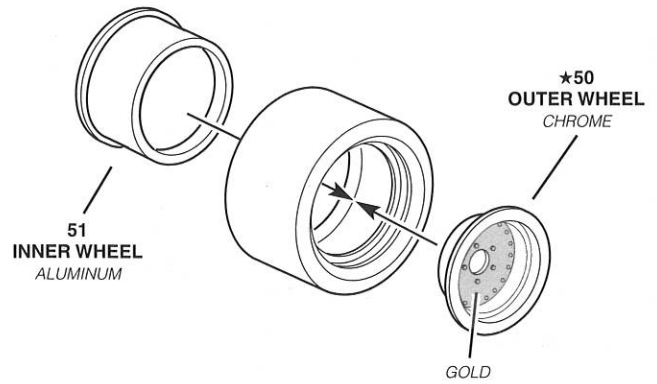

7

RADIATOR ASSEMBLY

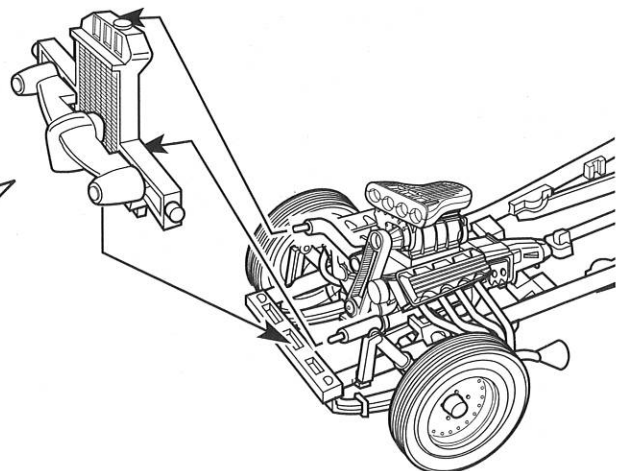
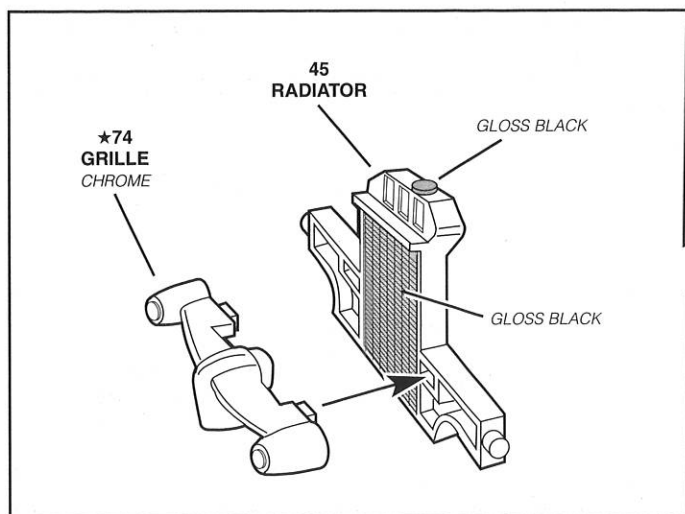

8

FENDER / HOOD / REAR ASSEMBLY

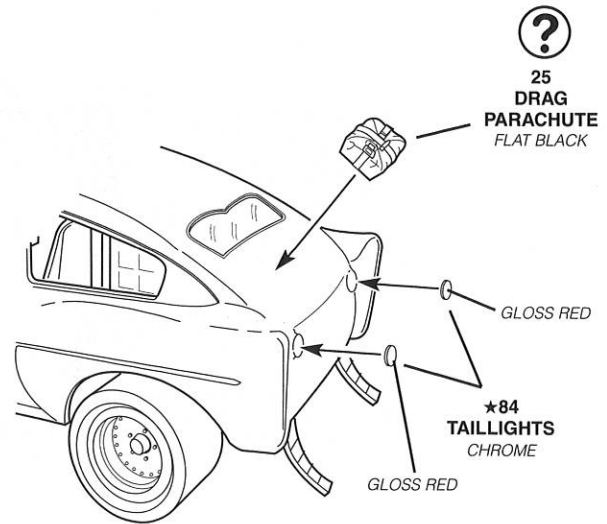
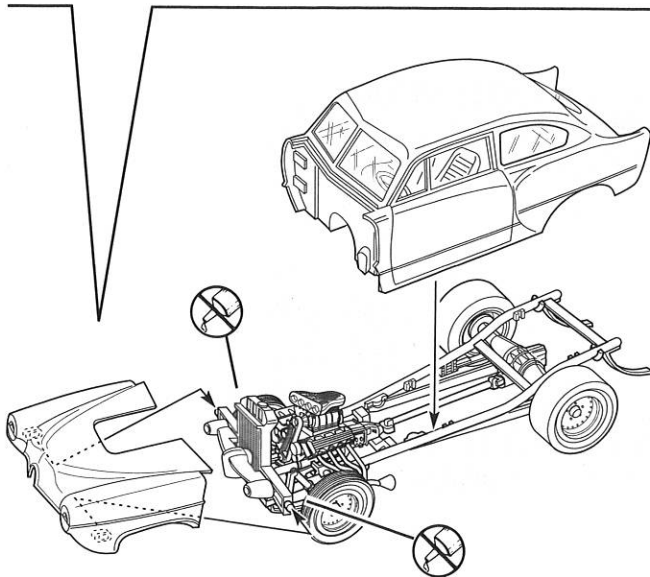
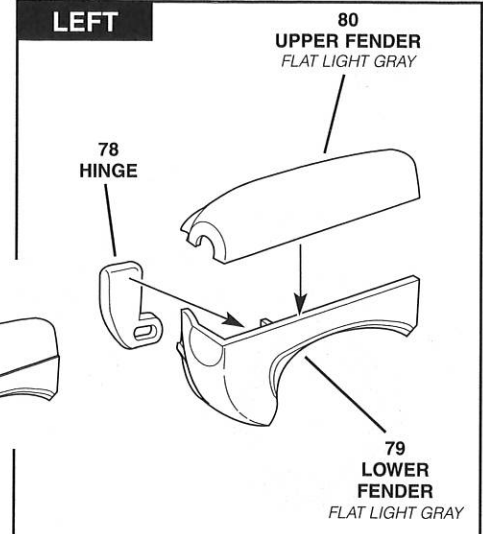
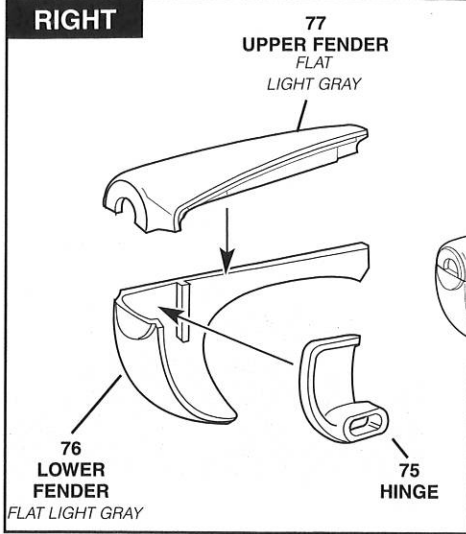

9

FINAL ASSEMBLY

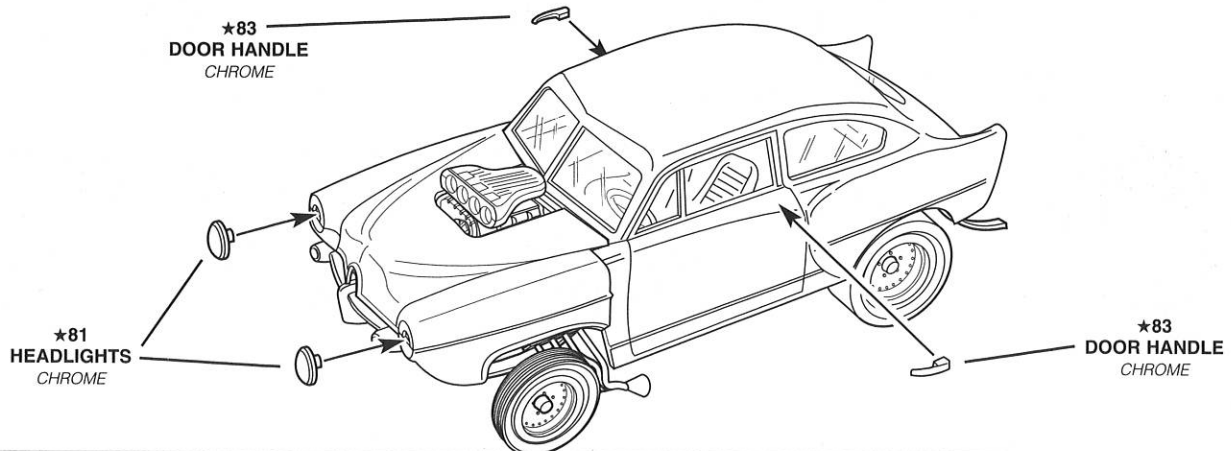

8

FENDER / HOOD / REAR ASSEMBLY

RIGHT

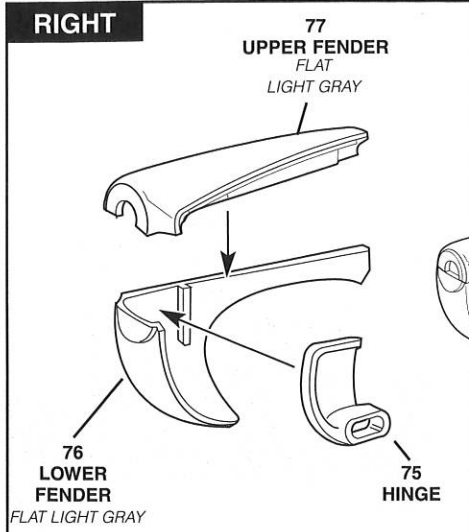

LEFT

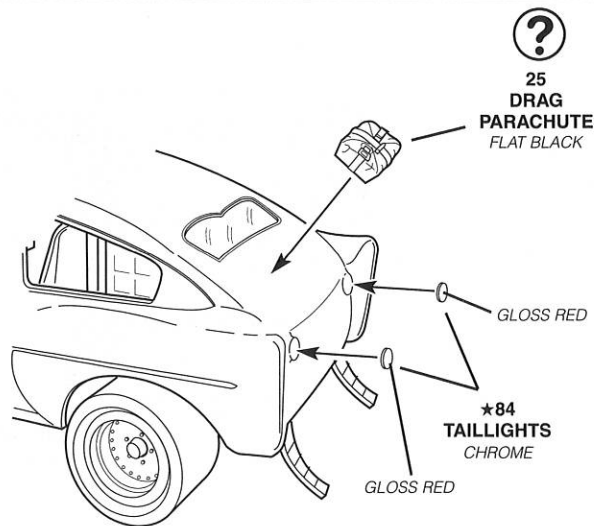
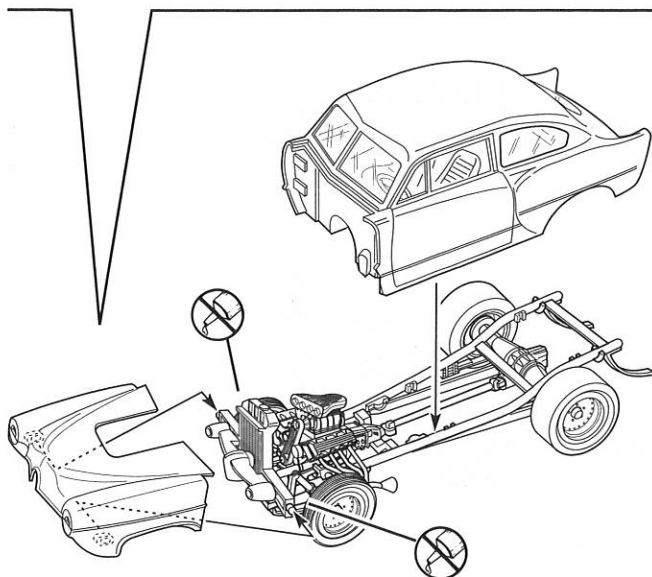
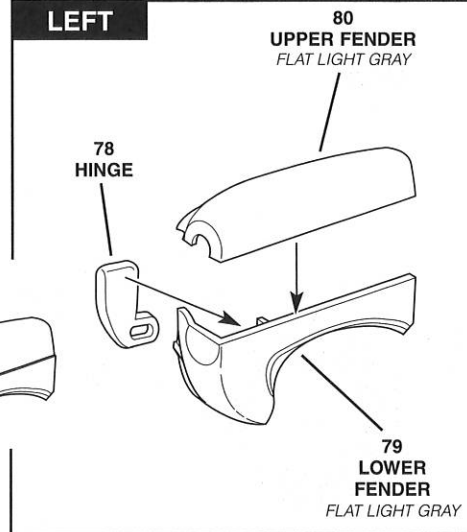

9

FINAL ASSEMBLY

