



KIT 2017

85201700200

1967 DODGE® CORONET R/T 2'n1

The intermediate Coronet model filled a vital and important role in the Dodge marketing plan in the 1960's. Kind of like that one player that can play multiple positions on a team, the Coronet was available in a variety of trim levels and price ranges from basic to flashy. While the sporty fastback Charger model, which was all Coronet under the skin, got most of the attention, the Coronet could be ordered with all of the same high performance parts. The bonus was the lower cost and lighter weight as compared to the Charger. New for 1967 was the R/T (Road & Track) option which added bucket seats, center console, non-functional hood scoop, low-restriction dual exhaust, and heavy-duty suspension, 7.75 x 14" red stripe tires and discreet R/T emblems. The key part of the package was found under the hood in the form of the new wedge-head 440 Magnum V-8 engine which put out 375 horsepower. The 727 Torqueflite automatic transmission came standard with a four speed manual available as an option. Base price for the R/T hardtop was \$3,199 while the R/T convertible stickered at \$3,438.

It was a nice package and a good seller for Dodge with over 10,000 copies sold. The vast majority of those were equipped with the standard 440 V-8. For an additional \$457, you could add the mighty 426 Hemi® to the Coronet R/T and shave another full second off the 7 second 0-60 and 15.4 second quarter mile times of the 440. Only 238 Coronets rolled off the assembly line with the Hemi® that year, making it a rare sight when new and even more scarce today. Documented '67 Hemi® Coronet R/T's often bring six-figure prices these days when they appear at muscle car auctions.

This new Revell California Wheels issue of the R/T includes all the pieces to assemble an accurate factory stock replica including the big 426 Hemi®. In addition, we've also included newly-tooled modular large diameter wheels and low-profile tires for a more contemporary look if you're so inclined. We hope you enjoy building your own Dodge Coronet R/T.



* REPEAT SEVERAL TIMES
* A REPETER PLUSIEURS FOIS



* OPTIONAL PARTS
* PIECES EN OPTION



* DECAL
* DECAL COMANIE



* ALTERNATIVE ASSEMBLY
* ENSEMBLAGE ALTERNATIVE



* CEMENT TOGETHER
* A COLLER



* REMOVE AND THROW AWAY
* A RETIRER ET JETER



* DO NOT CEMENT
* NE PAS COLLER

READ THIS BEFORE YOU BEGIN

- * Study the assembly drawings.
- * Each plastic part is identified by a number.
- * In the assembly drawings, some parts will be marked by a star (★) to indicate chrome plated plastic.
- * For better paint and decal adhesion, wash the plastic parts in a mild detergent solution. Rinse and let air dry.
- * Check the fit of each piece before cementing in place.
- * Use only cement for polystyrene plastic.
- * Scrape plating and paint from areas to be cemented.
- * Allow paint to dry thoroughly before handling parts.
- * Any unused parts may be discarded.

DECAL APPLICATION INSTRUCTIONS

1. Cut desired decal from sheet.
2. Dip decal in water for a few seconds.
3. Place wet decal on paper towel.
4. Wait until decal is movable on paper backing.
5. Place decal in position on model, face up and slide backing away.
6. Press out air bubbles with a soft damp cloth.
7. Milkyness that may appear is for better decal adhesion and will dry clear. Wipe away any excess adhesive.
8. Do not touch decal until fully dry.
9. Allow the decals 48 hours to dry before applying clear coat.

NOTE: Decals are compatible with setting solutions or solvents.

LIRE CE QUI SUIT AVANT DE COMMENCER

- * Etudier les schémas de montage.
- * Chaque pièce en plastique est identifiée par un numéro.
- * Sur les schémas de montage, certaines pièces sont marquées d'une étoile (★) pour indiquer qu'elles sont en plastique chromé.
- * Pour une meilleure prise de la peinture et des autocollants, laver les pièces en plastique avec une solution détergente peu concentrée. Les rincer et les laisser sécher à l'air.
- * Vérifier que chaque pièce s'ajuste bien avant de la coller en place.
- * N'utiliser que de la colle pour polystyrène.
- * Gratter les parties à coller pour enlever le chrome et la peinture.
- * Laisser la peinture bien sécher avant de manipuler les pièces.
- * Toute pièce inutilisée peut être jetée.

DIRECTIVES D'APPLICATION DES AUTOCOLLANTS

1. Découper l'autocollant désiré de la feuille.
2. Tremper l'autocollant dans de l'eau pendant quelques secondes.
3. Placer l'autocollant mouillé sur une serviette en papier.
4. Attendez que l'autocollant puisse être déplacé sur son support en papier.
5. Mettre l'autocollant en position sur le modèle face sur le dessus et faire glisser le support pour l'enlever.
6. Appuyer avec un chiffon doux humide pour éliminer les bulles d'air.
7. La substance laiteuse qui peut apparaître est destinée à améliorer l'adhésion de l'autocollant et devient incolore au séchage. Essuyer pour enlever tout excédent d'adhésif.
8. Ne pas toucher l'autocollant tant qu'il n'est pas bien sec.
9. Laisser l'autocollant sécher pendant 48 heures avant d'appliquer une couche transparente.

REMARQUE: Les autocollants sont compatibles avec les solutions de fixation ou les solvants.

This paint guide is provided to complete this kit as shown on the box.

Ce guide de peintures est fourni pour reproduire le modèle réduit qui apparaît sur la boîte.

Gloss Black	Noir Brillant
Flat Black	Noir Mat
Semigloss Black	Noir Satine'
Gloss Dark Blue	Bleu Fonce Brillant
Transparent Red	Rouge Transparent
Engine Orange	Rouge Motuer
Aluminum	Aluminum
Steel	Acier
Gloss Silver Metallic	Argent Brillant Métallisé ¹
Gloss Copper Metallic	Cuivre Brillant Métallisé ¹
Flat White	Blanc Mat
Turn Signal Amber	Ambre

If you have any questions or comments, call our hotline at: **(800) 833-3570** or, please write to:

Revell-Monogram Consumer Service Department, 725 Landwehr Road, Northbrook, Illinois 60062

Be sure to include the plan number (85201700200), part number, description, your return address and phone number.

Visit our website: www.revell.com

1

ENGINE ASSEMBLY

A

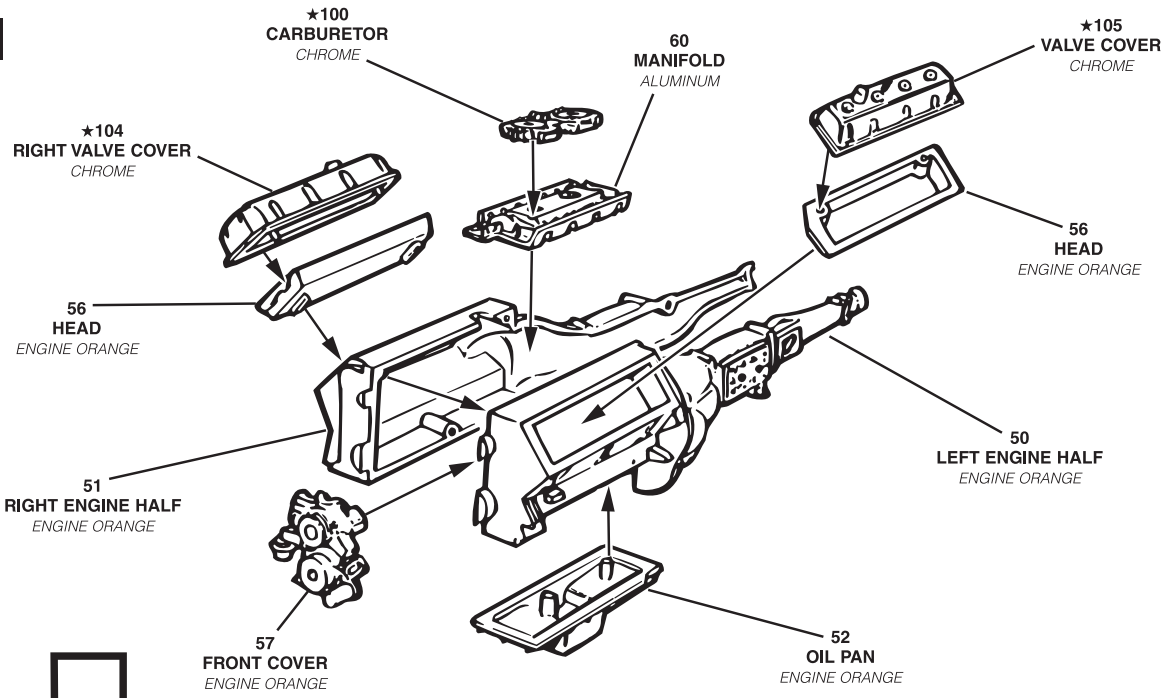

B

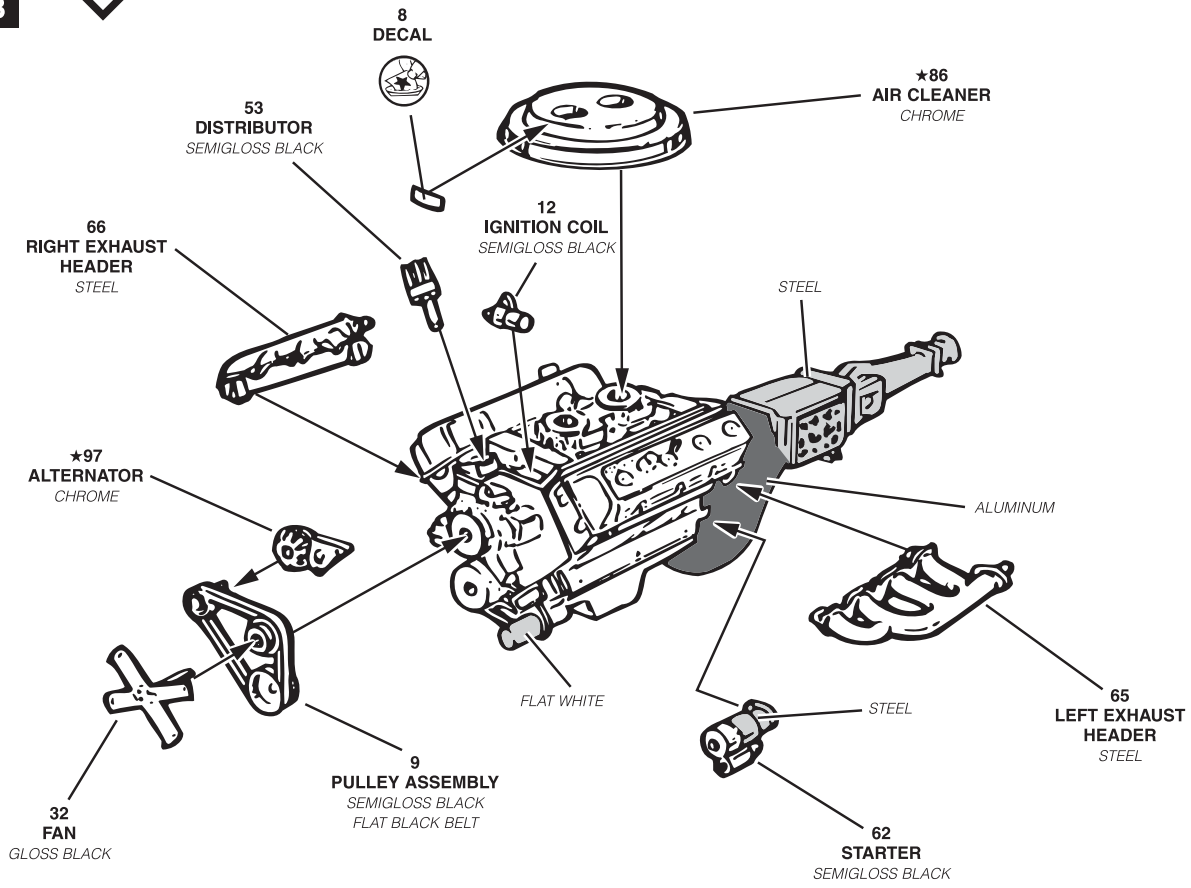

INSIDE OF BODY WITH WINDOWS IN PLACE

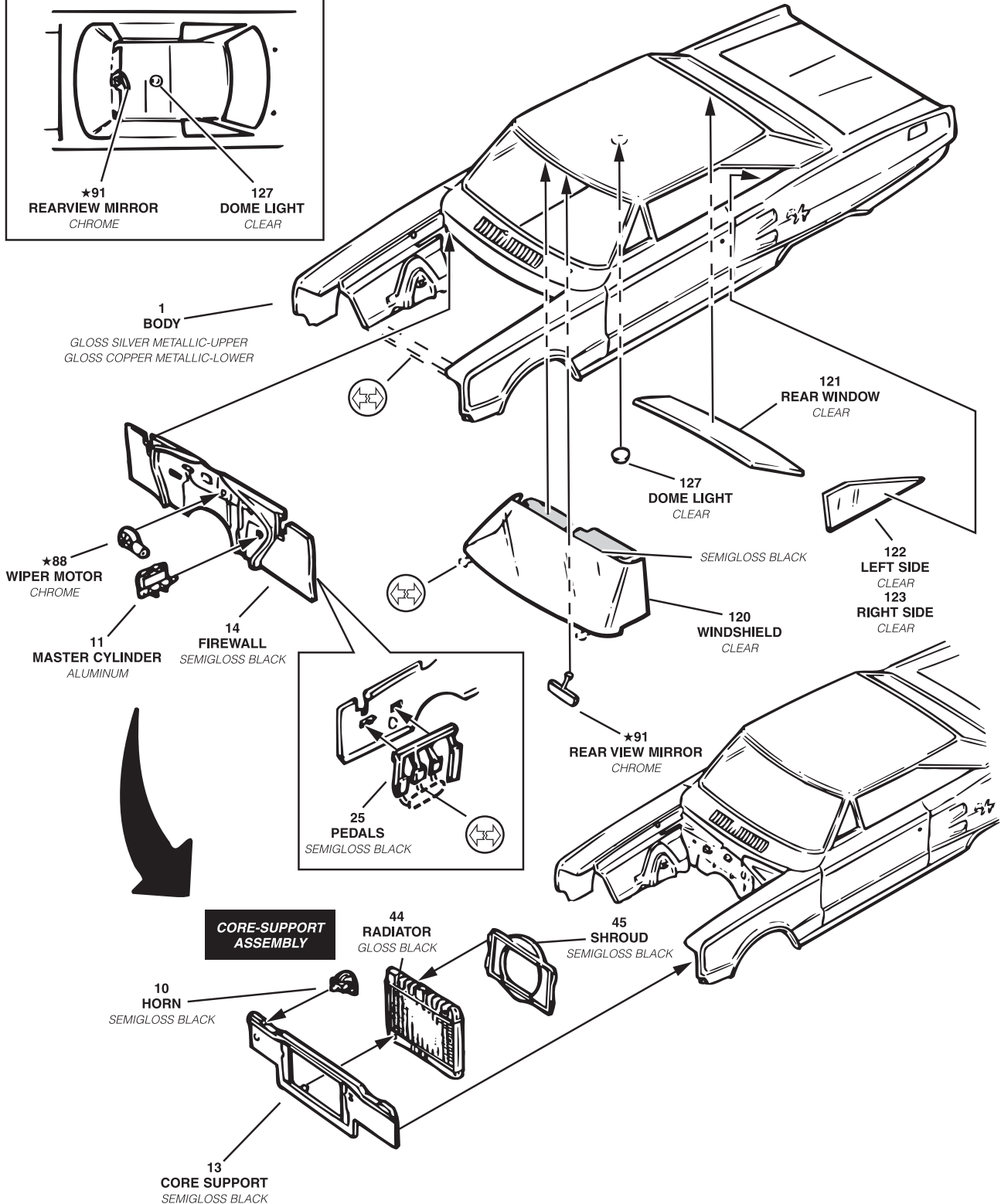
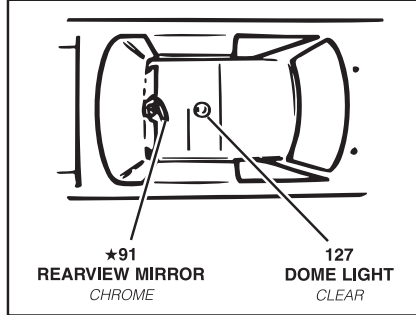

3

INTERIOR ASSEMBLY

A

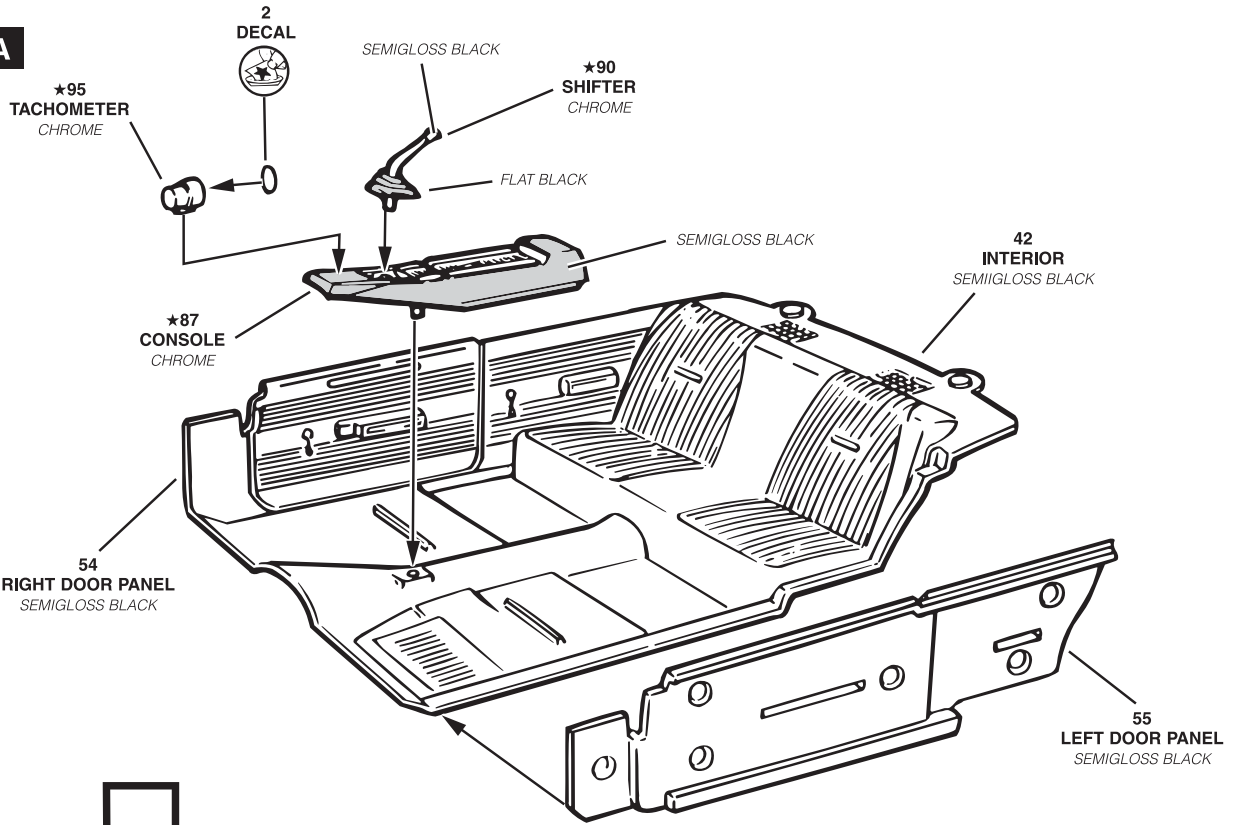

B

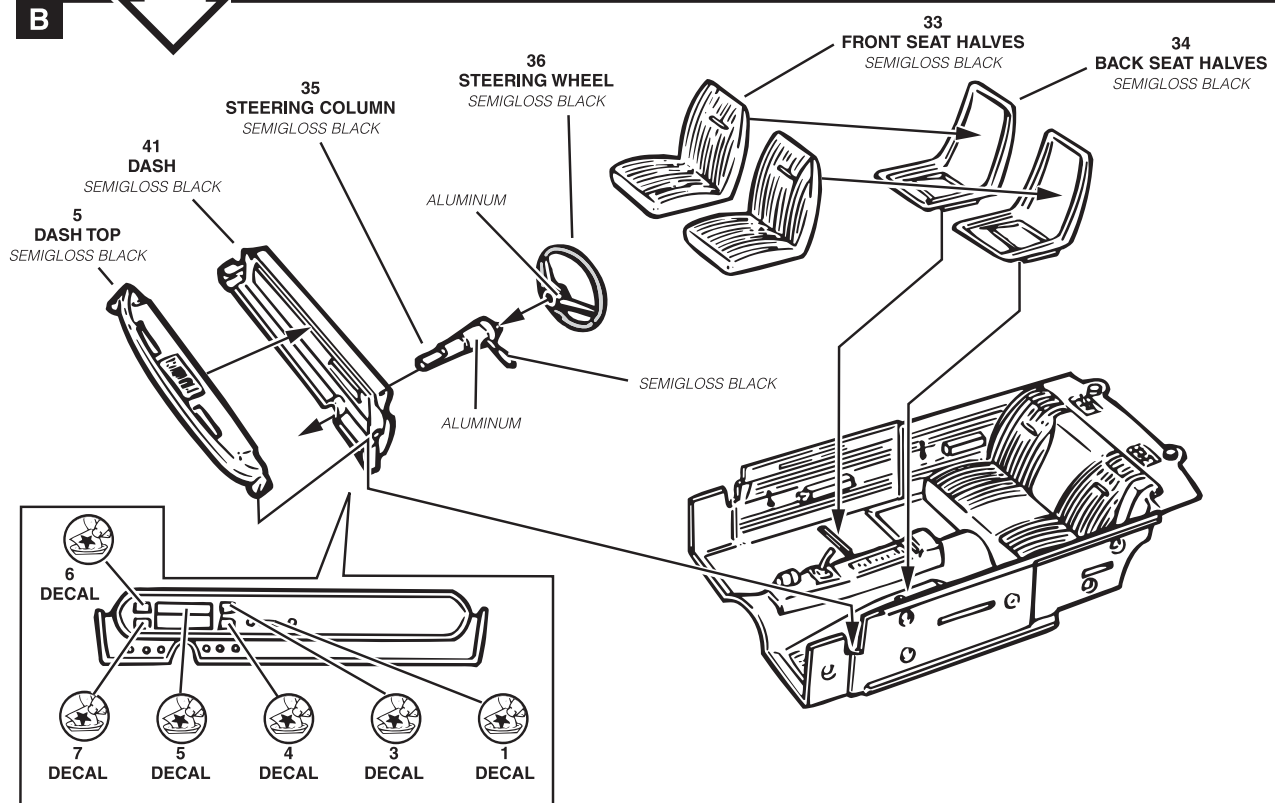

4

CHASSIS ASSEMBLY

A

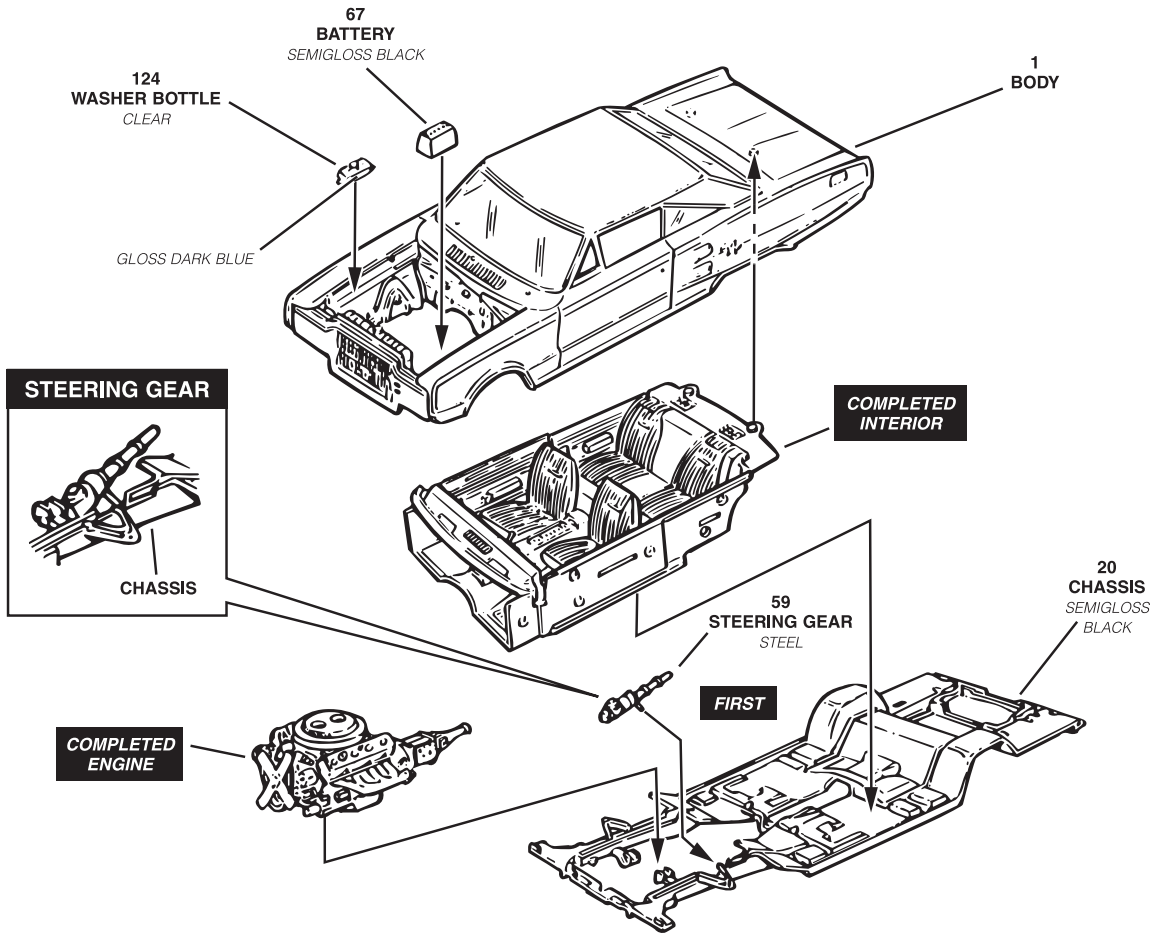

B

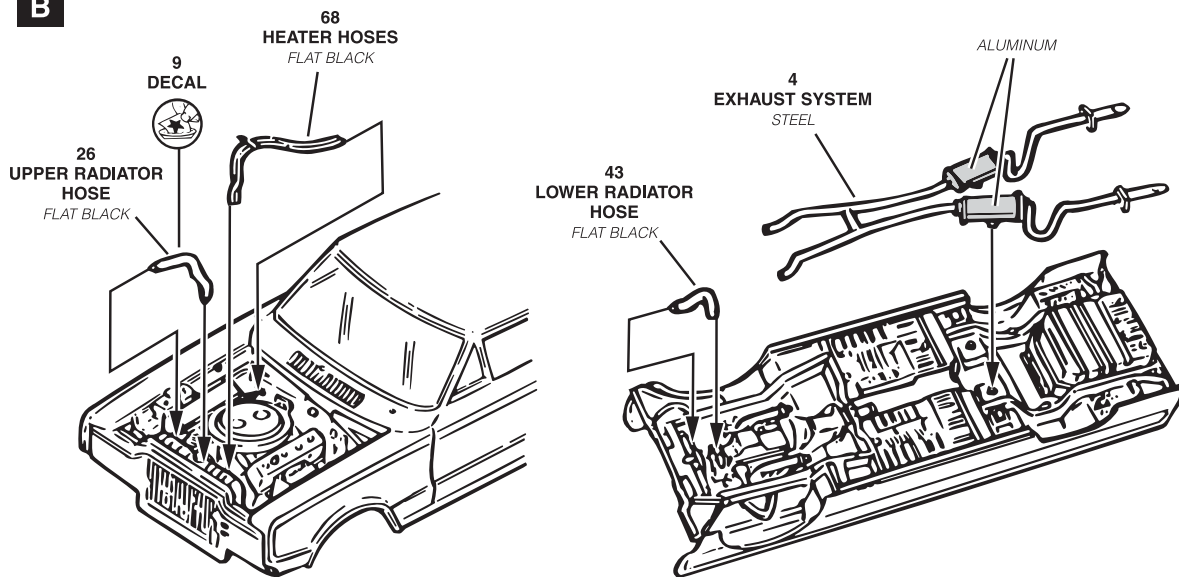

5

WHEEL & SUSPENSION ASSEMBLY

A

STOCK FRONT & REAR

4X

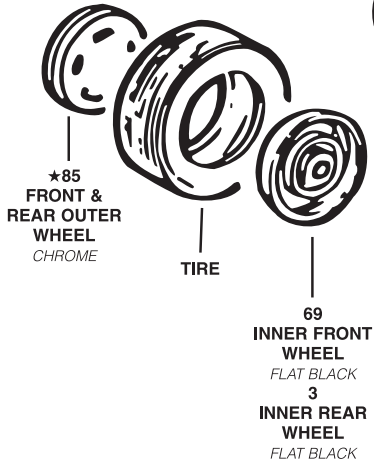

CUSTOM FRONT - SMALL

CUSTOM REAR - LARGE

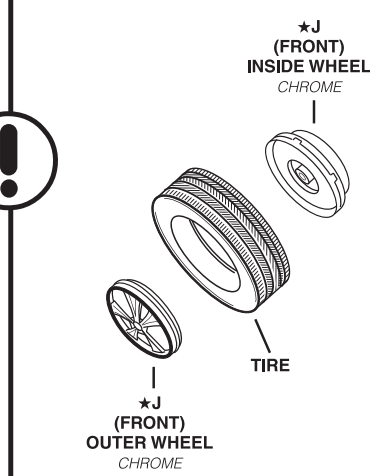

2X

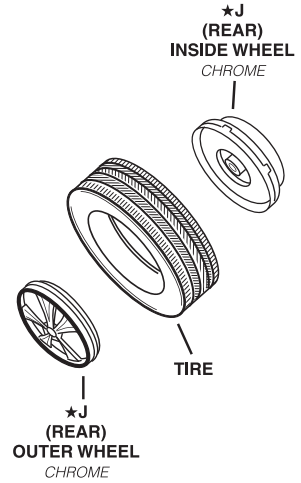

B



STOCK WHEELS & TIRES SHOWN

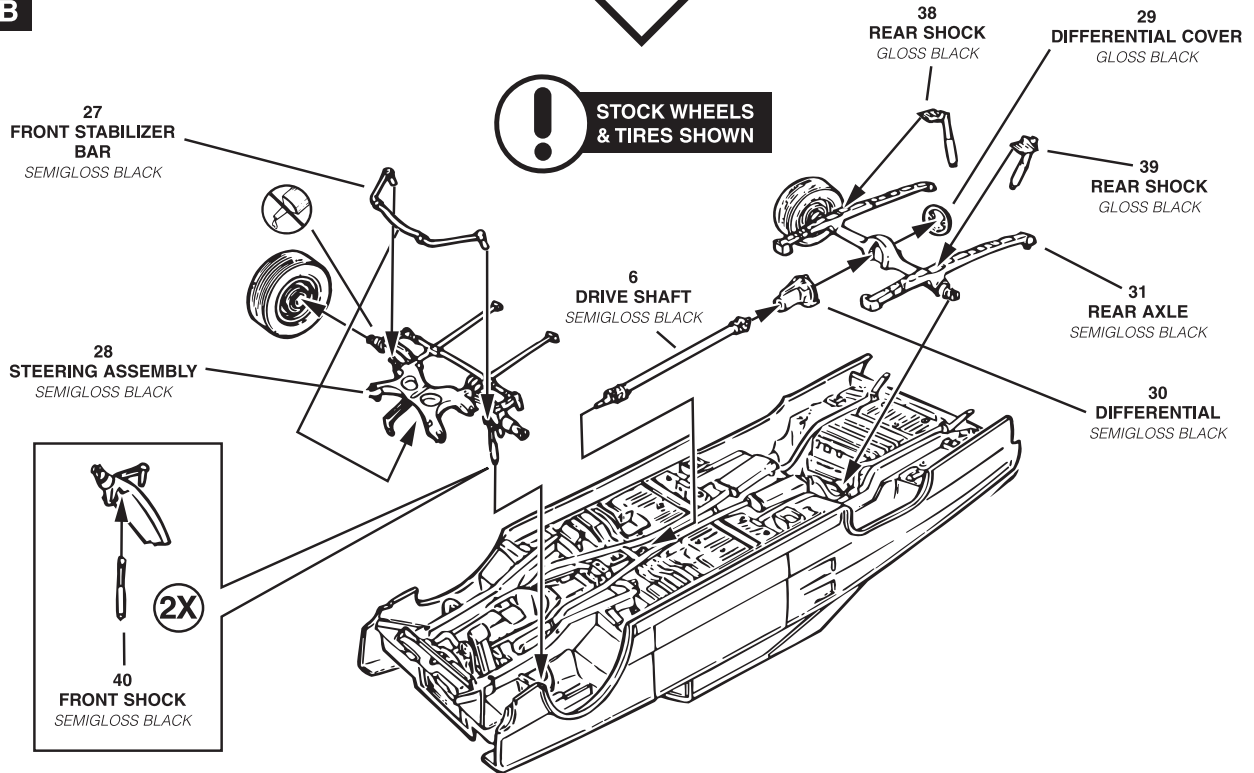

6

REAR BUMPER ASSEMBLY

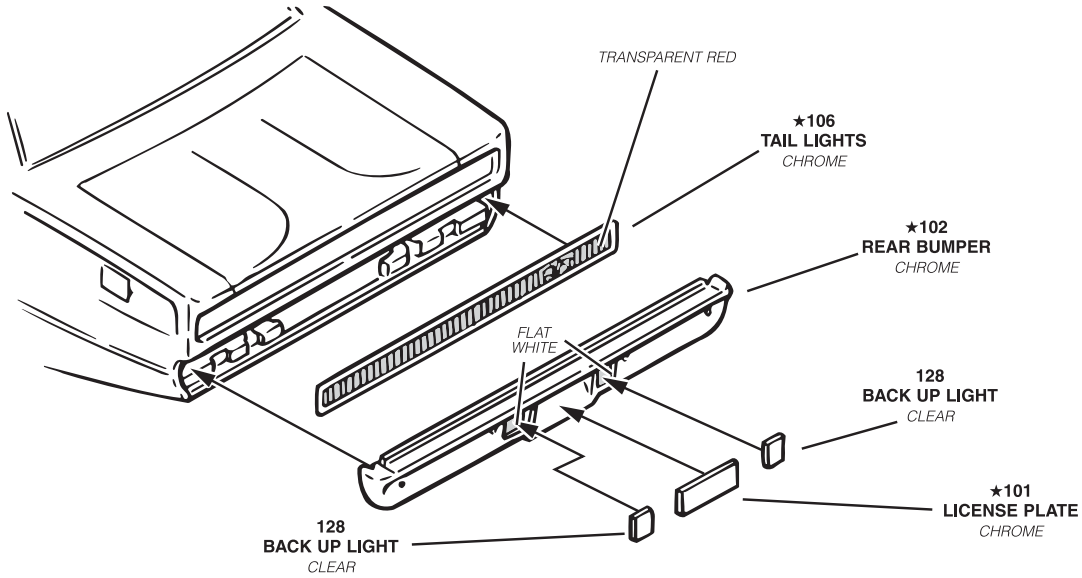

7

FRONT END / FINAL ASSEMBLY

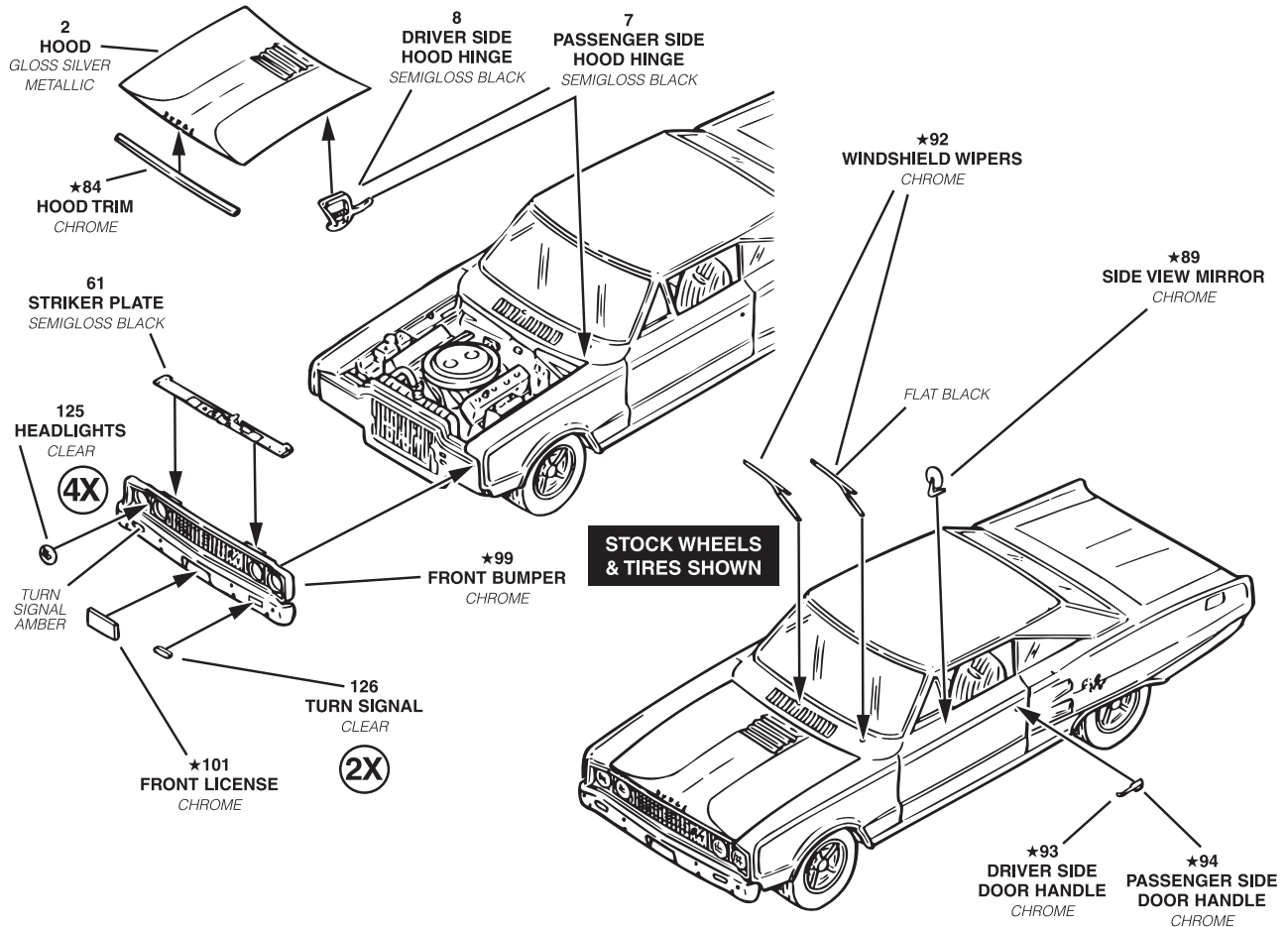

DECAL PLACEMENT

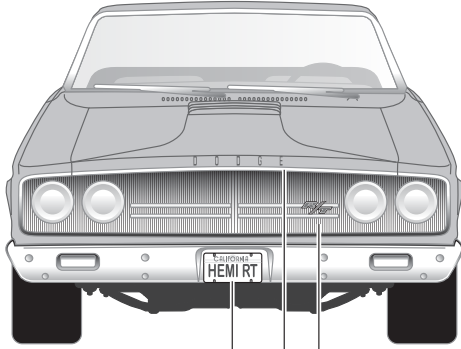

16 10 14

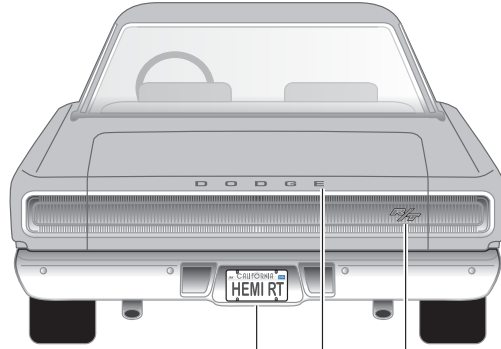

17 11 15

* NOTE: USE WITH CUSTOM WHEELS & TIRES ONLY

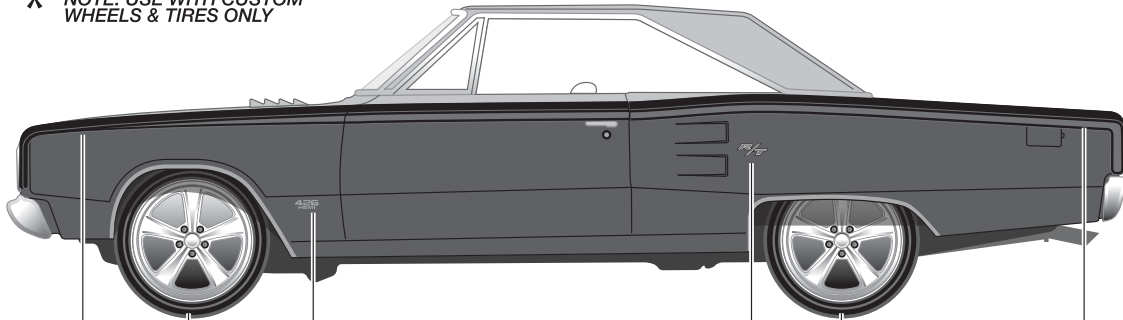

19 *-18 13 14 *-18 20

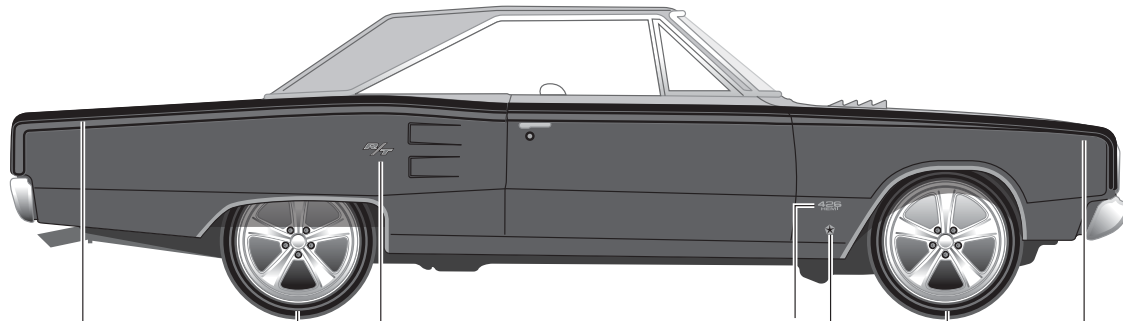

22 *-18 14 13 12 *-18 21

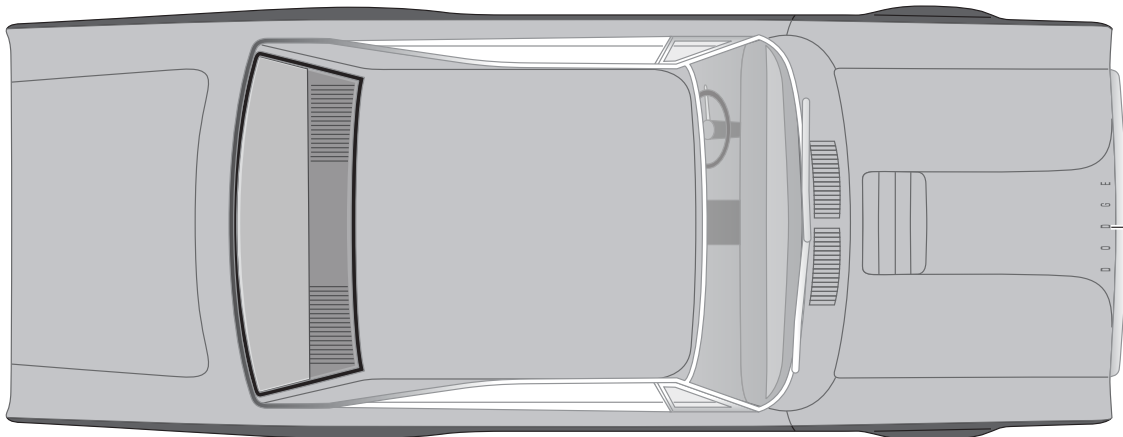

10