

Revell®

KIT 2015

85201500200

Corvette® Z06™

Through the fifty plus years of its existence, the Corvette® has remained for the most part true to its original definition-fiberglass body, accommodations for just two and except for its initial few years when there was none available, a V-8 engine under the hood.

While the Corvette® has always been a car that could perform, there were some over-achievers sprinkled in along the way. Since they were all officially called a Corvette®, one needed to learn the Chevrolet® alphabet soup of performance to separate the truly furious Vette™ from the merely quick. L88, ZL1, ZR-1-these were some of the limited production models that you would read about in the car magazines and talk about with your car-loving buddies. The letters and numbers designated engines and option packages that offered blistering acceleration and performance above and beyond your normal Corvette®. Besides the extra cost and difficulty in obtaining one of these special models, you gave up something else to gain the extra power and that would usually be weight. So, these legendary cars required the deletion of the radio, heater, sound insulation and any accessory not essential to speed. Air conditioning meant cranking open the window and going faster. If you wanted to be comfy you stayed home on the couch.

Fast forward to 2005 and the sixth generation Corvette®. Universally accepted as the most technologically advanced, it had it all.

Four hundred horsepower and incredible handling was combined with a smooth ride, very decent fuel economy and almost any luxury accessory you could get on a Cadillac®. With a history of never being satisfied, the engineers went back to work. The result is the 2006 Corvette® Z06™.

The Z06™ option code was initially used for a special performance package on the first Sting Ray™ in 1963. Today's Z06™ brings a new 7 liter V-8 engine developing an amazing 505 horsepower and 470 ft-lbs of torque at 4800 rpm. Zero to 60 mph times of about three and half seconds and a top speed of 198 mph are claimed. To handle this power all drive train components have been strengthened and the normally removable roof panel stays fixed in place on the stiffened body. A dry-sump type oil system has been installed so the engine oil doesn't all shift to one side and starve the big V-8 of needed lubrication during hard cornering. Again, weight is the key to speed and the Z06™ is the lightest of the C6 Corvette® models but this time you don't have to give up anything. Climate control, power everything, heated leather seats-it's all available and the car is docile enough to drive to work everyday in your best suit. With an initial base price of about \$65,000 the Z06™ isn't exactly inexpensive but you could spend twice as much and not have a better performing sports car so in that way it's a relative bargain. Look at it as an iron fist in a velvet glove.



* REPEAT SEVERAL TIMES
* A REPETER PLUSIEURS FOIS



* OPTIONAL PARTS
* PIECES EN OPTION



* DECAL
* DECAL COMANIE



* ALTERNATIVE ASSEMBLY
* ENSEMBLAGE ALTERNATIVE



* CEMENT TOGETHER
* A COLLER



* REMOVE AND THROW AWAY
* A RETIRER ET JETER



* DO NOT CEMENT
* NE PAS COLLER

READ THIS BEFORE YOU BEGIN

- * Study the assembly drawings.
- * Each plastic part is identified by a number.
- * In the assembly drawings, some parts will be marked by a star (★) to indicate chrome plated plastic.
- * For better paint and decal adhesion, wash the plastic parts in a mild detergent solution. Rinse and let air dry.
- * Check the fit of each piece before cementing in place.
- * Use only cement for polystyrene plastic.
- * Scrape plating and paint from areas to be cemented.
- * Allow paint to dry thoroughly before handling parts.
- * Any unused parts may be discarded.

DECAL APPLICATION INSTRUCTIONS

1. Cut desired decal from sheet.
2. Dip decal in water for a few seconds.
3. Place wet decal on paper towel.
4. Wait until decal is movable on paper backing.
5. Place decal in position on model, face up and slide backing away.
6. Press out air bubbles with a soft damp cloth.
7. Milkiness that may appear is for better decal adhesion and will dry clear. Wipe away any excess adhesive.
8. Do not touch decal until fully dry.
9. Allow the decals 48 hours to dry before applying clear coat.

NOTE: Decals are compatible with setting solutions or solvents.

LIRE CE QUI SUIT AVANT DE COMMENCER

- * Etudier les schémas de montage.
- * Chaque pièce en plastique est identifiée par un numéro.
- * Sur les schémas de montage, certaines pièces sont marquées d'une étoile (★) pour indiquer qu'elles sont en plastique chromé.
- * Pour une meilleure prise de la peinture et des autocollants, laver les pièces en plastique avec une solution détergente peu concentrée. Les rincer et les laisser sécher à l'air.
- * Vérifier que chaque pièce s'ajuste bien avant de la coller en place.
- * N'utiliser que de la colle pour polystyrène.
- * Gratter les parties à coller pour enlever le chrome et la peinture.
- * Laisser la peinture bien sécher avant de manipuler les pièces.
- * Toute pièce inutilisée peut être jetée.

DIRECTIVES D'APPLICATION DES AUTOCOLLANTS

1. Découper l'autocollant désiré de la feuille.
2. Tremper l'autocollant dans de l'eau pendant quelques secondes.
3. Placer l'autocollant mouillé sur une serviette en papier.
4. Attendez que l'autocollant puisse être déplacé sur son support en papier.
5. Mettre l'autocollant en position sur le modèle face sur le dessus et faire glisser le support pour l'enlever.
6. Appuyer avec un chiffon doux humide pour éliminer les bulles d'air.
7. La substance laiteuse qui peut apparaître est destinée à améliorer l'adhésion de l'autocollant et devient incolore au séchage. Essuyer pour enlever tout excédent d'adhésif.
8. Ne pas toucher l'autocollant tant qu'il n'est pas bien sec.
9. Laisser l'autocollant sécher pendant 48 heures avant d'appliquer une couche transparente.

REMARQUE: Les autocollants sont compatibles avec les solutions de fixation ou les solvants.

This paint guide is provided to complete this kit as shown on the box.
Ce guide de peinture est fourni pour reproduire le modèle réduit qui apparaît sur la boîte.

Aluminum	Aluminium
Burnt Iron	Fer brule
Flat Black	Nour mat
Gloss Yellow	Jaune brillant
Semigloss Black	Noir satiné
Semigloss White	Blanc satiné
Steel	Acier
Turn Signal Amber	Clignotant ambre
Semigloss Red	rouge satiné

If you have any questions or comments, call our hotline at: **(800) 833-3570**
or, please write to:

Revell-Monogram Consumer Service Department, 725 Landwehr Road, Northbrook, Illinois 60062

Be sure to include the plan number (85201500200), part number, description, your return address and phone number.

Visit our website: www.revell.com

1

ENGINE ASSEMBLY

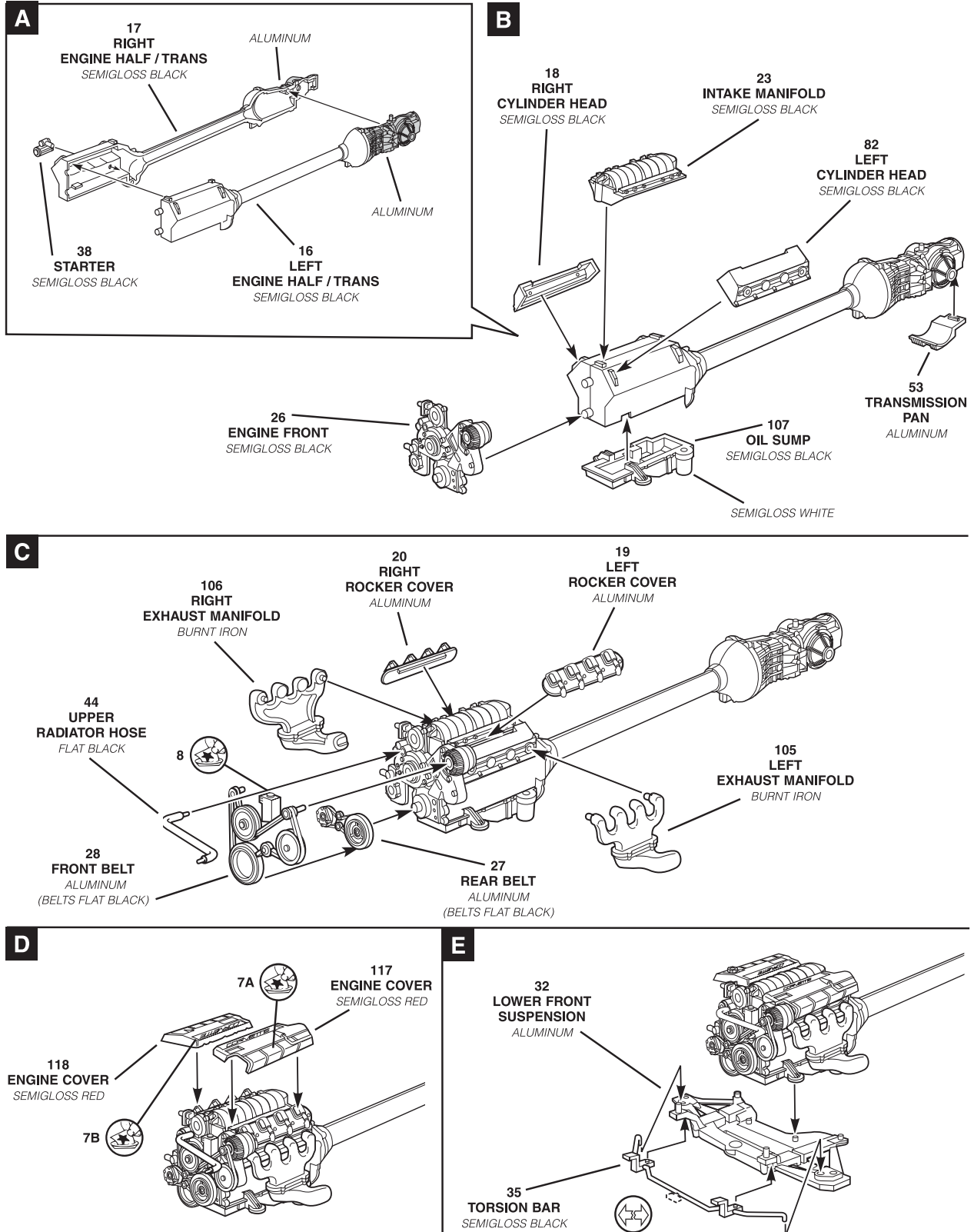

2

SUSPENSION ASSEMBLY

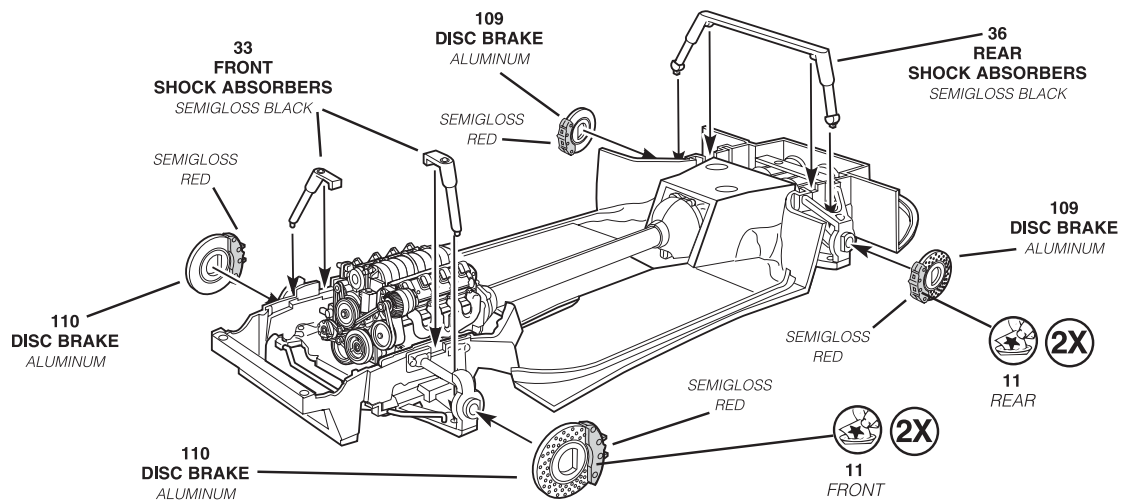
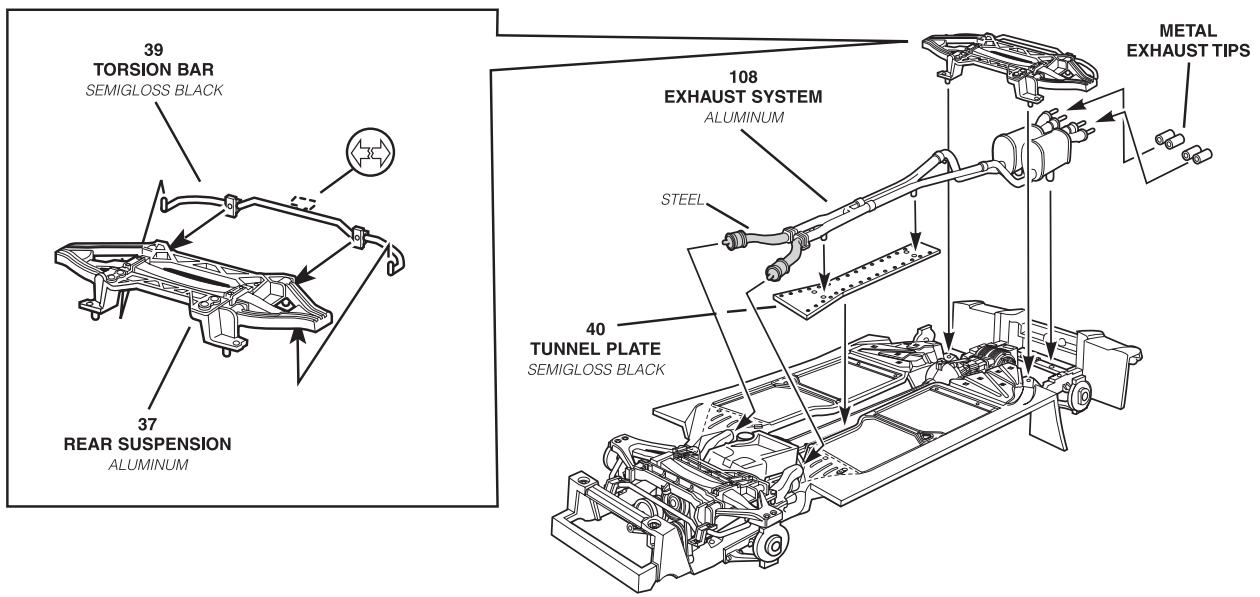
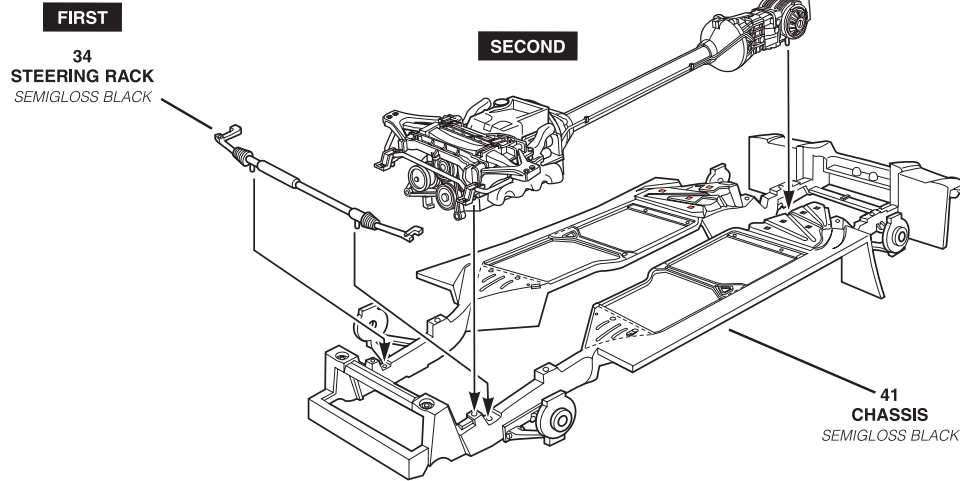

3

INTERIOR ASSEMBLY

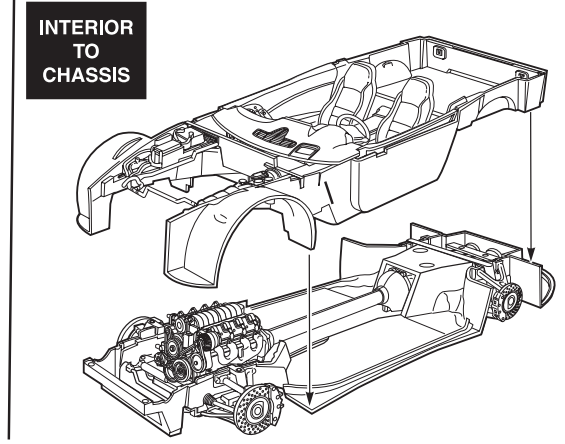
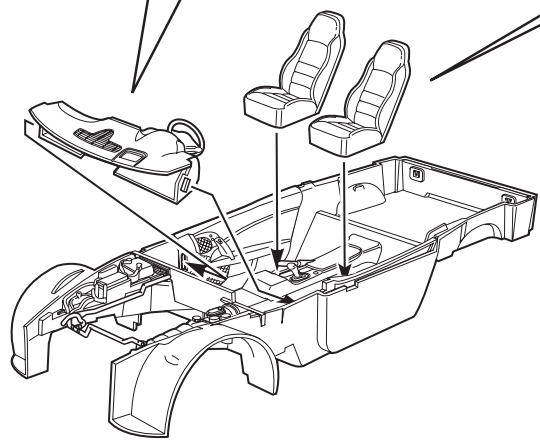
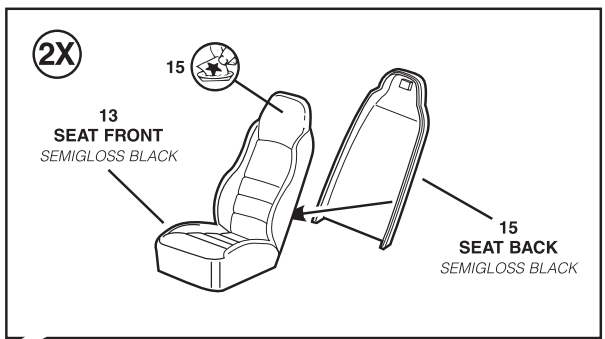
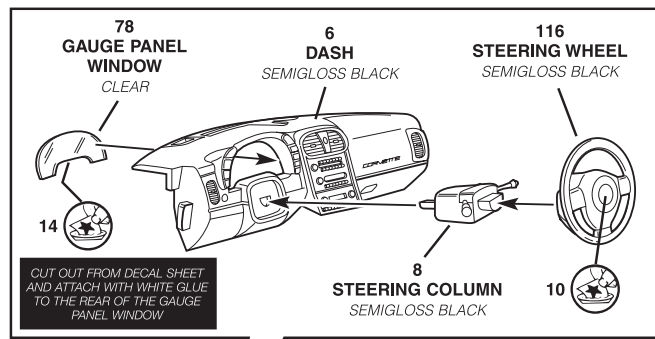
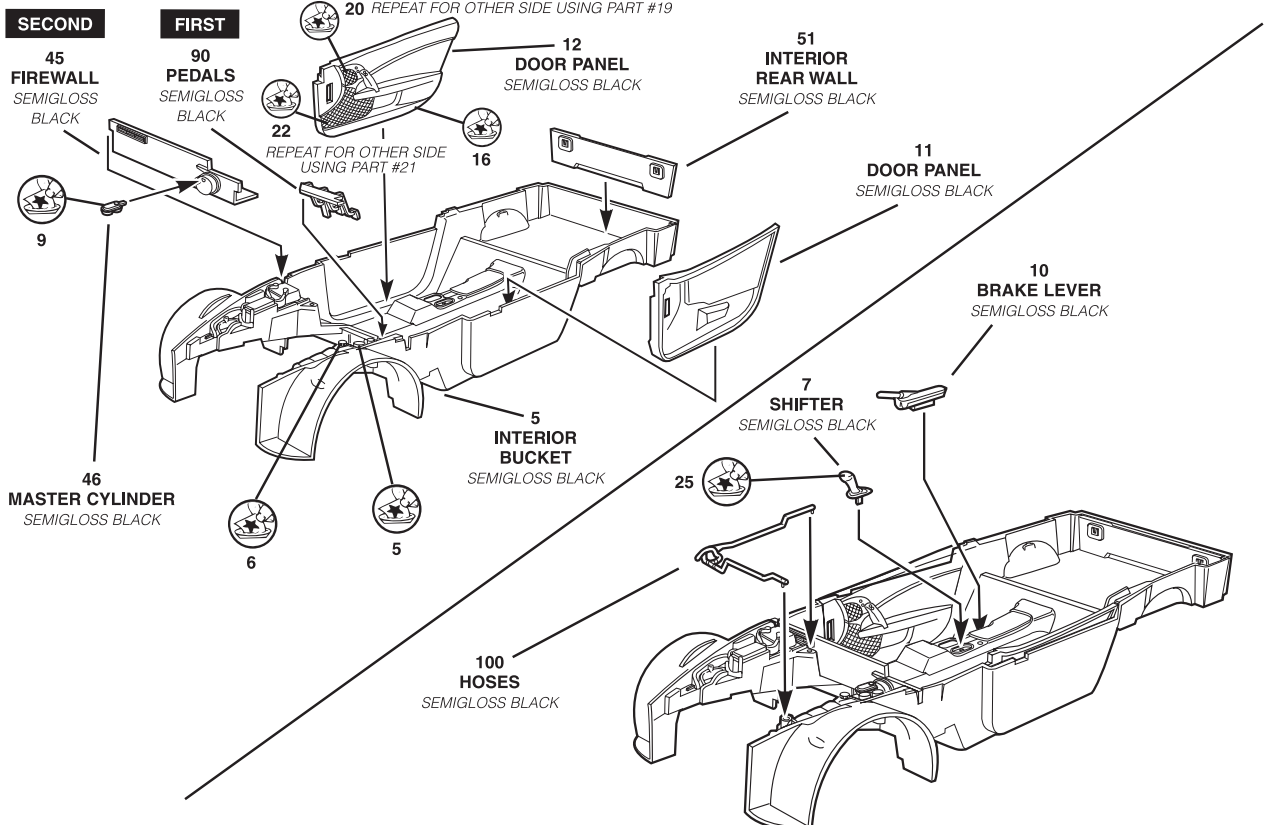

4

RADIATOR ASSEMBLY

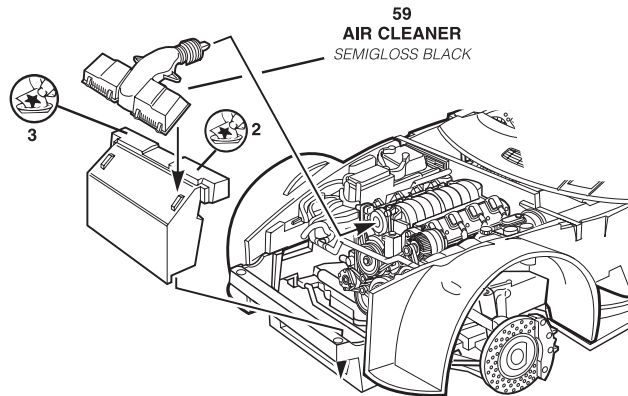
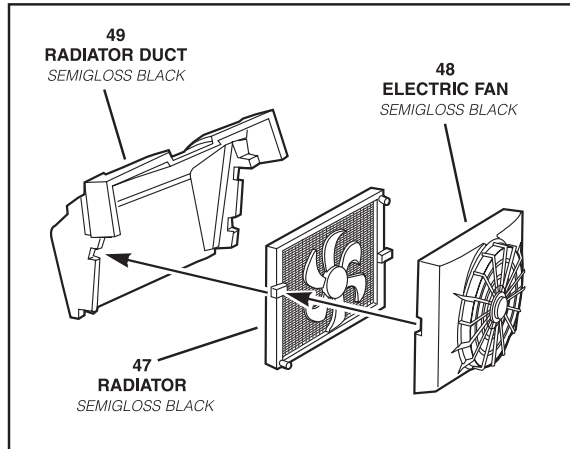

5

WHEEL ASSEMBLY

* NOTE: THE TREADS ON THE TIRES ARE DIRECTIONAL. THE ILLUSTRATIONS PROVIDED HAVE THE CORRECT TREAD PATTERN

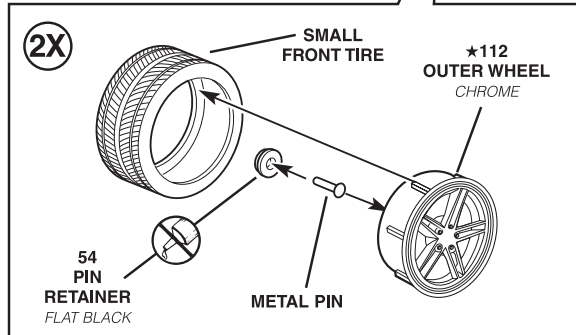
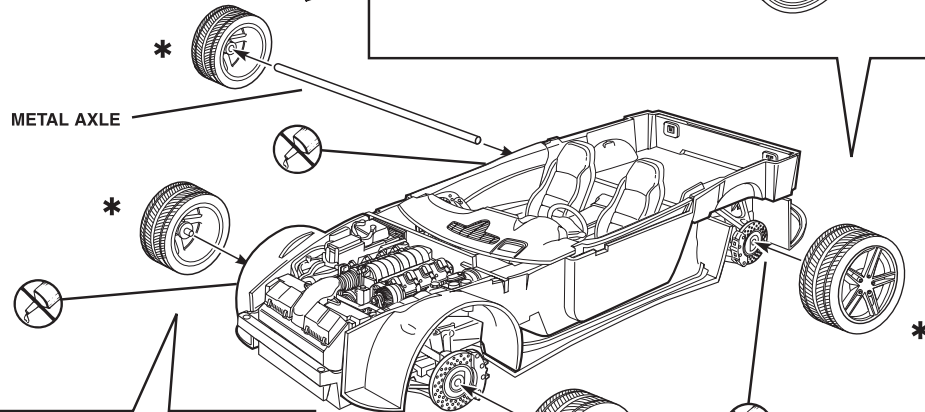
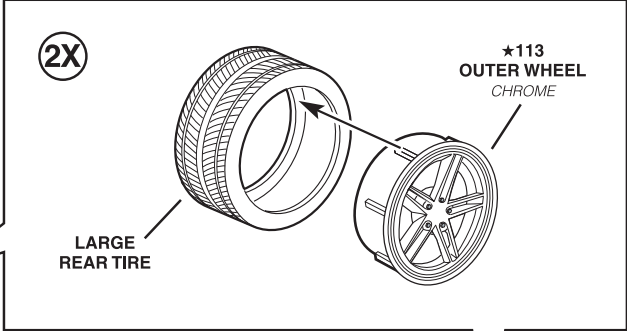

6

WINDOW ASSEMBLY

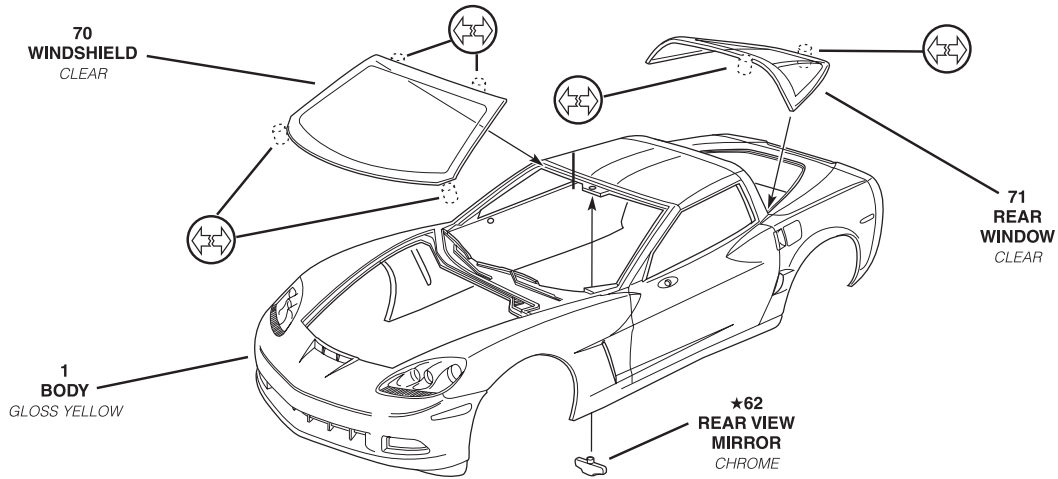

7

HOOD / FRONT ASSEMBLY

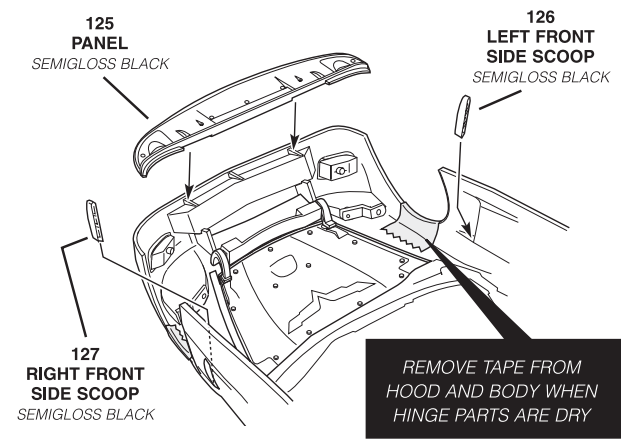
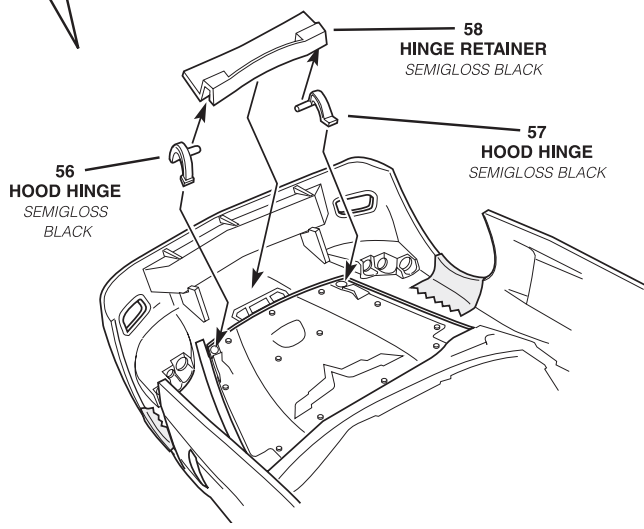
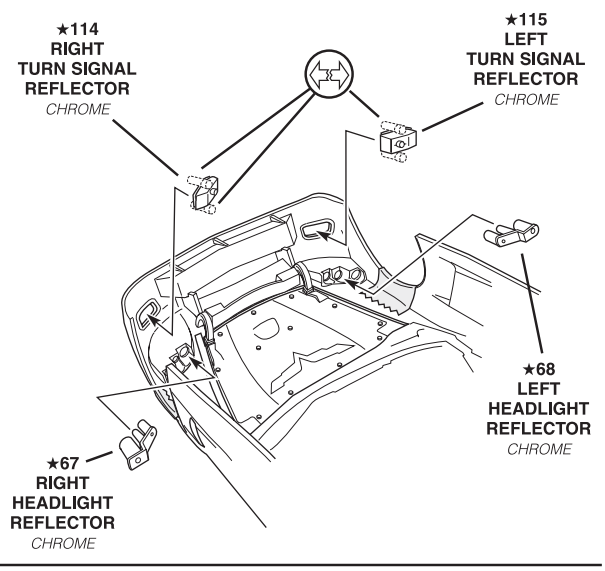
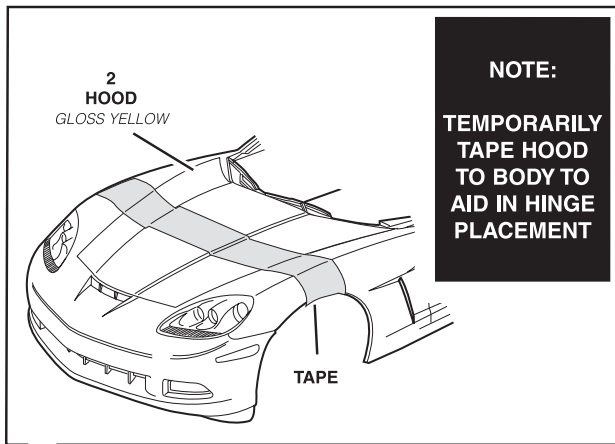

FINAL ASSEMBLY

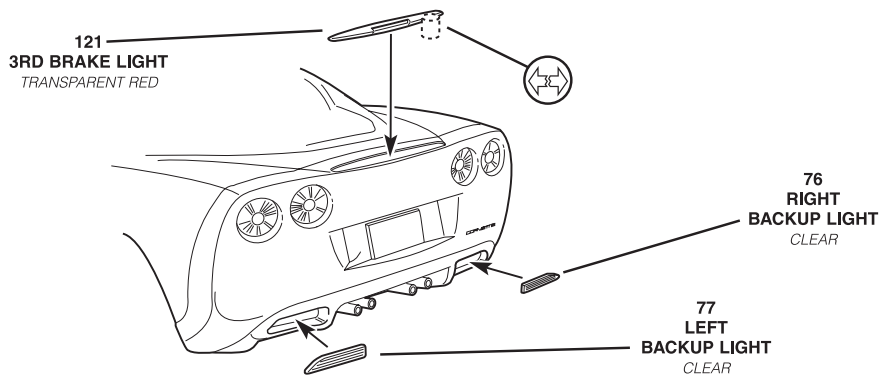
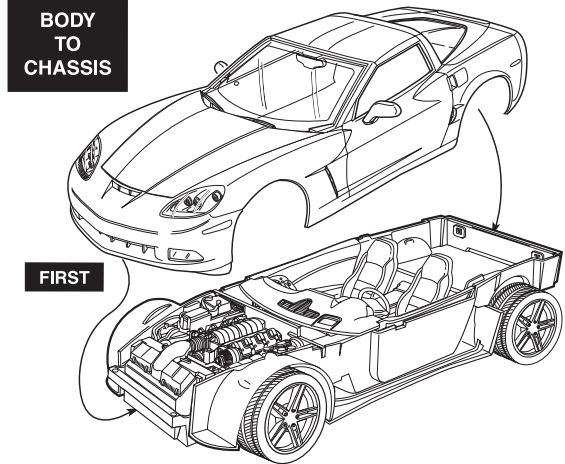
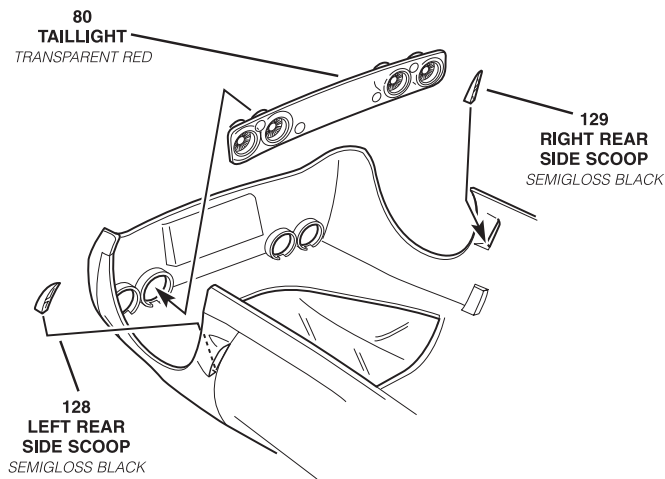
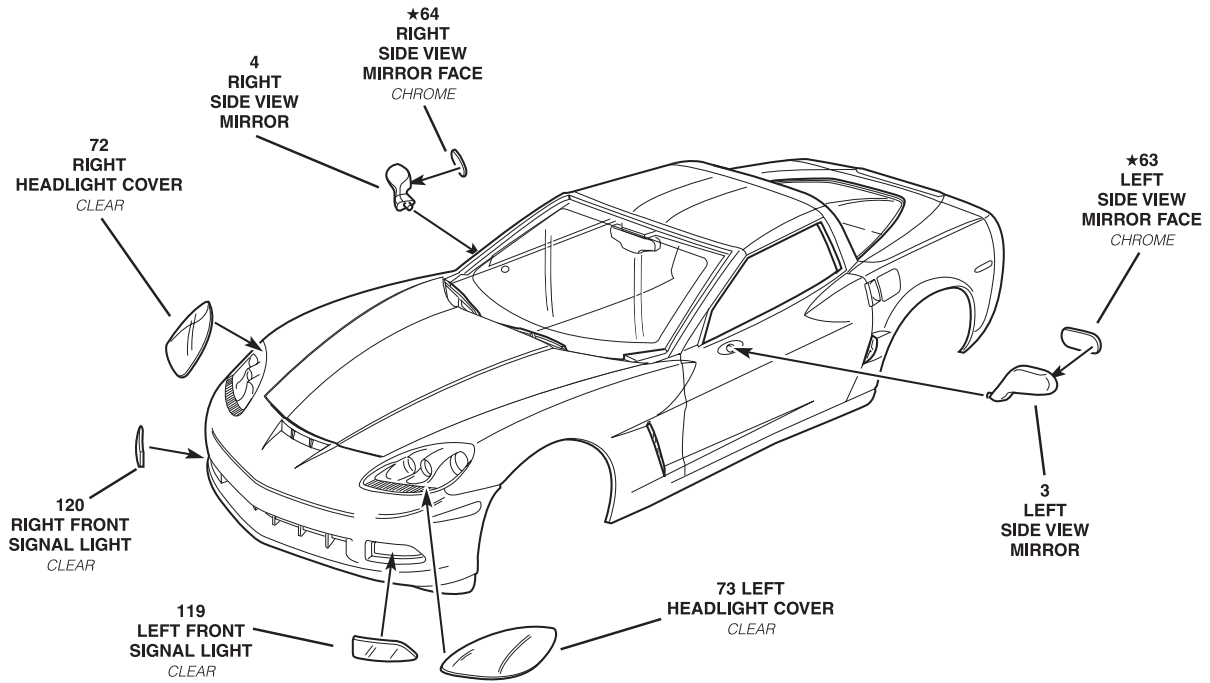

9

DECAL PLACEMENT

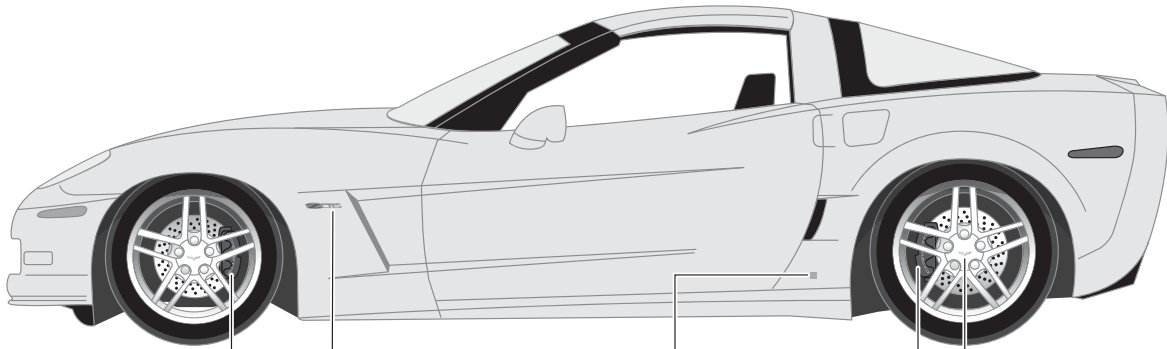

11 Front
(See Step #2)

2X

24
(Repeat For
Other Side)

23
(Repeat For
Other Side)

11 Rear
(See Step #2)

2X

4X-12

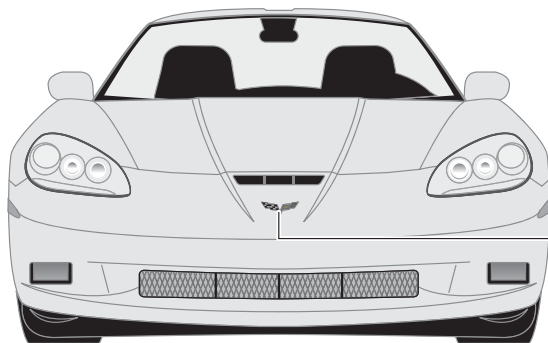
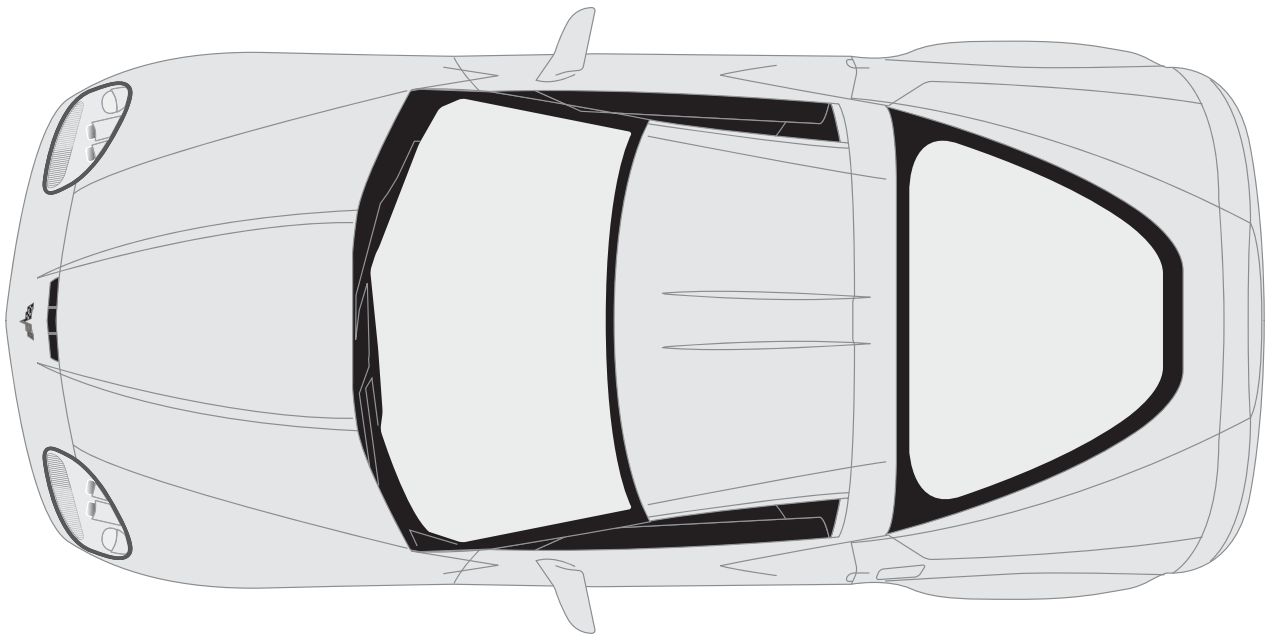

13



17 or 18

?