



Bearing Remover



MK-BRT02 Bearing Remover M2
MK-BRT03 Bearing Remover M3



MK-BRT05 Bearing Remover M5
MK-BRT06 Bearing Remover M6
MK-BRT08 Bearing Remover M8
MK-BRT10 Bearing Remover M10

MuchMore's New Bearing Remover is a tool that can remove your ball bearing from Kyosho Mini-z, steering arms, steering posts, hubs etc. easily and safely. Simply insert this Bearing Remover into the bearing then tighten the hand screw and pull it out.

We have various sizes which are most frequently used for R/C cars such as 2,3,5,6,8 and 12mm version. All of them are blue anodized.

HOW TO USE:



1. Unscrew (CCW) the handscrew.



2. Insert the Bearing Remover into the bearing.



3. Tighten the handscrew (CW).

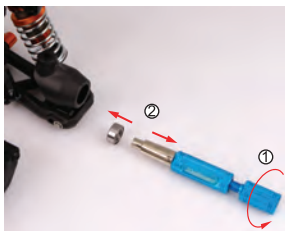

5. Unscrew the handscrew then pull out the bearing.



4. Pull out the Bearing Remover.