

ULTRA-TOTE CRADLE INSTRUCTIONS

PARTS LIST

HFBIF14 2 DIE-CUT PARTS
FOAM007 1 FOAM CRADLE CUSHION
NUTS017 2 10-24 WING NUT

SCRW049 2 10-24 X 1-1/4"
MACHINE SCREW
WSHR009 4 #10 FLAT WASHER

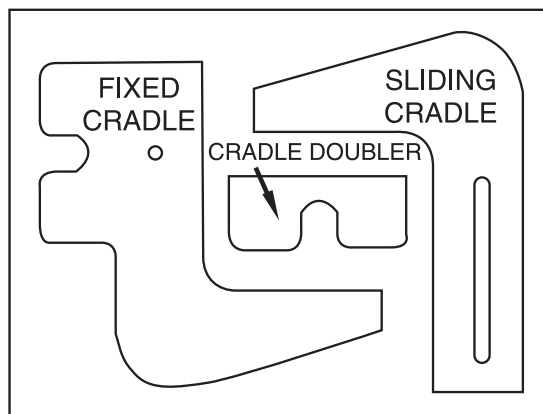

1. Punch out the two, 6 piece sets of cradles and very lightly sand the edges if necessary to remove any splinters. Glue each fixed cradle, cradle doubler and sliding cradle to another piece exactly like it. Make sure they are lined up correctly and that the punched indentation is showing on the largest pieces. You should now have two sets of three different pieces.

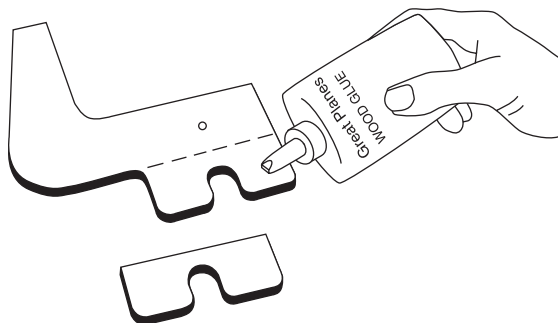

2. Glue the cradle doublers to the fixed cradles as shown in the sketch again making sure they are lined up correctly. Drill a 3/16" hole in this assembly where the punch mark is located. Repeat this procedure for the other set.

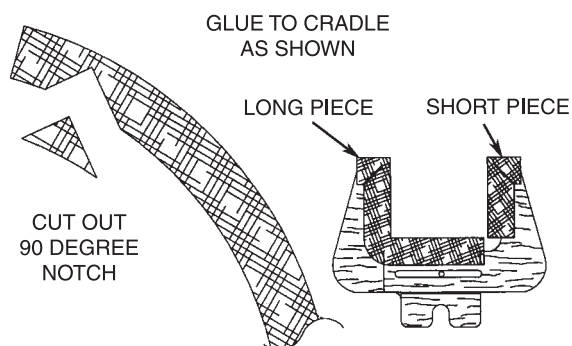

3. Cut the cradle sponge into four pieces – two pieces 6-1/2" long and two pieces 3-1/2" long. With a pair of scissors, carefully slit the tubing in a straight line from one end to the other. Cut a 90 degree notch about 3/4 of the way through the diameter of the tube on one end of each of the four pieces. Glue the pieces of cushion to the cradle so that the notch is at the corner. Do not glue the cushion to the bottom of the cradle since the two parts have to slide in relation to each other.

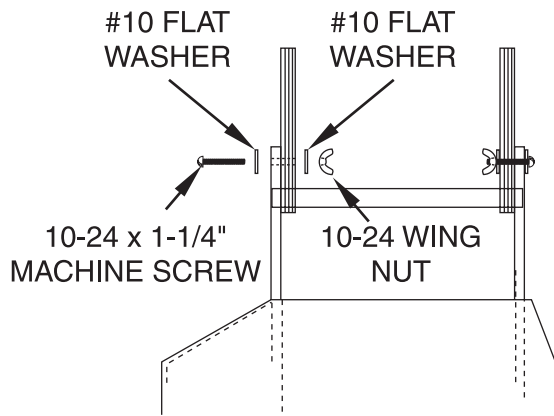

4. Each cradle is attached to your field box with a 10-24 x 1-1/4" machine screw, two #10 flat washers and a 10-24 wing nut.