

# ASSEMBLY OF YOUR STEALTH GLIDER

Read instructions completely before starting assembly.



Replacement Parts  
HCAA3291 Catapult Launcher

## 1 INSTALL NOSE REINFORCEMENT

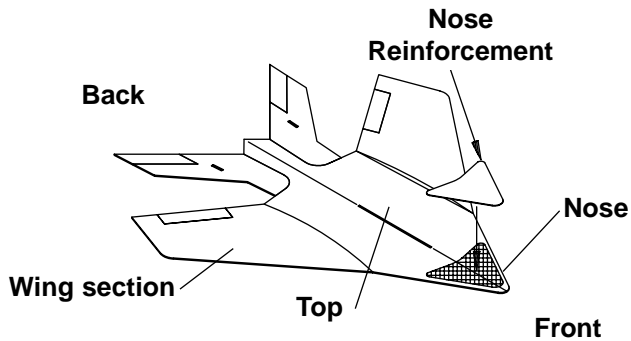

Remove paper from the nose reinforcement and apply to front of wing.

## 2 INSTALL HANDLE

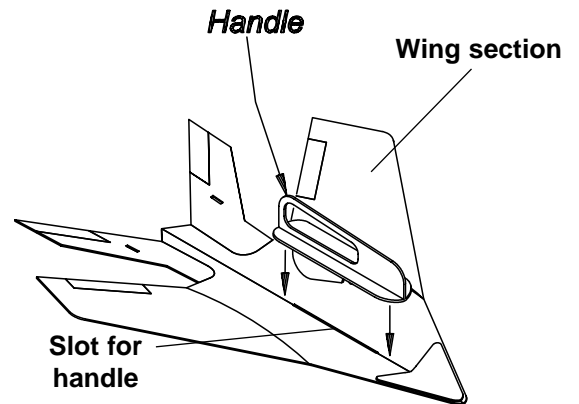

Remove paper from handle and press into slot.

## 3 ATTACH THE TOP DECK

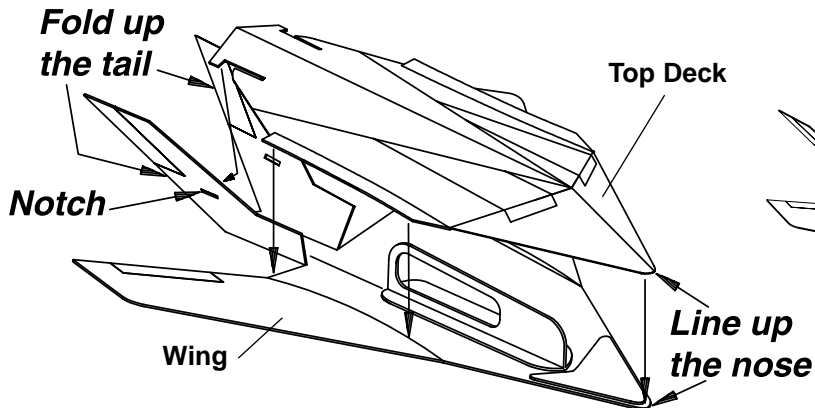

- A - Remove paper from the wing.
- B - Fold tail up
- C - Line up nose and press top deck to wing
- D - Slide tail into notches

## 4 NOSE & TAIL REINFORCEMENT DECALS

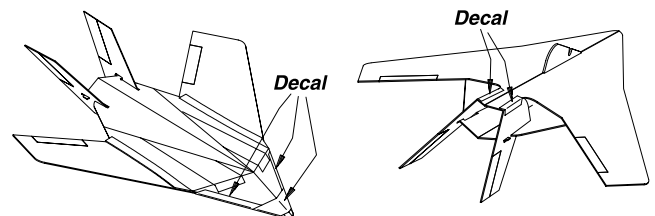

Apply decals for reinforcement on nose and tail.

## FLYING YOUR STEALTH

**CAUTION! ALWAYS LAUNCH THE AIRPLANE AWAY FROM PEOPLE AND OBSTACLES. NEVER POINT THE AIRPLANE AT ANYONE OR ANYTHING. ALWAYS LAUNCH SKYWARD. DO NOT LAUNCH INDOORS.**

Choose an open location, free of trees, power lines and other obstacles. Launch into the wind.

- ❶ It is important to test, or trim, your Stealth for proper flight.
- ❷ Grasp the airplane fuselage and gently toss the airplane into the wind. It should glide straight ahead and settle gently to the ground. See the diagram below.

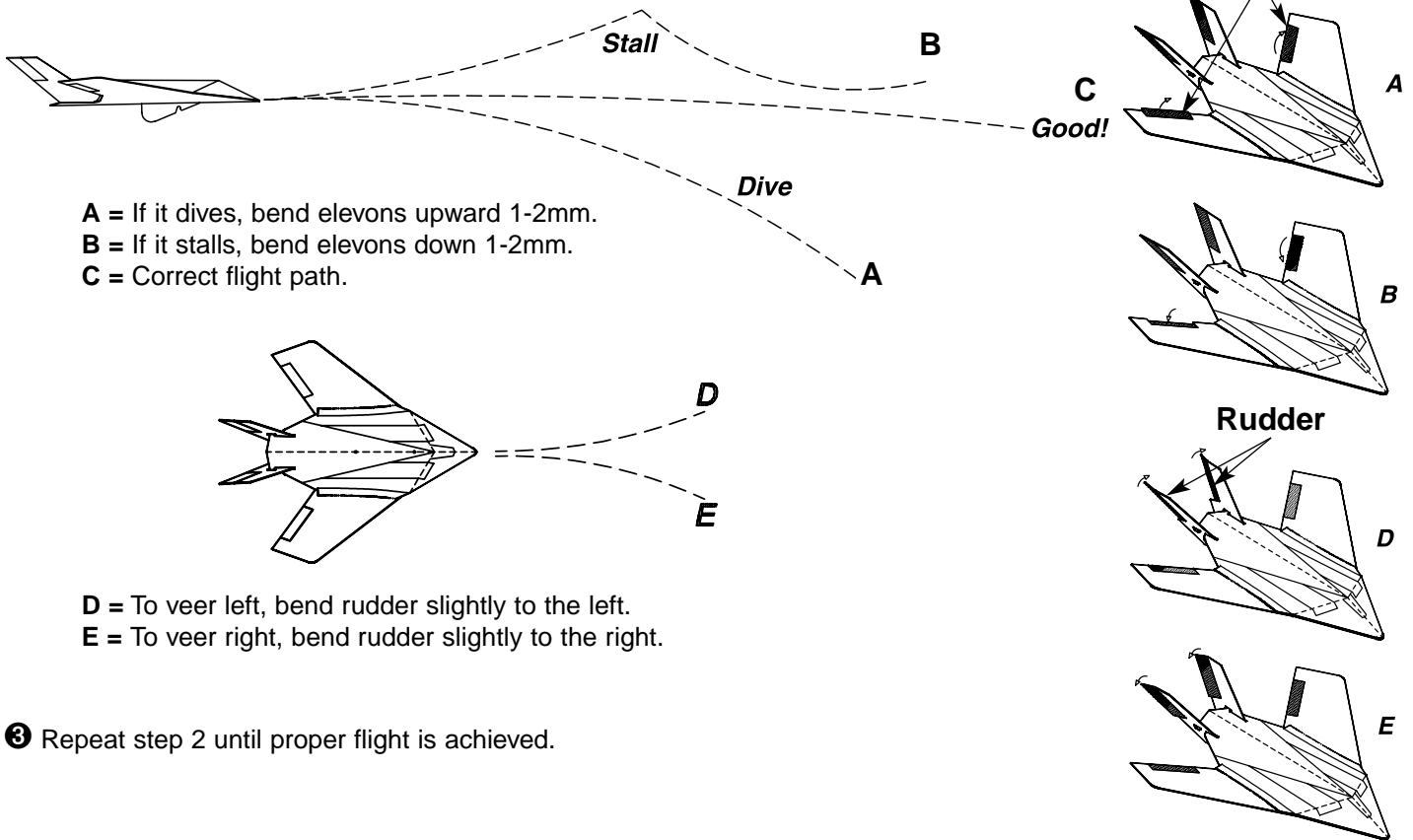

- ❸ Repeat step 2 until proper flight is achieved.

## CATAPULT LAUNCH

**Rubber Band Launch:** Tie the ends of the rubber band together. Secure the rubber band to the launcher stick. Attach the rubber band launcher to the nose of the Stealth. Holding the fuselage under the wing, stretch the rubber band tight. Point the Stealth into the breeze and release.

**Repair:** If the airplane is cracked or damaged, apply white glue and cellophane tape and let dry overnight.

**Warning:** Do not use super glue. It will damage the foam.

