

ESCAPADE

Technical Notice for Great Planes Escapade ARF

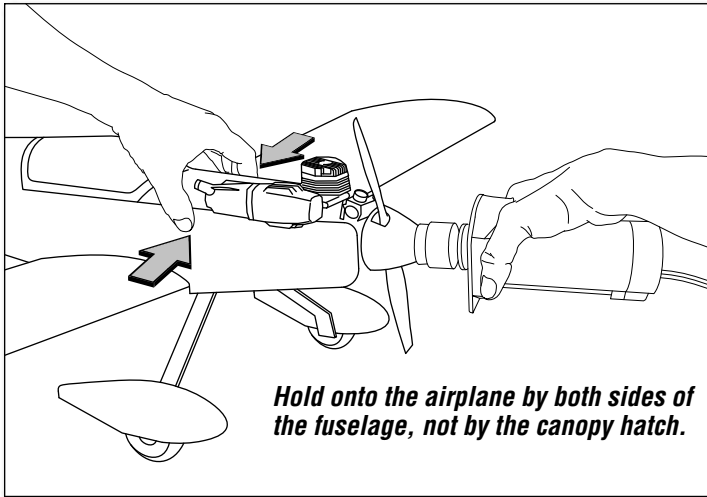

When starting the engine, some modelers inadvertently slide the canopy hatch forward while pushing the fuselage against the electric starter. To avoid this, don't hold onto the canopy hatch while starting the engine. Grasp only the fuselage sides just below the hatch.



To make certain the canopy hatch always remains latched and secure, stick two or three layers of 1/8" [3.2mm] single-sided foam wing seating tape on the front of the canopy hatch as shown. This will assist the magnets in pushing the canopy all the way back assuring that the tabs remain locked. Additionally, always make certain the canopy is all the way back and locked before taking off.