

# FPV Camera & Mount

## Installation Instructions

### CAMERA SPECS

600TVL FPV video camera  
25mW 40-channel,  
5-band, 5.8GHz video transmitter.

### ITEMS REQUIRED

- 5.8GHz monitor such as Tactic FPV-RM2 (TACZ5005)
- FPV goggles such as Tactic FPV-G1 Goggles. (TACZ5200)
- Dual Lead Extension "Y-harness" (FUTM4130)
- (2) 2x6mm Self-Tapping Screws (DTXQ0201)



### INSTALLATION

Rally Car	2 – 3mm
Short Course, SC4.18	2 – 3mm
Monster Truck	5 – 6mm
DT4.18	6 – 7mm

**NOT RECOMMENDED** for other body styles as they do not protect the camera.

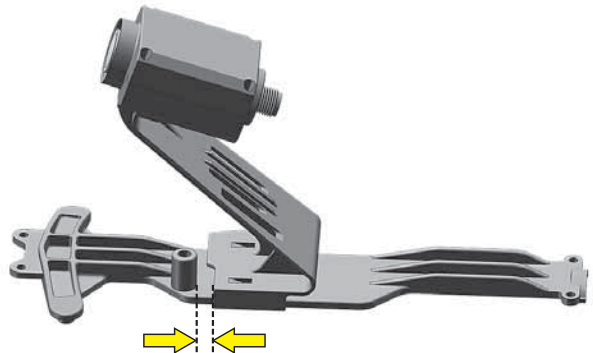

- A.** Peel the protective covering of the exposed side of the foam mounting tape and place the camera onto the top of the kit's chassis brace in the location shown for your vehicle.

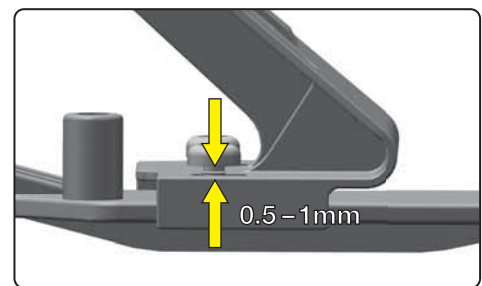
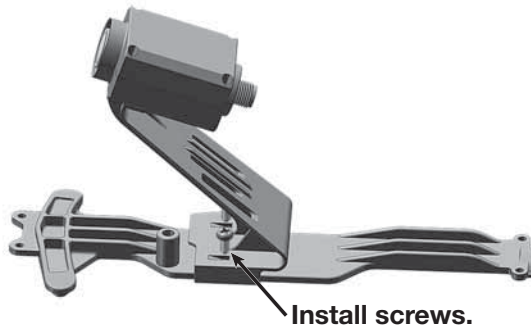

- B.** Install two 2x6mm screws (not included) through the bottom of the camera mount into the chassis brace. Tighten the screws until there is a small (0.5–1mm) gap between the screw head and the camera mount. **Do not compress the foam tape.**

- C.** Thread the antenna onto the antenna mount at the back of the camera. Be sure to position the small flat section pointed upwards if you intend to bend the antenna into the upright position.

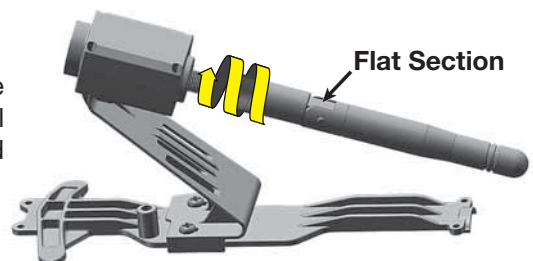

**D.** Plug the camera power wire into the ESC:

**1.** Remove the antenna cap and tube.



**2.** Remove the three screws that attach the ESC/Receiver to the chassis.

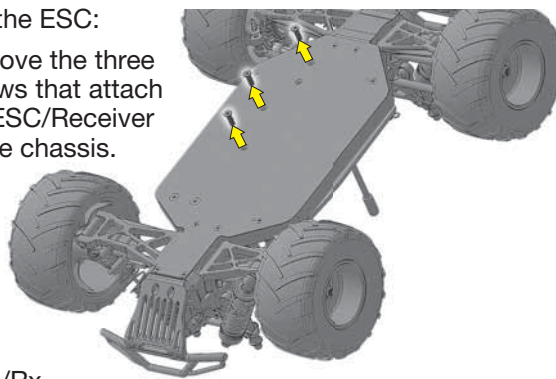

**3.** Unplug the servo from the ESC/Rx unit.

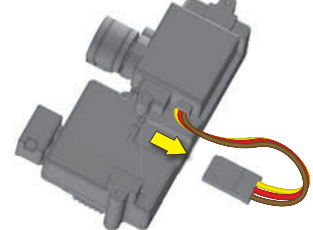

**4.** Plug the “Y” harness into the ESC/Rx unit where the servo was plugged in (note the +/- direction). Plug the servo and camera into either of the connectors at the other end of the harness.

**5.** Re-install the ESC/Rx unit to the chassis using the three screws removed in step 2. Be sure the new harness wires are routed so they do not contact any moving parts.

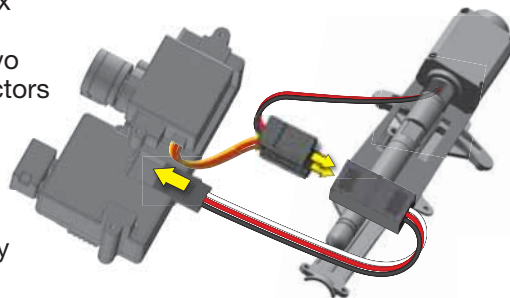

**6.** The receiver antenna must be upright beside the camera.



**E.** The front window of the body will need to be cut to clear the camera. Each body will need a slightly different size hole/location, but no matter what body is used, there are a few guidelines:

1. Use the smallest size cut-out needed to clear the camera.
2. The body should be not touching the camera.
3. Keep the camera under the body as much as possible to help protect it in the event of a rollover.
4. Be sure the edges of the camera's lens are not blocked.

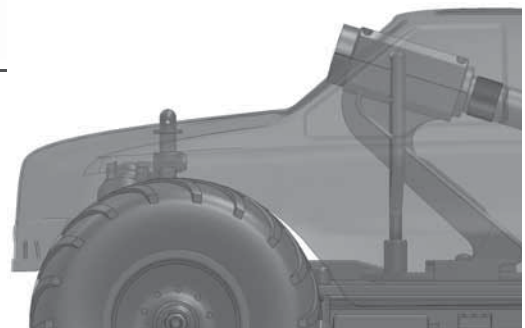

## BAND/CHANNEL CHANGE

**F.** To change channels or band on the camera, remove the 4 small screws holding the case together and remove the top of the camera case.

**G.** The band and channel information is displayed in the small screen above the selection button. Gently pushing the selection button forward changes the channel or band. The LED display will flash the selected band letter and number.

**To change the band:** Press and hold the button for one second.

**To change the channel:** Press and release the button.

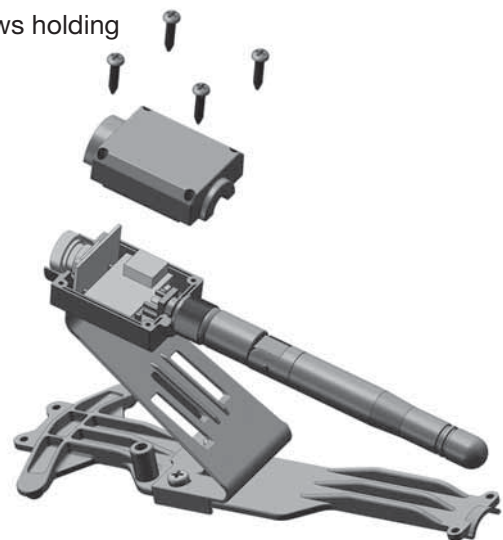
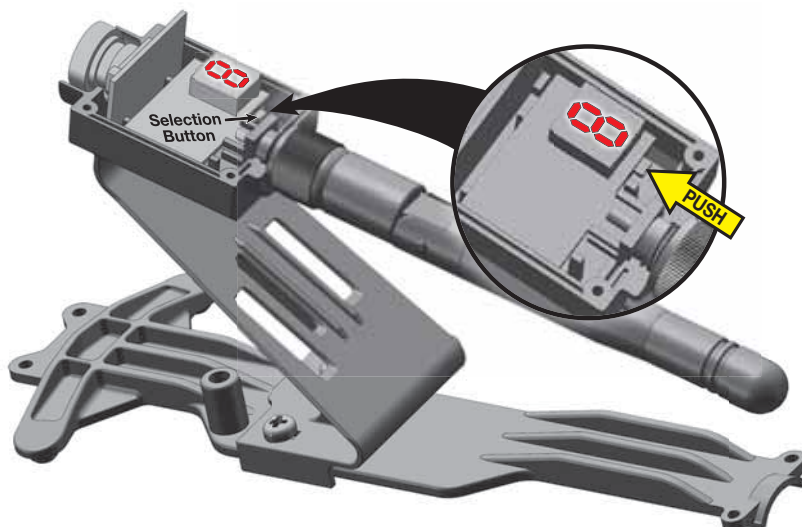

BAND	CH1	CH2	CH3	CH4	CH5	CH6	CH7	CH8
A	5865	5845	5825	5805	5785	5765	5745	5725
B	5733	5752	5771	5790	5809	5828	5847	5866
E	5705	5685	5665	5645	5885	5905	5925	5945
F	5740	5760	5780	5800	5820	5840	5860	5880
R	5658	5695	5732	5769	5806	5843	5880	5917